

Oklahoma Corporation Commission  
 Oil & Gas Conservation Division  
 Post Office Box 52000  
 Oklahoma City, Oklahoma 73152-2000  
 Rule 165: 10-3-25

Form 1002A

API No.: 35151243530000

**Completion Report**

Spud Date: March 06, 2015

OTC Prod. Unit No.:

Drilling Finished Date: March 29, 2015

1st Prod Date:

Completion Date: April 28, 2016

**Drill Type: HORIZONTAL HOLE**

Well Name: TENA 5-27-16 1H

Purchaser/Measurer:

Location: WOODS 5 27N 16W  
 NW NE NW NE  
 300 FNL 1965 FEL of 1/4 SEC  
 Derrick Elevation: 1906 Ground Elevation: 1888

First Sales Date:

Operator: CHESAPEAKE OPERATING LLC 17441  
 PO BOX 18496  
 6100 N WESTERN AVE  
 OKLAHOMA CITY, OK 73154-0496

Completion Type	
<input type="checkbox"/>	Single Zone
<input type="checkbox"/>	Multiple Zone
<input type="checkbox"/>	Commingled

Location Exception
Order No
634783

Increased Density
Order No
There are no Increased Density records to display.

Casing and Cement							
Type	Size	Weight	Grade	Feet	PSI	SAX	Top of CMT
SURFACE	9 5/8	36	J-55	1165		390	SURFACE
PRODUCTION	7	26	P-110EC	6120		215	4027

Liner								
Type	Size	Weight	Grade	Length	PSI	SAX	Top Depth	Bottom Depth
LINER	4 1/2	11.6	P-110EC	4570	0	515	5890	10460

**Total Depth: 10462**

Packer	
Depth	Brand & Type
There are no Packer records to display.	

Plug	
Depth	Plug Type
There are no Plug records to display.	

Initial Test Data										
Test Date	Formation	Oil BBL/Day	Oil-Gravity (API)	Gas MCF/Day	Gas-Oil Ratio Cu FT/BBL	Water BBL/Day	Pumpin or Flowing	Initial Shut-In Pressure	Choke Size	Flow Tubing Pressure
There are no Initial Data records to display.										

Completion and Test Data by Producing Formation		
Formation Name: N/A	Code:	Class: TA

Formation	Top
MISSISSIPPI	5731

Were open hole logs run? No

Date last log run:

Were unusual drilling circumstances encountered? No

Explanation:

Other Remarks
WAITING ON COMPLETION

Lateral Holes
Sec: 5 TWP: 27N RGE: 16W County: WOODS SE SE SW SE 176 FSL 1385 FEL of 1/4 SEC Depth of Deviation: 5437 Radius of Turn: 373 Direction: 180 Total Length: 4731 Measured Total Depth: 10462 True Vertical Depth: 5810 End Pt. Location From Release, Unit or Property Line: 176

FOR COMMISSION USE ONLY	
Status: Accepted	1133444

API NO. 35-151-24353  
OTC PROD.  
UNIT NO. N/A

PLEASE TYPE OR USE BLACK INK ONLY  
NOTE:  
Attach copy of original 1002A if recompletion or reentry.

OKLAHOMA CORPORATION COMMISSION  
Oil & Gas Conservation Division  
Post Office Box 52000  
Oklahoma City, Oklahoma 73152-2000  
Rule 165:10-3-25

654118/  
**RECEIVED**

APR 28 2016

ORIGINAL  
 AMENDED  
Reason Amended

COMPLETION REPORT

TYPE OF DRILLING OPERATION  
 STRAIGHT HOLE  DIRECTIONAL HOLE  HORIZONTAL HOLE  
If directional or horizontal, see reverse for bottom hole location.

SPUD DATE 3/6/2015  
DRLG FINISHED DATE 3/29/2015  
DATE OF WELL COMPLETION 4-28-2016  
1ST PROD DATE N/A  
RECAMP DATE

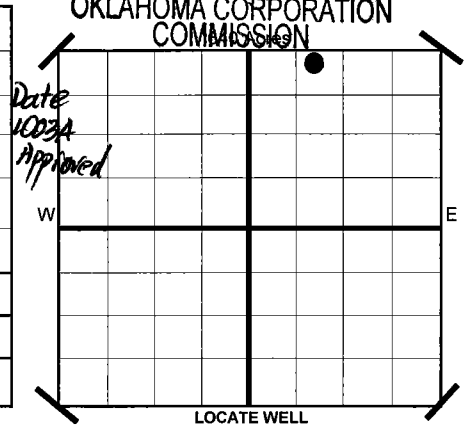

COUNTY WOODS SEC 5 TWP 27N RGE 16W  
LEASE NAME TENA 5-27-16 WELL NO 1H  
SHL NW 1/4 NE 1/4 NW 1/4 NE 1/4 300 1/4 SEC 1,965  
ELEVATION Derrick FI 1,906 Ground 1,888  
OPERATOR NAME CHESAPEAKE OPERATING, L.L.C. OTC/OCC OPERATOR NO. 17441  
ADDRESS P.O. BOX 18496  
CITY OKLAHOMA CITY STATE OK ZIP 73154

COMPLETION TYPE

SINGLE ZONE  
 MULTIPLE ZONE  
Application Date  
 COMMINGLED  
Application Date  
LOCATION EXCEPTION ORDER NO. 634783 (INTERIM)  
INCREASED DENSITY ORDER NO.

CASING & CEMENT (Form 1002C must be attached)

TYPE	SIZE	WEIGHT	GRADE	FEET	PSI	SAX	TOP	
CONDUCTOR								
SURFACE	9 5/8"	36#	J-55	1,165		390	SURFACE	
INTERMEDIATE								
PRODUCTION	7"	26#	P-110EC	6,120		215	4,027	
LINER	4 1/2"	11.6#	P-110EC	5,890-10,460		515	5,890	
							TOTAL DEPTH	10,462

PACKER @ N/A BRAND & TYPE  
PACKER @ BRAND & TYPE

PLUG @ TYPE PLUG @ TYPE  
PLUG @ TYPE PLUG @ TYPE

COMPLETION & TEST DATA BY PRODUCING FORMATION

FORMATION	SPACING & SPACING ORDER NUMBER	CLASS: Oil, Gas, Dry, Inj, Disp, Comm Disp, Svc	PERFORATED INTERVALS	ACID/VOLUME	FRACTURE TREATMENT (Fluids/Prop Amounts)
		Temporarily Abandoned			

**AS SUBMITTED**

Minimum Gas Allowable (165:10-17-7) OR Gas Purchaser/Measurer  
 Oil Allowable (165:10-13-3) 1st Sales Date

INITIAL TEST DATA

INITIAL TEST DATE	N/A				
OIL-BBL/DAY					
OIL-GRAVITY ( API)					
GAS-MCF/DAY					
GAS-OIL RATIO CU FT/BBL					
WATER-BBL/DAY					
PUMPING OR FLOWING					
INITIAL SHUT-IN PRESSURE					
CHOKE SIZE					
FLOW TUBING PRESSURE					

A record of the formations drilled through, and pertinent remarks are presented on the reverse. I declare that I have knowledge of the contents of this report and am authorized by my organization to make this report, which was prepared by me or under my supervision and direction, with the data and facts stated herein to be true, correct, and complete to the best of my knowledge and belief.

Sara Everett  
SIGNATURE  
P.O. BOX 18496  
ADDRESS  
OKLAHOMA CITY  
CITY  
OK  
STATE  
73154  
ZIP  
4/27/2016  
DATE  
405-848-8000  
PHONE NUMBER  
sara.everett@chk.com  
EMAIL ADDRESS

**PLEASE TYPE OR USE BLACK INK ONLY**  
FORMATION RECORD

Give formation names and tops, if available, or descriptions and thickness of formations drilled through. Show intervals cored or drillstem tested.

LEASE NAME TENA 5-27-16

WELL NO. 1H

NAMES OF FORMATIONS	TOP
MISSISSIPPI	5,731

FOR COMMISSION USE ONLY	
ITD on file	<input type="checkbox"/> YES <input type="checkbox"/> NO
APPROVED	DISAPPROVED
2) Reject Codes	
_____	
_____	
_____	
_____	

Were open hole logs run?	yes <input checked="" type="checkbox"/> no
Date Last log was run	N/A
Was CO <sub>2</sub> encountered?	yes <input checked="" type="checkbox"/> no at what depths?
Was H <sub>2</sub> S encountered?	yes <input checked="" type="checkbox"/> no at what depths?
Were unusual drilling circumstances encountered?	yes <input type="checkbox"/> no <input checked="" type="checkbox"/>
If yes, briefly explain.	

Other remarks: \*WAITING ON COMPLETION

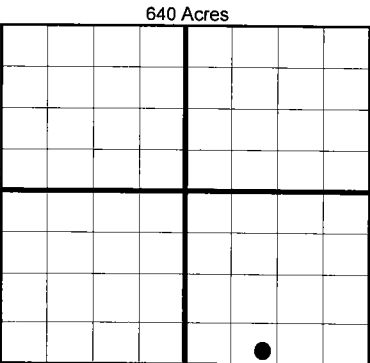

If more than three drainholes are proposed, attach a separate sheet indicating the necessary information.

Direction must be stated in degrees azimuth. Please note, the horizontal drainhole and its end point must be located within the boundaries of the lease or spacing unit.

**Directional surveys are required for all drainholes and directional wells.**

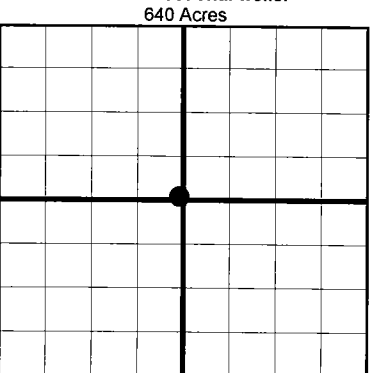

**BOTTOM HOLE LOCATION FOR DIRECTIONAL HOLE**

SEC	TWP	RGE	COUNTY							
Spot Location				1/4	1/4	1/4	1/4	Feet From 1/4 Sec Lines	FSL	FWL
Measured Total Depth				True Vertical Depth		BHL From Lease, Unit, or Property Line:				

**BOTTOM HOLE LOCATION FOR HORIZONTAL HOLE: (LATERALS)**

SEC	TWP	RGE	COUNTY								
5	27N	16W	WOODS								
Spot Location				SE 1/4	SE 1/4	SW 1/4	SE 1/4	Feet From 1/4 Sec Lines	FSL 176	FEL 1,385	
Depth of Deviation				5,437		Radius of Turn		373		Direction 180	Total Length 4,731
Measured Total Depth				10,462		True Vertical Depth		5,810		BHL From Lease, Unit, or Property Line: 176	

**LATERAL #2**

SEC	TWP	RGE	COUNTY								
Spot Location				1/4	1/4	1/4	1/4	Feet From 1/4 Sec Lines	FSL	FWL	
Depth of Deviation						Radius of Turn		Direction		Total Length	
Measured Total Depth						True Vertical Depth		BHL From Lease, Unit, or Property Line:			

**LATERAL #3**

SEC	TWP	RGE	COUNTY								
Spot Location				1/4	1/4	1/4	1/4	Feet From 1/4 Sec Lines	FSL	FWL	
Depth of Deviation						Radius of Turn		Direction		Total Length	
Measured Total Depth						True Vertical Depth		BHL From Lease, Unit, or Property Line:			