

Oklahoma Corporation Commission
 Oil & Gas Conservation Division
 Post Office Box 52000
 Oklahoma City, Oklahoma 73152-2000
 Rule 165: 10-3-25

Form 1002A

API No.: 35125015230001

Completion Report

Spud Date: December 09, 1950

OTC Prod. Unit No.:

Drilling Finished Date: January 01, 1951

Amended

1st Prod Date: January 01, 1951

Amend Reason: RESTORED TO PRODUCTION

Completion Date: January 01, 1951

Recomplete Date: October 14, 2015

Drill Type: STRAIGHT HOLE

Well Name: COULTER 1

Purchaser/Measurer:

Location: POTTAWATOMIE 32 6N 3E
 C SW NW NW
 1650 FSL 330 FWL of 1/4 SEC
 Derrick Elevation: 1008 Ground Elevation: 1003

First Sales Date:

Operator: BRAMMER PETROLEUM INC 17853
 PO BOX 243
 6178 E HIGHWAY 82
 GAINESVILLE, TX 76240-0243

Completion Type	
X	Single Zone
	Multiple Zone
	Commingled

Location Exception
Order No
There are no Location Exception records to display.

Increased Density
Order No
There are no Increased Density records to display.

Casing and Cement							
Type	Size	Weight	Grade	Feet	PSI	SAX	Top of CMT
CONDUCTOR	10 3/4	32	B	53		50	
PRODUCTION	7	24	B	3010			

Liner								
Type	Size	Weight	Grade	Length	PSI	SAX	Top Depth	Bottom Depth
There are no Liner records to display.								

Total Depth: 3033

Packer	
Depth	Brand & Type
There are no Packer records to display.	

Plug	
Depth	Plug Type
There are no Plug records to display.	

Initial Test Data										
Test Date	Formation	Oil BBL/Day	Oil-Gravity (API)	Gas MCF/Day	Gas-Oil Ratio Cu FT/BBL	Water BBL/Day	Pumpin or Flowing	Initial Shut-In Pressure	Choke Size	Flow Tubing Pressure
There are no Initial Data records to display.										

Completion and Test Data by Producing Formation														
Formation Name: LAYTON	Code: 405LYTN	Class: OIL												
<table border="1"> <thead> <tr> <th colspan="2">Spacing Orders</th> </tr> <tr> <th>Order No</th> <th>Unit Size</th> </tr> </thead> <tbody> <tr> <td colspan="2">There are no Spacing Order records to display.</td> </tr> </tbody> </table>		Spacing Orders		Order No	Unit Size	There are no Spacing Order records to display.		<table border="1"> <thead> <tr> <th colspan="2">Perforated Intervals</th> </tr> <tr> <th>From</th> <th>To</th> </tr> </thead> <tbody> <tr> <td colspan="2">There are no Perf. Intervals records to display.</td> </tr> </tbody> </table>	Perforated Intervals		From	To	There are no Perf. Intervals records to display.	
Spacing Orders														
Order No	Unit Size													
There are no Spacing Order records to display.														
Perforated Intervals														
From	To													
There are no Perf. Intervals records to display.														
<table border="1"> <thead> <tr> <th colspan="2">Acid Volumes</th> </tr> </thead> <tbody> <tr> <td colspan="2">There are no Acid Volume records to display.</td> </tr> </tbody> </table>		Acid Volumes		There are no Acid Volume records to display.		<table border="1"> <thead> <tr> <th colspan="2">Fracture Treatments</th> </tr> </thead> <tbody> <tr> <td colspan="2">HALLIBURTON HYDRO FRAC</td> </tr> </tbody> </table>	Fracture Treatments		HALLIBURTON HYDRO FRAC					
Acid Volumes														
There are no Acid Volume records to display.														
Fracture Treatments														
HALLIBURTON HYDRO FRAC														

Formation	Top
LAYTON	3007

Were open hole logs run? Yes
Date last log run: January 01, 1949

Were unusual drilling circumstances encountered? No
Explanation:

Other Remarks
OCC - THIS WELL IS AN OPEN HOLE COMPLETION FROM BOTTOM OF 7" CASING AT 3,010' TO TOTAL DEPTH AT 3,033'.

FOR COMMISSION USE ONLY	
Status: Accepted	1133436

RECEIVED

Form 1002A Rev. 2009

FEB 25 2016

OKLAHOMA CORPORATION COMMISSION

API NO 12501523
OTC PROD.
UNIT NO.

PLEASE TYPE OR USE BLACK INK ONLY
NOTE:

Attach copy of original 1002A if recompletion or reentry.

OKLAHOMA CORPORATION COMMISSION
Oil & Gas Conservation Division
Post Office Box 52000
Oklahoma City, Oklahoma 73152-2000
Rule 165:10-3-25

ORIGINAL
 AMENDED (Reason)

Restored to production

COMPLETION REPORT

TYPE OF DRILLING OPERATION

STRAIGHT HOLE DIRECTIONAL HOLE HORIZONTAL HOLE
 SERVICE WELL

SPUD DATE 12-9-1950
DRLG FINISHED DATE 1-1951

If directional or horizontal, see reverse for bottom hole location.

Well location and completion data including: Pottawatomie SEC 32 TWP 6N RGE 3E, Lease Name Coulter, C 1/4 SW 1/4 NW 1/4 NW 1/4, FSL OF 1/4 SEC 1650, FWL OF 1/4 SEC 330, RECOMP DATE 10-14-2015, OPERATOR Brammer Petroleum, ADDRESS P.O. Box 243, CITY Gainesville, STATE TX, ZIP 76241.

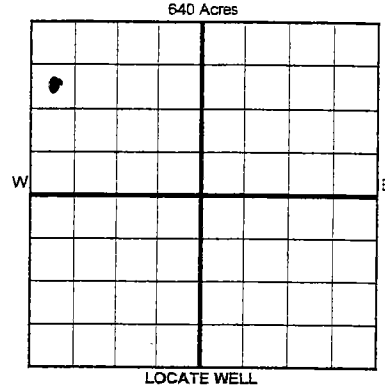

COMPLETION TYPE: SINGLE ZONE, MULTIPLE ZONE, COMMINGLED. LOCATION: EXCEPTION ORDER, INCREASED DENSITY, ORDER NO.

CASING & CEMENT (Form 1002C must be attached)

TYPE	SIZE	WEIGHT	GRADE	FEET	PSI	SAX	TOP OF CMT
CONDUCTOR							
SURFACE	10 3/4	32#	B	53.48'		50	
INTERMEDIATE							
PRODUCTION	7"	24#	B	3010			
LINER							

PACKER @ _____ BRAND & TYPE _____ PLUG @ _____ TYPE _____ PLUG @ _____ TYPE _____ TOTAL DEPTH 3033

COMPLETION & TEST DATA BY PRODUCING FORMATION 40564TN

FORMATION Lorton
CLASS: Oil, Gas, Dry, Int, Disp, Comm Disp, Svc
PERFORATED INTERVALS 0H-3010-3033 open hole
FRACTURE TREATMENT Halliburton Hydro Frac

AS SUBMITTED

Min Gas Allowable (165:10-17-7) OR Gas Purchaser/Measurer
Oil Allowable (165:10-13-3) First Sales Date

INITIAL TEST DATA

INITIAL TEST DATE					
OIL-BBL/DAY					
OIL-GRAVITY (API)					
GAS-MCF/DAY					
GAS-OIL RATIO CU FT/BBL					
WATER-BBL/DAY					
PUMPING OR FLOWING					
INITIAL SHUT-IN PRESSURE					
CHOKE SIZE					
FLOW TUBING PRESSURE					

A record of the formations drilled through, and pertinent remarks are presented on the reverse. I declare that I have knowledge of the contents of this report and am authorized by my organization to make this report, which was prepared by me or under my supervision and direction, with the data and facts stated herein to be true, correct, and complete to the best of my knowledge and belief.

SIGNATURE Stephen Moore NAME (PRINT OR TYPE) DATE 2/9/16 PHONE NUMBER 940-665-4807
ADDRESS P.O. Box 243 Gainesville TX ZIP 76241 EMAIL ADDRESS smail.moore@gmail.com

PLEASE TYPE OR USE BLACK INK ONLY
FORMATION RECORD

Give formation names and tops, if available, or descriptions and thickness of formations drilled through. Show intervals cored or drillstem tested.

LEASE NAME Cutter WELL NO. #1

NAMES OF FORMATIONS	TOP
<u>Cayton</u>	<u>3007</u>

FOR COMMISSION USE ONLY

ITD on file YES NO

APPROVED _____ DISAPPROVED _____

2) Reject Codes _____

Were open hole logs run? yes no

Date Last log was run 10/19

Was CO₂ encountered? yes no at what depths? _____

Was H₂S encountered? yes no at what depths? _____

Were unusual drilling circumstances encountered? yes no

If yes, briefly explain below _____

Other remarks: DCC - This well is an open hole completion from bottom of 7" casing at 3010' to total depth at 3033'

640 Acres

If more than three drainholes are proposed, attach a separate sheet indicating the necessary information.

Direction must be stated in degrees azimuth. Please note, the horizontal drainhole and its end point must be located within the boundaries of the lease or spacing unit.

Directional surveys are required for all drainholes and directional wells.

640 Acres

BOTTOM HOLE LOCATION FOR DIRECTIONAL HOLE

SEC	TWP	RGE	COUNTY				
Spot Location	1/4	1/4	1/4	1/4	Feet From 1/4 Sec Lines	FSL	FWL
Measured Total Depth	True Vertical Depth		BHL From Lease, Unit, or Property Line:				

BOTTOM HOLE LOCATION FOR HORIZONTAL HOLE: (LATERALS)

LATERAL #1

SEC	TWP	RGE	COUNTY				
Spot Location	1/4	1/4	1/4	1/4	Feet From 1/4 Sec Lines	FSL	FWL
Depth of Deviation	Radius of Turn		Direction		Total Length		
Measured Total Depth	True Vertical Depth		BHL From Lease, Unit, or Property Line:				

LATERAL #2

SEC	TWP	RGE	COUNTY				
Spot Location	1/4	1/4	1/4	1/4	Feet From 1/4 Sec Lines	FSL	FWL
Depth of Deviation	Radius of Turn		Direction		Total Length		
Measured Total Depth	True Vertical Depth		BHL From Lease, Unit, or Property Line:				

LATERAL #3

SEC	TWP	RGE	COUNTY				
Spot Location	1/4	1/4	1/4	1/4	Feet From 1/4 Sec Lines	FSL	FWL
Depth of Deviation	Radius of Turn		Direction		Total Length		
Measured Total Depth	True Vertical Depth		BHL From Lease, Unit, or Property Line:				