

Oklahoma Corporation Commission
Oil & Gas Conservation Division
Post Office Box 52000
Oklahoma City, Oklahoma 73152-2000
Rule 165: 10-3-25

Form 1002A

API No.: 35107235710001

Completion Report

Spud Date: October 17, 2015

OTC Prod. Unit No.:

Drilling Finished Date: November 30, 2015

1st Prod Date: December 20, 2015

Completion Date: December 10, 2015

Drill Type: HORIZONTAL HOLE

Min Gas Allowable: Yes

Well Name: CHEATWOOD 15-1HX

Purchaser/Measurer: ENERFIN

Location: OKFUSKEE 15 10N 9E
SW NW SW SW
836 FSL 175 FWL of 1/4 SEC
Latitude: 35.335875 Longitude: -96.33519401
Derrick Elevation: 0 Ground Elevation: 811

First Sales Date: 12/22/2015

Operator: J & T OPERATING LLC 23734

3324 FRENCH PARK DR STE E
EDMOND, OK 73034-7262

Completion Type	
X	Single Zone
	Multiple Zone
	Commingled

Location Exception
Order No
650927

Increased Density
Order No
There are no Increased Density records to display.

Casing and Cement							
Type	Size	Weight	Grade	Feet	PSI	SAX	Top of CMT
CONDUCTOR	14			30		16	SURFACE
SURFACE	9 5/8	36	J-55	324		130	SURFACE
INTERMEDIATE	7	26	P-110	3905		190	1656
PRODUCTION	4 1/2	11.6	P-110	10138		685	3490

Liner								
Type	Size	Weight	Grade	Length	PSI	SAX	Top Depth	Bottom Depth
There are no Liner records to display.								

Total Depth: 10146

Packer	
Depth	Brand & Type
There are no Packer records to display.	

Plug	
Depth	Plug Type
There are no Plug records to display.	

Initial Test Data										
Test Date	Formation	Oil BBL/Day	Oil-Gravity (API)	Gas MCF/Day	Gas-Oil Ratio Cu FT/BBL	Water BBL/Day	Pumpin or Flowing	Initial Shut-In Pressure	Choke Size	Flow Tubing Pressure
Dec 22, 2015	MISSISSIPPIAN			205		1828	FLOWING			205

Completion and Test Data by Producing Formation		
Formation Name: MISSISSIPPIAN	Code: 359MSSP	Class: GAS
Spacing Orders		Perforated Intervals
Order No	Unit Size	From
646252	640	4006
651153	MULTIUNIT	10002
Acid Volumes		Fracture Treatments
1,595 BARRELS 15% HCL		247,774 BARRELS FLUID, 7,127,193 POUNDS SAND

Formation	Top
RED FORK SS	2101
GILCREASE	2961
MISSISSIPPI	3912

Were open hole logs run? No
Date last log run: December 09, 2015
Were unusual drilling circumstances encountered? No
Explanation:

Other Remarks
There are no Other Remarks.

Lateral Holes
Sec: 10 TWP: 10N RGE: 9E County: OKFUSKEE NW NW NW SW 2479 FSL 377 FWL of 1/4 SEC Depth of Deviation: 2882 Radius of Turn: 683 Direction: 360 Total Length: 6191 Measured Total Depth: 10146 True Vertical Depth: 3565 End Pt. Location From Release, Unit or Property Line: 377

FOR COMMISSION USE ONLY
Status: Accepted
1133423

RECEIVED

Form 1002A Rev. 2009

MAR 24 2016

OKLAHOMA CORPORATION COMMISSION

API NO. 3510723571

PLEASE TYPE OR USE BLACK INK ONLY

OKLAHOMA CORPORATION COMMISSION Oil & Gas Conservation Division Post Office Box 52000 Oklahoma City, Oklahoma 73152-2000 Rule 165:10-3-25

Attach copy of original 1002A if recompletion or reentry.

ORIGINAL AMENDED (Reason)

COMPLETION REPORT

TYPE OF DRILLING OPERATION STRAIGHT HOLE DIRECTIONAL HOLE HORIZONTAL HOLE SERVICE WELL

SPUD DATE 10/17/15 DRLG FINISHED DATE 11/30/15 DATE OF WELL COMPLETION 12/10/15 1st PROD DATE 12/20/15 RECOMP DATE

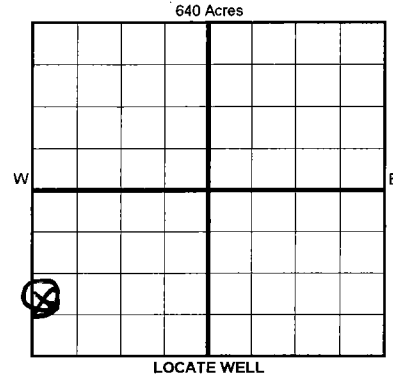

COUNTY Okfuskee SEC 15 TWP 10N RGE 09E LEASE NAME CHEATWOOD WELL NO. 15-1HX FSL OF 1/4 SEC 836' FWL OF 1/4 SEC 175' ELEVATION Derrick FL Ground 811' Latitude (if known) 35.335875 Longitude (if known) -96.33519401 OPERATOR NAME J & T OPERATING, LLC OTC/OCC OPERATOR NO. 23734 ADDRESS 3324 FRENCH PARK DR, SUITE E CITY EDMOND STATE OK ZIP 73034

COMPLETION TYPE SINGLE ZONE MULTIPLE ZONE Application Date COMMINGLED Application Date LOCATION EXCEPTION ORDER NO. 650927 F.O. 646810 INCREASED DENSITY ORDER NO.

Table with columns: TYPE, SIZE, WEIGHT, GRADE, FEET, PSI, SAX, TOP OF CMT. Rows include CONDUCTOR, SURFACE, INTERMEDIATE, PRODUCTION, LINER, and TOTAL DEPTH 10146'.

PACKER @ BRAND & TYPE PLUG @ TYPE PLUG @ TYPE

COMPLETION & TEST DATA BY PRODUCING FORMATION 359MSSP

Table with columns: FORMATION, SPACING & SPACING ORDER NUMBER, CLASS, PERFORATED INTERVALS, ACID/VOLUME, FRACTURE TREATMENT. Includes handwritten notes like 'MISSISSIPPIAN 651153 FO' and 'AS SUBMITTED' stamp.

Min Gas Allowable (165:10-17-7) Gas Purchaser/Measurer Enerfin First Sales Date 12/22/2015

Table with columns: INITIAL TEST DATE, OIL-BBL/DAY, GAS-MCF/DAY, WATER-BBL/DAY, PUMPING OR FLOWING, INITIAL SHUT-IN PRESSURE, CHOKER SIZE, FLOW TUBING PRESSURE.

A record of the formations drilled through, and pertinent remarks are presented on the reverse. I declare that I have knowledge of the contents of this report and am authorized by my organization to make this report, which was prepared by me or under my supervision and direction, with the data and facts stated herein to be true, correct, and complete to the best of my knowledge and belief. Signature: Kyle McLinn, Name: Kyle McLinn, Date: 405-340-2404, Address: 3324 French Park Dr., Suite E, Edmond, OK 73034, Email: kmclinn@mclinnland.com

PLEASE TYPE OR USE BLACK INK ONLY
FORMATION RECORD

Give formation names and tops, if available, or descriptions and thickness of formations drilled through. Show intervals cored or drillstem tested.

LEASE NAME CHEATWOOD WELL NO. 15-1HX

NAMES OF FORMATIONS	TOP
	MD
RED FORK Ss	2,101
GILCREASE	2,961
MISSISSIPPI	3,912

FOR COMMISSION USE ONLY

ITD on file YES NO

APPROVED _____ DISAPPROVED _____

2) Reject Codes _____

Were open hole logs run? ___ yes X no

Date Last log was run 12/9/2015

Was CO₂ encountered? ___ yes X no at what depths? _____

Was H₂S encountered? ___ yes X no at what depths? _____

Were unusual drilling circumstances encountered? ___ yes ___ no
If yes, briefly explain below

Other remarks:

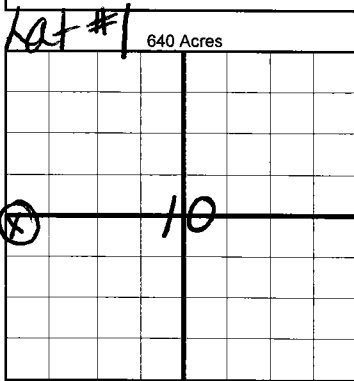

BOTTOM HOLE LOCATION FOR DIRECTIONAL HOLE

SEC	TWP	RGE	COUNTY				
Spot Location	1/4	1/4	1/4	1/4	Feet From 1/4 Sec Lines	FSL	FWL
Measured Total Depth	True Vertical Depth		BHL From Lease, Unit, or Property Line:				

BOTTOM HOLE LOCATION FOR HORIZONTAL HOLE: (LATERALS)

Data system won't take larger than 2640

2479 FSL

LATERAL #1	SEC	TWP	RGE	COUNTY					
SEC	10	10N	9E	OKFUSKEE					
Spot Location	NW 1/4	NW 1/4	SW 1/4	SW 1/4	Feet From 1/4 Sec Lines	FNL 2804	FWL 377		
Depth of Deviation	2,882		Radius of Turn	683 1848'		Direction	360 N	Total Length	6191 10,146
Measured Total Depth	10,146		True Vertical Depth	3,565		BHL From Lease, Unit, or Property Line: 377'			

If more than three drainholes are proposed, attach a separate sheet indicating the necessary information.

Direction must be stated in degrees azimuth. Please note, the horizontal drainhole and its end point must be located within the boundaries of the lease or spacing unit.

Directional surveys are required for all drainholes and directional wells.

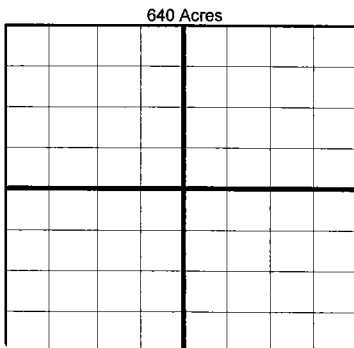

LATERAL #2

SEC	TWP	RGE	COUNTY				
Spot Location	1/4	1/4	1/4	1/4	Feet From 1/4 Sec Lines	FNL	FWL
Depth of Deviation	Radius of Turn		Direction		Total Length		
Measured Total Depth	True Vertical Depth		BHL From Lease, Unit, or Property Line:				

LATERAL #3

SEC	TWP	RGE	COUNTY				
Spot Location	1/4	1/4	1/4	1/4	Feet From 1/4 Sec Lines	FSL	FWL
Depth of Deviation	Radius of Turn		Direction		Total Length		
Measured Total Depth	True Vertical Depth		BHL From Lease, Unit, or Property Line:				

4/1/16

Recvd.
3/24/16

1016EZ

API NO. 10723571
OTC PROD. UNIT NO. 107-217145

PLEASE TYPE OR USE BLACK INK ONLY
NOTE:
Attach copy of original 1002A if recompletion or reentry.

OKLAHOMA CORPORATION COMMISSION
Oil & Gas Conservation Division
Post Office Box 52000
Oklahoma City, Oklahoma 73152-2000
Rule 165:10-3-25

ORIGINAL
 AMENDED (Reason)

ADDED ISIP

COMPLETION REPORT

TYPE OF DRILLING OPERATION: STRAIGHT HOLE DIRECTIONAL HOLE HORIZONTAL HOLE SERVICE WELL
 If directional or horizontal, see reverse for bottom hole location: **B.H.L. 10-10N-09E**

SPUD DATE: 10/17/15
 DRLG FINISHED DATE: 11/30/15
 DATE OF WELL COMPLETION: 12/10/15
 1st PROD DATE: 12/20/15
 RECOMP DATE: _____

COUNTY: Okfuskee SEC 15 TWP 10N RGE 9E
 LEASE NAME: CHEATWOOD WELL NO. 15-1HX
 FSL OF 1/4 SEC: 836' FWL OF 1/4 SEC: 175'
 ELEVATIO N Derrick: Ground 811' Latitude (if known): 35.335875 Longitude (if known): -96.33519401
 OPERATOR NAME: J & T OPERATING, LLC OTC/OCC OPERATOR NO. 23734
 ADDRESS: 3324 FRENCH PARK DR, SUITE E
 CITY: EDMOND STATE: OK ZIP: 73034

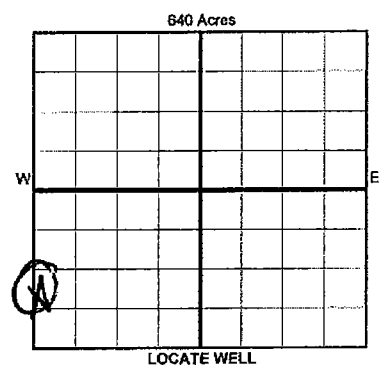

COMPLETION TYPE
 SINGLE ZONE
 MULTIPLE ZONE
 Application Date _____
 COMMINGLED
 Application Date _____

LOCATION
 EXCEPTION ORDER INCREASED DENSITY ORDER NO. 650927

CASING & CEMENT (Form 1002C must be attached)

TYPE	SIZE	WEIGHT	GRADE	FEET	PSI	SAX	TOP OF CMT	
CONDUCTOR	14"			30'		16	SURFACE	
SURFACE	9-5/8"	36#	J-55	324'		130	SURFACE	
INTERMEDIATE	7"	26#	P-110	3905'		190	1656'	
PRODUCTION	4-1/2"	11.6#	P-110	10138'		685	3490'	
LINER								
							TOTAL DEPTH	10146'

PACKER @ _____ BRAND & TYPE _____ PLUG @ _____ TYPE _____ PLUG @ _____ TYPE _____
 PACKER @ _____ BRAND & TYPE _____ PLUG @ _____ TYPE _____ PLUG @ _____ TYPE _____

COMPLETION & TEST DATA BY PRODUCING FORMATION

FORMATION	MISSISSIPPIAN						
SPACING & SPACING ORDER NUMBER	646252						
CLASS: Oil, Gas, Dry, Inj, Disp, Comm Disp, Svc	GAS						
PERFORATED INTERVALS	4006-10022'						
ACID/VOLUME	1595 Bbls 15% HCl						
FRACTURE TREATMENT (Fluids/Prop Amounts)	247,774 Bbls Fluid						
	7,127,193# Sd						

Min Gas Allowable (165:10-17-7) OR Oil Allowable (165:10-13-3)
 Gas Purchaser/Measurer: Enerfin
 First Sales Date: 12/22/2015

INITIAL TEST DATA

INITIAL TEST DATE	12/22/2015		
OIL-BBL/DAY			
OIL-GRAVITY (API)			
GAS-MCF/DAY	205		
GAS-OIL RATIO CU FT/BBL			
WATER-BBL/DAY	1828		
PUMPING OR FLOWING	Flowing		
INITIAL SHUT-IN PRESSURE	997		
CHOKE SIZE	64/64		
FLOW TUBING PRESSURE	205		

A record of the formations drilled through, and pertinent remarks are presented on the reverse. I declare that I have knowledge of the contents of this report and am authorized by my organization to make this report, which was prepared by me or under my supervision and direction, with the data and facts stated herein to be true, correct, and complete to the best of my knowledge and belief.

SIGNATURE: *Kyle McLinn* NAME (PRINT OR TYPE): Kyle McLinn DATE: 12/22/2015 PHONE NUMBER: 405-340-2404
 ADDRESS: 3324 French Park Dr, #E CITY: Edmond, STATE: OK ZIP: 73034 EMAIL ADDRESS: kmclinn@mclinnland.com

E2

JA