

Oklahoma Corporation Commission  
Oil & Gas Conservation Division  
Post Office Box 52000  
Oklahoma City, Oklahoma 73152-2000  
Rule 165: 10-3-25

Form 1002A

API No.: 35085212620001

**Completion Report**

Spud Date: August 06, 2015

OTC Prod. Unit No.: 085-217310

Drilling Finished Date: December 11, 2015

1st Prod Date: April 04, 2016

Completion Date: April 04, 2016

**Drill Type: HORIZONTAL HOLE**

Well Name: CONNIE SUE 1-23H26

Purchaser/Measurer:

Location: LOVE 23 7S 1E  
NW SE SW SW  
364 FSL 840 FWL of 1/4 SEC  
Derrick Elevation: 827 Ground Elevation: 800

First Sales Date:

Operator: XTO ENERGY INC 21003

210 W PARK AVE STE 2350  
OKLAHOMA CITY, OK 73102-5683

Completion Type	
X	Single Zone
	Multiple Zone
	Commingled

Location Exception	
Order No	
651763	

Increased Density	
Order No	
There are no Increased Density records to display.	

Casing and Cement							
Type	Size	Weight	Grade	Feet	PSI	SAX	Top of CMT
CONDUCTOR	20	53	PE & B	107			SURFACE
SURFACE	9 5/8	36	J-55	1993		520	SURFACE
PRODUCTION	7	32	P-110	15455		410	12050

Liner								
Type	Size	Weight	Grade	Length	PSI	SAX	Top Depth	Bottom Depth
LINER	4 1/2	15.1	P-110	6666	0	555	13384	20050

**Total Depth: 20075**

Packer	
Depth	Brand & Type
There are no Packer records to display.	

Plug	
Depth	Plug Type
There are no Plug records to display.	

Initial Test Data										
Test Date	Formation	Oil BBL/Day	Oil-Gravity (API)	Gas MCF/Day	Gas-Oil Ratio Cu FT/BBL	Water BBL/Day	Pumpin or Flowing	Initial Shut-In Pressure	Choke Size	Flow Tubing Pressure
Apr 24, 2016	WOODFORD	637	47	1803	2830	1731	FLOWING		18/64	3650

Completion and Test Data by Producing Formation										
Formation Name: WOODFORD			Code: 319WDFD			Class: OIL				
<b>Spacing Orders</b>				<b>Perforated Intervals</b>						
<b>Order No</b>		<b>Unit Size</b>		<b>From</b>			<b>To</b>			
636739		640		15457			19902			
<b>Acid Volumes</b>				<b>Fracture Treatments</b>						
80,000 GALLONS				20 STAGES - 235,979 BTW, 842,940 POUNDS 100 MESH, 7,918,880 POUNDS 40/70						

Formation	Top
WOODFORD	15233

Were open hole logs run? No

Date last log run:

Were unusual drilling circumstances encountered? No

Explanation:

Other Remarks
IRREGULAR SECTION

Lateral Holes
Sec: 26 TWP: 7S RGE: 1E County: LOVE
NW SE SE SW
464 FSL 2108 FWL of 1/4 SEC
Depth of Deviation: 14179 Radius of Turn: 1429 Direction: 166 Total Length: 5341
Measured Total Depth: 20075 True Vertical Depth: 15094 End Pt. Location From Release, Unit or Property Line: 464

FOR COMMISSION USE ONLY
Status: Accepted
1133427

API NO. 085-21262  
 OTC PROD. UNIT NO. 085-217310

PLEASE TYPE OR USE BLACK INK ONLY  
 NOTE:

Attach copy of original 1002A  
 if recompletion or reentry.

OKLAHOMA CORPORATION COMMISSION  
 Oil & Gas Conservation Division  
 Post Office Box 52000  
 Oklahoma City, Oklahoma 73152-2000  
 Rule 165.10-3-25

RECEIVED

Form 1002A  
 Rev. 2009

APR 28 2016

OKLAHOMA CORPORATION  
 COMMISSION

ORIGINAL  
 AMENDED (Reason)

COMPLETION REPORT

TYPE OF DRILLING OPERATION  
 STRAIGHT HOLE  DIRECTIONAL HOLE  HORIZONTAL HOLE  
 SERVICE WELL  
 If directional or horizontal, see reverse for bottom hole location.

SPUD DATE 8/6/2015  
 DRLG FINISHED DATE 12/11/2015  
 DATE OF WELL COMPLETION 4/4/2016  
 1st PROD DATE 4/4/2016  
 RECOMP DATE

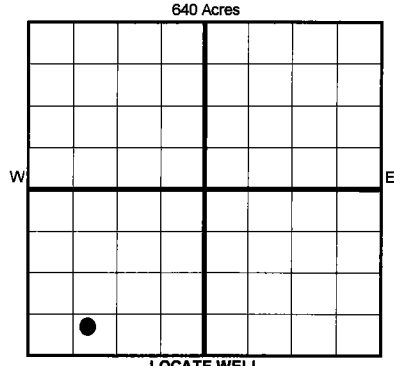

COUNTY Love SEC 23 TWP 7S RGE 1E  
 LEASE NAME Connie Sue 1-23H26 WELL NO. →  
 NW 1/4 SE 1/4 SW 1/4 SW 1/4 FSL OF 1/4 SEC 364' FWL OF 1/4 SEC 840'  
 ELEVATION 827' Ground 800' Latitude (if known) 33.926849°N Longitude (if known) 97.175391°W  
 OPERATOR NAME XTO Energy Inc. OTC/OCC OPERATOR NO. 21003  
 ADDRESS 210 Park Avenue, Suite 2350  
 CITY Oklahoma City STATE Oklahoma ZIP 73102

COMPLETION TYPE  
 SINGLE ZONE  
 MULTIPLE ZONE  
 COMMINGLED  
 LOCATION EXCEPTION ORDER NO. 651763 F.O.  
 INCREASED DENSITY ORDER NO. N/A

CASING & CEMENT (Form 1002C must be attached)

TYPE	SIZE	WEIGHT	GRADE	FEET	PSI	SAX	TOP OF CMT	
CONDUCTOR	20"	53	PE&B	107			Surface	
SURFACE	9 5/8"	36	J-55	1993		520	Surface	
INTERMEDIATE	7"	32	P-110	15,455		410	12,050	
PRODUCTION								
LINER	4 1/2"	15.1	P-110	13384-20050 6,666		555	13,409	
							TOTAL DEPTH	20,075'

PACKER @ \_\_\_\_\_ BRAND & TYPE \_\_\_\_\_ PLUG @ \_\_\_\_\_ TYPE \_\_\_\_\_ PLUG @ \_\_\_\_\_ TYPE \_\_\_\_\_  
 PACKER @ \_\_\_\_\_ BRAND & TYPE \_\_\_\_\_ PLUG @ \_\_\_\_\_ TYPE \_\_\_\_\_ PLUG @ \_\_\_\_\_ TYPE \_\_\_\_\_

COMPLETION & TEST DATA BY PRODUCING FORMATION 319WDFD

FORMATION	WOODFORD					
SPACING & SPACING ORDER NUMBER	640: 636739					
CLASS: Oil, Gas, Dry, Inj, Disp, Comm Disp, Svc	Oil					
PERFORATED INTERVALS	20 Stages 15,457-19,902'					
ACID/VOLUME	80,000 gals					
FRACTURE TREATMENT (Fluids/Prop Amounts)	235,979 BTW 842,940# 100 mesh 7,918,880# 40/70					

**AS SUBMITTED**

Reported to Frac Focus

Min Gas Allowable (165-10-17-7) OR  Gas Purchaser/Measurer First Sales Date  
 Oil Allowable (165-10-13-3)

INITIAL TEST DATA

INITIAL TEST DATE	4/24/2016			
OIL-BBL/DAY	637			
OIL-GRAVITY ( API)	47			
GAS-MCF/DAY	1803			
GAS-OIL RATIO CU FT/BBL	2830			
WATER-BBL/DAY	1731			
PUMPING OR FLOWING	Flowing			
INITIAL SHUT-IN PRESSURE	N/A			
CHOKE SIZE	18/64"			
FLOW TUBING PRESSURE	3650 FCP			

A record of the formations drilled through, and pertinent remarks are presented on the reverse. I declare that I have knowledge of the contents of this report and am authorized by my organization to make this report, which was prepared by me or under my supervision and direction, with the data and facts stated herein to be true, correct, and complete to the best of my knowledge and belief.

Debbie Waggoner 4/26/2016 405-319-3243  
 SIGNATURE NAME (PRINT OR TYPE) DATE PHONE NUMBER  
 210 Park Avenue, Suite 2350 Oklahoma City Ok 73102 debbie\_waggoner@xtoenergy.com  
 ADDRESS CITY STATE ZIP EMAIL ADDRESS

PLEASE TYPE OR USE BLACK INK ONLY  
FORMATION RECORD

Give formation names and tops, if available, or descriptions and thickness of formations drilled through. Show intervals cored or drillstem tested.

LEASE NAME CONNIE SUE WELL NO. 1-23H26

NAMES OF FORMATIONS	TOP
WOODFORD	15,233'

FOR COMMISSION USE ONLY

ITD on file  YES  NO

APPROVED \_\_\_\_\_ DISAPPROVED \_\_\_\_\_

2) Reject Codes \_\_\_\_\_  
\_\_\_\_\_  
\_\_\_\_\_  
\_\_\_\_\_

Were open hole logs run? \_\_\_ yes  no

Date Last log was run \_\_\_\_\_

Was CO<sub>2</sub> encountered? \_\_\_ yes  no at what depths? \_\_\_\_\_

Was H<sub>2</sub>S encountered? \_\_\_ yes  no at what depths? \_\_\_\_\_

Were unusual drilling circumstances encountered? \_\_\_ yes  no  
If yes, briefly explain below: \_\_\_\_\_

Other remarks: Irregular Section

\_\_\_\_\_  
\_\_\_\_\_  
\_\_\_\_\_  
\_\_\_\_\_

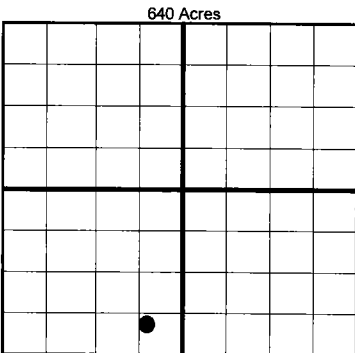

If more than three drainholes are proposed, attach a separate sheet indicating the necessary information.

Direction must be stated in degrees azimuth. Please note, the horizontal drainhole and its end point must be located within the boundaries of the lease or spacing unit.

Directional surveys are required for all drainholes and directional wells.

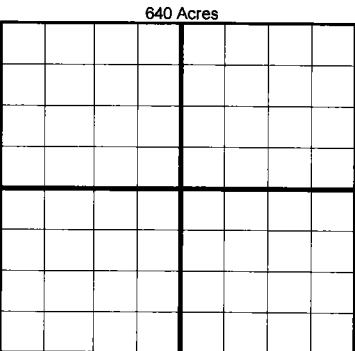

BOTTOM HOLE LOCATION FOR DIRECTIONAL HOLE

SEC	TWP	RGE	COUNTY
Spot Location			
1/4	1/4	1/4	1/4
Measured Total Depth		True Vertical Depth	BHL From Lease, Unit, or Property Line:

BOTTOM HOLE LOCATION FOR HORIZONTAL HOLE: (LATERALS)

LATERAL #1

SEC	TWP	RGE	COUNTY	Love
26	7S	1E		
Spot Location				
NW	SE	SE	SW	
1/4	1/4	1/4	1/4	
Depth of Deviation		Radius of Turn	Direction	FSL
14,179		1429.2'	166.2°	464'
Measured Total Depth		True Vertical Depth	BHL From Lease, Unit, or Property Line:	
20,075'		15,094'	464' FSL & 2108' FWL	

LATERAL #2

SEC	TWP	RGE	COUNTY
Spot Location			
1/4	1/4	1/4	1/4
Depth of Deviation		Radius of Turn	Direction
			Total Length
Measured Total Depth		True Vertical Depth	BHL From Lease, Unit, or Property Line:

LATERAL #3

SEC	TWP	RGE	COUNTY
Spot Location			
1/4	1/4	1/4	1/4
Depth of Deviation		Radius of Turn	Direction
			Total Length
Measured Total Depth		True Vertical Depth	BHL From Lease, Unit, or Property Line: