

OKLAHOMA CORPORATION COMMISSION
OIL & GAS CONSERVATION DIVISION
P.O. BOX 52000
OKLAHOMA CITY, OK 73152-2000
(Rule 165:10-3-1)

API NUMBER: 117 23679

Approval Date: 05/12/2016

Expiration Date: 11/12/2016

Straight Hole

Oil & Gas

PERMIT TO DRILL

WELL LOCATION: Sec: 20 Twp: 21N Rge: 8E

County: PAWNEE

SPOT LOCATION: ☐ SW ☐ NE ☐ NW ☐ SE

FEET FROM QUARTER: FROM NORTH FROM EAST

SECTION LINES: 375 1730

Lease Name: LUCINDA MARTIN

Well No: 13

Well will be 1730 feet from nearest unit or lease boundary.

Operator Name: MID-CON ENERGY OPERATING LLC

Telephone: 9187437575; 9187437

OTC/OCC Number: 23271 0

MID-CON ENERGY OPERATING LLC
2431 E 61ST ST STE 850
TULSA, OK 74136-1236

CHARLES R. OLMSTEAD
2431 E. 61ST ST., STE. 850
TULSA OK 74136

Formation(s) (Permit Valid for Listed Formations Only):

Name	Depth	Name	Depth
1 CLEVELAND	1550	6	
2		7	
3		8	
4		9	
5		10	

Spacing Orders: 609199

Location Exception Orders:

Increased Density Orders:

Pending CD Numbers:

Special Orders:

Total Depth: 2100

Ground Elevation: 962

Surface Casing: 300

Depth to base of Treatable Water-Bearing FM: 110

Under Federal Jurisdiction: No

Fresh Water Supply Well Drilled: No

Surface Water used to Drill: Yes

PIT 1 INFORMATION

Type of Pit System: ON SITE

Type of Mud System: WATER BASED

Chlorides Max: 5000 Average: 3000

Is depth to top of ground water greater than 10ft below base of pit? Y

Within 1 mile of municipal water well? N

Wellhead Protection Area? N

Pit is located in a Hydrologically Sensitive Area.

Category of Pit: 2

Liner not required for Category: 2

Pit Location is BED AQUIFER

Pit Location Formation: VAMOOSA

Approved Method for disposal of Drilling Fluids:

A. Evaporation/dewater and backfilling of reserve pit.

Notes:

This permit does not address the right of entry or settlement of surface damages.
The duration of this permit is SIX MONTHS, except as otherwise provided by Rule 165: 10-3-1.
Rule 165: 10-3-4 (c) (7) (e) - The Operator shall give 24 Hours notice by telephone to the appropriate District Office of the Conservation Division as to when Surface Casing will be run.

117 23679 LUCINDA MARTIN 13

Category	Description
HYDRAULIC FRACTURING	5/11/2016 - G71 - OCC 165:10-3-10 REQUIRES: 1) THE CHEMICAL DISCLOSURE OF HYDRAULIC FRACTURING INGREDIENTS FOR ALL WELLS BE REPORTED TO FRACFOCUS USING THE FOLLOWING LINK HTTP://FRACFOCUS.ORG/ WITH NOTICE GIVEN 48 HOURS IN ADVANCE OF FRACTURING TO THE LOCAL OCC DISTRICT OFFICE; AND, 2) PRIOR TO COMMENCEMENT OF FRACTURING OPERATIONS FOR HORIZONTAL WELLS, NOTICE ALSO GIVEN FIVE BUSINESS DAYS IN ADVANCE TO OFFSET OPERATORS WITH WELLS COMPLETED IN THE SAME COMMON SOURCE OF SUPPLY WITHIN 1/2 MILE.
SPACING - 609199	5/12/2016 - G75 - (UNIT) 20-21N-8E EST CLEVELAND FIELD UNIT TOP CGGV TO BASE ABCK

WELL LOCATION FOR: MidCon Energy

API 117-23679

R-8-E

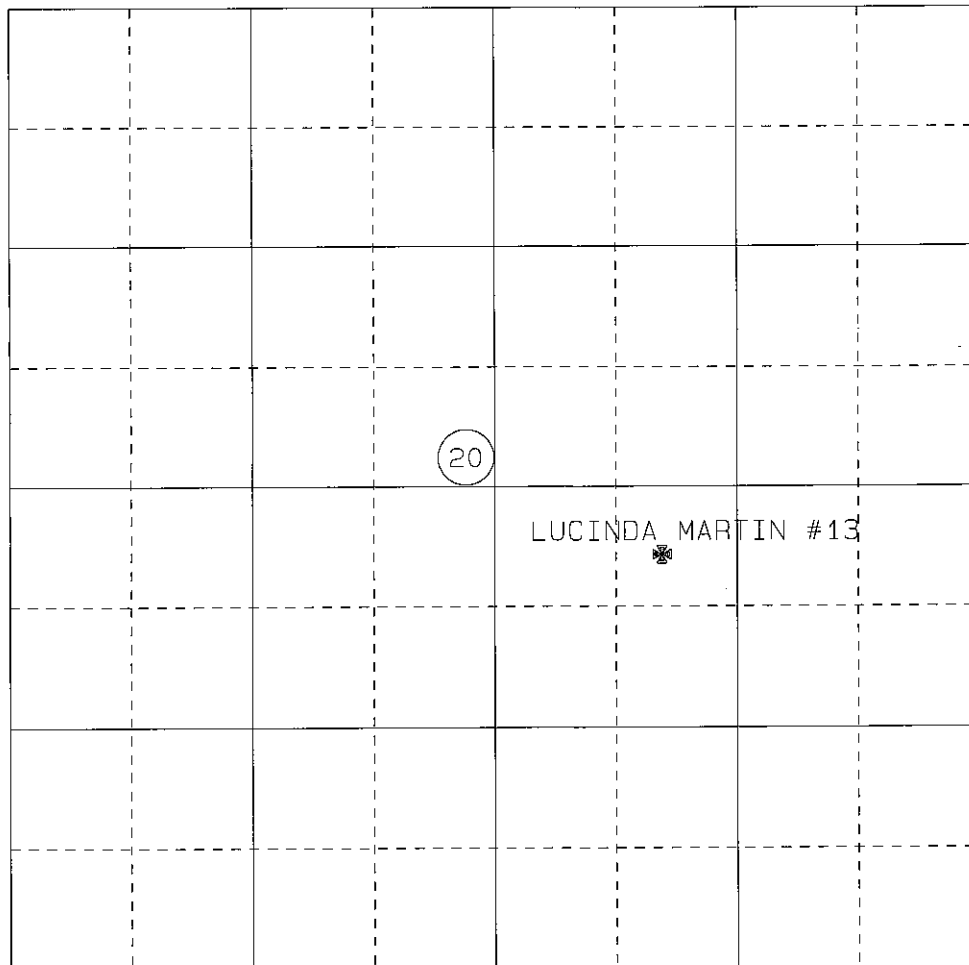

T
21
N

LUCINDA MARTIN #13
1730' F.E.L. &
375' F.N.L. SE/4
SEC 20-T21N-R8E
ELEV 962'

DUE CARE AND DILIGENCE HAVE BEEN EXERCISED IN THE
STAKING OF THIS WELL LOCATION ON THE GROUND
ACCORDING TO THE BEST OFFICIAL RECORDS AND MAPS
AVAILABLE TO US.
PLEASE REVIEW THIS PLAT AND NOTIFY US IMMEDIATELY
OF ANY DISCREPANCY

PENNCO ENGINEERING AND SURVEYING
P.O. BOX 657, BRISTOW, OK, 74010
(918) -367-2942; (918) -367-6099 fax
CA# 2074

DATE OF LAST SITE VISIT: 5-9-16
DATE OF REVISIONS: