

Oklahoma Corporation Commission
Oil & Gas Conservation Division
Post Office Box 52000
Oklahoma City, Oklahoma 73152-2000
Rule 165: 10-3-25

Form 1002A

API No.: 35083243520000

Completion Report

Spud Date: November 28, 2014

OTC Prod. Unit No.: 083-211842

Drilling Finished Date: December 18, 2014

1st Prod Date:

Completion Date: April 26, 2016

Drill Type: HORIZONTAL HOLE

Well Name: PLAGG 17-3-13 1 HW

Purchaser/Measurer:

Location: LOGAN 13 17N 3W
SE SE SW SW
200 FSL 1198 FWL of 1/4 SEC
Latitude: 34.9427 Longitude: -97.4749
Derrick Elevation: 0 Ground Elevation: 1096

First Sales Date:

Operator: SUNDANCE ENERGY OKLAHOMA LLC dba SEO LLC 22918

633 17TH ST STE 1950
DENVER , CO 80202-3620

Completion Type	
<input type="checkbox"/>	Single Zone
<input type="checkbox"/>	Multiple Zone
<input type="checkbox"/>	Commingled

Location Exception
Order No
There are no Location Exception records to display.

Increased Density
Order No
There are no Increased Density records to display.

Casing and Cement							
Type	Size	Weight	Grade	Feet	PSI	SAX	Top of CMT
SURFACE	9 5/8	36	J-55	547		400	SURFACE
PRODUCTION	7	26	P-110	6346		248	4525

Liner								
Type	Size	Weight	Grade	Length	PSI	SAX	Top Depth	Bottom Depth
LINER	4 1/2	11.6	P-110	4436	0	372	6131	10567

Total Depth: 10567

Packer	
Depth	Brand & Type
There are no Packer records to display.	

Plug	
Depth	Plug Type
There are no Plug records to display.	

Initial Test Data										
Test Date	Formation	Oil BBL/Day	Oil-Gravity (API)	Gas MCF/Day	Gas-Oil Ratio Cu FT/BBL	Water BBL/Day	Pumpin or Flowing	Initial Shut-In Pressure	Choke Size	Flow Tubing Pressure
There are no Initial Data records to display.										

Completion and Test Data by Producing Formation		
Formation Name: N/A	Code:	Class: TA

Formation	Top
COTTAGE GROVE	4565
HOGSHOOTER	4799
CHECKERBOARD	5005
BIG LIME	5316
4TH OSWEGO	5356
VERDIGRIS	5480
PINK LIME	5530
INOLA	5598
MISSISSIPPI LIME	5672
WOODFORD	5849

Were open hole logs run? No

Date last log run:

Were unusual drilling circumstances encountered? No

Explanation:

Other Remarks
WELL NOT COMPLETED DUE TO MARKET CONDITIONS

Lateral Holes
Sec: 13 TWP: 17N RGE: 3W County: LOGAN
NW NW NE NW
2466 FSL 1396 FWL of 1/4 SEC
Depth of Deviation: 5210 Radius of Turn: 330 Direction: 1 Total Length: 5357
Measured Total Depth: 10567 True Vertical Depth: 5875 End Pt. Location From Release, Unit or Property Line: 174

FOR COMMISSION USE ONLY
1133390
Status: Accepted

RECEIVED

APR 26 2016

Form 1002A Rev. 2009

API NO. 083-24352
OTC PROD. UNIT NO. 083-211842

PLEASE TYPE OR USE BLACK INK ONLY
NOTE:

Attach copy of original 1002A if recompletion or reentry.

OKLAHOMA CORPORATION COMMISSION
Oil & Gas Conservation Division
Post Office Box 52000
Oklahoma City, Oklahoma 73152-2000
Rule 165:10-3-25

OKLAHOMA CORPORATION COMMISSION

ORIGINAL AMENDED (Reason)

COMPLETION REPORT

TYPE OF DRILLING OPERATION
STRAIGHT HOLE DIRECTIONAL HOLE HORIZONTAL HOLE
SERVICE WELL

SPUD DATE 11/28/2014
DRLG FINISHED DATE 12/18/2014

If directional or horizontal, see reverse for bottom hole location.

COUNTY Logan SEC 13 TWP 17N RGE 3W
LEASE NAME Plagg 17-3-13 WELL NO. 1HW
SE 1/4 SE 1/4 SW 1/4 SW 1/4 FSL OF 1/4 SEC 200 FWL OF 1/4 SEC 1198
ELEVATIO N Derrick Ground 1096 Latitude (if known) 34.9427 Longitude (if known) -97.4749
OPERATOR NAME Sundance Energy Oklahoma dba SEO LLC OTC/OCC OPERATOR NO. 22918
ADDRESS 633 17th St., Suite 1950
CITY Denver STATE CO ZIP 80202

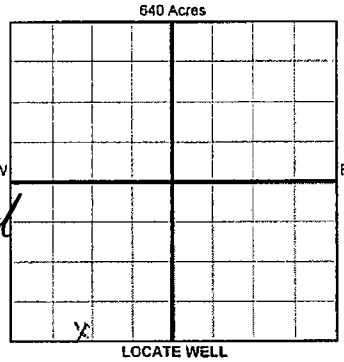

COMPLETION TYPE
SINGLE ZONE
MULTIPLE ZONE
Application Date
COMINGLED
Application Date
LOCATION
EXCEPTION ORDER
INCREASED DENSITY
ORDER NO.

Table with columns: TYPE, SIZE, WEIGHT, GRADE, FEET, PSI, SAX, TOP OF CMT. Rows include CONDUCTOR, SURFACE, INTERMEDIATE, PRODUCTION, LINER.

PACKER @ BRAND & TYPE PLUG @ TYPE PLUG @ TYPE
PACKER @ BRAND & TYPE PLUG @ TYPE PLUG @ TYPE

TOTAL DEPTH 10,567

COMPLETION & TEST DATA BY PRODUCING FORMATION

Table with columns: FORMATION, SPACING & SPACING ORDER NUMBER, CLASS, PERFORATED INTERVALS, ACID/VOLUME, FRACTURE TREATMENT.

AS SUBMITTED

Min Gas Allowable (165:10-17-7) Gas Purchaser/Measurer
OR First Sales Date
Oil Allowable (165:10-13-3)

Table with columns: INITIAL TEST DATE, OIL-BBL/DAY, OIL-GRAVITY (API), GAS-MCF/DAY, GAS-OIL RATIO CU FT/BBL, WATER-BBL/DAY, PUMPING OR FLOWING, INITIAL SHUT-IN PRESSURE, CHOKE SIZE, FLOW TUBING PRESSURE.

A record of the formations drilled through, and pertinent remarks are presented on the reverse. I declare that I have knowledge of the contents of this report and am authorized by my organization to make this report, which was prepared by me or under my supervision and direction, with the data and facts stated herein to be true, correct, and complete to the best of my knowledge and belief.

SIGNATURE Catherine A. Aniello DATE 4/26/16 PHONE NUMBER 720-390-6247
ADDRESS 633 17th St., Suite 1950 CITY Denver STATE CO ZIP 80202 EMAIL ADDRESS caniello@sundanceenergy.net

PLEASE TYPE OR USE BLACK INK ONLY
FORMATION RECORD

Give formation names and tops, if available, or descriptions and thickness of formations drilled through. Show intervals cored or drillstem tested.

LEASE NAME Plagg 17-3-13 WELL NO. 1HW

NAMES OF FORMATIONS	TOP
Cottage Grove	4,565
Hogshooter	4,799
Checkerboard	5,005
Big Lime	5,316
4th Oswego	5,356
Verdigris	5,480
Pink Lime	5,530
Inola	5,598
Miss. Lime	5,672
Woodford	5,849
All depths are TVD	

FOR COMMISSION USE ONLY

ITD on file YES NO

APPROVED _____ DISAPPROVED _____ 2) Reject Codes _____

Were open hole logs run? yes no

Date Last log was run _____

Was CO₂ encountered? yes no at what depths? _____

Was H₂S encountered? yes no at what depths? _____

Were unusual drilling circumstances encountered? yes no
If yes, briefly explain below _____

Other remarks: Well not completed due to market conditions

640 Acres

If more than three drainholes are proposed, attach a separate sheet indicating the necessary information.

Direction must be stated in degrees azimuth. Please note, the horizontal drainhole and its end point must be located within the boundaries of the lease or spacing unit.

Directional surveys are required for all drainholes and directional wells.

640 Acres

BOTTOM HOLE LOCATION FOR DIRECTIONAL HOLE

SEC	TWP	RGE	COUNTY
Spot Location	1/4	1/4	1/4
Measured Total Depth	True Vertical Depth		BHL From Lease, Unit, or Property Line:

BOTTOM HOLE LOCATION FOR HORIZONTAL HOLE: (LATERALS)

LATERAL #1

SEC	TWP	RGE	COUNTY
13	17N	3W	Logan
Spot Location	NE NW	NW 1/4	NW 1/4
Depth of Deviation	5,210	Radius of Turn	330.6
Measured Total Depth	10,567	True Vertical Depth	5,875
Direction <u>1 NW</u> Total Length <u>5,357</u>			
BHL From Lease, Unit, or Property Line: <u>174 5106' FSL & 3700' FEL</u>			

LATERAL #2

SEC	TWP	RGE	COUNTY
Spot Location	1/4	1/4	1/4
Depth of Deviation	Radius of Turn		Direction
Measured Total Depth	True Vertical Depth		Total Length
BHL From Lease, Unit, or Property Line:			

LATERAL #3

SEC	TWP	RGE	COUNTY
Spot Location	1/4	1/4	1/4
Depth of Deviation	Radius of Turn		Direction
Measured Total Depth	True Vertical Depth		Total Length
BHL From Lease, Unit, or Property Line:			