

Oklahoma Corporation Commission
 Oil & Gas Conservation Division
 Post Office Box 52000
 Oklahoma City, Oklahoma 73152-2000
 Rule 165: 10-3-25

Form 1002A

API No.: 35051239870001

Completion Report

Spud Date: October 01, 2015

OTC Prod. Unit No.: 051-216874

Drilling Finished Date: November 04, 2015

1st Prod Date: November 19, 2015

Amended

Completion Date: November 17, 2015

Amend Reason: REQUEST GAS ALLOWABLE

Drill Type: DIRECTIONAL HOLE

Min Gas Allowable: Yes

Well Name: TYE 1-25

Purchaser/Measurer: ONEOK

Location: GRADY 25 5N 6W
 SE NE SW SE
 930 FSL 1398 FEL of 1/4 SEC
 Derrick Elevation: 762 Ground Elevation: 0

First Sales Date: 11/19/2015

Operator: SHERIDAN PRODUCTION COMPANY LLC 22220

9 GREENWAY PLZ STE 1300
 HOUSTON, TX 77046-0922

Completion Type	
X	Single Zone
	Multiple Zone
	Commingled

Location Exception
Order No
There are no Location Exception records to display.

Increased Density
Order No
There are no Increased Density records to display.

Casing and Cement							
Type	Size	Weight	Grade	Feet	PSI	SAX	Top of CMT
SURFACE	10 3/4	40.5	J-55	1863		860	SURFACE
PRODUCTION	4 1/2	15.1	P-110	14408		1290	10000

Liner								
Type	Size	Weight	Grade	Length	PSI	SAX	Top Depth	Bottom Depth
There are no Liner records to display.								

Total Depth: 14408

Packer	
Depth	Brand & Type
There are no Packer records to display.	

Plug	
Depth	Plug Type
14311	PBTD

Initial Test Data										
Test Date	Formation	Oil BBL/Day	Oil-Gravity (API)	Gas MCF/Day	Gas-Oil Ratio Cu FT/BBL	Water BBL/Day	Pumpin or Flowing	Initial Shut-In Pressure	Choke Size	Flow Tubing Pressure
Nov 22, 2015	SYCAMORE	55	52	2087	37945	316	FLOWING	4400	16/64	900

Completion and Test Data by Producing Formation			
Formation Name: SYCAMORE	Code: 352SCMR	Class: GAS	
Spacing Orders		Perforated Intervals	
Order No	Unit Size	From	To
123502	640	13966	14200
Acid Volumes		Fracture Treatments	
476 BARRELS 20% ACID, 13,107 BARRELS WATER		There are no Fracture Treatments records to display.	

Formation	Top
1ST DEESE (ABERNATHY)	9265
2ND DEESE (PHAROAH)	9485
3RD DEESE (GIBSON)	9766
4TH DEESE (HART)	9997
5TH DEESE (OSBORN)	10233
PRIMROSE	10798
SPRINGER	11193
BOATWRIGHT	11736
SYCAMORE	13963
WOODFORD	14228
HUNTON	14493

Were open hole logs run? Yes

Date last log run: October 31, 2015

Were unusual drilling circumstances encountered? No

Explanation:

Other Remarks
FILING TO REQUEST MINIMUM GAS ALLOWABLE; GAS PURCHASER / MEASURER: ONEOK FIELD SERVICES - 20618. SUCCESSFUL NEW DRILL; SYCAMORE PRODUCER. IRREGULAR UNIT ALSO E2 OF 36 - 5N - 6W

Bottom Holes

Sec: 25 TWP: 5N RGE: 6W County: GRADY

SE NE SW SE

811 FSL 1337 FWL of 1/4 SEC

Depth of Deviation: 0 Radius of Turn: 0 Direction: 0 Total Length: 0

Measured Total Depth: 14408 True Vertical Depth: 14406 End Pt. Location From Release, Unit or Property Line: 1303

FOR COMMISSION USE ONLY

1133372

Status: Accepted

RECEIVED

Form 1002A Rev. 2009

APR 25 2016

OKLAHOMA CORPORATION COMMISSION

API NO. 051-23987
OTC PROD. UNIT NO. 051-216874

PLEASE TYPE OR USE BLACK INK ONLY
NOTE: Attach copy of original 1002A if recompletion or reent

OKLAHOMA CORPORATION COMMISSION
Oil & Gas Conservation Division
Post Office Box 52000
Oklahoma City, Oklahoma 73152-2000
Rule 165:10-3-25

ORIGINAL
 AMENDED
Reason Amended **REQUEST GAS ALLOWABLE**

COMPLETION REPORT

TYPE OF DRILLING OPERATION
 STRAIGHT HOLE DIRECTIONAL HOLE HORIZONTAL HOLE
 SERVICE WELL

SPUD DATE 10/1/2015

DRLG FINISHED DATE 11/4/2015

WELL COMPLETION DATE 11/17/15

1ST PROD DATE 11/19/15

RECOMP DATE

COUNTY GRADY SEC 25 TWP 5N RGE 6W

LEASE NAME TYE WELL NO. 1-25

SE 1/4 NE 1/4 SW 1/4 SE 1/4 FSL 930 SW 1/4 SEC 1398

ELEVATION 762 Ground Latitude if Known Longitude if Known

OPERATOR NAME SHERIDAN PRODUCTION COMPANY, LLC OTC/OCC OPERATOR NO. 22220-0

ADDRESS 9 GREENWAY PLAZA, SUITE 1300

CITY HOUSTON STATE TX ZIP 77046

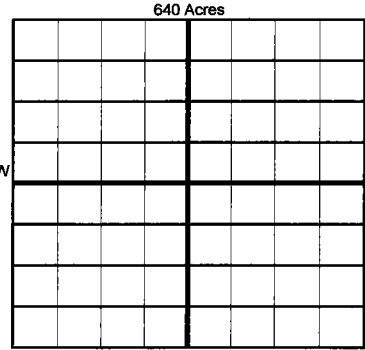

LOCATE WELL

COMPLETION TYPE

Table with completion type options: SINGLE ZONE (checked), MULTIPLE ZONE, COMMINGLED, LOCATION EXCEPTION, INCREASED DENSITY.

CASING & CEMENT (Form 1002C must be attached)

Table with columns: TYPE, SIZE, WEIGHT, GRADE, FEET, PSI, SAX, TOP OF CMT. Rows include Conductor, Surface, Intermediate, Production, and Liner.

PACKER @ BRAND & TYPE PLUG @ TYPE PLUG @ 14311 TYPE PBTD TOTAL DEPTH 14408

COMPLETION & TEST DATA BY PRODUCING FORMATION

Table with columns: FORMATION, SPACING & SPACING ORDER NUMBER, CLASS, PERFORATED INTERVALS, ACID/VOLUME, FRACTURE TREATMENT. Includes handwritten '352 SCMR' and a large 'AS SUBMITTED' stamp.

Oil Allowable (165:10-13-3) Minimum Gas Allowable (165:10-17-7) Gas Purchaser/Measurer ONEOK 1st Sales Date 11/19/15

INITIAL TEST DATA

Table with columns: INITIAL TEST DATE, OIL-BBL/DAY, OIL-GRAVITY (API), GAS-MCF/DAY, GAS-OIL RATIO CU FT/BBL, WATER-BBL/DAY, PUMPING OR FLOWING, INITIAL SHUT-IN PRESSURE, CHOKE SIZE, FLOW TUBING PRESSURE.

A record of the formations drilled through, and pertinent remarks are presented on the reverse. I declare that I have knowledge of the contents of this report and am authorized by my organization to make this report, which was prepared by me or under my supervision and direction, with the data and facts stated herein to be true, correct, and complete to the best of my knowledge and belief.

SIGNATURE: Joyce A. Williams, NAME (PRINT OR TYPE): JOYCE A WILLIAMS, DATE: 4/20/2016, PHONE NUMBER: 713-548-1070, ADDRESS: 9 GREENWAY PLAZA, SUITE 1300 HOUSTON TX 77046, EMAIL ADDRESS: jwilliams@sheridanproduction.com

PLEASE TYPE OR USE BLACK INK ONLY
FORMATION RECORD

Give formation names and tops, if available, or descriptions and thickness of formations drilled through. Show intervals cored or drillstem tested.

LEASE NAME TYE WELL NO. 1-25

NAMES OF FORMATIONS	TOP
1ST DEESE (ABERNATHY)	9265
2ND DEESE (PHAROAH)	9485
3RD DEESE (GIBSON)	9766
4TH DEESE (HART)	9997
5TH DEESE (OSBORNE)	10233
PRIMROSE	10798
SPRINGER	11193
BOATWRIGHT	11736
SYCAMORE	13963
WOODFORD	14228
HUNTON	14493

FOR COMMISSION USE ONLY

ITD on file YES NO

APPROVED _____ DISAPPROVED _____

2) Reject Codes _____

Were open hole logs run? yes no

Date Last log was run 10/31/2015

Was CO₂ encountered? yes no at what depths? _____

Was H₂S encountered? yes no at what depths? _____

Were unusual drilling circumstances encountered? yes no
If yes, briefly explain below: _____

Other remarks: FILING TO REQUEST MINIMUM GAS ALLOWABLE; GAS PURCHASER/MEASURER: ONEOK FIELD SERVICES - 20618
SUCCESSFUL NEW DRILL; SYCAMORE PRODUCER
IRR UNIT ALSO E2 OF 36-5N-6W

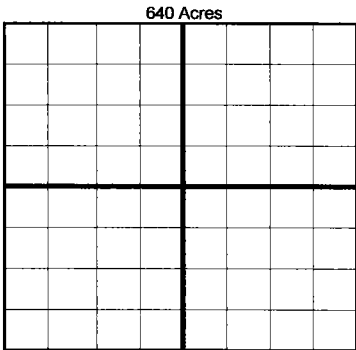

If more than three drainholes are proposed, attach a separate sheet indicating the necessary information.

Direction must be stated in degrees azimuth.
Please note, the horizontal drainhole and its end point must be located within the boundaries of the lease or spacing unit.

Directional surveys are required for all drainholes and directional wells.

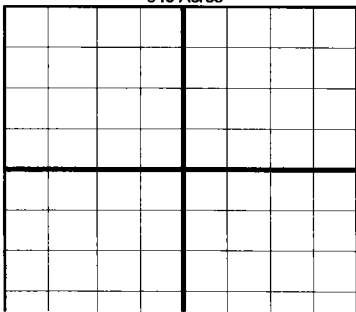

BOTTOM HOLE LOCATION FOR DIRECTIONAL HOLE

SEC	25	TWP	05N	RGE	06W	COUNTY	GRADY							
Spot Location						SE 1/4	NE 1/4	SW 1/4	SE 1/4	Feet From 1/4 Sec Lines	811	FSL	1337	FWL
Measured Total Depth				True Vertical Depth		BHL From Lease, Unit, or Property Line:								
14408				14406		1303 FWL								

BOTTOM HOLE LOCATION FOR HORIZONTAL HOLE: (LATERALS)

LATERAL #1

SEC	TWP	RGE	COUNTY							
Spot Location				1/4	1/4	1/4	1/4	Feet From 1/4 Sec Lines	FSL	FWL
Depth of Deviation		Radius of Turn		Direction		Total Length				
Measured Total Depth		True Vertical Depth		End Pt Location From Lease, Unit or Property Line:						

LATERAL #2

SEC	TWP	RGE	COUNTY							
Spot Location				1/4	1/4	1/4	1/4	Feet From 1/4 Sec Lines	FSL	FWL
Depth of Deviation		Radius of Turn		Direction		Total Length				
Measured Total Depth		True Vertical Depth		End Pt Location From Lease, Unit or Property Line:						

LATERAL #3

SEC	TWP	RGE	COUNTY							
Spot Location				1/4	1/4	1/4	1/4	Feet From 1/4 Sec Lines	FSL	FWL
Depth of Deviation		Radius of Turn		Direction		Total Length				
Measured Total Depth		True Vertical Depth		End Pt Location From Lease, Unit or Property Line:						

RECEIVED

1016EZ

Form 1002A Rev. 2009

APR 25 2016

OKLAHOMA CORPORATION COMMISSION

OKLAHOMA CORPORATION COMMISSION
Oil & Gas Conservation Division
Post Office Box 52000
Oklahoma City, Oklahoma 73152-2000
Rule 165:10-3-25

COMPLETION REPORT

API NO. 051-23987
PLEASE TYPE OR USE BLACK INK ONLY
NOTE: Attach copy of original 1002A if recompletion or reent

ORIGINAL
 AMENDED
Reason Amended
REQUEST GAS ALLOWABLE

TYPE OF DRILLING OPERATION
 STRAIGHT HOLE DIRECTIONAL HOLE HORIZONTAL HOLE
 SERVICE WELL

If directional or horizontal, see reverse for bottom hole location.

COUNTY GRADY SEC 25 TWP 5N RGE 6W
LEASE NAME TYE WELL NO. 1-25
SE 1/4 NE 1/4 SW 1/4 SE 1/4 FSL 930 1/4 SEC 1398
ELEVATION 762 Ground Latitude if Known FEL Longitude if Known
OPERATOR NAME SHERIDAN PRODUCTION COMPANY, LLC OTC/OCC OPERATOR NO. 22220-0
ADDRESS 9 GREENWAY PLAZA, SUITE 1300
CITY HOUSTON STATE TX ZIP 77046

SPUD DATE 10/1/2015
DRLG FINISHED DATE 11/4/2015
WELL COMPLETION DATE 11/17/15
1ST PROD DATE 11/19/15
RECOMP DATE

640 Acres
LOCATE WELL

COMPLETION TYPE
 SINGLE ZONE
 MULTIPLE ZONE
Application Date
 COMMINGLED
Application Date
LOCATION EXCEPTION ORDER NO.
INCREASED DENSITY ORDER NO. 637847

CASING & CEMENT (Form 1002C must be attached)

TYPE	SIZE	WEIGHT	GRADE	FEET	PSI	SAX	TOP OF CMT
Conductor							
Surface	10-3/4	40.5	J-55	1863		860	SURF
Intermediate							
Production	4-1/2	15.1	P-110	14408		1290	10000
Liner							

PACKER @ _____ BRAND & TYPE _____ PLUG @ _____ TYPE _____ PLUG @ 14311 TYPE PBDT TOTAL DEPTH 14408
PACKER @ _____ BRAND & TYPE _____ PLUG @ _____ TYPE _____ PLUG @ _____ TYPE _____

COMPLETION & TEST DATA BY PRODUCING FORMATION

352 SCMR Irregular 640-acre unit: E2 Sec. 25 & E2 Sec 36

FORMATION	SYCAMORE
SPACING & SPACING ORDER NUMBER	123502/640
CLASS: Oil, Gas, Dry, Inj, Disp, Comm Disp, Svc	GAS
PERFORATED INTERVALS	13966 14200
ACID/VOLUME	acid w/476 bbls; 20%
FRACTURE TREATMENT (Fluids/Prop Amounts)	HCl, 13107bbls wtr NA

AS SUBMITTED

Oil Allowable (165:10-13-3) Minimum Gas Allowable (165:10-17-7) Gas Purchaser/Measurer ONEOK 1st Sales Date 11/19/15

INITIAL TEST DATA

INITIAL TEST DATE	11/22/2015
OIL-BBL/DAY	55
OIL-GRAVITY (API)	52
GAS-MCF/DAY	2087
GAS-OIL RATIO CU FT/BBL	37945
WATER-BBL/DAY	316
PUMPING OR FLOWING	FLOWING
INITIAL SHUT-IN PRESSURE	4400
CHOKE SIZE	16/64
FLOW TUBING PRESSURE	900

SCANNED

A record of the formations drilled through, and pertinent remarks are presented on the reverse. I declare that I have knowledge of the contents of this report and am authorized by my organization to make this report, which was prepared by me or under my supervision and direction, with the data and facts stated herein to be true, correct, and complete to the best of my knowledge and belief.

SIGNATURE: *Joyce A. Williams* NAME (PRINT OR TYPE) JOYCE A WILLIAMS DATE 4/20/2016 PHONE NUMBER 713-548-1070
ADDRESS 9 GREENWAY PLAZA, SUITE 1300 CITY HOUSTON STATE TX ZIP 77046 EMAIL ADDRESS jwilliams@sheridanproduction.com

EZ

OR