

OKLAHOMA CORPORATION COMMISSION
OIL & GAS CONSERVATION DIVISION
P.O. BOX 52000
OKLAHOMA CITY, OK 73152-2000
(Rule 165:10-3-1)

API NUMBER: 095 20648

Approval Date: 03/06/2015

Expiration Date: 09/06/2015

Horizontal Hole Oil & Gas

PERMIT TO DRILL

WELL LOCATION: Sec: 11 Twp: 5S Rge: 6E

County: MARSHALL

SPOT LOCATION: ☐ NW ☐ NW ☐ NE ☐ NW

FEET FROM QUARTER: FROM NORTH FROM WEST

SECTION LINES: 250 1340

Lease Name: FLENNIKEN

Well No: 3-11H2

Well will be 250 feet from nearest unit or lease boundary.

Operator Name: XTO ENERGY INC

Telephone: 8178853255; 8178852

OTC/OCC Number: 21003 0

XTO ENERGY INC
810 HOUSTON ST
FORT WORTH, TX 76102-6203

FLENNIKEN ESTATE C/O LARRY LEE FLENNIKEN
1743 EAST 59TH PLACE
TULSA OK 74105

Formation(s) (Permit Valid for Listed Formations Only):

Name	Depth	Name	Depth
1 WOODFORD	6025	6	
2		7	
3		8	
4		9	
5		10	

Spacing Orders: 599549

Location Exception Orders:

Increased Density Orders:

Pending CD Numbers: 201501034
201501029

Special Orders:

Total Depth: 11900

Ground Elevation: 731

Surface Casing: 1990

Depth to base of Treatable Water-Bearing FM: 550

Under Federal Jurisdiction: No

Fresh Water Supply Well Drilled: Yes

Surface Water used to Drill: Yes

PIT 1 INFORMATION

Type of Pit System: ON SITE

Type of Mud System: AIR

Is depth to top of ground water greater than 10ft below base of pit? Y

Within 1 mile of municipal water well? N

Wellhead Protection Area? N

Pit is not located in a Hydrologically Sensitive Area.

Category of Pit: 4

Liner not required for Category: 4

Pit Location is NON HSA

Pit Location Formation: CADD0

Mud System Change to Water-Based or Oil-Based Mud Requires an Amended Intent (Form 1000).

Approved Method for disposal of Drilling Fluids:

A. Evaporation/dewater and backfilling of reserve pit.

D. One time land application -- (REQUIRES PERMIT)

PERMIT NO: 15-29645

H. SEE MEMO

This permit does not address the right of entry or settlement of surface damages.

The duration of this permit is SIX MONTHS, except as otherwise provided by Rule 165: 10-3-1.

Rule 165: 10-3-4 (c) (7) (e) - The Operator shall give 24 Hours notice by telephone to the appropriate District Office of the Conservation Division as to when Surface Casing will be run.

PIT 2 INFORMATION

Type of Pit System: CLOSED Closed System Means Steel Pits

Type of Mud System: WATER BASED

Chlorides Max: 8000 Average: 5000

Is depth to top of ground water greater than 10ft below base of pit? Y

Within 1 mile of municipal water well? N

Wellhead Protection Area? N

Pit is not located in a Hydrologically Sensitive Area.

Category of Pit: C

Liner not required for Category: C

Pit Location is NON HSA

Pit Location Formation: CADDO

PIT 3 INFORMATION

Type of Pit System: CLOSED Closed System Means Steel Pits

Type of Mud System: OIL BASED

Chlorides Max: 300000 Average: 200000

Is depth to top of ground water greater than 10ft below base of pit? Y

Within 1 mile of municipal water well? N

Wellhead Protection Area? N

Pit is not located in a Hydrologically Sensitive Area.

Category of Pit: C

Liner not required for Category: C

Pit Location is NON HSA

Pit Location Formation: CADDO

HORIZONTAL HOLE 1

Sec 02 Twp 5S Rge 6E County MARSHALL

Spot Location of End Point: NE NW NE NW

Feet From: NORTH 1/4 Section Line: 1

Feet From: WEST 1/4 Section Line: 1800

Depth of Deviation: 5218

Radius of Turn: 1000

Direction: 2

Total Length: 5111

Measured Total Depth: 11900

True Vertical Depth: 6400

End Point Location from Lease,

Unit, or Property Line: 1

Notes:

Category

Description

DEEP SURFACE CASING

3/4/2015 - G71 - APPROVED; NOTIFY OCC FIELD INSPECTOR IMMEDIATELY FOR ANY LOSS OF CIRCULATION OR FAILURE TO CIRCULATE CEMENT TO SURFACE ON CONDUCTOR OR SURFACE CASING

MEMO

3/4/2015 - G71 - PIT 2 & 3 - CLOSED SYSTEM=STEEL PITS PER OPERATOR REQUEST; PIT 3 - OBM TO VENDOR, OBM CUTTINGS PER DISTRICT

This permit does not address the right of entry or settlement of surface damages.

095 20648 FLENNIKEN 3-11H2

The duration of this permit is SIX MONTHS, except as otherwise provided by Rule 165: 10-3-1.

Rule 165: 10-3-4 (c) (7) (e) - The Operator shall give 24 Hours notice by telephone to the appropriate District

Office of the Conservation Division as to when Surface Casing will be run.

Category	Description
PENDING CD - 201501029	3/6/2015 - G75 - (E.O.) 2-5S-6E X599549 WDFD 3 WELLS XTO ENERGY INC. REC 3-3-2015 (DECKER)
PENDING CD - 201501034	3/6/2015 - G75 - (E.O.) X599549 WDFD SHL 250 FNL, 1340 FWL 11-5S-6E COMPL. INT. NCT 165 FSL, NCT 165 FNL, NCT 1750 FWL 2-5S-6E XTO ENERGY INC. REC 3-3-2015 (DECKER)
SPACING - 599549	3/6/2015 - G75 - (640) 2-5S-6E EXT 562312 WDFD, OTHERS

FLENNIKEN 3-11H2

SECTION 11

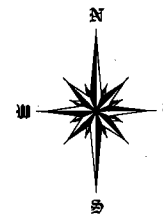
TOWNSHIP 5 SOUTH, RANGE 6 EAST
MARSHALL COUNTY, OKLAHOMA

OPERATOR:

XTO
ENERGY
a subsidiary of Exxon Mobil

LEGEND:

- EXISTING WELL HEAD/PRODUCTION WELL
 PROPOSED SURFACE HOLE (PSHL)
 SECTION CORNER
 PROPOSED LANDING POINT (LP)
 PROPOSED BOTTOM HOLE (PBHL)
 DRILLING UNIT

Line Table		
Line #	Azimuth	Length
L1	047.358769	617.88
L2	359.668531	5110.78



NOTES:
 1. This survey does not represent a boundary survey. It is for Geographical Information Systems (GIS) purposes only as instructed by the client and is not to be relied upon for the establishment of fences, buildings or other further improvement lines. Positions were taken with Survey Grade RTK GPS and NGS OPUS processed control using the NAD27 Oklahoma South State Plane Coordinate System.
 2. Bottom hole information provided by operator listed, not surveyed and corner coordinates are taken from points surveyed in field.

I, Chad Fox, a duly registered Professional Land Surveyor in the State of OKLAHOMA, do hereby certify that the drawing shown hereon was completed and represents a good and accurate survey made upon the ground by me or under my direct supervision.

CHAD FOX P.L.S. NO. 1758
 C.O.A. NO. 6186 EX. DATE: 31JAN14

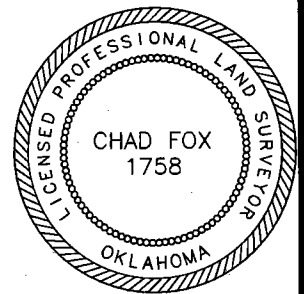

CDF AND ASSOCIATES, LLC.

208 Dewey Ave. Poteau, OK 74953 (918) 649-3303
 Certificate of Authorization No. 6186

JOB NO: XTO/WP14/FLENNIKEN 3-11H2 DRAWN BY: LD
 DATE: 01/OCT/14 REV: B SCALE: 1" = 1,000' SHT NO. 1

Surface Hole Location: 250' From North Line Section 11
 1340' From West Line Section 11

Latitude: N34.142691° (NAD 27)
 Longitude: W96.648918° (NAD 27)
 Latitude: N34.142787° (NAD 83)
 Longitude: W96.649195° (NAD 83)

Ground Elev: 731.0

Landing Point Location: 165' From South Line Section 2
 1800' From West Line Section 2

Bottom Hole Location: 0' From North Line Section 2
 1800' From West Line Section 2

Drilling Unit: Section 2, T5S, R6E

Operator: XTO Energy, Inc.

Best Accessibility to
 Location: From East

Distance & Direction from
 Hwy Jct or Town:
 From the intersection of
 Hwy 99 and Linn Rd. go
 East 5.8mi on Linn Rd.
 then 2.0mi North on
 Moore Rd to Access Rd.
 Well Location to the West.

BOTTOM HOLE
 0' FNL - 1800' FWL
 NAD - 27
 Lat: N034°09'28.32"
 Lon: W096°38'50.17"
 Lat: N034.157868
 Lon: W096.647268
 N: 302798.97
 E: 2409233.71

LANDING POINT
 165' FSL - 1800' FWL
 NAD - 27
 Lat: N034°08'37.77"
 Lon: W096°38'50.63"
 Lat: N034.143824
 Lon: W096.647397
 N: 297688.27
 E: 2409263.27

SURFACE LOCATION
 250' FNL - 1340' FWL
 NAD - 27
 Lat: N034°08'33.69"
 Lon: W096°38'56.10"
 Lat: N034.142691
 Lon: W096.648918
 N: 297269.71
 E: 2408808.76