

OKLAHOMA CORPORATION COMMISSION
OIL & GAS CONSERVATION DIVISION
P.O. BOX 52000
OKLAHOMA CITY, OK 73152-2000
(Rule 165:10-3-1)

API NUMBER: 019 26172

Approval Date: 03/05/2015
Expiration Date: 09/05/2015

Horizontal Hole Oil & Gas

PERMIT TO DRILL

WELL LOCATION: Sec: 31 Twp: 2S Rge: 3W

County: CARTER

SPOT LOCATION: NE NW NW NW

FEET FROM QUARTER: FROM NORTH FROM WEST

SECTION LINES: 250 600

Lease Name: WYNELL

Well No: 1-31-6XH

Well will be 250 feet from nearest unit or lease boundary.

Operator Name: CONTINENTAL RESOURCES INC

Telephone: 4052349000; 4052349

OTC/OCC Number: 3186 0

CONTINENTAL RESOURCES INC
PO BOX 269000
OKLAHOMA CITY, OK 73126-9000

MARVIN & WYNELL HATCHETT REVOCABLE TRUST
P.O. BOX 1389
ARLINGTON TX 73402

Formation(s) (Permit Valid for Listed Formations Only):

Name	Depth	Name	Depth
1 MISSISSIPPIAN	10894	6	
2 WOODFORD	11161	7	
3 HUNTON	11688	8	
4		9	
5		10	

Spacing Orders: No Spacing

Location Exception Orders:

Increased Density Orders:

Pending CD Numbers: 201501020
201501018
201501021
201501024

Special Orders:

Total Depth: 20684

Ground Elevation: 1077

Surface Casing: 1500

Depth to base of Treatable Water-Bearing FM: 350

Under Federal Jurisdiction: No

Fresh Water Supply Well Drilled: No

Surface Water used to Drill: Yes

PIT 1 INFORMATION

Type of Pit System: ON SITE

Type of Mud System: WATER BASED

Chlorides Max: 3000 Average: 2500

Is depth to top of ground water greater than 10ft below base of pit? Y

Within 1 mile of municipal water well? N

Wellhead Protection Area? N

Pit is located in a Hydrologically Sensitive Area.

Category of Pit: 2

Liner not required for Category: 2

Pit Location is BED AQUIFER

Pit Location Formation: GARBER

Approved Method for disposal of Drilling Fluids:

A. Evaporation/dewater and backfilling of reserve pit.

D. One time land application -- (REQUIRES PERMIT) PERMIT NO: 15-29623

H. PIT 2 - 20-MIL LINER REQUIRED, OBM TO VENDOR, OBM CUTTINGS PER DISTRICT

This permit does not address the right of entry or settlement of surface damages.

The duration of this permit is SIX MONTHS, except as otherwise provided by Rule 165: 10-3-1.

Rule 165: 10-3-4 (c) (7) (e) - The Operator shall give 24 Hours notice by telephone to the appropriate District Office of the Conservation Division as to when Surface Casing will be run.

PIT 2 INFORMATION

Type of Pit System: ON SITE
 Type of Mud System: OIL BASED
 Chlorides Max: 300000 Average: 250000
 Is depth to top of ground water greater than 10ft below base of pit? Y
 Within 1 mile of municipal water well? N
 Wellhead Protection Area? N
 Pit is located in a Hydrologically Sensitive Area.

Category of Pit: 3
 Liner required for Category: 3
 Pit Location is BED AQUIFER
 Pit Location Formation: GARBER

HORIZONTAL HOLE 1

Sec 06 Twp 3S Rge 3W County CARTER
 Spot Location of End Point: S2 S2 SW SW
 Feet From: SOUTH 1/4 Section Line: 30
 Feet From: WEST 1/4 Section Line: 660
 Depth of Deviation: 10131
 Radius of Turn: 478
 Direction: 179
 Total Length: 9802
 Measured Total Depth: 20684
 True Vertical Depth: 14276
 End Point Location from Lease,
 Unit, or Property Line: 30

Additional Surface Owner	Address	City, State, Zip
GRIFFIN PROPERTIES OKC LLC	P.O. BOX 1389	ARDMORE, OK 73402
STEVEN LEE HOWARD	849 BRONCO ROAD	WILSON, OK 73463
ROBERT OR JANE HIGHTOWER	100 N. PLAZA DRIVE	LITTLE ROAD, AR 72205

Notes:

Category	Description
DEEP SURFACE CASING	2/24/2015 - G64 - APPROVED; NOTIFY OCC FIELD INSPECTOR IMMEDIATELY FOR ANY LOSS OF CIRCULATION OR FAILURE TO CIRCULATE CEMENT TO SURFACE ON CONDUCTOR OR SURFACE CASING
PENDING CD - 201501018	2/25/2015 - G75 - (E.O.)(640) 6-3S-3W VAC 199701 SCMR, OTHERS ** EXT (VER) 627067 MSSP, WDFD, HNTN, OTHERS EST (HOR) OTHERS CONTINENTAL RESOURCES, INC. REC 3-3-2015 (DECKER) ** S/B VAC 199701 SCMR, HNTN, OTHERS; TO BE CORRECTED AT HEARING ON 3-3-2015 PER ATTORNEY FOR OPERATOR
PENDING CD - 201501020	2/25/2015 - G75 - (E.O.)(640) 31-2S-3W VAC 199701 SCMR, OTHERS ** EXT (VER) 627067 MSSP, WDFD, HNTN, OTHERS EST (HOR) OTHERS CONTINENTAL RESOURCES, INC. REC 3-3-2015 (DECKER) ** S/B VAC 199701 SCMR, HNTN, OTHERS; TO BE CORRECTED AT HEARING ON 3-3-2015 PER ATTORNEY FOR OPERATOR

This permit does not address the right of entry or settlement of surface damages.
 The duration of this permit is SIX MONTHS, except as otherwise provided by Rule 165: 10-3-1.
 Rule 165: 10-3-4 (c) (7) (e) - The Operator shall give 24 Hours notice by telephone to the appropriate District Office of the Conservation Division as to when Surface Casing will be run.

Category	Description
PENDING CD - 201501021	2/25/2015 - G75 - (E.O.) 31-2S-3W & 6-3S-3W EST MULTIUNIT HORIZONTAL WELL X201501020 MSSP, WDFD, HNTN 31-2S-3W X201501018 MSSP, WDFD, HNTN 6-3S-3W (MSSP, HNTN ASSOCIATED COMMON SOURCES OF SUPPLY TO WDFD) 47.97% 31-2S-3W 52.03% 6-3S-3W CONTINENTAL RESOURCES, INC. REC 3-3-2015 (DECKER)
PENDING CD - 201501024	2/25/2015 - G75 - (E.O.) 31-2S-3W & 6-3S-3W X201501020 MSSP, WDFD, HNTN 31-2S-3W X201501018 MSSP, WDFD, HNTN 6-3S-3W SHL NCT 150 FNL, NCT 330 FWL 31-2S-3W COMPL. INT. (31-2S-3W) NCT 150 FNL, NCT 0 FSL, NCT 330 FWL COMPL. INT. (6-3S-3W) NCT 0 FNL, NCT 150 FSL, NCT 330 FWL CONTINENTAL RESOURCES, INC. REC 3-3-2015 (DECKER)

This permit does not address the right of entry or settlement of surface damages.
 The duration of this permit is SIX MONTHS, except as otherwise provided by Rule 165: 10-3-1.
 Rule 165: 10-3-4 (c) (7) (e) - The Operator shall give 24 Hours notice by telephone to the appropriate District
 Office of the Conservation Division as to when Surface Casing will be run.

API 019-26192

OKLAHOMA CORPORATION COMMISSION
OIL & GAS CONSERVATION DIVISION
P.O. BOX 52000
OKLAHOMA CITY, OK 73152-2000
(Rule 165:10-3-1)

API NUMBER: 000 00000

Horizontal Hole Oil & Gas

Approval Date:
Expiration Date:

PERMIT TO DRILL

WELL LOCATION: Sec: 31 Twp: 2S Rge: 3W County: CARTER
SPOT LOCATION: NE NW NW NW FROM NORTH FROM WEST
SECTION LINES: 250 600

Application for
Intent to Drill

Lease Name: WYNELL Well No: 1-31-6XH Well will be 250 feet from nearest unit or lease boundary.

Operator Name: CONTINENTAL RESOURCES INC Telephone: 4052349000; 4052349 OTC/OCC Number: 3186 0

CONTINENTAL RESOURCES INC
PO BOX 269000
OKLAHOMA CITY, OK 73126-9000

MARVIN & WYNELL HATCHETT REVOCABLE TRUST
PO BOX 1389
ARLINGTON TX 73402

Formation(s) (Permit Valid for Listed Formations Only):

Name	Depth	Name	Depth
1		6	
2 MISSISSIPPIAN	10894	7	
3 WOODFORD	11161	8	
4 HUNTON	11688	9	
5		10	

Spacing Orders: No Spacing Location Exception Orders: Increased Density Orders:

Pending CD Numbers: 201501020 } E.O. Hearings 3-3-2015
201501018
201501021
201501024

Total Depth: 20684 Ground Elevation: 1077 Surface Casing: 1500 Depth to base of Treatable Water-Bearing FM: 350

Deep surface casing has been approved

Under Federal Jurisdiction: No Fresh Water Supply Well Drilled: No Surface Water used to Drill: Yes

Approved Method for disposal of Drilling Fluids:

Pit 1: water-based, on-site
3K-2.5K ppm chlorides
category 2

A. Evaporation / dewater / backfill
H. Pit 2 - 20 mil liner required
OBM to vendor, OBM cuttings per District

PERMIT NO: 15-29623

Pit 2: oil-based, on-site
300K-250K ppm chlorides
Category 3

TEMPORARY AUTHORIZATION
TO DRILL
Expiration Date: 3-6-2015
Signature: [Signature] 2/26/15
165:10-3-1-1

This permit does not address the right of entry or settlement of surface damages.
The duration of this permit is SIX MONTHS, except as otherwise provided by Rule 165: 10-3-1.
Rule 165: 10-3-4 (c) (7) (e) - The Operator shall give 24 Hours notice by telephone to the appropriate District Office of the Conservation Division as to when Surface Casing will be run.

HORIZONTAL HOLE 1

API 019-26172

Sec 06 Twp 35 Rge 3W County CARTER

Spot Location of End Point: S2 S2 SW SW

Feet From: SOUTH 1/4 Section Line: 30

Feet From: WEST 1/4 Section Line: 660

Depth of Deviation: 10,131

Radius of Turn: 478

Direction: 179

Total Length: 9802

Measured Total Depth: 20684

True Vertical Depth: 14276

End Point Location from Lease,

Unit, or Property Line: 30

Application for Intent to Drill

Additional Surface Owner	Address	City, State, Zip
GRIFFIN PROPERTIES OKC LLC	PO BOX 1389	ARDMORE, OK 73402
STEVEN LEE HOWARD	849 BRONCO ROAD	WILSON, OK 73463
ROBERT M. OR JANE F. HIGHTOWE	100 N. PLAZA DRIVE	LITTLE ROAD, AR 72205

This permit does not address the right of entry or settlement of surface damages.
 The duration of this permit is SIX MONTHS, except as otherwise provided by Rule 165: 10-3-1.
 Rule 165: 10-3-4 (c) (7) (e) - The Operator shall give 24 Hours notice by telephone to the appropriate District Office of the Conservation Division as to when Surface Casing will be run.

000 00000 WYNELL 1-31-6XH

APT 019-26172

Continental

Well Location Plat

S.H.L. Sec. 31-2S-3W I.M.
B.H.L. Sec. 6-3S-3W I.M.

Operator: CONTINENTAL RESOURCES, INC.
 Lease Name and No. : WYNELL 1-31-6XH
 Footage : 250' FNL - 600' FWL GR. ELEVATION : 1077' Good Site? YES
 Section: 31 Township: 2S Range: 3W I.M.
 County : Carter State of Oklahoma
 Alternate Loc. : N/A
 Terrain at Loc. : Stake fell in timber.
 Accessibility : From the North.
 Directions : From the town of Pruitt City, Ok. at the intersection of State Hwy 76. Go South on State Hwy 76 for 5 miles. Then go West on State Hwy 53 to the NE Corner of Section 31.

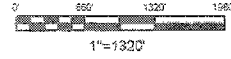

GPS DATUM
 NAD - 27
 OK SOUTH ZONE

Surface Hole Loc.:
 Lat: 34°20'46.77"N
 Lon: 97°33'37.28"W
 X: 2132707
 Y: 368927

Bottom Hole Loc.:
 Lat: 34°19'05.19"N
 Lon: 97°33'36.62"W
 X: 2132808
 Y: 358658

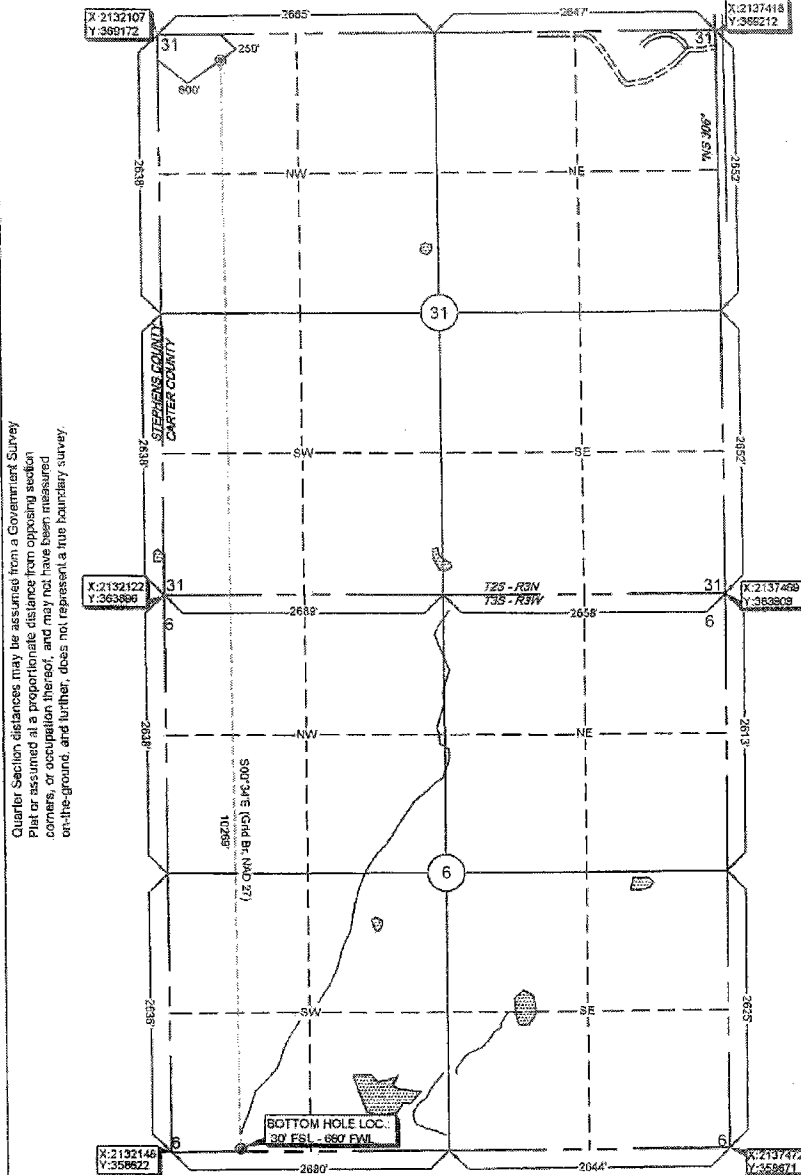

Quarter Section distances may be assumed from a Government Survey Plat or assumed as a proportionate distance from opposing section corners, or occupied thereof, and may not have been measured on-the-ground, and further, does not represent a true boundary survey.

NOTE: X and Y data shown hereon for Section Corners may NOT have been surveyed on-the-ground, and further, does NOT represent a true boundary survey.

Please note that this location was staked on the ground under the supervision of a Licensed Professional Land Surveyor, but the accuracy of this survey is not guaranteed. Please contact Arkoma Surveying and Mapping promptly if any inconsistency is determined. GPS data is observed from RTK - GPS.

survey and plat by,
Arkoma Surveying and Mapping, PLLC
 P.O. Box 238 Wilburton, OK 74578
 Ph. 918-465-5711 Fax 918-465-5030

Certificate of Authorization No. 5348
 Expires June 30, 2016
 Invoice #5096
 Date Staked : 11/24/14 By : C.K.
 Date Drawn : 12/02/14 By : T.S.
 Revise Cells : 01/15/15 By : R.M.
 Revise BHL Call : 02/13/15 By : R.S.

Certification:
 This is to certify that this Well Location Plat represents the results of a survey made on the ground performed under the supervision of the undersigned.

Stan Drannon 2/13/15
STAN DRANNON OK LPLS 1672

