

OKLAHOMA CORPORATION COMMISSION
OIL & GAS CONSERVATION DIVISION
P.O. BOX 52000
OKLAHOMA CITY, OK 73152-2000
(Rule 165:10-3-1)

API NUMBER: 047 24993

Approval Date: 01/13/2015
Expiration Date: 07/13/2015

Horizontal Hole Oil & Gas

PERMIT TO DRILL

WELL LOCATION: Sec: 06 Twp: 24N Rge: 4W County: GARFIELD
SPOT LOCATION: NW NW NE FEET FROM QUARTER: FROM NORTH FROM EAST
SECTION LINES: 165 2500

Lease Name: THOMPSON Well No: 4-6H Well will be 165 feet from nearest unit or lease boundary.
Operator Name: SK PLYMOUTH LLC Telephone: 9185991800 OTC/OCC Number: 23485 0

SK PLYMOUTH LLC
110 W 7TH ST STE 2600
TULSA, OK 74119-1104

FRANCES K. TOEWS, TRUSTEE
5801 N. OAKWOOD RD., APT. B108
ENID OK 73703

Formation(s) (Permit Valid for Listed Formations Only):

Name	Depth	Name	Depth
1	MISSISSIPPI	5450	6
2			7
3			8
4			9
5			10

Spacing Orders: 582112

Location Exception Orders: 634443

Increased Density Orders:

Pending CD Numbers: 201408237

Special Orders:

Total Depth: 10700

Ground Elevation: 1069

Surface Casing: 310

Depth to base of Treatable Water-Bearing FM: 260

Under Federal Jurisdiction: No

Fresh Water Supply Well Drilled: No

Surface Water used to Drill: Yes

PIT 1 INFORMATION

Approved Method for disposal of Drilling Fluids:

Type of Pit System: CLOSED Closed System Means Steel Pits

Type of Mud System: WATER BASED

Chlorides Max: 50000 Average: 5000

Is depth to top of ground water greater than 10ft below base of pit? Y

Within 1 mile of municipal water well? N

Wellhead Protection Area? N

Pit is located in a Hydrologically Sensitive Area.

Category of Pit: C

Liner not required for Category: C

Pit Location is BED AQUIFER

Pit Location Formation: GARBER

D. One time land application -- (REQUIRES PERMIT) PERMIT NO: 14-29336
H. CLOSED SYSTEM=STEEL PITS PER OPERATOR REQUEST

This permit does not address the right of entry or settlement of surface damages.
The duration of this permit is SIX MONTHS, except as otherwise provided by Rule 165: 10-3-1.
Rule 165: 10-3-4 (c) (7) (e) - The Operator shall give 24 Hours notice by telephone to the appropriate District Office of the Conservation Division as to when Surface Casing will be run.

HORIZONTAL HOLE 1

Sec 06 Twp 24N Rge 4W County GARFIELD

Spot Location of End Point: SW SW SW SE

Feet From: SOUTH 1/4 Section Line: 150

Feet From: EAST 1/4 Section Line: 2500

Depth of Deviation: 5089

Radius of Turn: 636

Direction: 180

Total Length: 4612

Measured Total Depth: 10700

True Vertical Depth: 5725

End Point Location from Lease,
Unit, or Property Line: 150

Notes:

Category	Description
LOCATION EXCEPTION - 634443	1/13/2015 - G75 - (I.O.) 6-24N-4W X582112 MISS SHL NCT 150 FNL, NCT 660 FEL FIRST PERF NCT 150 FNL, NCT 660 FEL LAST PERF NCT 150 FSL, NCT 660 FEL BHL NCT 150 FSL, NCT 660 FEL SK PLYMOUTH EXPLOR., L.L.C. ** 12-22-2014 ** S/B SK PLYMOUTH, L.L.C.; TO BE CORRECTED AT HEARING FOR FINAL ORDER LOCATION EXCEPTION PER OPERATOR
PENDING CD - 201408237	1/13/2015 - G75 - 6-24N-4W X582112 MISS 2 WELLS NO OP. NAMED REC 12-2-2014 (MCKEOWN)
SPACING - 582112	1/13/2015 - G75 - (640)(HOR) 6-24N-4W EST MISS POE TO BHL NCT 660' FB (SUPERSEDE SP. ORDER # 113734/361822 MISS SW4; COEXIST THOMPSON 6-1 MISS SW4 SE4 LEASE BASIS)

This permit does not address the right of entry or settlement of surface damages.
The duration of this permit is SIX MONTHS, except as otherwise provided by Rule 165: 10-3-1.
Rule 165: 10-3-4 (c) (7) (e) - The Operator shall give 24 Hours notice by telephone to the appropriate District Office of the Conservation Division as to when Surface Casing will be run.

NW NW NW NE

LEGEND:

- = 90° SYMBOL
- = PROPOSED WELLHEAD.
- ▲ = SECTION CORNERS LOCATED.

T24N, R4W, I.M. API 047-24993

S 1/4 Cor. Sec. 31,
Rebar, #1667,
0.5' Below E-W Road
(SP NAD 27)
N: 580187.94
E: 2097251.52

SE Cor. Sec. 31,
Rebar, #1667,
0.9' Below Road Intersection
(SP NAD 27)
N: 580201.22
E: 2099887.45

T25N
T24N

Rebar, #1667,
0.3' Below Road
Intersection
(SP NAD 27)
N: 580177.73
E: 2095454.16

Rebar, #1200,
Flush W/E-W Road
(SP NAD 27)
N: 580191.04
E: 2097899.33

2500'
THOMPSON #4-6H1
Elev. Ungraded
Ground = 1069.4'

Nail, 0.7' Below
Road Intersection
(SP NAD 27)
N: 580204.87
E: 2100537.23

N00°22'44"E - 2898.15' (Meas.)

N00°20'02"E - 2634.74' (Meas.)

N00°10'04"E - 2888.71' (Meas.)

N00°10'24"E - 2636.64' (Meas.)

Rebar, #1667,
0.1' Below
N-S Road
(SP NAD 27)
N: 577279.88
E: 2095448.60

Rebar, #1667,
0.2' Below
N-S Road
(SP NAD 27)
N: 577316.45
E: 2100542.33

R5
R4
W
W

S89°36'03"W - 2456.73' (Meas.)

N89°51'47"W - 2644.99' (Meas.)

LINE TABLE		
LINE	DIRECTION	LENGTH
L1	S89°56'48"W	649.85'
L2	S89°59'39"W	647.87'

NAD 83 (SURFACE LOCATION)	
LATITUDE =	36°35'34.73" (36.592981)
LONGITUDE =	97°39'59.01" (97.666392)
NAD 27 (SURFACE LOCATION)	
LATITUDE =	36°35'34.61" (36.592947)
LONGITUDE =	97°39'57.82" (97.666061)
STATE PLANE NAD 83	
N:	580052.91 E: 2066438.59
STATE PLANE NAD 27	
N:	580026.80 E: 2098037.76

CERTIFICATE OF PROFESSIONAL SURVEYOR
THIS IS TO CERTIFY THAT THE ABOVE PLAT WAS PREPARED FROM FIELD NOTES OF ACTUAL SURVEYS MADE BY ME OR UNDER MY SUPERVISION AND THAT THE SAME ARE TRUE AND CORRECT TO THE BEST OF MY KNOWLEDGE AND BELIEF.

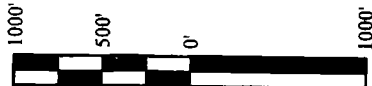
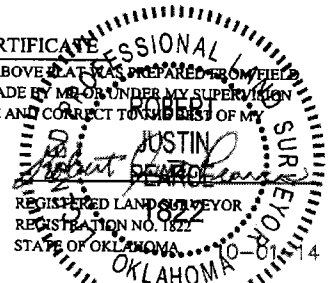

BASIS OF BEARINGS
BASIS OF BEARINGS IS A G.P.S. OBSERVATION
BASIS OF ELEVATION

BENCH MARK (F184) LOCATED NEAR THE SOUTH LINE OF THE SW 1/4 OF SECTION 12, T22N, R6W, I.M., TAKEN FROM THE ENID EAST, QUADRANGLE, OKLAHOMA, GARFIELD COUNTY, 7.5 MINUTE QUAD. (TOPOGRAPHIC MAP) PUBLISHED BY THE UNITED STATES DEPARTMENT OF THE INTERIOR, GEOLOGICAL SURVEY. SAID ELEVATION IS MARKED AS BEING 1154.36 FEET.

SK PLYMOUTH, LLC

**THOMPSON #4-6H
LOT 2, SECTION 6, T24N, R4W, I.M.
GARFIELD COUNTY, OKLAHOMA**

SURVEYED BY: J.P., C.B.	SURVEY DATE: 09-22-14
DRAWN BY: S.F.	DATE DRAWN: 09-29-14
SCALE: 1" = 1000'	REVISED: 00-00-00

WELL LOCATION PLAT



UELS, LLC
Corporate Office * 85 South 200 East
Vernal, UT 84078 * (435) 789-1017

