

Oklahoma Corporation Commission
Oil & Gas Conservation Division
Post Office Box 52000
Oklahoma City, Oklahoma 73152-2000
Rule 165: 10-3-25

Form 1002A

API No.: 35085212260000

Completion Report

Spud Date: April 24, 2014

OTC Prod. Unit No.: 085-214806

Drilling Finished Date: June 17, 2014

1st Prod Date: November 11, 2014

Completion Date: November 06, 2014

Drill Type: HORIZONTAL HOLE

Well Name: JACOBS 1-21H16

Purchaser/Measurer:

Location: LOVE 21 7S 1E
SE NE NW NE
340 FNL 1325 FEL of 1/4 SEC
Derrick Elevation: 0 Ground Elevation: 836

First Sales Date:

Operator: XTO ENERGY INC 21003

810 HOUSTON ST
FORT WORTH, TX 76102-6203

Completion Type	
X	Single Zone
	Multiple Zone
	Commingled

Location Exception	
Order No	
623406	

Increased Density	
Order No	
There are no Increased Density records to display.	

Casing and Cement							
Type	Size	Weight	Grade	Feet	PSI	SAX	Top of CMT
CONDUCTOR	16	109	J-55	80		12	SURFACE
SURFACE	9 5/8	36	J-55	1992		510	SURFACE
PRODUCTION	7	32	P-110	16292		630	12229

Liner								
Type	Size	Weight	Grade	Length	PSI	SAX	Top Depth	Bottom Depth
LINER	4 1/2	15.1	P-110	6061	0	485	13839	19900

Total Depth: 19920

Packer	
Depth	Brand & Type
There are no Packer records to display.	

Plug	
Depth	Plug Type
There are no Plug records to display.	

Initial Test Data										
Test Date	Formation	Oil BBL/Day	Oil-Gravity (API)	Gas MCF/Day	Gas-Oil Ratio Cu FT/BBL	Water BBL/Day	Pumpin or Flowing	Initial Shut-In Pressure	Choke Size	Flow Tubing Pressure
Nov 12, 2014	WOODFORD	485	43	514	1060	2792	FLOWING		22/64	2690

Completion and Test Data by Producing Formation										
Formation Name: WOODFORD			Code: 319WDFD			Class: OIL				
Spacing Orders				Perforated Intervals						
Order No	Unit Size			From			To			
622294	640			14862			19735			
Acid Volumes				Fracture Treatments						
28,000 GALLONS				14 STAGES - 120,716 BTW, 427,820 POUNDS 100 MESH, 4,770,700 POUNDS 40/70						

Formation	Top
WOODFORD	14825

Were open hole logs run? No

Date last log run:

Were unusual drilling circumstances encountered? No

Explanation:

Other Remarks
OCC: FLE ORDERS HAVE NOT BEEN ISSUED. WE HAVE ACCEPTED OPERATORS DATA AS SUBMITTED. IRREGULAR SECTION.

Lateral Holes
Sec: 16 TWP: 7S RGE: 1E County: LOVE
NW NE NW NE
26 FNL 1668 FEL of 1/4 SEC
Depth of Deviation: 14031 Radius of Turn: 792 Direction: 356 Total Length: 5613
Measured Total Depth: 19920 True Vertical Depth: 14365 End Pt. Location From Release, Unit or Property Line: 26

FOR COMMISSION USE ONLY
Status: Accepted
1127287

AS SUBMITTED

RECEIVED

Form 1002A
Rev. 2009

DEC 03 2014

OKLAHOMA CORPORATION
COMMISSIONAPI NO. 085-21226
OTC PROD. UNIT NO. 085-214806PLEASE TYPE OR USE BLACK INK
NOTE:Attach copy of original 10
if recompletion or reentry.Oklahoma City, Oklahoma 73152-2000
Rule 165:10-3-25 ORIGINAL
 AMENDED (Reason)

COMPLETION REPORT

TYPE OF DRILLING OPERATION

 STRAIGHT HOLE DIRECTIONAL HOLE HORIZONTAL HOLE
 SERVICE WELL

If directional or horizontal, see reverse for bottom hole location.

COUNTY	Love	SEC	21	TWP	7S	RGE	1E	SPUD DATE	4/24/2014	
LEASE NAME	Jacobs			WELL NO.	1-21H16		1st PROD DATE	6/17/2014	DATE OF WELL COMPLETION	11/6/2014
SE 1/4 NE 1/4 NW 1/4 NE 1/4	FNL OF 1/4 SEC 340'		FEL OF 1/4 SEC 1325'		RECOMP DATE					
ELEVATION Derrick FL	Ground	836'	Latitude (if known)	33.939411N		Longitude (if known)	97.199948W			
OPERATOR NAME	XTO Energy Inc.			OTC/OCC OPERATOR NO.	21003					
ADDRESS	210 Park Avenue, Suite 2350									
CITY	Oklahoma City	STATE	Oklahoma	ZIP	73102					

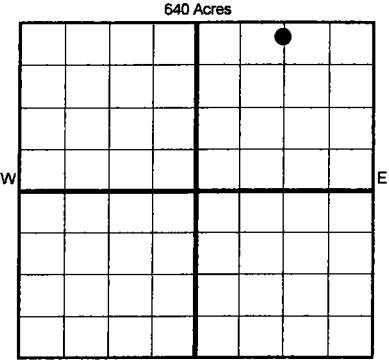

LOCATE WELL

COMPLETION TYPE

<input checked="" type="checkbox"/>	SINGLE ZONE
<input type="checkbox"/>	MULTIPLE ZONE
	Application Date
<input type="checkbox"/>	COMINGLED
	Application Date
LOCATION EXCEPTION ORDER NO.	623406
INCREASED DENSITY ORDER NO.	

CASING & CEMENT (Form 1002C must be attached)

TYPE	SIZE	WEIGHT	GRADE	FEET	PSI	SAX	TOP OF CMT	
CONDUCTOR	16"	109	J-55	80			Surface	
SURFACE	9 5/8"	36	J-55	1992		510	Surface	
INTERMEDIATE	7"	32	P-110	16,292		630	12,229	
PRODUCTION								
LINER	4 1/2"	15.1	P-110	13839-19900 5,061		485	13,839	
							TOTAL DEPTH	19,920

 PACKER @ _____ BRAND & TYPE _____ PLUG @ _____ TYPE _____ PLUG @ _____ TYPE _____
 PACKER @ _____ BRAND & TYPE _____ PLUG @ _____ TYPE _____ PLUG @ _____ TYPE _____

COMPLETION & TEST DATA BY PRODUCING FORMATION

FORMATION	WOODFORD							
SPACING & SPACING ORDER NUMBER	640: 622294							
CLASS: Oil, Gas, Dry, Inj, Disp, Comm Disp, Svc	Oil							
PERFORATED INTERVALS	14 Stages							
	14862-19735'							
ACID/VOLUME	28,000 gals							
FRACTURE TREATMENT (Fluids/Prop Amounts)	120,716 BTW							
	427,820# 100 Mesh							
	4,770,700# 40/70							

Reported to Frac Focus

Min Gas Allowable (165:10-17-7)

Gas Purchaser/Measurer

OR

First Sales Date

Oil Allowable (165:10-13-3)

INITIAL TEST DATA

INITIAL TEST DATE	11/12/2014				
OIL-BBL/DAY	485				
OIL-GRAVITY (API)	43				
GAS-MCF/DAY	514				
GAS-OIL RATIO CU FT/BBL	1060				
WATER-BBL/DAY	2792				
PUMPING OR FLOWING	Flowing				
INITIAL SHUT-IN PRESSURE					
CHOKE SIZE	22/64"				
FLOW TUBING PRESSURE	2690 FCP				

A record of the formations drilled through, and pertinent remarks are presented on the reverse. I declare that I have knowledge of the contents of this report and am authorized by my organization to make this report, which was prepared by me or under my supervision and direction, with the data and facts stated herein to be true, correct, and complete to the best of my knowledge and belief.

Debbie Waggoner

Debbie Waggoner

12/2/2014 405-319-3243

SIGNATURE

NAME (PRINT OR TYPE)

DATE

PHONE NUMBER

210 Park Avenue, Suite 2350

Oklahoma City Ok 73102

debbie_waggoner@xtoenergy.com

ADDRESS

CITY

STATE

ZIP

EMAIL ADDRESS

PLEASE TYPE OR USE BLACK INK ONLY
FORMATION RECORD

Give formation names and tops, if available, or descriptions and thickness of formations drilled through. Show intervals cored or drillstem tested.

LEASE NAME JACOBS WELL NO. 1-21H16

NAMES OF FORMATIONS	TOP
WOODFORD	14,825'

FOR COMMISSION USE ONLY

ITD on file YES NO

APPROVED _____ DISAPPROVED _____ 2) Reject Codes _____

Were open hole logs run? yes no

Date Last log was run _____

Was CO₂ encountered? yes no at what depths? _____

Was H₂S encountered? yes no at what depths? _____

Were unusual drilling circumstances encountered? yes no
If yes, briefly explain below:

Other remarks: Irregular Section

640 Acres

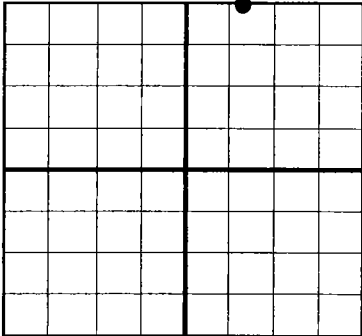

BOTTOM HOLE LOCATION FOR DIRECTIONAL HOLE

SEC	TWP	RGE	COUNTY			
Spot Location	1/4	1/4	1/4	Feet From 1/4 Sec Lines	FSL	FWL
Measured Total Depth	True Vertical Depth		BHL From Lease, Unit, or Property Line:			

BOTTOM HOLE LOCATION FOR HORIZONTAL HOLE: (LATERALS)

LATERAL #1

SEC	TWP	RGE	COUNTY				
SEC 16	TWP 7S	RGE 1E	COUNTY Love				
Spot Location	NW 1/4	NE 1/4	NW 1/4	NE 1/4	Feet From 1/4 Sec Lines	FNL 26'	FEL 1668.5
Depth of Deviation	14,031'	Radius of Turn	792.6'	Direction	356.5°	Total Length	5613.7'
Measured Total Depth	19,920'	True Vertical Depth	14,365'	BHL From Lease, Unit, or Property Line: 26" FNL & 1668.5' FEL			

If more than three drainholes are proposed, attach a separate sheet indicating the necessary information.

Direction must be stated in degrees azimuth. Please note, the horizontal drainhole and its end point must be located within the boundaries of the lease or spacing unit.

Directional surveys are required for all drainholes and directional wells.

640 Acres

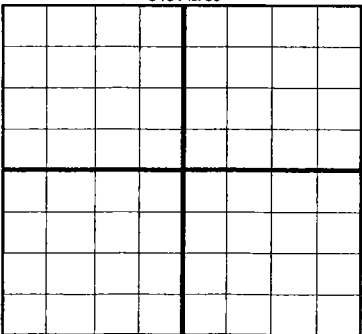

LATERAL #2

SEC	TWP	RGE	COUNTY				
Spot Location	1/4	1/4	1/4	1/4	Feet From 1/4 Sec Lines	FSL	FWL
Depth of Deviation	Radius of Turn		Direction		Total Length		
Measured Total Depth	True Vertical Depth		BHL From Lease, Unit, or Property Line:				

LATERAL #3

SEC	TWP	RGE	COUNTY				
Spot Location	1/4	1/4	1/4	1/4	Feet From 1/4 Sec Lines	FSL	FWL
Depth of Deviation	Radius of Turn		Direction		Total Length		
Measured Total Depth	True Vertical Depth		BHL From Lease, Unit, or Property Line:				