

OKLAHOMA CORPORATION COMMISSION  
OIL & GAS CONSERVATION DIVISION  
P.O. BOX 52000  
OKLAHOMA CITY, OK 73152-2000  
(Rule 165:10-3-1)

API NUMBER: 117 23630

Approval Date: 12/22/2014  
Expiration Date: 06/22/2015

Straight Hole Oil & Gas

PERMIT TO DRILL

WELL LOCATION: Sec: 17 Twp: 20N Rge: 6E County: PAWNEE  
SPOT LOCATION:  NE  SE  NW  SE FEET FROM QUARTER: FROM SOUTH FROM EAST  
SECTION LINES: 1815 1485

Lease Name: LASSLEY Well No: 2-17 Well will be 825 feet from nearest unit or lease boundary.  
Operator Name: TARKA ENERGY LLC Telephone: 5804709230 OTC/OCC Number: 23529 0

TARKA ENERGY LLC  
PO BOX 190  
DUNCAN, OK 73534-0190

WILLIAM & KRISTI LASSLEY  
363033 E. 5880 RD.  
YALE OK 74085

Formation(s) (Permit Valid for Listed Formations Only):

	Name	Depth	Name	Depth	
1	CLEVELAND	2532	6	RED FORK	3013
2	BIG LIME	2591	7	MISSISSIPPI	3269
3	OSWEGO	2721	8	WOODFORD	3378
4	PRUE	2816	9	SIMPSON DOLOMITE	3420
5	SKINNER	2962	10	WILCOX	3448

Spacing Orders: 472149

Location Exception Orders:

Increased Density Orders:

Pending CD Numbers: 201409114

Special Orders:

Total Depth: 3650

Ground Elevation: 890

**Surface Casing: 390**

Depth to base of Treatable Water-Bearing FM: 340

Under Federal Jurisdiction: No

Fresh Water Supply Well Drilled: No

Surface Water used to Drill: No

PIT 1 INFORMATION

Type of Pit System: ON SITE

Type of Mud System: WATER BASED

Chlorides Max: 3000 Average: 2000

Is depth to top of ground water greater than 10ft below base of pit? Y

Within 1 mile of municipal water well? N

Wellhead Protection Area? N

Pit is located in a Hydrologically Sensitive Area.

Category of Pit: 2

Liner not required for Category: 2

Pit Location is BED AQUIFER

Pit Location Formation: VANOSS

Approved Method for disposal of Drilling Fluids:

A. Evaporation/dewater and backfilling of reserve pit.

Notes:

This permit does not address the right of entry or settlement of surface damages.  
The duration of this permit is SIX MONTHS, except as otherwise provided by Rule 165: 10-3-1.  
Rule 165: 10-3-4 (c) (7) (e) - The Operator shall give 24 Hours notice by telephone to the appropriate District Office of the Conservation Division as to when Surface Casing will be run.

117 23630 LASSLEY 2-17

Category	Description
FRAC FOCUS	11/13/2014 - G71 - THE REQUIREMENT FOR CHEMICAL DISCLOSURE OF HYDRAULIC FRACTURING INGREDIENTS WILL BE EXTENDED TO INCLUDE ALL NON-HORIZONTAL WELLS FOR HYDRAULIC FRACTURING OPERATIONS BEGINNING JANUARY 1, 2014. REFER TO OCC RULE 165:10-3-10 FOR COMPLIANCE REQUIREMENTS. PLEASE REPORT DIRECTLY TO FRACFOCUS USING THE FOLLOWING LINK <a href="http://fracfocus.org/">HTTP://FRACFOCUS.ORG/</a> OR FOR OCC ASSISTANCE CONTACT DENNIS NISKERN AT 405-522-2977 OR D.NISKERN@OCCEMAIL.COM
PENDING CD - 201409114	12/22/2014 - G76 - (E.O) NW4 SE4 17-20N-6E X472149 CLVD, PRUE, SKNR, RDFK, WLCX NCT 495 FSL, NCT 165 FEL NO OP. NAMED REC. 12/19/2014 (DECKER)
SPACING	12/11/2014 - G76 - BIG LIME, OSWEGO, MISSISSIPPI, WOODFORD, SIMPSON DOLOMITE UNSPACED; 160-ACRE LEASE (SE4)
SPACING - 472149	12/11/2014 - G76 - (40) SE4 17-20N-6E EST CLVD, PRUE, SKNR, RDFK, WLCX

This permit does not address the right of entry or settlement of surface damages.  
The duration of this permit is SIX MONTHS, except as otherwise provided by Rule 165: 10-3-1.  
Rule 165: 10-3-4 (c) (7) (e) - The Operator shall give 24 Hours notice by telephone to the appropriate District Office of the Conservation Division as to when Surface Casing will be run.

117 23630 LASSLEY 2-17

HPI-117-23630

# Well Location Plat

Sec. 17-20N-6E I.M.

Operator: TARKA ENERGY, LLC  
 Lease Name and No.: LASSLEY 2-17 ALT  
 Footage: 1815' FSL - 1485' FEL GR. ELEVATION: 890' Good Site? YES  
 Section: 17 Township: 20N Range: 6E I.M.  
 County: Pawnee State of Oklahoma  
 Terrain at Loc.: Pasture, scattered timber  
 Accessibility: From the North.  
 Directions: From the junction of US Highway 64 & OK Highway 18 in the town of Pawnee, OK, go 5.8 miles South on Hwy 18, then turn East onto "Loce Chimney Road" for ± 6 miles, thence going South on Underwood Road ±1.5 miles, to the East quarter of Section 17-20N-6E.



1"=1000'  
 GPS DATUM  
 NAD 83  
 OK NORTH ZONE  
 NAD 83  
 OK NORTH ZONE

Surface Hole Loc.  
 Lat: 36.20022962  
 Lon: 96.60290389  
 X: 2397062  
 Y: 442453

Surface Hole Loc.  
 Lat: 36.20018553  
 Lon: 96.60249747  
 X: 2392867  
 Y: 442400

Please note that this location was staked on the ground under the supervision of a Licensed Professional Land Surveyor and the accuracy of the survey is not guaranteed. Please contact Arkoma Surveying and Mapping for any inconsistency in coordinates. GPS 562 is obtained from RTK-GPS.

160  
 Acre  
 Lease  
 SE/4

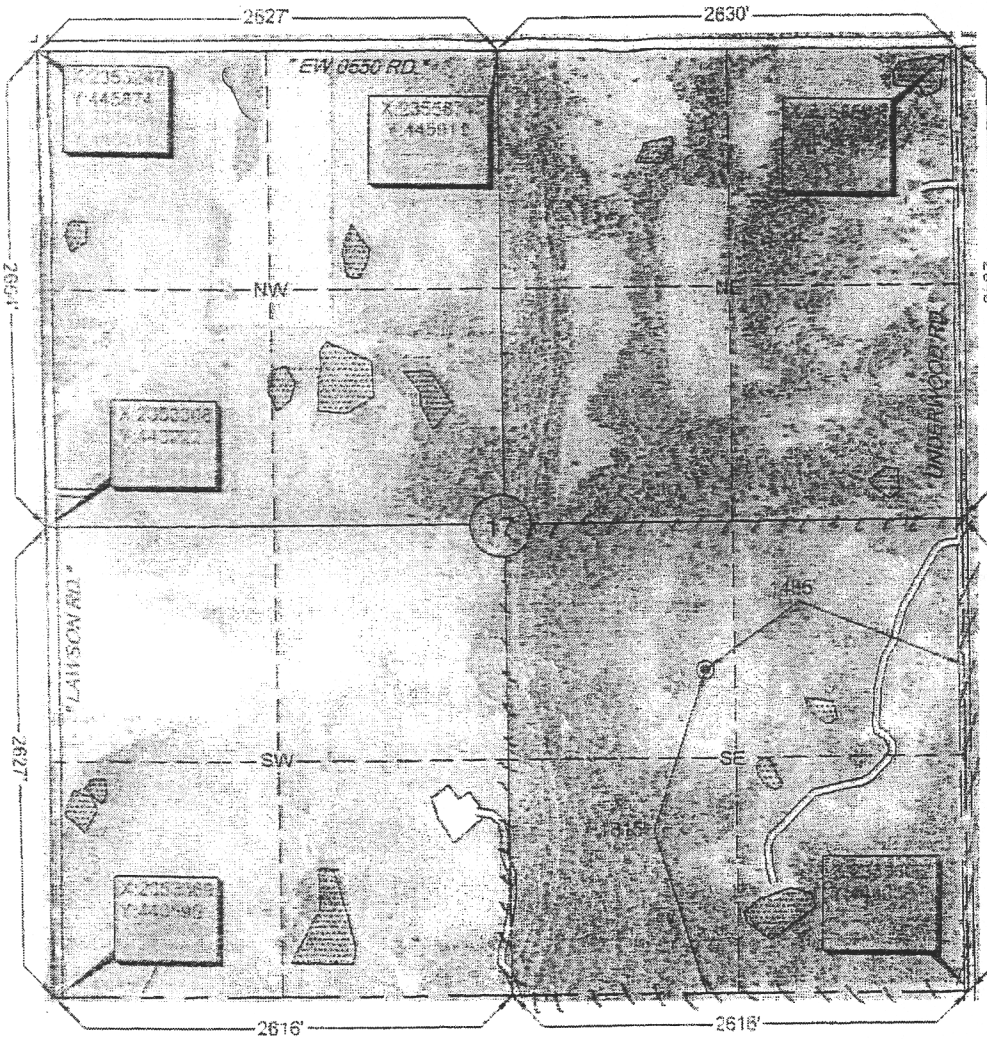

NOTE: X and Y data shown herein is based on a Government Survey Plat. Coordinates may NOT have been surveyed on the ground, and further, do NOT represent a true boundary survey.

survey and plat by:  
 Arkoma Surveying and Mapping, PLLC  
 P.O. Box 238 Wilburton, OK 74575  
 Ph. 918-465-6711 Fax 918-465-5030  
 Certificate of Authorization No. 5348  
 Expires June 30, 2016

Certification:  
 This is to certify that this Well Location Plat represents the results of a survey made on the ground performed under the supervision of the undersigned.

Invoice #5033-A  
 Date Staked: 10/30/14 By: JF  
 Date Drawn: 11/07/14 By: RS

*Stan Drannon* 11/10/14  
 STAN DRANNON OK LPLS 1672

