

Oklahoma Corporation Commission
Oil & Gas Conservation Division
Post Office Box 52000
Oklahoma City, Oklahoma 73152-2000
Rule 165: 10-3-25

Form 1002A

API No.: 35069201530000

Completion Report

Spud Date: November 17, 2013

OTC Prod. Unit No.: 069-213084

Drilling Finished Date: December 07, 2013

1st Prod Date: April 24, 2014

Completion Date: April 29, 2014

Drill Type: DIRECTIONAL HOLE

Well Name: DOUGLAS HARRINGTON 1-26

Purchaser/Measurer: CARRENA GAS GATHERING

Location: JOHNSTON 26 4S 5E
SW SW NE NE
1602 FSL 1646 FWL of 1/4 SEC
Derrick Elevation: 796 Ground Elevation: 779

First Sales Date: 05/07/2014

Operator: CONTINENTAL EXPLORATION LLC 21863

275 W CAMPBELL RD STE 440
RICHARDSON, TX 75080-8006

Completion Type	
	Single Zone
	Multiple Zone
X	Commingled

Location Exception
Order No
There are no Location Exception records to display.

Increased Density
Order No
618322

Casing and Cement							
Type	Size	Weight	Grade	Feet	PSI	SAX	Top of CMT
SURFACE	9 5/8	36	J-55	338		200	SURFACE
PRODUCTION	5 1/2	17	J-55	7933		675	5850

Liner								
Type	Size	Weight	Grade	Length	PSI	SAX	Top Depth	Bottom Depth
There are no Liner records to display.								

Total Depth: 7933

Packer	
Depth	Brand & Type
There are no Packer records to display.	

Plug	
Depth	Plug Type
There are no Plug records to display.	

Initial Test Data										
Test Date	Formation	Oil BBL/Day	Oil-Gravity (API)	Gas MCF/Day	Gas-Oil Ratio Cu FT/BBL	Water BBL/Day	Pumpin or Flowing	Initial Shut-In Pressure	Choke Size	Flow Tubing Pressure
Apr 29, 2014	SYCAMORE- WOODFORD-HUNTON- VIOLA	124	38	380	3064		FLOWING	1660	20/64	100

Completion and Test Data by Producing Formation

Formation Name: SYCAMORE

Code: 352SCMR

Class: OIL

Spacing Orders

Order No	Unit Size
408107	160
529423	160

Perforated Intervals

From	To
5948	6046

Acid Volumes

2,000 GALLONS

Fracture Treatments

7,310 BW, 75,371 POUNDS

Formation Name: WOODFORD

Code: 319WDFD

Class: OIL

Spacing Orders

Order No	Unit Size
408107	160
529423	160

Perforated Intervals

From	To
6126	6378

Acid Volumes

2,000 GALLONS

Fracture Treatments

12,318 BW, 110,674 POUNDS

Formation Name: HUNTON

Code: 269HNTN

Class: OIL

Spacing Orders

Order No	Unit Size
408107	160
529423	160

Perforated Intervals

From	To
6420	6518

Acid Volumes

2,000 GALLONS

Fracture Treatments

2,508 BW, 8,218 POUNDS

Formation Name: VIOLA

Code: 202VIOL

Class: OIL

Spacing Orders

Order No	Unit Size
408107	160
529423	160

Perforated Intervals

From	To
6850	7370

Acid Volumes

4,000 GALLONS

Fracture Treatments

21,539 BW, 212,428 POUNDS

Formation Name: SYCAMORE-WOODFORD-HUNTON-VIOLA

Code:

Class: OIL

Formation	Top
CANEY	5716
SYCAMORE	5933
WOODFORD	6112
HUNTON	6421
SYLVAN	6518
VIOLA	6813
BROMIDE MASSIVE	7400
BROMIDE 2ND	7850

Were open hole logs run? Yes

Date last log run: December 03, 2013

Were unusual drilling circumstances encountered? No

Explanation:

Other Remarks

IRREGULAR SECTION.

Bottom Holes

Sec: 23 TWP: 4S RGE: 5E County: JOHNSTON

SW NE SW SE

880 FSL 840 FWL of 1/4 SEC

Depth of Deviation: 0 Radius of Turn: 0 Direction: 0 Total Length: 0

Measured Total Depth: 7933 True Vertical Depth: 7695 End Pt. Location From Release, Unit or Property Line: 880

FOR COMMISSION USE ONLY

1126722

Status: Accepted

AS SUBMITTED

RECEIVED

API NO 35-069-20153
OTC PROD UNIT NO. 069-213084

PLEASE TYPE OR USE BLACK INK
NOTE:
Attach copy of original 1002A if recompletion or reentry.

Oklahoma City, Oklahoma 73152-2000
Rule 165:10-3-25

OCT 30 2014

Form 1002A
Rev. 2009

OKLAHOMA CORPORATION
COMMISSION
Section 26

ORIGINAL
 AMENDED (Reason)

COMPLETION REPORT

TYPE OF DRILLING OPERATION
 STRAIGHT HOLE DIRECTIONAL HOLE HORIZONTAL HOLE
 SERVICE WELL

SPUD DATE 11/17/2013

DRLG FINISHED DATE 12/7/2013

DATE OF WELL COMPLETION 4/29/2014

1st PROD DATE 4/24/2014

RECOMP DATE N/A

Longitude (if known)

COUNTY Johnston SEC 26 TWP 45 RGE 5E

LEASE NAME Douglas Harrington WELL NO. 1-26

SW 1/4 SW 1/4 NE 1/4 NE 1/4 FSL OF 1/4 SEC 1602' FWL OF 1/4 SEC 1646'

ELEVATIO N Demick 796' Ground 779' Latitude (if known)

OPERATOR NAME Continental Exploration LLC OTC/OCC OPERATOR NO. 21063

ADDRESS 275 West Campbell, Suite 440

CITY Richardson STATE Texas ZIP 75080

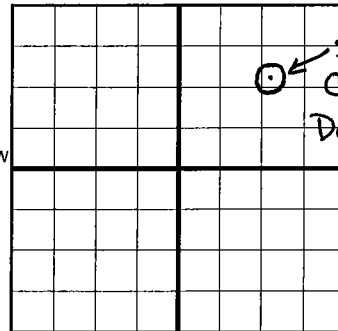

COMPLETION TYPE

SINGLE ZONE
 MULTIPLE ZONE
Application Date
 COMMINGLED
Application Date
LOCATION
EXCEPTION ORDER N/A
INCREASED DENSITY ORDER NO. 618322

CASING & CEMENT (Form 1002C must be attached)

TYPE	SIZE	WEIGHT	GRADE	FEET	PSI	SAX	TOP OF CMT
CONDUCTOR	<u>95/8"</u>						
SURFACE		<u>36</u>	<u>J-55</u>	<u>338'</u>		<u>200</u>	<u>Surface</u>
INTERMEDIATE							
PRODUCTION	<u>5 1/2"</u>	<u>17</u>	<u>J-55</u>	<u>7900'</u>		<u>675</u>	<u>5850'</u>
LINER							

PACKER @ N/A BRAND & TYPE _____ PLUG @ _____ TYPE _____ PLUG @ _____ TYPE _____ TOTAL DEPTH 8006'

COMPLETION & TEST DATA BY PRODUCING FORMATION

FORMATION	540000	Woodford	HUNTON	Viola	Monitor
SPACING & SPACING ORDER NUMBER	<u>(160) 408107 + 529423</u>	<u>same</u>	<u>same</u>	<u>same</u>	<u>Report to Fire Focus</u>
CLASS: Oil, Gas, Dry Int, Disp, Comm Disp, Svc	<u>Gas</u>	<u>Gas</u>	<u>Gas</u>	<u>Gas</u>	
PERFORATED INTERVALS	<u>5948'-6046'</u>	<u>6126'-6378'</u>	<u>6420'-6518'</u>	<u>6850'-7370'</u>	
ACID/VOLUME	<u>2000 gal</u>	<u>2000 gal</u>	<u>2000 gal</u>	<u>4000 gal</u>	
FRACTURE TREATMENT (Fluids/Prop Amounts)	<u>7,310 BW</u> <u>75,371 lbs</u>	<u>1,2318 BW</u> <u>110,674 lbs</u>	<u>2,508 BW</u> <u>8,218 lbs</u>	<u>21,539 BW</u> <u>212,428 lbs</u>	

Min Gas Allowable (165:10-17-7) OR Gas Purchaser/Measurer First Sales Date Current Gas Gathering 5/7/2014

INITIAL TEST DATA

INITIAL TEST DATE	<u>4/29/2014</u>
OIL-BBL/DAY	<u>124</u>
OIL-GRAVITY (API)	<u>38</u>
GAS-MCF/DAY	<u>380</u>
GAS-OIL RATIO CU FT/BBL	<u>3,064</u>
WATER-BBL/DAY	<u>0</u>
PUMPING OR FLOWING	<u>Flowing</u>
INITIAL SHUT-IN PRESSURE	<u>1660</u>
CHOKE SIZE	<u>20/64</u>
FLOW TUBING PRESSURE	<u>100</u>

A record of the formations drilled through, and pertinent remarks are presented on the reverse. I declare that I have knowledge of the contents of this report and am authorized by my organization to make this report, which was prepared by me or under my supervision and direction, with the data and facts stated herein to be true, correct, and complete to the best of my knowledge and belief.

Douglas Harrington SIGNATURE NAME (PRINT OR TYPE) Douglas Harrington DATE 10/29/2014 PHONE NUMBER (214) 615-8558

275 W. Campbell, Suite 440, Richardson Texas 75080 ADDRESS CITY STATE ZIP djh@ancientseasexpl.com EMAIL ADDRESS

PLEASE TYPE OR USE BLACK INK ONLY
FORMATION RECORD

Give formation names and tops, if available, or descriptions and thickness of formations drilled through. Show intervals cored or drillstem tested.

LEASE NAME _____ WELL NO. _____

NAMES OF FORMATIONS	TOP MD	TOP TVD
CANEY	5716'	5520'
Sycamore	5933'	5730'
Woodford	6112'	5895'
Hunton	6421'	6195'
Sylvan	6518'	6290'
Viola	6813	6588'
Bramide Massive	7400'	7168'
Bramide 2nd	7850'	7613'

FOR COMMISSION USE ONLY

ITD on file YES NO

APPROVED _____ DISAPPROVED _____

2) Reject Codes _____

Were open hole logs run? yes no

Date Last log was run 12/3/2013

Was CO₂ encountered? yes no at what depths? _____

Was H₂S encountered? yes no at what depths? _____

Were unusual drilling circumstances encountered? yes no

If yes, briefly explain below _____

Other remarks: _____

Section 23
640 Acres

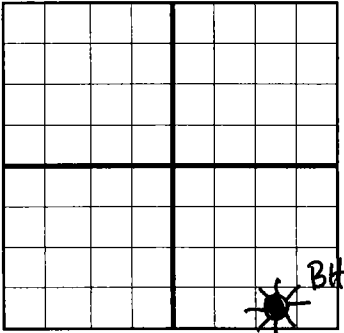

If more than three drainholes are proposed, attach a separate sheet indicating the necessary information.

Direction must be stated in degrees azimuth. Please note, the horizontal drainhole and its end point must be located within the boundaries of the lease or spacing unit.

Directional surveys are required for all drainholes and directional wells.

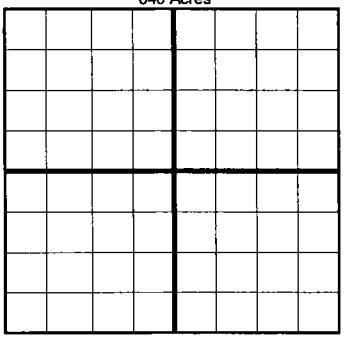

BOTTOM HOLE LOCATION FOR DIRECTIONAL HOLE

SEC 23	TWP 4S	RGE SE	COUNTY Johnston
Spot Location 1/4 C 1/4 SW 1/4 SE 1/4	Feet From 1/4 Sec Lines	FSL 800'	FWL 840'
Measured Total Depth 8006	True Vertical Depth 7720	BHL From Lease, Unit, or Property Line: 660' FNL + 700' FWL	

BOTTOM HOLE LOCATION FOR HORIZONTAL HOLE: (LATERALS)

LATERAL #1

SEC	TWP	RGE	COUNTY
Spot Location 1/4 1/4 1/4 1/4	Feet From 1/4 Sec Lines	FSL	FWL
Depth of Deviation	Radius of Turn	Direction	Total Length
Measured Total Depth	True Vertical Depth	BHL From Lease, Unit, or Property Line:	

LATERAL #2

SEC	TWP	RGE	COUNTY
Spot Location 1/4 1/4 1/4 1/4	Feet From 1/4 Sec Lines	FSL	FWL
Depth of Deviation	Radius of Turn	Direction	Total Length
Measured Total Depth	True Vertical Depth	BHL From Lease, Unit, or Property Line:	

LATERAL #3

SEC	TWP	RGE	COUNTY
Spot Location 1/4 1/4 1/4 1/4	Feet From 1/4 Sec Lines	FSL	FWL
Depth of Deviation	Radius of Turn	Direction	Total Length
Measured Total Depth	True Vertical Depth	BHL From Lease, Unit, or Property Line:	

11/1/14

069-20153

AS SUBMITTED

RECEIVED

API NO. 35-069-20153
OTC PROD UNIT NO. 069-213084

PLEASE TYPE OR USE BLACK INK C
NOTE:
Attach copy of original 1002A if recompletion or reentry.

Oklahoma City, Oklahoma 73152-2000
Rule 165:10-3-25

OCT 30 2014

Form 1002A
Rev. 2009

OKLAHOMA CORPORATION
COMMISSION
Section 26

1016EZ

ORIGINAL AMENDED (Reason)
TYPE OF DRILLING OPERATION
 STRAIGHT HOLE DIRECTIONAL HOLE HORIZONTAL HOLE
 SERVICE WELL
If directional or horizontal, see reverse of bottom hole location.

COMPLETION REPORT

SPUD DATE 11/17/2013
DRLG FINISHED DATE 12/7/2013
DATE OF WELL COMPLETION 4/29/2014
1st PROD DATE 4/24/2014
RECOMP DATE N/A
Longitude (if known)

OPERATOR NAME Continental Exploration LLC
OTC/OOC OPERATOR NO. 21063
ADDRESS 275 West Campbell, Suite 440
CITY Richardson STATE TEXAS ZIP 75080

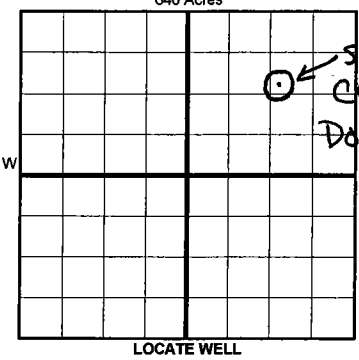

COMPLETION TYPE
 SINGLE ZONE
 MULTIPLE ZONE
 COMMINGLED
LOCATION EXCEPTION ORDER INCREASED DENSITY ORDER NO. 618322

TYPE	SIZE	WEIGHT	GRADE	FEET	PSI	SAX	TOP OF CMT
CONDUCTOR	95/8"						
SURFACE		36	J-55	338'		200	Surface
INTERMEDIATE							
PRODUCTION	5 1/2"	17	J-55	7980'		675	5850'
LINER							

PACKER @ N/A BRAND & TYPE PLUG @ TYPE PLUG @ TYPE TOTAL DEPTH 8006'

COMPLETION & TEST DATA BY PRODUCING FORMATION

FORMATION	SPACING & SPACING ORDER NUMBER	CLASS: Oil, Gas, Dry, etc.	PERFORATED INTERVALS	ACID/VOLUME	FRACTURE TREATMENT (Fluids/Prop Amounts)
Sycamore	(160) 408107 + 529423	Gas	5948' - 6046'	2000 gal	7,310 BW 75,371 lbs
Woodford		Gas	6126' - 6378'	2000 gal	2,318 BW 110,674 lbs
Hutton		Gas	6420' - 6518'	2000 gal	2,508 BW 8,218 lbs
Viola		Gas	6850' - 7370'	4000 gal	21,539 BW 212,428 lbs

INITIAL TEST DATA
Min Gas Allowable (165:10-17-7) OR Min Allowable (165:10-13-3) Gas Purchaser/Measurer First Sales Date

INITIAL TEST DATE	4/29/2014				
OIL-BBL/DAY	124				
OIL-GRAVITY (API)	38				
GAS-MCF/DAY	380				
GAS-OIL RATIO CU FT/BBL	3,064				
WATER-BBL/DAY	0				
PUMPING OR FLOWING	Flowing				
INITIAL SHUT-IN PRESSURE	1660				
CHOKE SIZE	20/64				
FLOW TUBING PRESSURE	100				

A record of the formations drilled through, and pertinent remarks are presented on the reverse. I declare that I have knowledge of the contents of this report and am authorized by my organization to make this report which was prepared by me or under my supervision and direction, with the data and facts stated herein to be true, correct, and complete to the best of my knowledge and belief.

Signature: Douglas Harrington
NAME (PRINT OR TYPE): Douglas Harrington
DATE: 10/28/2014 (214) 615-8558
PHONE NUMBER: (214) 615-8558
ADDRESS: 275 W. Campbell, Suite 440, Richardson, Texas 75080
CITY: Richardson STATE: Texas ZIP: 75080
EMAIL ADDRESS: djh@ancientseasexpl.com

E 2

SCANNED

JR