

Oklahoma Corporation Commission
Oil & Gas Conservation Division
Post Office Box 52000
Oklahoma City, Oklahoma 73152-2000
Rule 165: 10-3-25

Form 1002A

API No.: 35019260920000

Completion Report

Spud Date: July 19, 2014

OTC Prod. Unit No.: 019-203140

Drilling Finished Date: July 22, 2014

1st Prod Date: November 02, 2014

Completion Date: November 02, 2014

Drill Type: STRAIGHT HOLE

Well Name: COX 30-4

Purchaser/Measurer:

Location: CARTER 30 1S 2W
SW NW SW NE
825 FSL 165 FWL of 1/4 SEC
Latitude: 34.443806 Longitude: -97.447972
Derrick Elevation: 980 Ground Elevation: 975

First Sales Date:

Operator: JUDD BILLY INVESTMENT CO INC 20160

826 FOREST LN
ARDMORE, OK 73401-1095

Completion Type	
X	Single Zone
	Multiple Zone
	Commingled

Location Exception
Order No
There are no Location Exception records to display.

Increased Density
Order No
There are no Increased Density records to display.

Casing and Cement							
Type	Size	Weight	Grade	Feet	PSI	SAX	Top of CMT
PRODUCTION	5.5			1476	1000	230	SURFACE

Liner								
Type	Size	Weight	Grade	Length	PSI	SAX	Top Depth	Bottom Depth
There are no Liner records to display.								

Total Depth: 1500

Packer	
Depth	Brand & Type
There are no Packer records to display.	

Plug	
Depth	Plug Type
1468	PBTD

Initial Test Data										
Test Date	Formation	Oil BBL/Day	Oil-Gravity (API)	Gas MCF/Day	Gas-Oil Ratio Cu FT/BBL	Water BBL/Day	Pumpin or Flowing	Initial Shut-In Pressure	Choke Size	Flow Tubing Pressure
Nov 01, 2014	HOXBAR	7	28				PUMPING			

Completion and Test Data by Producing Formation		
Formation Name: HOXBAR	Code: 405HXBR	Class: OIL
Spacing Orders		Perforated Intervals
Order No	Unit Size	From
There are no Spacing Order records to display.		To
		1141
		1354
Acid Volumes		Fracture Treatments
1,000 GALLONS NAS		There are no Fracture Treatments records to display.

Formation	Top
PONTOTOC	0
HOXBAR	1093

Were open hole logs run? Yes
Date last log run: July 22, 2014

Were unusual drilling circumstances encountered? No
Explanation:

Other Remarks
There are no Other Remarks.

FOR COMMISSION USE ONLY	
Status: Accepted	1126847

AS SUBMITTED

RECEIVED

NOV 04 2014

Form 1002A
Rev. 2009

OKLAHOMA CORPORATION
COMMISSION

API NO. 019-26092
OTC PROD. 019
UNIT NO. 203740

PLEASE TYPE OR USE BL
NOTE:

Attach copy of original 1002A
if recompletion or reentry.

OKLAHOMA CORPORATION COMMISSION
Oil & Gas Conservation Division
Post Office Box 52000
Oklahoma City, Oklahoma 73152-2000
Rule 165-10-3-25.

ORIGINAL
 AMENDED (Reason) _____

COMPLETION REPORT

TYPE OF DRILLING OPERATION
 STRAIGHT HOLE DIRECTIONAL HOLE HORIZONTAL HOLE
 SERVICE WELL

SPUD DATE 7-19-14
DRLG FINISHED DATE 7-22-14

COUNTY <u>CARTER</u>	SEC <u>30</u>	TWP <u>15</u>	RGE <u>2W</u>	DATE OF WELL COMPLETION <u>11-2-14</u>
LEASE NAME <u>COX</u>	WELL NO. <u>30-4</u>	1st PROD DATE <u>11-2-14</u>		
<u>SW 1/4 NW 1/4 SW 1/4 NE 1/4</u>	FSL OF 1/4 SEC <u>825</u>	FWL OF 1/4 SEC <u>165</u>	RECOMP DATE	
ELEVATION N Derrick <u>980</u>	Ground <u>975</u>	Latitude (if known) <u>34.443806</u>	Longitude (if known) <u>97.447972</u>	
OPERATOR NAME <u>BILLY JUDD INV. CO., NK.</u>	OTC/OCC OPERATOR NO. <u>20160-6</u>	ADDRESS <u>826 FOREST LANE</u>		
CITY <u>AROMORE</u>	STATE <u>OK.</u>	ZIP <u>73401</u>		

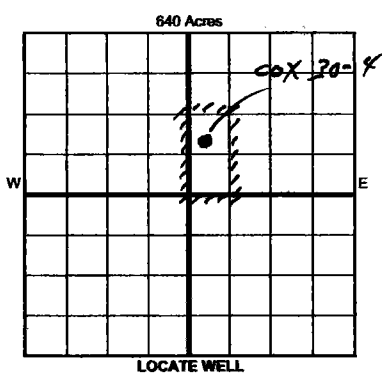

COMPLETION TYPE

SINGLE ZONE
 MULTIPLE ZONE
Application Date _____
 COMMINGLED
Application Date _____

LOCATION
 EXCEPTION ORDER
 INCREASED DENSITY
ORDER NO. _____

CASING & CEMENT (Form 1002C must be attached)

TYPE	SIZE	WEIGHT	GRADE	FEET	PSI	SAX	TOP OF CMT
CONDUCTOR							
SURFACE							
INTERMEDIATE							
PRODUCTION	<u>5.5</u>			<u>1476</u>	<u>1000</u>	<u>230</u>	<u>SURF</u>
LINER							

PACKER @ _____ BRAND & TYPE _____ PLUG @ _____ TYPE _____ PLUG @ _____ TYPE _____
PACKER @ _____ BRAND & TYPE _____ PLUG @ _____ TYPE _____ PLUG @ _____ TYPE _____

TOTAL DEPTH 1500
PSTD 1468

COMPLETION & TEST DATA BY PRODUCING FORMATION 405HXBR

FORMATION	<u>H0XBAR</u>						<u>No Frac</u>
SPACING & SPACING ORDER NUMBER	<u>UNSPACED</u>						
CLASS: Oil, Gas, Dry, Inj, Disp, Comm Disp, Svc	<u>OIL</u>						
PERFORATED INTERVALS	<u>1141-1354</u> <u>2 SPF</u> <u>(OA)</u>						
ACID/VOLUME	<u>1000 GAL. NAS</u>						
FRACTURE TREATMENT (Fluids/Prop Amounts)	<u>NO</u>						

BOND LOG
CBL SHOWS GOOD BOND
(D)

Min Gas Allowable (165-10-17-7) OR Gas Purchaser/Measurer
 Oil Allowable (165-10-13-3) First Sales Date _____

INITIAL TEST DATA

INITIAL TEST DATE	<u>11-1-14</u>			
OIL-BBL/DAY	<u>7</u>			
OIL-GRAVITY (API)	<u>28</u>			
GAS-MCF/DAY	<u>TSTM</u>			
GAS-OIL RATIO CU FT/BBL				
WATER-BBL/DAY				
PUMPING OR FLOWING	<u>PUMPING</u>			
INITIAL SHUT-IN PRESSURE				
CHOKE SIZE				
FLOW TUBING PRESSURE				

A record of the formations drilled through, and pertinent remarks are presented on the reverse. I declare that I have knowledge of the contents of this report and am authorized by my organization to make this report, which was prepared by me or under my supervision and direction, with the data and facts stated herein to be true, correct, and complete to the best of my knowledge and belief.

JR. LAWS JR. LAWS 11-4-14 580-220-8455
SIGNATURE NAME (PRINT OR TYPE) DATE PHONE NUMBER
1515 WARD RD. AROMORE, OK. 73401 JRLAWS@HOTMAIL.COM

PLEASE TYPE OR USE BLACK INK ONLY
FORMATION RECORD

Give formation names and tops, if available, or descriptions and thickness of formations drilled through. Show intervals cored or drilled stem tested.

LEASE NAME COX

WELL NO. 30-4

NAMES OF FORMATIONS	TOP
PONTIAC	SURF
HoxBAR	1093
TD	1500

FOR COMMISSION USE ONLY

ITD on file YES NO

APPROVED _____ DISAPPROVED _____

2) Reject Codes _____

Were open hole logs run? yes no

Date Last log was run 7-22-14

Was CO₂ encountered? yes no at what depths? _____

Was H₂S encountered? yes no at what depths? _____

Were unusual drilling circumstances encountered? yes no

If yes, briefly explain below _____

Other remarks: _____

640 Acres

If more than three drainholes are proposed, attach a separate sheet indicating the necessary information.

Direction must be stated in degrees azimuth. Please note, the horizontal drainhole and its end point must be located within the boundaries of the lease or spacing unit.

Directional surveys are required for all drainholes and directional wells.

640 Acres

BOTTOM HOLE LOCATION FOR DIRECTIONAL HOLE

SEC	TWP	RGE	COUNTY
Spot Location	1/4	1/4	1/4
Measured Total Depth	True Vertical Depth		BHL From Lease, Unit, or Property Line:

BOTTOM HOLE LOCATION FOR HORIZONTAL HOLE: (LATERALS)

LATERAL #1

SEC	TWP	RGE	COUNTY
Spot Location	1/4	1/4	1/4
Depth of Deviation	Radius of Turn		Direction
Measured Total Depth	True Vertical Depth		BHL From Lease, Unit, or Property Line:

LATERAL #2

SEC	TWP	RGE	COUNTY
Spot Location	1/4	1/4	1/4
Depth of Deviation	Radius of Turn		Direction
Measured Total Depth	True Vertical Depth		BHL From Lease, Unit, or Property Line:

LATERAL #3

SEC	TWP	RGE	COUNTY
Spot Location	1/4	1/4	1/4
Depth of Deviation	Radius of Turn		Direction
Measured Total Depth	True Vertical Depth		BHL From Lease, Unit, or Property Line: