

Oklahoma Corporation Commission
Oil & Gas Conservation Division
Post Office Box 52000
Oklahoma City, Oklahoma 73152-2000
Rule 165: 10-3-25

Form 1002A

API No.: 35019261200000

Completion Report

Spud Date: September 08, 2014

OTC Prod. Unit No.:

Drilling Finished Date: September 11, 2014

1st Prod Date: October 03, 2014

Completion Date: October 02, 2014

Drill Type: STRAIGHT HOLE

Well Name: TDU RD 5

Purchaser/Measurer:

Location: CARTER 5 1S 3W
SE NE SE NW
740 FSL 2634 FWL of 1/4 SEC
Derrick Elevation: 976 Ground Elevation: 968

First Sales Date:

Operator: STEPHENS & JOHNSON OPERATING CO 19113
PO BOX 2249
811 6TH ST
WICHITA FALLS, TX 76307-2249

Completion Type	
X	Single Zone
	Multiple Zone
	Commingled

Location Exception
Order No
There are no Location Exception records to display.

Increased Density
Order No
There are no Increased Density records to display.

Casing and Cement							
Type	Size	Weight	Grade	Feet	PSI	SAX	Top of CMT
CONDUCTOR	8 5/8	23	J-55	126		150	SURFACE
PRODUCTION	5 1/2	15.5	J-55	3364		575	SURFACE

Liner								
Type	Size	Weight	Grade	Length	PSI	SAX	Top Depth	Bottom Depth
There are no Liner records to display.								

Total Depth: 3368

Packer	
Depth	Brand & Type
There are no Packer records to display.	

Plug	
Depth	Plug Type
There are no Plug records to display.	

Initial Test Data										
Test Date	Formation	Oil BBL/Day	Oil-Gravity (API)	Gas MCF/Day	Gas-Oil Ratio Cu FT/BBL	Water BBL/Day	Pumpin or Flowing	Initial Shut-In Pressure	Choke Size	Flow Tubing Pressure
Oct 03, 2014	DEESE	57.3	25	15	261	27	PUMPING			

Completion and Test Data by Producing Formation										
Formation Name: DEESE			Code: 404DEESS			Class: OIL				
Spacing Orders				Perforated Intervals						
Order No		Unit Size		From			To			
75567		UNIT		3019			3218			
Acid Volumes				Fracture Treatments						
2,400 GALLONS 15% NEFE				77,000 POUNDS 12/20 SAND						

Formation	Top
TUSSY DEESE	2920

Were open hole logs run? Yes
Date last log run: September 12, 2014

Were unusual drilling circumstances encountered? Yes
Explanation: LOG HIT @ BRIDGE @ 3,079'

Other Remarks
COULD NOT LOG ANY DEEPER THAN 3,079'

FOR COMMISSION USE ONLY	
Status: Accepted	1126710

AS SUBMITTED

RECEIVED

OCT 27 2014

Form 1002A
Rev. 2009

API NO **019-26120**
OTC PROD.
UNIT NO.

PLEASE TYPE OR USE BLACK NOTE:

Attach copy of original if recompletion or reentry.

Post Office Box 52000
Oklahoma City, Oklahoma 73152-2000
Rule 165:10-3-25

OKLAHOMA CORPORATION COMMISSION

ORIGINAL
 AMENDED (Reason)

COMPLETION REPORT

TYPE OF DRILLING OPERATION

STRAIGHT HOLE DIRECTIONAL HOLE HORIZONTAL HOLE
 SERVICE WELL

If directional or horizontal, see reverse for bottom hole location.

SPUD DATE **9/8/14**
DRLG FINISHED DATE **9/11/14**
DATE OF WELL COMPLETION **10/2/14**
1st PROD DATE **10/3/14**
RECOMP DATE

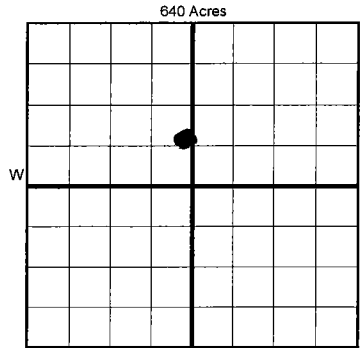

COUNTY **CARTER** SEC **5** TWP **15** RGE **3W**
LEASE NAME **TDU RD** WELL NO. **5**
SE 1/4 NE 1/4 SE 1/4 NW 1/4 FSL OF 1/4 SEC **740** FWL OF 1/4 SEC **2634**
ELEVATIO N Derrick **976** Ground **968** Latitude (if known) Longitude (if known)
OPERATOR NAME **STEPHENS & JOHNSON OPER. CO.** OTC/OCC OPERATOR NO. **19113**
ADDRESS **P.O. BOX 2249**
CITY **WICHITA FALLS** STATE **TX** ZIP **76307**

COMPLETION TYPE

SINGLE ZONE
 MULTIPLE ZONE
Application Date
COMMINGLED
Application Date
LOCATION
EXCEPTION ORDER
INCREASED DENSITY
ORDER NO.

CASING & CEMENT (Form 1002C must be attached)

TYPE	SIZE	WEIGHT	GRADE	FEET	PSI	SAX	TOP OF CMT
CONDUCTOR	8 5/8	23	J55	126		150	SURF
SURFACE							
INTERMEDIATE							
PRODUCTION	5 1/2	15.5	J55	3364		575	SURF
LINER							
						TOTAL DEPTH	3368

CBL shows good bond
(DHI)

PACKER @ _____ BRAND & TYPE _____ PLUG @ _____ TYPE _____ PLUG @ _____ TYPE _____
PACKER @ _____ BRAND & TYPE _____ PLUG @ _____ TYPE _____ PLUG @ _____ TYPE _____

COMPLETION & TEST DATA BY PRODUCING FORMATION

404 DEESE

FORMATION	SPACING & SPACING ORDER NUMBER	CLASS: Oil, Gas, Dry, Inj, Disp, Comm Disp, Svc	PERFORATED INTERVALS	ACID/VOLUME	FRACTURE TREATMENT (Fluids/Prop Amounts)
DEESE	75567 (unit)	OIL	3019-3218	A/2400 GALLS 15% NEFE	77,000# 12/20 SAND

Reported to For Focus

Min Gas Allowable (165:10-17-7) OR Gas Purchaser/Measurer First Sales Date
 Oil Allowable (165:10-13-3)

INITIAL TEST DATA

INITIAL TEST DATE	10/3/14			
OIL-BBL/DAY	57.3			
OIL-GRAVITY (API)	25			
GAS-MCF/DAY	15			
GAS-OIL RATIO CU FT/BBL	600			
WATER-BBL/DAY	2.7			
PUMPING OR FLOWING	P			
INITIAL SHUT-IN PRESSURE	-			
CHOKE SIZE	-			
FLOW TUBING PRESSURE	-			

A record of the formations drilled through, and pertinent remarks are presented on the reverse. I declare that I have knowledge of the contents of this report and am authorized by my organization to make this report, which was prepared by me or under my supervision and direction, with the data and facts stated herein to be true, correct, and complete to the best of my knowledge and belief.

Bruce Robertson SIGNATURE **BRUCE ROBERTSON** NAME (PRINT OR TYPE) **10/24/14** DATE **940-723-2166** PHONE NUMBER
P.O. BOX 2249 WICHITA FALLS TX 76307 ADDRESS CITY STATE ZIP **BRROBERTSON@STOC-NET** EMAIL ADDRESS

PLEASE TYPE OR USE BLACK INK ONLY
FORMATION RECORD

Give formation names and tops, if available, or descriptions and thickness of formations drilled through. Show intervals cored or drillstem tested.

LEASE NAME TDU RD WELL NO. 5

NAMES OF FORMATIONS	TOP
Tussy DEESE	2920

FOR COMMISSION USE ONLY

ITD on file YES NO

APPROVED _____ DISAPPROVED _____

2) Reject Codes _____

Were open hole logs run? yes no

Date Last log was run 9/12/14

Was CO₂ encountered? yes no at what depths? _____

Was H₂S encountered? yes no at what depths? _____

Were unusual drilling circumstances encountered? yes no
If yes, briefly explain below

LOG HIT @ BRIDGE @ 3079'

Other remarks: COULD NOT LOG ANY DEEPER THAN 3079'.

640 Acres

If more than three drainholes are proposed, attach a separate sheet indicating the necessary information.

Direction must be stated in degrees azimuth. Please note, the horizontal drainhole and its end point must be located within the boundaries of the lease or spacing unit.

Directional surveys are required for all drainholes and directional wells.

640 Acres

BOTTOM HOLE LOCATION FOR DIRECTIONAL HOLE

SEC	TWP	RGE	COUNTY			
Spot Location	1/4	1/4	1/4	Feet From 1/4 Sec Lines	FSL	FWL
Measured Total Depth	True Vertical Depth		BHL From Lease, Unit, or Property Line:			

BOTTOM HOLE LOCATION FOR HORIZONTAL HOLE: (LATERALS)

LATERAL #1

SEC	TWP	RGE	COUNTY			
Spot Location	1/4	1/4	1/4	Feet From 1/4 Sec Lines	FSL	FWL
Depth of Deviation	Radius of Turn		Direction		Total Length	
Measured Total Depth	True Vertical Depth		BHL From Lease, Unit, or Property Line:			

LATERAL #2

SEC	TWP	RGE	COUNTY			
Spot Location	1/4	1/4	1/4	Feet From 1/4 Sec Lines	FSL	FWL
Depth of Deviation	Radius of Turn		Direction		Total Length	
Measured Total Depth	True Vertical Depth		BHL From Lease, Unit, or Property Line:			

LATERAL #3

SEC	TWP	RGE	COUNTY			
Spot Location	1/4	1/4	1/4	Feet From 1/4 Sec Lines	FSL	FWL
Depth of Deviation	Radius of Turn		Direction		Total Length	
Measured Total Depth	True Vertical Depth		BHL From Lease, Unit, or Property Line:			