

OKLAHOMA CORPORATION COMMISSION
OIL & GAS CONSERVATION DIVISION
P.O. BOX 52000
OKLAHOMA CITY, OK 73152-2000
(Rule 165:10-3-1)

API NUMBER: 095 20637

Approval Date: 10/24/2014

Expiration Date: 04/24/2015

Horizontal Hole Oil & Gas

PERMIT TO DRILL

WELL LOCATION: Sec: 03 Twp: 6S Rge: 6E

County: MARSHALL

SPOT LOCATION: ☐ NW ☐ SE ☐ NE ☐ NE

FEET FROM QUARTER: FROM NORTH FROM EAST

SECTION LINES: 670 499

Lease Name: DOC WATKINS

Well No: 1-3H

Well will be 499 feet from nearest unit or lease boundary.

Operator Name: XTO ENERGY INC

Telephone: 8178853255

OTC/OCC Number: 21003 0

XTO ENERGY INC
810 HOUSTON ST
FORT WORTH, TX 76102-6203

H. G. WATKINS & MARY M. WATKINS
P.O. BOX 807
MADILL OK 73446

Formation(s) (Permit Valid for Listed Formations Only):

	Name	Depth	Name	Depth
1	CANEY	6263	6	
2	SYCAMORE	6593	7	
3	WOODFORD	6713	8	
4	HUNTON	7043	9	
5			10	

Spacing Orders: 627207

Location Exception Orders: 628618

Increased Density Orders:

Pending CD Numbers:

Special Orders:

Total Depth: 13000

Ground Elevation: 680

Surface Casing: 1990

Depth to base of Treatable Water-Bearing FM: 390

Under Federal Jurisdiction: No

Fresh Water Supply Well Drilled: Yes

Surface Water used to Drill: Yes

PIT 1 INFORMATION

Type of Pit System: ON SITE

Type of Mud System: AIR

Is depth to top of ground water greater than 10ft below base of pit? Y

Within 1 mile of municipal water well? N

Wellhead Protection Area? N

Pit is not located in a Hydrologically Sensitive Area.

Category of Pit: 4

Liner not required for Category: 4

Pit Location is NON HSA

Pit Location Formation: CADD0

Mud System Change to Water-Based or Oil-Based Mud Requires an Amended Intent (Form 1000).

Approved Method for disposal of Drilling Fluids:

A. Evaporation/dewater and backfilling of reserve pit.

D. One time land application -- (REQUIRES PERMIT)

PERMIT NO: 14-28468

H. SEE MEMO

This permit does not address the right of entry or settlement of surface damages.

The duration of this permit is SIX MONTHS, except as otherwise provided by Rule 165: 10-3-1.

Rule 165: 10-3-4 (c) (7) (e) - The Operator shall give 24 Hours notice by telephone to the appropriate District Office of the Conservation Division as to when Surface Casing will be run.

PIT 2 INFORMATION

Type of Pit System: CLOSED Closed System Means Steel Pits

Type of Mud System: WATER BASED

Chlorides Max: 5000 Average: 3000

Is depth to top of ground water greater than 10ft below base of pit? Y

Within 1 mile of municipal water well? N

Wellhead Protection Area? N

Pit is not located in a Hydrologically Sensitive Area.

Category of Pit: C

Liner not required for Category: C

Pit Location is NON HSA

Pit Location Formation: CADDO

PIT 3 INFORMATION

Type of Pit System: CLOSED Closed System Means Steel Pits

Type of Mud System: OIL BASED

Chlorides Max: 300000 Average: 200000

Is depth to top of ground water greater than 10ft below base of pit? Y

Within 1 mile of municipal water well? N

Wellhead Protection Area? N

Pit is not located in a Hydrologically Sensitive Area.

Category of Pit: C

Liner not required for Category: C

Pit Location is NON HSA

Pit Location Formation: CADDO

HORIZONTAL HOLE 1

Sec 03 Twp 6S Rge 6E County MARSHALL

Spot Location of End Point: SW NW NW NW

Feet From: NORTH 1/4 Section Line: 380

Feet From: WEST 1/4 Section Line: 1

Depth of Deviation: 6406

Radius of Turn: 1000

Direction: 275

Total Length: 5023

Measured Total Depth: 13000

True Vertical Depth: 7043

End Point Location from Lease,

Unit, or Property Line: 1

Notes:

Category

Description

DEEP SURFACE CASING

10/15/2014 - G76 - APPROVED; NOTIFY OCC FIELD INSPECTOR IMMEDIATELY FOR ANY LOSS OF CIRCULATION OR FAILURE TO CIRCULATE CEMENT TO SURFACE ON CONDUCTOR OR SURFACE CASING

LOCATION EXCEPTION - 628618

10/24/2014 - G75 - (I.O.) N2 3-6S-6E
X627207 CNEY, SCMR, WDFD, HNTN
SHL 670 FNL, 499 FEL
COMPL. INT. NCT 165 FEL, NCT 165 FWL, NCT 330 FNL
XTO ENERGY INC.
8-1-2014

This permit does not address the right of entry or settlement of surface damages.

095 20637 DOC WATKINS 1-3H

The duration of this permit is SIX MONTHS, except as otherwise provided by Rule 165: 10-3-1.

Rule 165: 10-3-4 (c) (7) (e) - The Operator shall give 24 Hours notice by telephone to the appropriate District Office of the Conservation Division as to when Surface Casing will be run.

Category	Description
MEMO	10/15/2014 - G76 - PIT 2 & 3 - CLOSED SYSTEM=STEEL PITS PER OPERATOR REQUEST; PIT 3 - OBM TO VENDOR, OBM CUTTINGS PER DISTRICT
SPACING - 627207	10/24/2014 - G75 - (320) N2 3-6S-6E LD NLT 660' FB VAC 34254 MSRH NE4 VAC 40136 WDFD NE4 VAC 272341 SCMR, WDFD, OTHER SE4 NW4 VAC 357531 SCMR, OTHER EST CNEY, SCMR, WDFD, HNTN

TOPOGRAPHIC LAND SURVEYORS OF OKLAHOMA

6709 NORTH CLASSEN BLVD., OKLA. CITY, OKLA. 73116 * LOCAL (405) 843-4847 * OUT OF STATE (800) 654-3219
Certificate of Authorization No. 1293

MARSHALL

County, Oklahoma

API 095-20637

X= 2401567
Y= 270991

670'FNL-499'FEL Section 3 Township 6S Range 6E I.M.

X= 2402524
Y= 271004

1ST GUIDE MERIDIAN SOUTH
Township Line - T6S - R6E

X= 2406859
Y= 271059

BOTTOM HOLE
380'FNL-0'FWL
NAD - 27
N 34° 04' 10.9"
W 96° 39' 25.4"
N 34.069703°
W 96.673986°
X= 2401572
Y= 270611

LINE	LENGTH
L1	48.289590"
L2	269.267898"

LANDING POINT
380'FNL-165'FEL
NAD - 27
N 34° 04' 10.9"
W 96° 39' 25.4"
N 34.069696°
W 96.657057°
X= 2406699
Y= 270677

LEGEND:
○ PROPOSED SURFACE HOLE (PSHL)
● CONDUCTOR PIPE (CP)
✱ EXISTING WELLHEAD/PRODUCTION WELL
✱ PLUGGED & ABANDONED WELL
✱ PER OCL RECORDS
✱ PROPOSED LANDING POINT (LP)
✱ PROPOSED BOTTOM HOLE (FBHL)
--- PROPOSED OTHER LATERAL LINES (PLL)

Falls in Lake
CALCULATED
X= 2401653
Y= 265694

X= 2404285
Y= 265741

X= 2406894
Y= 268419

X= 2406929
Y= 265780

BOTTOM HOLE, LANDING POINT, AND DRILL PATH
INFORMATION PROVIDED BY OPERATOR LISTED, NOT SURVEYED;
DISTANCE BETWEEN DRILL PATHS ARE CALCULATED
AND CORNER COORDINATES ARE TAKEN
FROM POINTS SURVEYED IN THE FIELD.

ELEVATION:

680' Gr. on level pad

Operator: XTO ENERGY, INC.

Lease Name: DOC WATKINS

Well No.: 1-3H

Topography & Vegetation Loc. fell on level pad, 20' North of Watkins 1-3H2

Good Drill Site? Yes

Reference Stakes or Alternate Location
Stakes Set None

Best Accessibility to Location From North off county road, 20' South of Watkins 1-3H2

Distance & Direction
from Hwy Jct or Town From Little City, OK., go ±3.0 mi. West on St. Hwy 199 to

Indian Road, then ± 1.0 mil South to Existing lease road in the NE corner of Section 3-T6S-R6E

Date of Drawing: Aug. 12, 2013

Invoice # 205546 Date Staked: Aug. 5, 2013

JAL

DATUM: NAD-27
LAT: 34°04'08.0"N
LONG: 96°39'29.4"W
LAT: 34.068900°N
LONG: 96.658160°W
STATE PLANE
COORDINATES: (US Feet)
ZONE: OK SOUTH
X: 2406369
Y: 270382

CERTIFICATE:

I, Lee K. Goss a Oklahoma Licensed Land
Surveyor and an authorized agent of Topographic Land
Surveyors of Oklahoma, do hereby certify that the above
described well location was surveyed and staked on the
ground as shown herein.

Oklahoma Lic. No. 1778

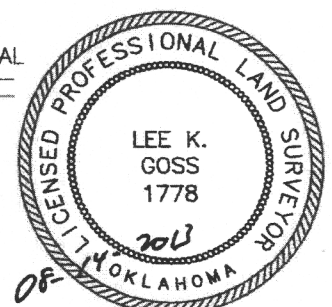

This information was
gathered with a GPS receiver
with ±1.0' accuracy.