

OKLAHOMA CORPORATION COMMISSION
OIL & GAS CONSERVATION DIVISION
P.O. BOX 52000
OKLAHOMA CITY, OK 73152-2000
(Rule 165:10-3-1)

API NUMBER: 129 24017

Approval Date: 10/17/2014

Expiration Date: 04/17/2015

Horizontal Hole Oil & Gas

PERMIT TO DRILL

WELL LOCATION: Sec: 13 Twp: 15N Rge: 26W

County: ROGER MILLS

SPOT LOCATION: ☐ SE ☐ SE ☐ SW ☐ SE

FEET FROM QUARTER: FROM SOUTH FROM EAST

SECTION LINES: 250 1500

Lease Name: CHURCHILL 13-15-26

Well No: 1H

Well will be 250 feet from nearest unit or lease boundary.

Operator Name: APACHE CORPORATION

Telephone: 9184914900; 9184914

OTC/OCC Number: 6778 0

APACHE CORPORATION
6120 S YALE AVE STE 1500
TULSA, OK 74136-4224

SYLVESTER CHURCHILL
RT. 1, BOX 62
DURHAM OK 73642

Formation(s) (Permit Valid for Listed Formations Only):

Name	Depth	Name	Depth
1 CLEVELAND	10167	6	
2		7	
3		8	
4		9	
5		10	

Spacing Orders: 135140

Location Exception Orders: 631793

Increased Density Orders: 630752

Pending CD Numbers:

Special Orders:

Total Depth: 15000

Ground Elevation: 2258

Surface Casing: 700

Depth to base of Treatable Water-Bearing FM: 650

Under Federal Jurisdiction: No

Fresh Water Supply Well Drilled: No

Surface Water used to Drill: No

PIT 1 INFORMATION

Type of Pit System: ON SITE

Type of Mud System: WATER BASED

Chlorides Max: 8000 Average: 5000

Is depth to top of ground water greater than 10ft below base of pit? Y

Within 1 mile of municipal water well? N

Wellhead Protection Area? N

Pit is located in a Hydrologically Sensitive Area.

Category of Pit: 1B

Liner required for Category: 1B

Pit Location is BED AQUIFER

Pit Location Formation: OGALLALA

Approved Method for disposal of Drilling Fluids:

A. Evaporation/dewater and backfilling of reserve pit.

D. One time land application -- (REQUIRES PERMIT)

PERMIT NO: 14-28460

H. SEE MEMO

This permit does not address the right of entry or settlement of surface damages.

The duration of this permit is SIX MONTHS, except as otherwise provided by Rule 165: 10-3-1.

Rule 165: 10-3-4 (c) (7) (e) - The Operator shall give 24 Hours notice by telephone to the appropriate District Office of the Conservation Division as to when Surface Casing will be run.

PIT 2 INFORMATION

Type of Pit System: ON SITE

Type of Mud System: OIL BASED

Chlorides Max: 300000 Average: 200000

Is depth to top of ground water greater than 10ft below base of pit? Y

Within 1 mile of municipal water well? N

Wellhead Protection Area? N

Pit is located in a Hydrologically Sensitive Area.

Category of Pit: 3

Liner required for Category: 3

Pit Location is BED AQUIFER

Pit Location Formation: OGALLALA

HORIZONTAL HOLE 1

Sec 13 Twp 15N Rge 26W County ROGER MILLS

Spot Location of End Point: E2 NE NW NE

Feet From: NORTH 1/4 Section Line: 330

Feet From: EAST 1/4 Section Line: 1500

Depth of Deviation: 9651

Radius of Turn: 418

Direction: 360

Total Length: 4692

Measured Total Depth: 15000

True Vertical Depth: 10560

End Point Location from Lease,
Unit, or Property Line: 330

Notes:

Category

Description

INCREASED DENSITY - 630752

10/17/2014 - G91 - 13-15N-26W
X 135140 CLVD
1 WELL
APACHE CORPORATION
9-17-2014

LOCATION EXCEPTION - 631793

10/17/2014 - G91 - (I.O.) 13-15N-26W
X 135140 CLVD
SHL NCT 250 FSL, NCT 1500 FEL
1ST PERF NCT 300 FSL, NCT 1000 FEL
LAST PERF NCT 300 FNL, NCT 1000 FEL
APACHE CORPORATION
10-14-2014

MEMO

10/17/2014 - G71 - PITS 1 & 2 - CONCRETE LINED PIT PER OPERATOR REQUEST, PIT 2 - OBM
RETURNED TO VENDOR, CUTTINGS PERMITTED PER DISTRICT

SPACING - 135140

10/17/2014 - G91 - (640) 13-15N-26W
EXT 100037 CLVD
EST OTHERS

This permit does not address the right of entry or settlement of surface damages.

The duration of this permit is SIX MONTHS, except as otherwise provided by Rule 165: 10-3-1.

Rule 165: 10-3-4 (c) (7) (e) - The Operator shall give 24 Hours notice by telephone to the appropriate District
Office of the Conservation Division as to when Surface Casing will be run.

129 24017 CHURCHILL 13-15-26 1H

Well Location Plat 129-24017 Sec. 13-15N-26W I.M.

Operator: APACHE CORPORATION

Lease Name and No. : CHURCHILL 13-15-26 1H

Footage : 250' FSL - 1500' FEL GR. ELEVATION : 2258' Good Site? YES

Section: 13 Township: 15N Range: 26W I.M.

County : Roger Mills State of Oklahoma

Alternate Loc. : N/A

Terrain at Loc. : Stake fell in open, flat pasture, 230' N. of E-W fence.

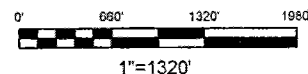
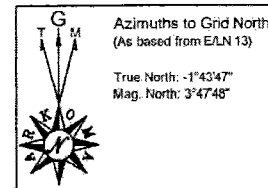

Accessibility : From the North.

Directions : From the junction of State Highway 30 & State Highway 33 in Northwest Roger Mills County, go 2 miles South on Hwy 30 to the Northwest Corner of Section 13-15N-26W.

GPS DATUM
NAD - 27
OK NORTH ZONE

Surface Hole Loc.:
Lat: 35°46'13.51"N
Lon: 99°54'45.08"W
Lat: 35.770420
Lon: 99.912521
X: 1432659
Y: 286027

Bottom Hole Loc.:
Lat: 35°46'59.92"N
Lon: 99°54'44.48"W
Lat: 35.783310
Lon: 99.912355
X: 1432800
Y: 290717

60D W/WASHER
X: 1428991
Y: 291085
LAT: 35°47'02.81"N
LON: 99°55'30.80"W
LAT: 35.784115
LON: 99.925221

IRON ROD
X: 1434309
Y: 290990
LAT: 35°47'02.91"N
LON: 99°54'26.23"W
LAT: 35.784142
LON: 99.907287

BOTTOM HOLE LOC.:
330' FNL - 1500' FEL

X: 1429544
Y: 290746

X: 1433739
Y: 290670

MEWBOURNE OIL CO.
SHAW #2
981' FNL - 1321' FWL
LAT: 35°46'53.03"N
LON: 99°55'14.77"W
X: 1430291
Y: 290071

MEWBOURNE OIL CO.
SHAW #1
657' FNL - 1973' FEL
LAT: 35°46'56.38"N
LON: 99°54'50.27"W
X: 1432317
Y: 290368

X: 1429450
Y: 285191

X: 1433601
Y: 286082

IRON ROD
X: 1428884
Y: 285876
LAT: 35°46'11.28"N
LON: 99°55'30.84"W
LAT: 35.769800
LON: 99.925233

IR W/CAP 1293
X: 1434151
Y: 285738
LAT: 35°46'10.94"N
LON: 99°54'26.91"W
LAT: 35.769706
LON: 99.907474

NOTE: X and Y data shown hereon for Section Corners may NOT have been surveyed on-the-ground, and further, does NOT represent a true Boundary Survey.

Quarter Section distances may be assumed from a Government Survey Plat or assumed at a proportionate distance from opposing section corners, or occupation thereof, and may not have been measured on-the-ground, and further, does not represent a true boundary survey.

survey and plat by,

Arkoma Surveying and Mapping, PLLC

P.O. Box 238 Wilburton, OK 74578

Ph. 918-465-5711 Fax 918-465-5030

Certificate of Authorization No. 5348

Expires June 30, 2014

Invoice #4347

Date Staked : 02/12/14 By : C.K.

Date Drawn : 02/17/14 By : E.D.

Certification:

This is to certify that this Well Location Plat represents the results of a survey made on the ground performed under the supervision of the undersigned.

Stan Drannon 2/18/14
STAN DRANNON OK LPLS 1672

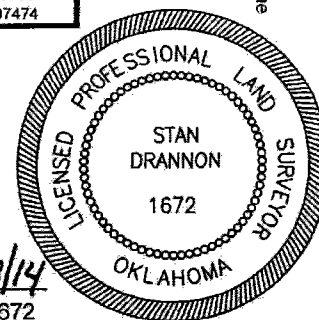

Please note that this location was staked on the ground under the supervision of a Licensed Professional Land Surveyor, but the accuracy of this survey is not guaranteed. Please contact Arkoma Surveying and Mapping promptly if any inconsistency is determined. GPS data is observed from RTK - GPS.