

Oklahoma Corporation Commission  
Oil & Gas Conservation Division  
Post Office Box 52000  
Oklahoma City, Oklahoma 73152-2000  
Rule 165: 10-3-25

Form 1002A

API No.: 35085212130000

**Completion Report**

Spud Date: March 09, 2014

OTC Prod. Unit No.: 085-214235

Drilling Finished Date: April 18, 2014

1st Prod Date: August 29, 2014

Completion Date: July 10, 2014

**Drill Type: HORIZONTAL HOLE**

Well Name: CHARLIE 1-27H28

Purchaser/Measurer:

Location: LOVE 27 6S 1E  
SE NW SW SW  
750 FSL 400 FWL of 1/4 SEC  
Derrick Elevation: 0 Ground Elevation: 921

First Sales Date: 08/29/2014

Operator: XTO ENERGY INC 21003

810 HOUSTON ST  
FORT WORTH, TX 76102-6203

Completion Type	
X	Single Zone
	Multiple Zone
	Commingled

Location Exception	
Order No	
	622340
	629003

Increased Density	
Order No	
There are no Increased Density records to display.	

Casing and Cement							
Type	Size	Weight	Grade	Feet	PSI	SAX	Top of CMT
CONDUCTOR	16	118	J-55	70		9	SURFACE
SURFACE	9 5/8	36	J-55	1990		510	SURFACE
PRODUCTION	5 1/2	23	P-110	19079		1890	11700

Liner								
Type	Size	Weight	Grade	Length	PSI	SAX	Top Depth	Bottom Depth
There are no Liner records to display.								

**Total Depth: 19079**

Packer	
Depth	Brand & Type
13796	RETRIEVABLE

Plug	
Depth	Plug Type
There are no Plug records to display.	

Initial Test Data										
Test Date	Formation	Oil BBL/Day	Oil-Gravity (API)	Gas MCF/Day	Gas-Oil Ratio Cu FT/BBL	Water BBL/Day	Pumpin or Flowing	Initial Shut-In Pressure	Choke Size	Flow Tubing Pressure
Sep 01, 2014	WOODFORD	425	41	503	1184	930	GAS LIFT	1075	64/64	220

Completion and Test Data by Producing Formation										
Formation Name: WOODFORD			Code: 319WDFD			Class: OIL				
<b>Spacing Orders</b>				<b>Perforated Intervals</b>						
<b>Order No</b>		<b>Unit Size</b>		<b>From</b>			<b>To</b>			
621848		640		14162			18960			
<b>Acid Volumes</b>				<b>Fracture Treatments</b>						
26,000 GALLONS				14 STAGES - 195,516 BTW, 464,300 POUNDS 100 MESH, 1,636,740 POUNDS 40/70, 1,325,046 POUNDS CRC 40/70						

Formation	Top
WOODFORD	14116

Were open hole logs run? No

Date last log run:

Were unusual drilling circumstances encountered? No

Explanation:

Other Remarks
IRREGULAR SECTION

Lateral Holes
Sec: 28 TWP: 6S RGE: 1E County: LOVE
NW SW SW SW
399 FSL 170 FWL of 1/4 SEC
Depth of Deviation: 12355 Radius of Turn: 1658 Direction: 266 Total Length: 5639
Measured Total Depth: 19079 True Vertical Depth: 13662 End Pt. Location From Release, Unit or Property Line: 170

FOR COMMISSION USE ONLY
Status: Accepted
1126171

RECEIVED

SEP 24 2014

Form 1002A Rev. 2009

OKLAHOMA CORPORATION COMMISSION

AS SUBMITTED

API NO. 085-21213
OTC PROD. UNIT NO. 085-214235

PLEASE TYPE OR USE BLACK NOTE:

Attach copy of original if recompletion or rec...

Rule 165:10-3-25

ORIGINAL AMENDED (Reason)

COMPLETION REPORT

TYPE OF DRILLING OPERATION: STRAIGHT HOLE, DIRECTIONAL HOLE, HORIZONTAL HOLE, SERVICE WELL

SPUD DATE 3/9/2014
DRLG FINISHED DATE 4/18/2014
DATE OF WELL COMPLETION 7/10/2014
1st PROD DATE 8/29/2014
RECOMP DATE
Longitude (if known) 97.194360W

COUNTY Love SEC 27 TWP 6S RGE 1E
LEASE NAME Charlie WELL NO. 1-27H28
SE 1/4 NW 1/4 SW 1/4 SW 1/4 FSL OF 1/4 SEC 750' FWL OF 1/4 SEC 400'
ELEVATION Derrick FL Ground 921' Latitude (if known) 34.000564N
OPERATOR NAME XTO Energy Inc. OTC/OCC OPERATOR NO. 21003
ADDRESS 210 Park Avenue, Suite 2350
CITY Oklahoma City STATE Oklahoma ZIP 73102

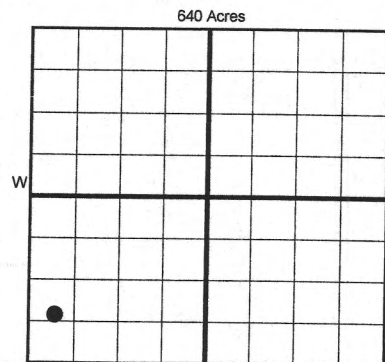

LOCATE WELL

COMPLETION TYPE

SINGLE ZONE
MULTIPLE ZONE
Application Date
COMINGLED
Application Date
LOCATION EXCEPTION ORDER NO. 622340
INCREASED DENSITY ORDER NO.

CASING & CEMENT (Form 1002C must be attached)

Table with columns: TYPE, SIZE, WEIGHT, GRADE, FEET, PSI, SAX, TOP OF CMT. Rows include CONDUCTOR, SURFACE, INTERMEDIATE, PRODUCTION, LINER.

PACKER @ 13,796' BRAND & TYPE Retrievable PLUG @ TYPE PLUG @ TYPE
PACKER @ BRAND & TYPE PLUG @ TYPE PLUG @ TYPE

TOTAL DEPTH 19,079'

COMPLETION & TEST DATA BY PRODUCING FORMATION

Table with columns: FORMATION, SPACING & SPACING ORDER NUMBER, CLASS, PERFORATED INTERVALS, ACID/VOLUME, FRACTURE TREATMENT (Fluids/Prop Amounts).

Min Gas Allowable (165:10-17-7) OR Oil Allowable (165:10-13-3)

Gas Purchaser/Measurer First Sales Date

8/29/2014

INITIAL TEST DATA

Table with columns: INITIAL TEST DATE, OIL-BBL/DAY, OIL-GRAVITY ( API), GAS-MCF/DAY, GAS-OIL RATIO CU FT/BBL, WATER-BBL/DAY, PUMPING OR FLOWING, INITIAL SHUT-IN PRESSURE, CHOKE SIZE, FLOW TUBING PRESSURE.

A record of the formations drilled through, and pertinent remarks are presented on the reverse. I declare that I have knowledge of the contents of this report and am authorized by my organization to make this report, which was prepared by me or under my supervision and direction, with the data and facts stated herein to be true, correct, and complete to the best of my knowledge and belief.

Signature of Debbie Waggoner

Debbie Waggoner

9/23/2014

405-319-3243

SIGNATURE

NAME (PRINT OR TYPE)

DATE

PHONE NUMBER

210 Park Avenue, Suite 2350

Oklahoma City

Ok

73102

debbie\_waggoner@xtoenergy.com

ADDRESS

CITY

STATE

ZIP

EMAIL ADDRESS

PLEASE TYPE OR USE BLACK INK ONLY  
FORMATION RECORD

Give formation names and tops, if available, or descriptions and thickness of formations drilled through. Show intervals cored or drillstem tested.

LEASE NAME CHARLIE WELL NO. 1-27H28

NAMES OF FORMATIONS	TOP
WOODFORD	14,116

FOR COMMISSION USE ONLY	
ITD on file <input type="checkbox"/> YES <input type="checkbox"/> NO	
APPROVED _____	DISAPPROVED _____
2) Reject Codes	

Were open hole logs run?	_____ yes	<u>X</u> no
Date Last log was run	_____	
Was CO <sub>2</sub> encountered?	_____ yes	<u>X</u> no at what depths? _____
Was H <sub>2</sub> S encountered?	_____ yes	<u>X</u> no at what depths? _____
Were unusual drilling circumstances encountered?	_____ yes	<u>X</u> no
If yes, briefly explain below: _____		

Other remarks:

IRREGULAR SECTION

\_\_\_\_\_

\_\_\_\_\_

\_\_\_\_\_

640 Acres

If more than three drainholes are proposed, attach a separate sheet indicating the necessary information.

Direction must be stated in degrees azimuth. Please note, the horizontal drainhole and its end point must be located within the boundaries of the lease or spacing unit.

Directional surveys are required for all drainholes and directional wells.

640 Acres

BOTTOM HOLE LOCATION FOR DIRECTIONAL HOLE

SEC	TWP	RGE	COUNTY
Spot Location	1/4	1/4	1/4
Measured Total Depth	True Vertical Depth		BHL From Lease, Unit, or Property Line:

BOTTOM HOLE LOCATION FOR HORIZONTAL HOLE: (LATERALS)

LATERAL #1

SEC	TWP	RGE	COUNTY	Love
Spot Location	NW 1/4	SW 1/4	SW 1/4	SW 1/4
Feet From 1/4 Sec Lines	FSL		397'	FWL 51.75'
Depth of Deviation	12,355'	Radius of Turn	1658.4'	Direction 266.4° Total Length 5639.7'
Measured Total Depth	19,079'	True Vertical Depth	13,662'	BHL From Lease, Unit, or Property Line: 397' FSL & 51.75' FWL

LATERAL #2

SEC	TWP	RGE	COUNTY
Spot Location	1/4	1/4	1/4
Depth of Deviation	Radius of Turn		Direction
Measured Total Depth	True Vertical Depth		Total Length
BHL From Lease, Unit, or Property Line:			

LATERAL #3

SEC	TWP	RGE	COUNTY
Spot Location	1/4	1/4	1/4
Depth of Deviation	Radius of Turn		Direction
Measured Total Depth	True Vertical Depth		Total Length
BHL From Lease, Unit, or Property Line:			