

Oklahoma Corporation Commission  
Oil & Gas Conservation Division  
Post Office Box 52000  
Oklahoma City, Oklahoma 73152-2000  
Rule 165: 10-3-25

Form 1002A

API No.: 35069201610000

**Completion Report**

Spud Date: April 04, 2014

OTC Prod. Unit No.: 069-214004

Drilling Finished Date: May 01, 2014

1st Prod Date: August 06, 2014

Completion Date: August 06, 2014

**Drill Type: HORIZONTAL HOLE**

Well Name: SITZES 1-24HR

Purchaser/Measurer:

Location: JOHNSTON 24 4S 5E  
SW SE SE SE  
315 FSL 545 FEL of 1/4 SEC  
Derrick Elevation: 0 Ground Elevation: 799

First Sales Date:

Operator: XTO ENERGY INC 21003

810 HOUSTON ST  
FORT WORTH, TX 76102-6203

Completion Type	
X	Single Zone
	Multiple Zone
	Commingled

Location Exception	
Order No	
	621283
	629000

Increased Density	
Order No	
There are no Increased Density records to display.	

Casing and Cement							
Type	Size	Weight	Grade	Feet	PSI	SAX	Top of CMT
CONDUCTOR	20	84.75	J-55	103		23	SURFACE
SURFACE	13 3/8	61	J-55	2005		1064	SURFACE
INTERMEDIATE	9 5/8	40	K-55	5182		470	3270
PRODUCTION	5 1/2	20, 23	P-110	10553		1240	2710

Liner								
Type	Size	Weight	Grade	Length	PSI	SAX	Top Depth	Bottom Depth
There are no Liner records to display.								

**Total Depth: 10560**

Packer	
Depth	Brand & Type
5709	RETRIEVABLE

Plug	
Depth	Plug Type
There are no Plug records to display.	

Initial Test Data										
Test Date	Formation	Oil BBL/Day	Oil-Gravity (API)	Gas MCF/Day	Gas-Oil Ratio Cu FT/BBL	Water BBL/Day	Pumpin or Flowing	Initial Shut-In Pressure	Choke Size	Flow Tubing Pressure
Sep 08, 2014	WOODFORD	250	38	216	864	460	FLOWING	700	OPEN	210

Completion and Test Data by Producing Formation										
Formation Name: WOODFORD			Code: 319WDFD			Class: OIL				
<b>Spacing Orders</b>				<b>Perforated Intervals</b>						
<b>Order No</b>		<b>Unit Size</b>		<b>From</b>			<b>To</b>			
434368		640		5664			10436			
<b>Acid Volumes</b>				<b>Fracture Treatments</b>						
There are no Acid Volume records to display.				14 STAGES - 187,283 BTW, 448,800 POUNDS 100 MESH, 3,929,700 POUNDS 40/70						

Formation	Top
WOODFORD	5664

Were open hole logs run? No

Date last log run:

Were unusual drilling circumstances encountered? No

Explanation:

Other Remarks
IRREGULAR SECTION

Lateral Holes
Sec: 24 TWP: 4S RGE: 5E County: JOHNSTON
NW SW SW SW
395 FSL 307 FWL of 1/4 SEC
Depth of Deviation: 5648 Radius of Turn: 360 Direction: 271 Total Length: 4448
Measured Total Depth: 10560 True Vertical Depth: 6106 End Pt. Location From Release, Unit or Property Line: 307

FOR COMMISSION USE ONLY
Status: Accepted
1126088

RECEIVED

SEP 15 2014

Form 1002A Rev. 2009

OKLAHOMA CORPORATION COMMISSION

API NO. 069-20161
OTC PROD. UNIT NO. 069-214004

PLEASE TYPE

Attach if rec

AS SUBMITTED

OKLAHOMA CORPORATION COMMISSION
Regulation Division
Box 52000
Oklahoma 73152-2000
5-10-3-25

ORIGINAL
AMENDED (Reason)

COMPLETION REPORT

TYPE OF DRILLING OPERATION
STRAIGHT HOLE
DIRECTIONAL HOLE
HORIZONTAL HOLE
SERVICE WELL

SPUD DATE 4/4/2014
DRLG FINISHED DATE 5/1/2014
DATE OF WELL COMPLETION 8/6/2014
1st PROD DATE 8/6/2014
RECOMP DATE
ELEVATION Derrick FL Ground 799'
Latitude (if known) 34.187952° N
Longitude (if known) 96.725299° W
OPERATOR NAME XTO Energy Inc.
OTC/OCC OPERATOR NO. 21003
ADDRESS 210 Park Avenue, Suite 2350
CITY Oklahoma City STATE Oklahoma ZIP 73102

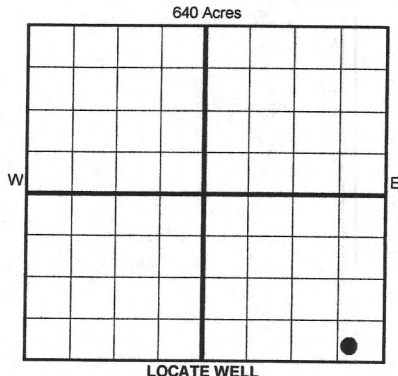

COMPLETION TYPE
SINGLE ZONE
MULTIPLE ZONE
COMMINGLED
LOCATION EXCEPTION ORDER NO. 621283
INCREASED DENSITY ORDER NO.

Table with columns: TYPE, SIZE, WEIGHT, GRADE, FEET, PSI, SAX, TOP OF CMT. Rows include CONDUCTOR, SURFACE, INTERMEDIATE, PRODUCTION, LINER.

PACKER @ 5709' BRAND & TYPE Retrievable PLUG @ TYPE PLUG @ TYPE TOTAL DEPTH 10,560'

Table with columns: FORMATION, SPACING & SPACING ORDER NUMBER, CLASS, PERFORATED INTERVALS, ACID/VOLUME, FRACTURE TREATMENT. Includes handwritten notes like '319 WDFD' and 'Reported to FracFocus'.

INITIAL TEST DATA
Min Gas Allowable (165:10-17-7)
OR
Oil Allowable (165:10-13-3)
Gas Purchaser/Measurer
First Sales Date

Table with columns: INITIAL TEST DATE, OIL-BBL/DAY, OIL-GRAVITY (API), GAS-MCF/DAY, GAS-OIL RATIO CU FT/BBL, WATER-BBL/DAY, PUMPING OR FLOWING, INITIAL SHUT-IN PRESSURE, CHOKE SIZE, FLOW TUBING PRESSURE.

A record of the formations drilled through, and pertinent remarks are presented on the reverse. I declare that I have knowledge of the contents of this report and am authorized by my organization to make this report, which was prepared by me or under my supervision and direction, with the data and facts stated herein to be true, correct, and complete to the best of my knowledge and belief.
Signature: Debbie Waggoner
Name: Debbie Waggoner
Date: 9/12/2014
Phone Number: 405-319-3243
Address: 210 Park Avenue, Suite 2350, Oklahoma City, OK 73102
Email: debbie\_waggoner@xtoenergy.com

