

OKLAHOMA CORPORATION COMMISSION
OIL & GAS CONSERVATION DIVISION
P.O. BOX 52000
OKLAHOMA CITY, OK 73152-2000
(Rule 165:10-3-1)

API NUMBER: 129 24002

Approval Date: 09/12/2014

Expiration Date: 03/12/2015

Horizontal Hole Oil & Gas

PERMIT TO DRILL

WELL LOCATION: Sec: 26 Twp: 13N Rge: 25W

County: ROGER MILLS

SPOT LOCATION: ☐ NE ☐ NE ☐ NW ☐ NE

FEET FROM QUARTER: FROM NORTH FROM WEST

SECTION LINES: 275 1295

Lease Name: REBECCA 26-13-25

Well No: 1H

Well will be 275 feet from nearest unit or lease boundary.

Operator
Name: APACHE CORPORATION

Telephone: 9184914900; 9184914

OTC/OCC Number: 6778 0

APACHE CORPORATION
6120 S YALE AVE STE 1500
TULSA, OK 74136-4224

U.S. FOREST SERVICE - BLACK KETTLE NATIONAL
GRASSLANDS
ROUTE 1, BOX 55B
ATTN: TOM SMELTZER
CHEYENNE OK 73628

Formation(s) (Permit Valid for Listed Formations Only):

	Name	Depth	Name	Depth
1	TONKAWA	9506	6	
2			7	
3			8	
4			9	
5			10	

Spacing Orders: 188118

Location Exception Orders: 201406523

Increased Density Orders:

Pending CD Numbers:

Special Orders:

Total Depth: 14500

Ground Elevation: 2263

Surface Casing: 620

Depth to base of Treatable Water-Bearing FM: 570

Under Federal Jurisdiction: Yes

Fresh Water Supply Well Drilled: No

Surface Water used to Drill: No

PIT 1 INFORMATION

Type of Pit System: ON SITE

Type of Mud System: WATER BASED

Chlorides Max: 90000 Average: 5000

Is depth to top of ground water greater than 10ft below base of pit? Y

Within 1 mile of municipal water well? N

Wellhead Protection Area? N

Pit is located in a Hydrologically Sensitive Area.

Category of Pit: 1B

Liner required for Category: 1B

Pit Location is BED AQUIFER

Pit Location Formation: OGALLALA

Approved Method for disposal of Drilling Fluids:

A. Evaporation/dewater and backfilling of reserve pit.

D. One time land application -- (REQUIRES PERMIT)

PERMIT NO: 14-27020

H. SEE MEMO

This permit does not address the right of entry or settlement of surface damages.

The duration of this permit is SIX MONTHS, except as otherwise provided by Rule 165: 10-3-1.

Rule 165: 10-3-4 (c) (7) (e) - The Operator shall give 24 Hours notice by telephone to the appropriate District Office of the Conservation Division as to when Surface Casing will be run.

PIT 2 INFORMATION

Type of Pit System: ON SITE

Type of Mud System: OIL BASED

Chlorides Max: 300000 Average: 200000

Is depth to top of ground water greater than 10ft below base of pit? Y

Within 1 mile of municipal water well? N

Wellhead Protection Area? N

Pit is located in a Hydrologically Sensitive Area.

Category of Pit: 3

Liner required for Category: 3

Pit Location is BED AQUIFER

Pit Location Formation: OGALLALA

HORIZONTAL HOLE 1

Sec 26 Twp 13N Rge 25W County ROGER MILLS

Spot Location of End Point: C S2 S2 S2

Feet From: SOUTH 1/4 Section Line: 330

Feet From: EAST 1/4 Section Line: 2640

Depth of Deviation: 9031

Radius of Turn: 573

Direction: 197

Total Length: 4646

Measured Total Depth: 14500

True Vertical Depth: 9682

End Point Location from Lease,
Unit, or Property Line: 330

Notes:

Category

Description

MEMO

9/4/2014 - G76 - PITS 1 & 2 - CONCRETE LINED PIT PER OPERATOR REQUEST, PIT 2 - OBM
RETURNED TO VENDOR, CUTTINGS PERMITTED PER DISTRICT

PENDING CD - 201406523

9/12/2014 - G72 - 26-13N-25W (E.O.)
X 188118 TMKW;
SHL NCT 275 FNL NCT 1295 FEL;
1ST PERF NCT 300 FNL NCT 500 FEL;
LAST PERF NCT 300 FSL NCT 1320 FEL OR FWL;
NO OPER NAMED;
REC 9/5/2014 (MCKEOWN)

SPACING - 188118

9/12/2014 - G72 - (640) 26-13N-25W
EXT 110840 TNKW, OTHERS
EXT OTHERS
EST OTHERS

This permit does not address the right of entry or settlement of surface damages.

129 24002 REBECCA 26-13-25 1H

The duration of this permit is SIX MONTHS, except as otherwise provided by Rule 165: 10-3-1.

Rule 165: 10-3-4 (c) (7) (e) - The Operator shall give 24 Hours notice by telephone to the appropriate District
Office of the Conservation Division as to when Surface Casing will be run.

129-24002

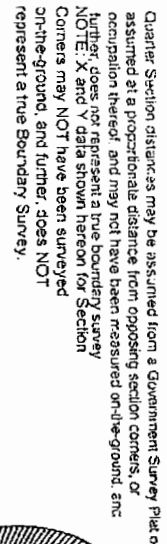

Stan Drannon 4/4/14
STAN DRANNON OK LPLS 1672

