

Oklahoma Corporation Commission
Oil & Gas Conservation Division
Post Office Box 52000
Oklahoma City, Oklahoma 73152-2000
Rule 165: 10-3-25

Form 1002A

API No.: 35019078330001

Completion Report

Spud Date: March 12, 1926

OTC Prod. Unit No.:

Drilling Finished Date: March 26, 1926

Amended

1st Prod Date: March 26, 1926

Amend Reason: ACIDIZED PERFORATIONS

Completion Date: March 26, 1926

Recomplete Date: April 08, 2014

Drill Type: STRAIGHT HOLE

Well Name: GRAHAM DEESE UNIT (C D WILLIAMS 3DD) 7-3

Purchaser/Measurer:

Location: CARTER 23 2S 3W
C NW SW NE
990 FSL 330 FWL of 1/4 SEC
Derrick Elevation: 0 Ground Elevation: 990

First Sales Date:

Operator: CITATION OIL & GAS CORPORATION 14156
PO BOX 690688
14077 CUTTEN RD
HOUSTON, TX 77269-0688

Completion Type	
X	Single Zone
	Multiple Zone
	Commingled

Location Exception
Order No
There are no Location Exception records to display.

Increased Density
Order No
There are no Increased Density records to display.

Casing and Cement							
Type	Size	Weight	Grade	Feet	PSI	SAX	Top of CMT
SURFACE	12 1/2			185		75	SURFACE
PRODUCTION	8 5/8	32		2403		125	SURFACE

Liner								
Type	Size	Weight	Grade	Length	PSI	SAX	Top Depth	Bottom Depth
LINER	5 1/2	14	J-55	1120	0	247	2327	3447

Total Depth: 3447

Packer	
Depth	Brand & Type
There are no Packer records to display.	

Plug	
Depth	Plug Type
There are no Plug records to display.	

Initial Test Data										
Test Date	Formation	Oil BBL/Day	Oil-Gravity (API)	Gas MCF/Day	Gas-Oil Ratio Cu FT/BBL	Water BBL/Day	Pumpin or Flowing	Initial Shut-In Pressure	Choke Size	Flow Tubing Pressure
Apr 08, 2014	DEESE	7	33.9			59	PUMPING			

Completion and Test Data by Producing Formation										
Formation Name: DEESE			Code: 404DEESS			Class: OIL				
Spacing Orders				Perforated Intervals						
Order No		Unit Size		From			To			
There are no Spacing Order records to display.				2628			2886			
Acid Volumes				Fracture Treatments						
SEE NOTES				SEE NOTES						

Formation	Top
DEESE	2628

Were open hole logs run? Yes
Date last log run: April 02, 2014

Were unusual drilling circumstances encountered? No
Explanation:

Other Remarks
SEE AS SUBMITTED COPY

FOR COMMISSION USE ONLY	
Status: Accepted	1124014

AS SUBMITTED

RECEIVED

APR 18 2014

Form 1002A Rev. 2009

API NO. 35-019-07833

PLEASE TYPE OR USE BLACK INK ONLY
NOTE: Attach copy of original 1002A if recompletion or reentry

Oil & Gas Conservation Division
Post Office Box 52000
Oklahoma City, Oklahoma 73152-2000
Rule 165:10-3-25

OKLAHOMA CORPORATION COMMISSION

ORIGINAL
AMENDED
Reason Amended Acidized perfs

COMPLETION REPORT

TYPE OF DRILLING OPERATION
STRAIGHT HOLE
DIRECTIONAL HOLE
HORIZONTAL HOLE
SERVICE WELL

SPUD DATE 03/12/1926
DRLG FINISHED DATE 03/26/1926

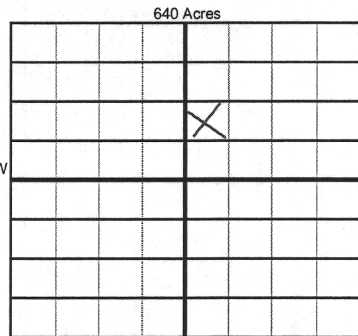

Form containing well location and completion data: COUNTY Carter, SEC 23, TWP 2S, RGE 3W; LEASE NAME Graham Deese, WELL NO. 7-3; RECOMP DATE 04/08/2014; OPERATOR Citation Oil & Gas Corp., OTC/OCC OPERATOR NO. 14156; CITY Houston, STATE TX, ZIP 77269.

COMPLETION TYPE

Form for completion type: SINGLE ZONE (checked), MULTIPLE ZONE, COMMINGLED. Includes location exception order numbers.

CASING & CEMENT (Form 1002C must be attached)

Table with columns: TYPE, SIZE, WEIGHT, GRADE, FEET, PSI, SAX, TOP OF CMT. Rows include Conductor, Surface (12 1/2", 185'), Intermediate, Production (8 5/8", 32#, 2403'), and Liner (5-1/2", 14#, J-55, 2327'-3447').

PACKER @ BRAND & TYPE PLUG @ TYPE PLUG @ TYPE TOTAL DEPTH 3447'

COMPLETION & TEST DATA BY PRODUCING FORMATION

Table for completion and test data by producing formation. Includes columns for FORMATION (Deese), SPACING & SPACING ORDER NUMBER, CLASS (Oil), PERFORATED INTERVALS (2876'-2886', 2628'-2638'), ACID/VOLUME (See notes), FRACTURE TREATMENT (See notes), and No Frac.

Oil Allowable (165:10-13-3), Minimum Gas Allowable (165:10-17-7), Gas Purchaser/Measurer, 1st Sales Date

INITIAL TEST DATA

Table for initial test data: INITIAL TEST DATE 04/08/2014, OIL-BBL/DAY 7, OIL-GRAVITY (API) 33.9, GAS-MCF/DAY 0, GAS-OIL RATIO CU FT/BBL 0, WATER-BBL/DAY 59, PUMPING OR FLOWING Pumping.

A record of the formations drilled through, and pertinent remarks are presented on the reverse. I declare that I have knowledge of the contents of this report and am authorized by my organization to make this report, which was prepared by me or under my supervision and direction, with the data and facts stated herein to be true, correct, and complete to the best of my knowledge and belief.

Signature block for Rena Schindewolf, Completion Analyst, dated 04/15/2014, phone number (281) 891-1585, email nschindewolf@cogc.com.

PLEASE TYPE OR USE BLACK INK ONLY
FORMATION RECORD

Give formation names and tops, if available, or descriptions and thickness of formation: drilled through. Show intervals cored or drillstem tested.

LEASE NAME Graham Deese WELL NO. 7-3

NAMES OF FORMATIONS	TOP
Deese	2628'

FOR COMMISSION USE ONLY	
ITD on file	<input type="checkbox"/> YES <input type="checkbox"/> NO
APPROVED	DISAPPROVED
2) Reject Codes	

Were open hole logs run? yes no

Date Last log was run 04/02/2014

Was CO₂ encountered? yes no at what depths? _____

Was H₂S encountered? yes no at what depths? _____

Were unusual drilling circumstances encountered? yes no
If yes, briefly explain below

Other remarks: Perfd intervals 2876'-2886' & 2628'-2638' @ 4 spf & 90 deg phasing. Acidized perfs 2984'-4304' w/ 2375 gals 15% NEFE acid w/ 10% Xylenc. Loaded tbg w/ 17 bbls. EIR w/ 20 BLW @ 5 bpm & 860#. Pmpd 500 gals 15% NEFE HCL @ 5 bpm & 860# w/ 650# RS & 12 BLW @ 5 bpm & 840#. Acid @ 5 bpm & 790#. 650# RS w/ 12 BLW @ 5 bpm & 840#, 500 gals acid @ 5 bpm & 820#, 650# RS w/ 12 BLW @ 5 bpm & 860#, 875 gals NEFE @ 5 bpm & 920# & flush w/ 29 BLW @ 5 bpm & 1020#. Acidized perfs 2876'-2886' w/ 250 gals 15% NEFE acid w/ 10% Xylene. Loaded tbg w/ 13 bbls. BD perfs @ 1850#. EIR @ 5 bpm & 1440#. Acid @ 5 bpm & 1430#. Flushed w/ 19 BLW @ 5 bpm & 1450#. Acidized perfs 2584'-2638' OA. Loaded tbg w/ 14 bbls. EIR @ 6 bpm z& 680#. Pmpd 400 gals 15% NEFE @ 6 bpm & 640#, 600# RS w/ 11 BLW @ 5 bpm & 670#, 400 gals 15% NEFE @ 6 bpm & 650#. Flushed w/ 19 BLW @ 6 bpm & 810#. Acidized perfs 2405'-2446' OA. Loaded tbg w/ 12 bbls. EIR @ 5 bpm & 1070#. Pmpd 350 gals 15% NEFE acid @ 5 bpm & 1260#, 550# RS w/ 10 BLW @ 5 bpm & 1320#, 375 gals NEFE @ 5 bpm & 1320#. Flushed w/ 16 BLW @ 5 bpm & 1200#.

TIH w/ seating nipple & tbg. Landed SN @ 3342'. TIH w/ pmp & rods. Spaced out pmp. Hung on horsehead. Put on production.

If more than three drainholes are proposed, attach a separate sheet indicating the necessary information.

Direction must be stated in degrees azimuth. Please note, the horizontal drainhole and its end point must be located within the boundaries of the lease or spacing unit.

Directional surveys are required for all drainholes and directional wells.

640 Acres

1/4	1/4	1/4	1/4	Feet From 1/4 Sec Lines	FSL	FWL
Measured Total Depth	True Vertical Depth	BHL From Lease, Unit, or Property Line				

BOTTOM HOLE LOCATION FOR HORIZONTAL HOLE: (LATERALS)

LATERAL #1

SEC	TWP	RGE	COUNTY				
Spot Location	1/4	1/4	1/4	1/4	Feet From 1/4 Sec Lines	FSL	FWL
Depth of Deviation	Radius of Turn		Direction	Total Length			
Measured Total Depth	True Vertical Depth	End Pt Location From Lease, Unit or Property Line					

LATERAL #2

SEC	TWP	RGE	COUNTY				
Spot Location	1/4	1/4	1/4	1/4	Feet From 1/4 Sec Lines	FSL	FWL
Depth of Deviation	Radius of Turn		Direction	Total Length			
Measured Total Depth	True Vertical Depth	End Pt Location From Lease, Unit or Property Line					

LATERAL #3

SEC	TWP	RGE	COUNTY				
Spot Location	1/4	1/4	1/4	1/4	Feet From 1/4 Sec Lines	FSL	FWL
Depth of Deviation	Radius of Turn		Direction	Total Length			
Measured Total Depth	True Vertical Depth	End Pt Location From Lease, Unit or Property Line					