

Oklahoma Corporation Commission  
Oil & Gas Conservation Division  
Post Office Box 52000  
Oklahoma City, Oklahoma 73152-2000  
Rule 165: 10-3-25

Form 1002A

API No.: 35047247330000

**Completion Report**

Spud Date: October 16, 2013

OTC Prod. Unit No.: 047-212220-0-0000-70

Drilling Finished Date: November 02, 2013

1st Prod Date: December 30, 2013

Completion Date: December 30, 2013

**Drill Type: HORIZONTAL HOLE**

Min Gas Allowable: Yes

Well Name: WEINKAUF 1-36H

Purchaser/Measurer: PVR

Location: GARFIELD 36 20N 3W  
W2 NW NE NE  
330 FNL 1479 FWL of 1/4 SEC  
Latitude: 36.176889 Longitude: 97.460436  
Derrick Elevation: 1152 Ground Elevation: 1134

First Sales Date: 12/31/2013

Operator: CROWN ENERGY COMPANY 19779

1117 NW 24TH ST  
OKLAHOMA CITY, OK 73106-5615

Completion Type	
X	Single Zone
	Multiple Zone
	Commingled

Location Exception
Order No
621584

Increased Density
Order No
There are no Increased Density records to display.

Casing and Cement							
Type	Size	Weight	Grade	Feet	PSI	SAX	Top of CMT
SURFACE	9 5/8	36	J-55	420		160	SURFACE
PRODUCTION	7	26	N-80	5448		240	3817

Liner								
Type	Size	Weight	Grade	Length	PSI	SAX	Top Depth	Bottom Depth
LINER	4 1/2	11.6	P-110	9144	0	0	0	9144

**Total Depth: 9149**

Packer	
Depth	Brand & Type
There are no Packer records to display.	

Plug	
Depth	Plug Type
There are no Plug records to display.	

Initial Test Data										
Test Date	Formation	Oil BBL/Day	Oil-Gravity (API)	Gas MCF/Day	Gas-Oil Ratio Cu FT/BBL	Water BBL/Day	Pumpin or Flowing	Initial Shut-In Pressure	Choke Size	Flow Tubing Pressure
Dec 30, 2013	CLEVELAND	51	45	320	6275	1753	PUMPING	1115		

Completion and Test Data by Producing Formation										
Formation Name: CLEVELAND			Code: 405CLVD			Class: OIL				
<b>Spacing Orders</b>				<b>Perforated Intervals</b>						
<b>Order No</b>	<b>Unit Size</b>			<b>From</b>			<b>To</b>			
607925	320			There are no Perf. Intervals records to display.						
<b>Acid Volumes</b>				<b>Fracture Treatments</b>						
There are no Acid Volume records to display.				51,875, 1,954,080 POUNDS 30/50 SAND, 105,320 POUNDS 40/70 SAND						

Formation	Top
HOOVER	2820
OREAD	3304
ENDICOTT	3400
TONKAWA	3690
AVANT	3994
PERRY GAS SAND	4052
LAYTON	4403
HOGSHOOTER	4610
CHECKERBOARD	5106
CLEVELAND	5278

Were open hole logs run? Yes

Date last log run: October 25, 2013

Were unusual drilling circumstances encountered? No

Explanation:

Other Remarks
OCC - THIS WELL IS AN OPEN HOLE COMPLETION FROM BOTTOM OF THE 7" CASING AT 5,448' TO TERMINUS AT 9,149'. THE 4 1/2" LINER IS OPEN FROM 5,702' TO 8,990' BUT THE LINER IS NOT CEMENTED. IRREGULAR SECTION.

**Lateral Holes**

Sec: 36 TWP: 20N RGE: 3W County: LOGAN

NW SE SE SE

2269 FNL 1986 FWL of 1/4 SEC

Depth of Deviation: 4185 Radius of Turn: 1262 Direction: 173 Total Length: 3702

Measured Total Depth: 9149 True Vertical Depth: 4896 End Pt. Location From Release, Unit or Property Line: 371

**FOR COMMISSION USE ONLY**

1123597

Status: Accepted

047-212220-0-0000-70  
 083-212220-0-0000-30

**AS SUBMITTED RECEIVED**

Form 1002A  
 Rev. 2009

API NO. 047-24733  
 OTC PROD. UNIT NO.

PLEASE TYPE OR USE BLACK INK ONLY  
 NOTE:

Attach copy of original 1002A  
 if recompletion or reentry.

MAR 17 2014

OKLAHOMA CORPORATION  
 COMMISSION

ORIGINAL  
 AMENDED (Reason)

Rule 165:10-3-25

COMPLETION REPORT

TYPE OF DRILLING OPERATION  
 STRAIGHT HOLE  DIRECTIONAL HOLE  HORIZONTAL HOLE  
 SERVICE WELL  
 If directional or horizontal, see reverse for bottom hole location.

SPUD DATE 10/16/13  
 DRLG FINISHED DATE 11/2/13  
 DATE OF WELL COMPLETION 12/30/13  
 1st PROD DATE 12/30/13  
 RECOMP DATE  
 Longitude (if known) 97.460436  
 OTC/OCC OPERATOR NO. 19779

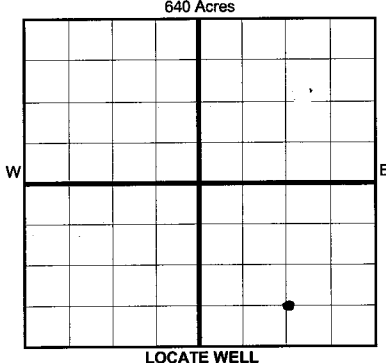

COUNTY Garfield SEC 36 TWP 20N RGE 3W  
 LEASE NAME Weinkauf WELL NO. 1-36H  
 W2 1/4 NW 1/4 NE 1/4 NE 1/4 FNL OF 1/4 SEC 330' FWL OF 1/4 SEC 1479'  
 ELEVATIO N Derrick 1152' Ground 1134' Latitude (if known) 36.176889  
 OPERATOR NAME Crown Energy  
 ADDRESS 1117 N.W. 24Th  
 CITY OKC STATE OK ZIP 73106

COMPLETION TYPE  
 SINGLE ZONE  
 MULTIPLE ZONE  
 Application Date  
 COMMINGLED  
 Application Date  
 LOCATION EXCEPTION ORDER # 621504 201308107  
 INCREASED DENSITY ORDER NO.

CASING & CEMENT (Form 1002C must be attached)							
TYPE	SIZE	WEIGHT	GRADE	FEET	PSI	SAX	TOP OF CMT
CONDUCTOR						160	
SURFACE	9 5/8"	36#	J55	420'		100	Surface
INTERMEDIATE	7"	26#	N80	5,448'		140	3817'
PRODUCTION						240	
LINER	4 1/2"	11.6#	P110	9,144' --0			
TOTAL DEPTH							9,149'

PACKER @ \_\_\_\_\_ BRAND & TYPE \_\_\_\_\_ PLUG @ \_\_\_\_\_ TYPE \_\_\_\_\_ PLUG @ \_\_\_\_\_ TYPE \_\_\_\_\_  
 PACKER @ \_\_\_\_\_ BRAND & TYPE \_\_\_\_\_ PLUG @ \_\_\_\_\_ TYPE \_\_\_\_\_ PLUG @ \_\_\_\_\_ TYPE \_\_\_\_\_

COMPLETION & TEST DATA BY PRODUCING FORMATION 405CLVD

FORMATION	Cleveland						
SPACING & SPACING ORDER NUMBER	320-607925						Reported to FracFocus
CLASS: Oil, Gas, Dry, Inj, Disp, Comm Disp, Svc	Oil						
PERFORATED INTERVALS	Liner w/ 14 frac sleeves	open hole					
	5702'-8,990' MD						
ACID/VOLUME							
FRACTURE TREATMENT (Fluids/Prop Amounts)	51,875						
	1,954,080 #30/50SD						
	105,320 #40/70SD						

Min Gas Allowable (165:10-17-7)  
 OR  
 Oil Allowable (165:10-13-3)

Gas Purchaser/Measurer PVR  
 First Sales Date 12/31/2013

INITIAL TEST DATA

INITIAL TEST DATE	12/30/2013			
OIL-BBL/DAY	51			
OIL-GRAVITY ( API)	45			
GAS-MCF/DAY	320			
GAS-OIL RATIO CU FT/BBL	6			
WATER-BBL/DAY	1753			
PUMPING OR FLOWING	Pumping			
INITIAL SHUT-IN PRESSURE	1115#			
CHOKE SIZE				
FLOW TUBING PRESSURE				

A record of the formations drilled through, and pertinent remarks are presented on the reverse. I declare that I have knowledge of the contents of this report and am authorized by my organization to make this report, which was prepared by me or under my supervision and direction, with the data and facts stated herein to be true, correct, and complete to the best of my knowledge and belief.

SIGNATURE: Tia Yarbrough/Prod Tech  
 ADDRESS: 1117 N.W. 24th  
 CITY: OKC STATE: OK ZIP: 73106  
 DATE: 2/28/2014 PHONE NUMBER: 405-526-0111  
 EMAIL ADDRESS: tiayarbrough@crownc.com

PLEASE TYPE OR USE BLACK INK ONLY  
FORMATION RECORD

Give formation names and tops, if available, or descriptions and thickness of formations drilled through. Show intervals cored or drillstem tested.

LEASE NAME Weinkauf WELL NO. 1-36H

NAMES OF FORMATIONS	TOP
Hoover	2820' MD
Oread	3304' MD
Endicott	3400' MD
Tonkawa	3690' MD
Avant	3994' MD
Perry Gas Sand	4052' MD
Layton	4403' MD
Hogshooter	4610' MD
Checkerboard	5106' MD
Cleveland	5278' MD

FOR COMMISSION USE ONLY

ITD on file  YES  NO

APPROVED \_\_\_\_\_ DISAPPROVED \_\_\_\_\_

2) Reject Codes \_\_\_\_\_

Were open hole logs run?  yes  no

Date Last log was run 10/25/2013

Was CO<sub>2</sub> encountered?  yes  no at what depths? \_\_\_\_\_

Was H<sub>2</sub>S encountered?  yes  no at what depths? \_\_\_\_\_

Were unusual drilling circumstances encountered?  yes  no  
If yes, briefly explain below \_\_\_\_\_

Other remarks: *OCG - This well is an open hole completion from bottom of the 7" casing at 5448' to terminus at 9149'. The 4 1/2" liner is open from 5702' to 8990' but the liner is not cemented*

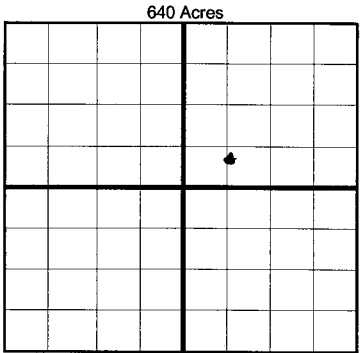

If more than three drainholes are proposed, attach a separate sheet indicating the necessary information.

Direction must be stated in degrees azimuth. Please note, the horizontal drainhole and its end point must be located within the boundaries of the lease or spacing unit.

Directional surveys are required for all drainholes and directional wells.

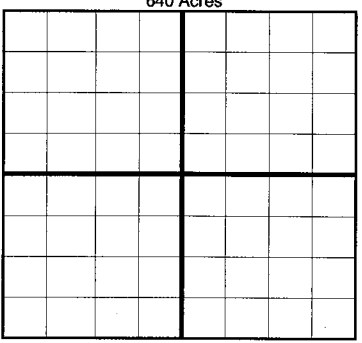

BOTTOM HOLE LOCATION FOR DIRECTIONAL HOLE

SEC	TWP	RGE	COUNTY
Spot Location			
1/4	1/4	1/4	1/4
Measured Total Depth		True Vertical Depth	Feet From 1/4 Sec Lines FSL FWL
BHL From Lease, Unit, or Property Line:			

BOTTOM HOLE LOCATION FOR HORIZONTAL HOLE: (LATERALS)

LATERAL #1

SEC	TWP	RGE	#W	COUNTY
36	20N			Logan
Spot Location				
SE 1/4	SE 1/4	NE 1/4		
Depth of Deviation 4185'		Radius of Turn 1262'	Direction 173.69	FSL 1227' FWL 1576'
Measured Total Depth 9149'		True Vertical Depth 4896'	Total Length 3702'	
BHL From Lease, Unit, or Property Line: 371' FSL 650' FEL				

LATERAL #2

SEC	TWP	RGE	COUNTY
Spot Location			
1/4	1/4	1/4	1/4
Depth of Deviation		Radius of Turn	Direction
Measured Total Depth		True Vertical Depth	Total Length
BHL From Lease, Unit, or Property Line:			

LATERAL #3

SEC	TWP	RGE	COUNTY
Spot Location			
1/4	1/4	1/4	1/4
Depth of Deviation		Radius of Turn	Direction
Measured Total Depth		True Vertical Depth	Total Length
BHL From Lease, Unit, or Property Line:			