

Oklahoma Corporation Commission
 Oil & Gas Conservation Division
 Post Office Box 52000
 Oklahoma City, Oklahoma 73152-2000
 Rule 165: 10-3-25

Form 1002A

API No.: 35095206130000

Completion Report

Spud Date: April 02, 2013

OTC Prod. Unit No.: 095-212119

Drilling Finished Date: June 07, 2013

1st Prod Date: February 06, 2014

Completion Date: February 03, 2014

Drill Type: HORIZONTAL HOLE

Well Name: VERONICA 6-16H9

Purchaser/Measurer:

Location: MARSHALL 16 5S 6E
 NE NE NW NW
 228 FNL 1121 FWL of 1/4 SEC
 Derrick Elevation: 0 Ground Elevation: 763

First Sales Date:

Operator: XTO ENERGY INC 21003

810 HOUSTON ST
 FORT WORTH, TX 76102-6203

Completion Type	
X	Single Zone
	Multiple Zone
	Commingled

Location Exception	
Order No	
	621255
	619153

Increased Density	
Order No	
	610082

Casing and Cement							
Type	Size	Weight	Grade	Feet	PSI	SAX	Top of CMT
CONDUCTOR	16	75	J-55	80		12	SURFACE
SURFACE	9 5/8	36	J-55	1058		410	SURFACE
PRODUCTION	5 1/2	20	P-110	13180		1180	6150

Liner								
Type	Size	Weight	Grade	Length	PSI	SAX	Top Depth	Bottom Depth
There are no Liner records to display.								

Total Depth: 13180

Packer	
Depth	Brand & Type
There are no Packer records to display.	

Plug	
Depth	Plug Type
There are no Plug records to display.	

Initial Test Data										
Test Date	Formation	Oil BBL/Day	Oil-Gravity (API)	Gas MCF/Day	Gas-Oil Ratio Cu FT/BBL	Water BBL/Day	Pumpin or Flowing	Initial Shut-In Pressure	Choke Size	Flow Tubing Pressure
Feb 17, 2014	WOODFORD	140	38	1950	13929	339	FLOWING	800	OPEN	530

Completion and Test Data by Producing Formation										
Formation Name: WOODFORD			Code: 319WDFD			Class: OIL				
Spacing Orders				Perforated Intervals						
Order No		Unit Size		From			To			
584675		640		8011			13000			
Acid Volumes				Fracture Treatments						
There are no Acid Volume records to display.				14 STAGES - 194,309 BTW, 827,960 POUNDS 100 MESH, 3,537,780 POUNDS 40/70						

Formation	Top
------------------	------------

Were open hole logs run? No
Date last log run:

Were unusual drilling circumstances encountered? No
Explanation:

Other Remarks
IRREGULAR SECTION

Lateral Holes
Sec: 9 TWP: 5S RGE: 6E County: MARSHALL NW NE NW NW 60 FNL 938 FWL of 1/4 SEC Depth of Deviation: 6557 Radius of Turn: 2657 Direction: 358 Total Length: 5450 Measured Total Depth: 13180 True Vertical Depth: 7839 End Pt. Location From Release, Unit or Property Line: 60

FOR COMMISSION USE ONLY	
Status: Accepted	1123234

API NO. 095-20613
 OTC PROD. UNIT NO. 095-212119

PLEASE TYPE OR USE BLACK INK ONLY
 NOTE: Attach copy of original 1002A if recompleting



RECEIVED Form 1002A Rev. 2007

FEB 20 2014

OKLAHOMA CORPORATION COMMISSION

ORIGINAL
 AMENDED
 Reason Amended

COMPLETION REPORT

TYPE OF DRILLING OPERATION
 STRAIGHT HOLE DIRECTIONAL HOLE HORIZONTAL HOLE
 SERVICE WELL

SPUD DATE 4/2/2013

DRLG FINISHED 6/7/2013

WELL COMPLETION 2/3/2014

1ST PROD DATE 2/6/2014

RECOMP DATE

If directional or horizontal, see reverse for bottom hole location.

COUNTY Marshall SEC 16 TWP 5S RGE 6E
 LEASE NAME Veronica WELL NO. 6-16H9
 SHL NE 1/4 NE 1/4 NW 1/4 NW 1/4 FNL FWL OF 1/4 SE 228' 1121'
 ELEVATION Demick Fl GL: 763' Ground Latitude if Known N34.128315° Longitude if Known W96.684824°
 OPERATOR NAME XTO ENERGY INC. OTC/OCC OPERATOR NO. 21003
 ADDRESS 210 PARK AVENUE, SUITE 2350
 CITY OKLAHOMA CITY STATE OKLAHOMA ZIP 73102

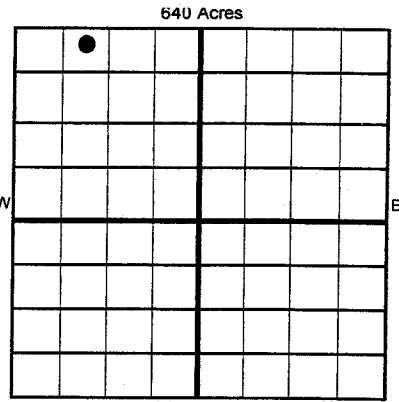

COMPLETION TYPE
 SINGLE ZONE
 MULTIPLE ZONE
 Application Date
 COMMINGLED
 Application Date
 LOCATION EXCEPTION ORDER NO. 610341, 610175
 INCREASED DENSITY ORDER NO. 610082

CASING & CEMENT (Form 1002C must be attached)

TYPE	SIZE	WEIGHT	GRADE	FEET	PSI	SAX	TOP OF CMI
Conductor	16"	75	J-55	80			Surface
Surface	9 5/8"	36	J-55	1058		410	Surface
Intermediate							
Production							
Liner	5 1/2"	20	P-110	13,136		1180	6150'
				TOTAL DEPTH		13,180'	

PACKER @ _____ BRAND & TYPE _____ PLUG @ _____ TYPE _____ PLUG @ _____ TYPE _____
 PACKER @ _____ BRAND & TYPE _____ PLUG @ _____ TYPE _____ PLUG @ _____ TYPE _____

COMPLETION & TEST DATA BY PRODUCING FORMATION

319W DFD

FORMATION	WOODFORD				
SPACING & SPACING ORDER NUMBER	640:584675				Reported to Free Focus
CLASS: Oil, Gas, Dry, Inj, Disp, Comm Disp, Svc	Oil				
PERFORATED INTERVALS	14 Stages 8011-13,000				
ACID/VOLUME Fracture Treatment (Fluids/Prop Amounts)	0 acid 194,309 BTW 827,960# 100 Mesh 3,537,780# 40/70				

Request minimum gas allowable (165:10-17-7) Gas Purchaser/Measurer _____ 1st Sales Date _____

INITIAL TEST DATA

INITIAL TEST DATE	2/17/2014			
OIL-BBL/DAY	140			
OIL-GRAVITY (API)	38			
GAS-MCF/DAY	1950			
GAS-OIL RATIO CU FT/BBL	13,928			
WATER-BBL/DAY	339			
PUMPING OR FLOWING	Flowing			
INITIAL SHUT-IN PRESSURE	800			
CHOKE SIZE	Open			
FLOW TUBING PRESSURE	530			

A record of the formations drilled through, and pertinent remarks are presented on the reverse. I declare that I have knowledge of the contents of this report and am authorized by my organization to make this report, which was prepared by me or under my supervision and direction, with the data and facts stated herein to be true, correct, and complete to the best of my knowledge and belief.

SIGNATURE *Debbie Waggoner* Debbie Waggoner, Regulatory Analyst 2/19/2014 405-232-4011
 NAME (PRINT OR TYPE) DATE PHONE NUMBER
 ADDRESS 210 Park Avenue, Suite 2350 Oklahoma City Oklahoma 73102 debbie.waggoner@xtoenergy.com
 CITY STATE ZIP EMAIL ADDRESS

PLEASE TYPE OR USE BLACK INK ONLY
FORMATION RECORD

Give formation names and tops, if available, or descriptions and thickness of formations drilled through. Show intervals cored or drillstem tested.

LEASE NAME VERONICA

WELL NO. 6-16H9

NAMES OF FORMATIONS	TOP

FOR COMMISSION USE ONLY	
ITD on file <input type="checkbox"/> YES <input type="checkbox"/> NO	
APPROVED _____	DISAPPROVED _____
2) Reject Codes	

Were open hole logs run? yes <input checked="" type="checkbox"/> no
Date Last log was run
Was CO ₂ encountered? yes <input checked="" type="checkbox"/> no at what depths?
Was H ₂ S encountered? yes <input checked="" type="checkbox"/> no at what depths?
Were unusual drilling circumstances encountered? yes <input checked="" type="checkbox"/> no If yes, briefly explain.

Other remarks: **IRREGULAR SECTION**

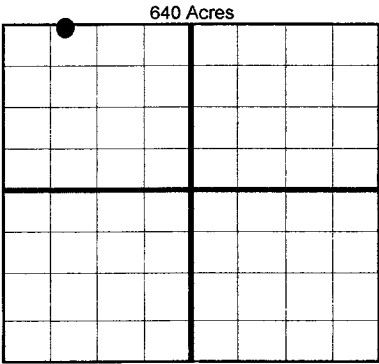

BOTTOM HOLE LOCATION FOR DIRECTIONAL HOLE					
SEC	TWP	RGE	COUNTY		
Spot Location			Feet From 1/4 Sec Lines		
1/4	1/4	1/4	1/4	FSL	FWL
Measured Total Depth		True Vertical Depth		BHL From Lease, Unit, or Property Line:	

BOTTOM HOLE LOCATION FOR HORIZONTAL HOLE: (LATERALS)							
LATERAL #1							
SEC	TWP	RGE	COUNTY				
9	5S	6E	Marshall				
Spot Location			Feet From 1/4 Sec Lines				
NW	NE	1/4	NW	1/4	NW	1/4	60' FNL 938' FWL
Depth of Deviation		Radius of Turn		Direction		Total Length	
6557'		2657'		358°		5450'	
Measured Total Depth		True Vertical Depth		End Pt Location From Lease, Unit or Property Line:			
13,180'		7839'		60' FNL & 938' FWL			

If more than three drainholes are proposed, attach a separate sheet indicating the necessary information.

Direction must be stated in degrees azimuth. Please note, the horizontal drainhole and its end point must be located within the boundaries of the lease or spacing unit.

Directional surveys are required for all drainholes and directional wells.

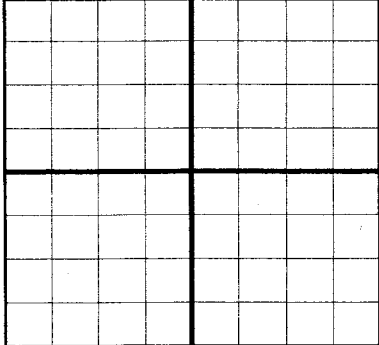

LATERAL #2							
SEC	TWP	RGE	COUNTY				
Spot Location			Feet From 1/4 Sec Lines				
1/4	1/4	1/4	1/4	FSL		FWL	
Depth of Deviation		Radius of Turn		Direction		Total Length	
Measured Total Depth		True Vertical Depth		End Pt Location From Lease, Unit or Property Line:			

LATERAL #3							
SEC	TWP	RGE	COUNTY				
Spot Location			Feet From 1/4 Sec Lines				
1/4	1/4	1/4	1/4	FSL		FWL	
Depth of Deviation		Radius of Turn		Direction		Total Length	
Measured Total Depth		True Vertical Depth		End Pt Location From Lease, Unit or Property Line:			