

Oklahoma Corporation Commission  
 Oil & Gas Conservation Division  
 Post Office Box 52000  
 Oklahoma City, Oklahoma 73152-2000  
 Rule 165: 10-3-25

Form 1002A

API No.: 35117234920001

**Completion Report**

Spud Date: August 06, 2012

OTC Prod. Unit No.:

Drilling Finished Date: August 16, 2012

**Amended**

1st Prod Date: September 21, 2012

Amend Reason: ADDITIONAL PERFORATIONS TO UNITIZED FORMATIONS (CLEVELAND SAND)

Completion Date: September 06, 2012

Recomplete Date: November 19, 2013

**Drill Type: STRAIGHT HOLE**

Well Name: WALKER 3A

Purchaser/Measurer:

Location: PAWNEE 29 21N 8E  
 S2 N2 NW NE  
 2145 FSL 660 FWL of 1/4 SEC  
 Derrick Elevation: 971 Ground Elevation: 963

First Sales Date:

Operator: MID-CON ENERGY OPERATING LLC 23271

2431 E 61ST ST STE 850  
 TULSA, OK 74136-1236

Completion Type	
X	Single Zone
	Multiple Zone
	Commingled

Location Exception
Order No
There are no Location Exception records to display.

Increased Density
Order No
There are no Increased Density records to display.

Casing and Cement							
Type	Size	Weight	Grade	Feet	PSI	SAX	Top of CMT
SURFACE	9 5/8	32.3	J-55	220		175	SURFACE
PRODUCTION	7	23	J-55	2742		400	502

Liner								
Type	Size	Weight	Grade	Length	PSI	SAX	Top Depth	Bottom Depth
There are no Liner records to display.								

**Total Depth: 2881**

Packer	
Depth	Brand & Type
There are no Packer records to display.	

Plug	
Depth	Plug Type
There are no Plug records to display.	

Initial Test Data										
Test Date	Formation	Oil BBL/Day	Oil-Gravity (API)	Gas MCF/Day	Gas-Oil Ratio Cu FT/BBL	Water BBL/Day	Pumpin or Flowing	Initial Shut-In Pressure	Choke Size	Flow Tubing Pressure
Sep 21, 2012	LAYTON	38				82	PUMPING			
Nov 26, 2013	CLEVELAND	21				160	PUMPING			

Completion and Test Data by Producing Formation														
Formation Name: LAYTON	Code: 405LYTN	Class: OIL												
<table border="1"> <thead> <tr> <th colspan="2">Spacing Orders</th> </tr> <tr> <th>Order No</th> <th>Unit Size</th> </tr> </thead> <tbody> <tr> <td>609199</td> <td>UNIT</td> </tr> </tbody> </table>		Spacing Orders		Order No	Unit Size	609199	UNIT	<table border="1"> <thead> <tr> <th colspan="2">Perforated Intervals</th> </tr> <tr> <th>From</th> <th>To</th> </tr> </thead> <tbody> <tr> <td>1358</td> <td>1422</td> </tr> </tbody> </table>	Perforated Intervals		From	To	1358	1422
Spacing Orders														
Order No	Unit Size													
609199	UNIT													
Perforated Intervals														
From	To													
1358	1422													
<table border="1"> <thead> <tr> <th>Acid Volumes</th> </tr> </thead> <tbody> <tr> <td>24 BARRELS 7.5% SME</td> </tr> </tbody> </table>		Acid Volumes	24 BARRELS 7.5% SME	<table border="1"> <thead> <tr> <th>Fracture Treatments</th> </tr> </thead> <tbody> <tr> <td>500 BARRELS GEL WATER, 39,800 POUNDS 12/20 BRADY SAND</td> </tr> </tbody> </table>	Fracture Treatments	500 BARRELS GEL WATER, 39,800 POUNDS 12/20 BRADY SAND								
Acid Volumes														
24 BARRELS 7.5% SME														
Fracture Treatments														
500 BARRELS GEL WATER, 39,800 POUNDS 12/20 BRADY SAND														

Formation Name: CLEVELAND	Code: 405CLVD	Class: OIL												
<table border="1"> <thead> <tr> <th colspan="2">Spacing Orders</th> </tr> <tr> <th>Order No</th> <th>Unit Size</th> </tr> </thead> <tbody> <tr> <td>609199</td> <td>UNIT</td> </tr> </tbody> </table>		Spacing Orders		Order No	Unit Size	609199	UNIT	<table border="1"> <thead> <tr> <th colspan="2">Perforated Intervals</th> </tr> <tr> <th>From</th> <th>To</th> </tr> </thead> <tbody> <tr> <td>1726</td> <td>1684</td> </tr> </tbody> </table>	Perforated Intervals		From	To	1726	1684
Spacing Orders														
Order No	Unit Size													
609199	UNIT													
Perforated Intervals														
From	To													
1726	1684													
<table border="1"> <thead> <tr> <th>Acid Volumes</th> </tr> </thead> <tbody> <tr> <td>36 BARRELS 7 1/2 SME</td> </tr> </tbody> </table>		Acid Volumes	36 BARRELS 7 1/2 SME	<table border="1"> <thead> <tr> <th>Fracture Treatments</th> </tr> </thead> <tbody> <tr> <td>983 BARRELS GEL WATER, 80,900 POUNDS 12/20 BRADY SAND</td> </tr> </tbody> </table>	Fracture Treatments	983 BARRELS GEL WATER, 80,900 POUNDS 12/20 BRADY SAND								
Acid Volumes														
36 BARRELS 7 1/2 SME														
Fracture Treatments														
983 BARRELS GEL WATER, 80,900 POUNDS 12/20 BRADY SAND														

Formation	Top
OSAGE LAYTON	1075
LAYTON	1350
CLEVELAND	1740
SKINNER	2145
BARTLESVILLE	2350
ARBUCKLE	2685

Were open hole logs run? Yes

Date last log run: August 15, 2012

Were unusual drilling circumstances encountered? No

Explanation:

Other Remarks
LAYTON AND CLEVELAND FORMATIONS ARE UNITIZED UNDER ORDER NUMBER 609199.

**FOR COMMISSION USE ONLY**

1122417

Status: Accepted

API NO. 117-23492  
 OTC PROD. UNIT NO.

PLEASE TYPE OR USE BLACK INK ONLY  
 NOTE:  
 Attach copy of original 1002A if recompl

**AS SUBMITTED**

**RECEIVED**  
 101-1002A  
 Rev. 2009

DEC 16 2013

OKLAHOMA CORPORATION  
 COMMISSION

ORIGINAL  
 AMENDED (Reason) Additional Perfs (Cleveland Sand)

COMPLETION REPORT

TYPE OF DRILLING OPERATION  
 STRAIGHT HOLE  DIRECTIONAL HOLE  HORIZONTAL HOLE  
 SERVICE WELL

SPUD DATE 8/6/2012  
 DRLG FINISHED DATE 8/16/2012  
 DATE OF WELL COMPLETION 9/6/2012

If directional or horizontal, see reverse for bottom hole location.

COUNTY Pawnee SEC 29 TWP 21N RGE 8E  
 LEASE NAME Walker WELL NO. 3A  
 S2 1/4 N2 1/4 NW 1/4 NE 1/4 FSL 2145' FWL OF 1/4 SEC 660'  
 ELEVATION N Derrick 971' Ground 963' Latitude (if known) Longitude (if known)

1st PROD DATE  
 RECOMP DATE 11/19/2013

OPERATOR NAME Mid-Con Energy Operating, Inc. LLC OTC/OCC OPERATOR N 1001123271

ADDRESS 2431 E 61st St., Ste. 850  
 CITY Tulsa STATE OK ZIP 74136

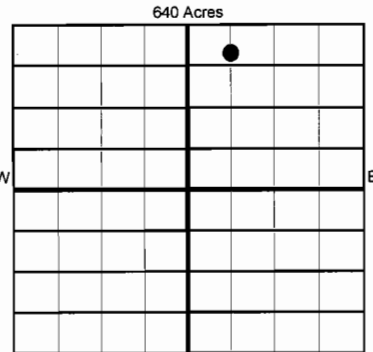

Per Survey

COMPLETION TYPE  
 SINGLE ZONE  
 MULTIPLE ZONE Application Date  
 COMMINGLED Application Date  
 LOCATION  
 EXCEPTION ORDER  
 INCREASED DENSITY ORDER NO.

CASING & CEMENT (Form 1002C must be attached)							
TYPE	SIZE	WEIGHT	GRADE	FEET	PSI	SAX	TOP OF CMT
CONDUCTOR							
SURFACE	9 5/8"	32.3#	J55	220'		175	Surface
INTERMEDIATE							
PRODUCTION	7"	23#	J55	2742'		400	502'
LINER							
TOTAL DEPTH							2881'

PACKER @ \_\_\_\_\_ BRAND & TYPE \_\_\_\_\_ PLUG @ \_\_\_\_\_ TYPE \_\_\_\_\_ PLUG @ \_\_\_\_\_ TYPE \_\_\_\_\_  
 PACKER @ \_\_\_\_\_ BRAND & TYPE \_\_\_\_\_ PLUG @ \_\_\_\_\_ TYPE \_\_\_\_\_ PLUG @ \_\_\_\_\_ TYPE \_\_\_\_\_

COMPLETION & TEST DATA BY PRODUCING FORMATION 405 LYTIN 405 CLVD

FORMATION	Layton	Cleveland
SPACING & SPACING ORDER NUMBER	609199 (unit)	609199 (unit)
CLASS: Oil, Gas, Dry, Inj, Disp, Comm Disp, Svc	Oil	Oil
PERFORATED INTERVALS	1358'-1362', 1368'-1372' 1386'-1392', 1414'-1422'	1726'-1736', 1742'-1752' 1762'-1772', 1779'-1794'
ACID/VOLUME	24 bbls 7.5% SME	36 bbls 7 1/2 SME
FRACTURE TREATMENT (Fluids/Prop Amounts)	500 bbl gel water 39,800#s 12/20 Brady Sand	983 bbls gel water 80,900# 12/20 Brady Sand

Min Gas Allowable (165:10-17-7) OR  Gas Purchaser/Measurer First Sales Date  
 Oil Allowable (165:10-13-3)

INITIAL TEST DATA	9/21/2012	11/26/2013
OIL-BBL/DAY	38	21
OIL-GRAVITY ( API)		
GAS-MCF/DAY		
GAS-OIL RATIO CU FT/BBL		
WATER-BBL/DAY	82	160
PUMPING OR FLOWING	Pumping	pumping
INITIAL SHUT-IN PRESSURE		
CHOKE SIZE		
FLOW TUBING PRESSURE		

A record of the formations drilled through, and pertinent remarks are presented on the reverse. I declare that I have knowledge of the contents of this report and am authorized by my organization to make this report, which was prepared by me or under my supervision and direction, with the data and facts stated herein to be true, correct, and complete to the best of my knowledge and belief.

Lindsey Vedros SIGNATURE NAME (PRINT OR TYPE) Lindsey Vedros  
2431 E 61st St. Suite 850 ADDRESS Tulsa Ok 74136 CITY STA ZIP  
12/12/13 DATE 918-748-3378 PHONE NUMBER  
Lvedros@midcon-energy.com EMAIL ADDRESS

PLEASE TYPE OR USE BLACK INK ONLY  
FORMATION RECORD

Give formation names and tops, if available, or descriptions and thickness of formations drilled through. Show intervals cored or drillstem tested.

LEASE NAME Walker WELL NO. 3A

NAMES OF FORMATIONS	TOP
Osage Layton	1075'
Layton	1350'
Cleveland	1740'
Skinner	2145'
Bartlesville	2350'
Arbuckle	2685'

FOR COMMISSION USE ONLY

ITD on file  YES  NO

APPROVED \_\_\_\_\_ DISAPPROVED \_\_\_\_\_

2) Reject Codes \_\_\_\_\_  
 \_\_\_\_\_  
 \_\_\_\_\_  
 \_\_\_\_\_

Were open hole logs run?  yes  no

Date Last log was run 8/15/2012

Was CO<sub>2</sub> encountered?  yes  no at what depths? \_\_\_\_\_

Was H<sub>2</sub>S encountered?  yes  no at what depths? \_\_\_\_\_

Were unusual drilling circumstances encountered?  yes  no  
 If yes, briefly explain below

Other remarks: Layton and Cleveland formations are unitized under order # 609199

640 Acres

If more than three drainholes are proposed, attach a separate sheet indicating the necessary information.

Direction must be stated in degrees azimuth.  
 Please note, the horizontal drainhole and its end point must be located within the boundaries of the lease or spacing unit.

Directional surveys are required for all drainholes and directional wells.

640 Acres

**BOTTOM HOLE LOCATION FOR DIRECTIONAL HOLE**

SEC	TWP	RGE	COUNTY	Spot Location		Feet From 1/4 Sec Lines	FSL	FWL
				1/4	1/4			
Measured Total Depth		True Vertical Depth		BHL From Lease, Unit, or Property Line:				

**BOTTOM HOLE LOCATION FOR HORIZONTAL HOLE: (LATERALS)**

**LATERAL #1**

SEC	TWP	RGE	COUNTY	Spot Location		Feet From 1/4 Sec Lines	FSL	FWL
				1/4	1/4			
Depth of Deviation		Radius of Turn		Direction		Total Length		
Measured Total Depth		True Vertical Depth		BHL From Lease, Unit, or Property Line:				

**LATERAL #2**

SEC	TWP	RGE	COUNTY	Spot Location		Feet From 1/4 Sec Lines	FSL	FWL
				1/4	1/4			
Depth of Deviation		Radius of Turn		Direction		Total Length		
Measured Total Depth		True Vertical Depth		BHL From Lease, Unit, or Property Line:				

**LATERAL #3**

SEC	TWP	RGE	COUNTY	Spot Location		Feet From 1/4 Sec Lines	FSL	FWL
				1/4	1/4			
Depth of Deviation		Radius of Turn		Direction		Total Length		
Measured Total Depth		True Vertical Depth		BHL From Lease, Unit, or Property Line:				