

Oklahoma Corporation Commission  
Oil & Gas Conservation Division  
Post Office Box 52000  
Oklahoma City, Oklahoma 73152-2000  
Rule 165: 10-3-25

Form 1002A

API No.: 35007256220000

**Completion Report**

Spud Date: September 13, 2013

OTC Prod. Unit No.: 007-212027

Drilling Finished Date: October 03, 2013

1st Prod Date: December 01, 2013

Completion Date: December 05, 2013

**Drill Type: HORIZONTAL HOLE**

Well Name: FLOWERS 1H-8

Purchaser/Measurer:

Location: BEAVER 17 1N 20E CM  
SW NE NE NE  
350 FNL 550 FEL of 1/4 SEC  
Derrick Elevation: 0 Ground Elevation: 2832

First Sales Date:

Operator: CHAPARRAL ENERGY LLC 16896

701 CEDAR LAKE BLVD  
OKLAHOMA CITY, OK 73114-7800

Completion Type	
X	Single Zone
	Multiple Zone
	Commingled

Location Exception
Order No
614171

Increased Density
Order No
There are no Increased Density records to display.

Casing and Cement							
Type	Size	Weight	Grade	Feet	PSI	SAX	Top of CMT
SURFACE	9 5/8	36	J-55	1975		1150	SURFACE
PRODUCTION	7	26	P-110	6371		300	4740

Liner								
Type	Size	Weight	Grade	Length	PSI	SAX	Top Depth	Bottom Depth
LINER	4 1/2	11.6	P-110	4889	0	0	6231	11120

**Total Depth: 11133**

Packer	
Depth	Brand & Type
There are no Packer records to display.	

Plug	
Depth	Plug Type
There are no Plug records to display.	

Initial Test Data										
Test Date	Formation	Oil BBL/Day	Oil-Gravity (API)	Gas MCF/Day	Gas-Oil Ratio Cu FT/BBL	Water BBL/Day	Pumpin or Flowing	Initial Shut-In Pressure	Choke Size	Flow Tubing Pressure
Dec 05, 2013	MARMATON	165	42	58	352	1847	PUMPING		OPEN	

Completion and Test Data by Producing Formation										
Formation Name: MARMATON			Code: 404MRMN			Class: OIL				
<b>Spacing Orders</b>				<b>Perforated Intervals</b>						
<b>Order No</b>	<b>Unit Size</b>			<b>From</b>			<b>To</b>			
613539	640			There are no Perf. Intervals records to display.						
<b>Acid Volumes</b>				<b>Fracture Treatments</b>						
2,520 GALLONS 15% HCL ACID				1,468,698 GALLONS TREATED SLICK WATER WITH 406,864 POUNDS 40/70 WHITE SAND PROPPANT OVER 11 FRAC STAGES						

Formation	Top
MARMATON	6370

Were open hole logs run? No

Date last log run:

Were unusual drilling circumstances encountered? No

Explanation:

Other Remarks
THIS WELL IS AN OPEN HOLE COMPLETION (PACKER PLUS SYSTEM) FROM THE BOTTOM OF THE 7" CASING (6,371') TO THE TERMINUS (11,133'). THE 4 1/2" LINER IS PORTED FROM (6,652') TO (11,069'). THIS 4 1/2" LINER IS NOT CEMENTED IN. FLE ORDER HAS NOT BEEN ISSUED. WE HAVE ACCEPTED OPERATORS DATA AS SUBMITTED. IRREGULAR SECTION.

Lateral Holes
Sec: 8 TWP: 1N RGE: 20E County: BEAVER Meridian: CM NW NE NE NE 201 FNL 577 FEL of 1/4 SEC Depth of Deviation: 5375 Radius of Turn: 1538 Direction: 360 Total Length: 4220 Measured Total Depth: 11133 True Vertical Depth: 6051 End Pt. Location From Release, Unit or Property Line: 201

FOR COMMISSION USE ONLY
Status: Accepted
1122365

RECEIVED

Form 1002A Rev. 2009

DEC 11 2013

OKLAHOMA CORPORATION COMMISSION

API NO. 007-25622
OTC PROD. UNIT NO. 007-212027

PLEASE TYPE OR USE BLOCK LETTERS

AS SUBMITTED

Attach copy of original if recompletion or recompletion

X ORIGINAL
AMENDED (Reason)

COMPLETION REPORT

TYPE OF DRILLING OPERATION
STRAIGHT HOLE DIRECTIONAL HOLE HORIZONTAL HOLE
SERVICE WELL

SPUD DATE 9/13/2013
DRLG FINISHED DATE 10/03/2013
DATE OF WELL COMPLETION 12/05/2013
1st PROD DATE 12/01/2013
RECOMP DATE
Longitude (if known)

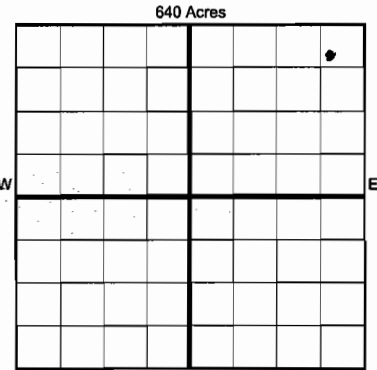

BEAVER SEC 17 TWP 01N RGE 20ECM
FLOWERS WELL NO. 1H-8
SW 1/4 NE 1/4 NE 1/4 NE 1/4
ELEVATION Ground 2832
CHAPARRAL ENERGY, L.L.C.
701 CEDAR LAKE BLVD.
OKLAHOMA CITY OK 73114

COMPLETION TYPE

X SINGLE ZONE
MULTIPLE ZONE
COMMINGLED
LOCATION EXCEPTION ORDER INCREASED DENSITY ORDER NO. 614171

CASING & CEMENT (Form 1002C must be attached)

Table with columns: TYPE, SIZE, WEIGHT, GRADE, FEET, PSI, SAX, TOP OF CMT. Rows include CONDUCTOR, SURFACE, INTERMEDIATE, PRODUCTION, LINER.

PACKER @ BRAND & TYPE PLUG @ TYPE PLUG @ TYPE
PACKER @ BRAND & TYPE PLUG @ TYPE PLUG @ TYPE

TOTAL DEPTH 11,133

COMPLETION & TEST DATA BY PRODUCING FORMATION

Table with columns: FORMATION, SPACING & SPACING ORDER NUMBER, CLASS, PERFORATED INTERVALS, ACID/VOLUME, FRACTURE TREATMENT.

Min Gas Allowable (165:10-17-7) OR Oil Allowable (165:10-13-3) Gas Purchaser/Measurer First Sales Date

INITIAL TEST DATA

Table with columns: INITIAL TEST DATE, OIL-BBL/DAY, OIL-GRAVITY (API), GAS-MCF/DAY, GAS-OIL RATIO CU FT/BBL, WATER-BBL/DAY, PUMPING OR FLOWING, INITIAL SHUT-IN PRESSURE, CHOKE SIZE, FLOW TUBING PRESSURE.

A record of the formations drilled through, and pertinent remarks are presented on the reverse. I declare that I have knowledge of the contents of this report and am authorized by my organization to make this report, which was prepared by me or under my supervision and direction, with the data and facts stated herein to be true, correct, and complete to the best of my knowledge and belief.

Paul Honeycutt - Sr. Engineering Tech, I
701 Cedar Lake Blvd. Oklahoma City, OK 73114 paulh@chaparralenergy.com

**PLEASE TYPE OR USE BLACK INK ONLY**  
**FORMATION RECORD**

Give formation names and tops, if available, or descriptions and thickness of formations drilled through. Show intervals cored or drillstem tested.

LEASE NAME FLOWERS WELL NO. 1H-8

NAMES OF FORMATIONS	TOP
MARMATON	6370'

FOR COMMISSION USE ONLY

ITD on file  YES  NO

APPROVED \_\_\_\_\_ DISAPPROVED \_\_\_\_\_

2) Reject Codes \_\_\_\_\_

\_\_\_\_\_

\_\_\_\_\_

\_\_\_\_\_

Were open hole logs run?  yes  no

Date Last log was run \_\_\_\_\_

Was CO<sub>2</sub> encountered?  yes  no at what depths? \_\_\_\_\_

Was H<sub>2</sub>S encountered?  yes  no at what depths? \_\_\_\_\_

Were unusual drilling circumstances encountered?  yes  no  
 If yes, briefly explain below \_\_\_\_\_

Other remarks: **NOTE: This well is an "Open Hole Completion" ( Packer Plus System) from the bottom of the 7" casing (6371') to the TERMINUS (11,133'). The 4 1/2" Liner is ported from (6652') to (11,069'). This 4 1/2" LINER IS "NOT CEMENTED IN".**

\_\_\_\_\_

\_\_\_\_\_

\_\_\_\_\_

640 Acres

If more than three drainholes are proposed, attach a separate sheet indicating the necessary information.

Direction must be stated in degrees azimuth. Please note, the horizontal drainhole and its end point must be located within the boundaries of the lease or spacing unit.

Directional surveys are required for all drainholes and directional wells.

640 Acres

**BOTTOM HOLE LOCATION FOR DIRECTIONAL HOLE**

SEC	TWP	RGE	COUNTY
Spot Location	1/4	1/4	1/4
Measured Total Depth	True Vertical Depth		BHL From Lease, Unit, or Property Line:

**BOTTOM HOLE LOCATION FOR HORIZONTAL HOLE: (LATERALS)**

**LATERAL #1**

SEC	TWP	RGE	COUNTY
8	01N	20ECM	BEAVER
Spot Location	NW 1/4	NE 1/4	NE 1/4
Depth of Deviation	5375	Radius of Turn	1538'
Measured Total Depth	11,133	True Vertical Depth	6,050
		Direction	0.10 AZ
		Total Length	4220
		BHL From Lease, Unit, or Property Line: 201'	

**LATERAL #2**

SEC	TWP	RGE	COUNTY
Spot Location	1/4	1/4	1/4
Depth of Deviation	Radius of Turn		Direction
Measured Total Depth	True Vertical Depth		Total Length
		BHL From Lease, Unit, or Property Line:	

**LATERAL #3**

SEC	TWP	RGE	COUNTY
Spot Location	1/4	1/4	1/4
Depth of Deviation	Radius of Turn		Direction
Measured Total Depth	True Vertical Depth		Total Length
		BHL From Lease, Unit, or Property Line:	