

Oklahoma Corporation Commission  
 Oil & Gas Conservation Division  
 Post Office Box 52000  
 Oklahoma City, Oklahoma 73152-2000  
 Rule 165: 10-3-25

Form 1002A

API No.: 35045233920000

**Completion Report**

Spud Date: September 18, 2013

OTC Prod. Unit No.: 045-211921

Drilling Finished Date: October 11, 2013

1st Prod Date: November 06, 2013

Completion Date: November 04, 2013

**Drill Type: HORIZONTAL HOLE**

Min Gas Allowable: Yes

Well Name: RICH 3-1H

Purchaser/Measurer: DCP MIDSTREAM LP

Location: ELLIS 3 18N 24W  
 SW SW SE SW  
 250 FSL 1500 FWL of 1/4 SEC  
 Derrick Elevation: 0 Ground Elevation: 2398

First Sales Date: 11/07/2013

Operator: EOG RESOURCES INC 16231

3817 NW EXPRESSWAY STE 500  
 OKLAHOMA CITY, OK 73112-1483

Completion Type	
X	Single Zone
	Multiple Zone
	Commingled

Location Exception
Order No
616637

Increased Density
Order No
There are no Increased Density records to display.

Casing and Cement							
Type	Size	Weight	Grade	Feet	PSI	SAX	Top of CMT
SURFACE	9 5/8	36	J-55	1487		520	SURFACE
PRODUCTION	7	26	P-110	9580		350	6938

Liner								
Type	Size	Weight	Grade	Length	PSI	SAX	Top Depth	Bottom Depth
LINER	4 1/2	13.5	P-110	5122	0	420	8736	13858

**Total Depth: 13858**

Packer	
Depth	Brand & Type
8736	PACKER

Plug	
Depth	Plug Type
There are no Plug records to display.	

Initial Test Data										
Test Date	Formation	Oil BBL/Day	Oil-Gravity (API)	Gas MCF/Day	Gas-Oil Ratio Cu FT/BBL	Water BBL/Day	Pumpin or Flowing	Initial Shut-In Pressure	Choke Size	Flow Tubing Pressure
Nov 13, 2013	MARMATON	247	43	468	1895	873	FLOWING	2350	OPEN	400

Completion and Test Data by Producing Formation										
Formation Name: MARMATON			Code: 404MRMN			Class: OIL				
<b>Spacing Orders</b>				<b>Perforated Intervals</b>						
<b>Order No</b>	<b>Unit Size</b>			<b>From</b>			<b>To</b>			
614805	640			9425			13773			
<b>Acid Volumes</b>				<b>Fracture Treatments</b>						
There are no Acid Volume records to display.				0.037MM GALLONS HCL, 3.76MM GALLONS SLICK WATER, 3.79MM POUNDS PROPPANT						

Formation	Top
TOP CLEVELAND	8968
MARMATON MFS	9152
MARMATON	9376

Were open hole logs run? No

Date last log run:

Were unusual drilling circumstances encountered? No

Explanation:

Other Remarks
OCC: FLE ORDER HAS NOT BEEN ISSUED. WE HAVE ACCEPTED OPERATORS DATA AS SUBMITTED. IRREGULAR SECTION.

Lateral Holes
Sec: 3 TWP: 18N RGE: 24W County: ELLIS
NE NE NW NW
2357 FSL 1157 FWL of 1/4 SEC
Depth of Deviation: 8767 Radius of Turn: 672 Direction: 357 Total Length: 4152
Measured Total Depth: 13858 True Vertical Depth: 9203 End Pt. Location From Release, Unit or Property Line: 283

FOR COMMISSION USE ONLY
Status: Accepted
1122367

API NO. 045-23392  
 OTC PROD. UNIT NO. 045-211921

PLEASE TYPE OF

Attach copy if recompl

**AS SUBMITTED**

OKLAHOMA CORPORATION COMMISSION

Form 1002A Rev. 2009  
 n Commission 52000  
 na 73152-2000  
 -3-25

RECEIVED

DEC 09 2013

OKLAHOMA CORPORATION COMMISSION

ORIGINAL  
 AMENDED

Reason Amended TYPE OF DRILLING OPERATION

STRAIGHT HOLE  DIRECTIONAL HOLE  HORIZONTAL HOLE  
 SERVICE WELL

SPUD DATE 09/18/2013

DRLG FINISHED DATE 10/11/2013

If directional or horizontal, see reverse for bottom hole location.

COUNTY: ELLIS SEC 03 TWP 18N RGE 24W

DATE OF WELL COMPLETION 11/04/2013

LEASE NAME: RICH WELL NO: 3 #1H

1ST PROD DATE 11/06/2013

SHL: SW 1/4 SW 1/4 SE 1/4 SW 1/4 FSL 250 FWL OF 1/4 SEC 1500

RECOMP DATE

ELEVATION: Derrick Fl Ground 2398 Latitude if known

Longitude (if known)

OPERATOR NAME EOG RESOURCES, INC. OTC/OCC OPER NO 16231-0

ADDRESS 3817 NW EXPRESSWAY, SUITE 500

CITY OKLAHOMA CITY STATE OK ZIP 73112

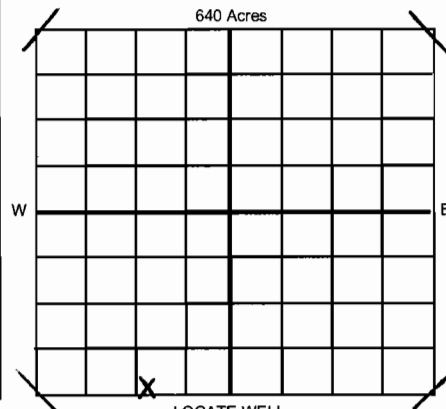

COMPLETION TYPE

SINGLE ZONE  
 MULTIPLE ZONE Application Date  
 COMMINGLED Application Date  
 LOCATION EXCEPTION ORDER NO. 616637  
 INCREASED DENSITY ORDER NO.

CASING & CEMENT (Form 1002C must be attached)

TYPE	SIZE	WEIGHT	GRADE	FEET	PSI	SAX	TOP	
Conductor								
Surface	9 5/8	36#	J-55	1487		520	SURFACE	
Intermediate								
Production	7"	26#	P-110	9580		350	6938	
Liner	4 1/2	13.5#	P-110	8736-	13858'	420	8736	
							TOTAL DEPTH	13858

PACKER @ 8736 BRAND & TYPE PLUG@ TYPE PLUG@ TYPE  
 PACKER @ BRAND & TYPE PLUG@ TYPE PLUG@ TYPE

COMPLETION & TEST DATA BY PRODUCING FORMATION

FORMATION	SPACING & SPACING ORDER NUMBER	CLASS: Oil, Gas, Dry, Inj disp, Comm Disp, svc	PERFORATED INTERVALS	ACID/VOLUME	FRACTURE TREATMENT (Fluids/Prop Amounts)
MARMATON	640/614805	OIL	9425-13773'	NO	0.037MM G HCL, 3.76MM G SLWR, +3.797MM# PROP.

*404 MRMN*  
*Reported to Frac Focus*

INITIAL TEST DATA  Minimum gas allowable (165:10-17-7) OR Gas Purchaser/Measurer DCP MIDSTREAM, LP 1st Sales Date 11/07/2013  
 Oil Allowable (165:10-13-3)

INITIAL TEST DATE	11/13/2013
OIL-BBL/DAY	247
OIL-GRAVITY ( API)	43
GAS-MCF/DAY	468
GAS-OIL RATIO CU FT/BBL	1895
WATER-BBL/DAY	873
PUMPING OR FLOWING	FLOWING
INITIAL SHUT-IN PRESSURE	2350
CHOKE SIZE	OPEN
FLOW TUBING PRESSURE	400

A record of the formations drilled through, and pertinent remarks are presented on the reverse. I declare that I have knowledge of the contents of this report and am authorized by my organization to make this report, which was prepared by me or under my supervision and direction, with the data and facts stated herein to be true, correct, and complete to the best of my knowledge and belief.

SIGNATURE Dawn Pracht NAME (PRINT OR TYPE) DAWN PRACHT a/k/a Rockel DATE 12/4/2013 PHONE NUMBER 405/246-3226  
 ADDRESS 3817 NW EXPRESSWAY, STE. 500 CITY OKLAHOMA CITY STATE OK ZIP 73112 EMAIL ADDRESS

PLEASE TYPE OR USE BLACK INK ONLY  
FORMATION RECORD

Give formation names and tops, if available, or descriptions and thickness of formations drilled through. Show intervals cored or drillstem tested.

LEASE NAME RICH WELL NO. 3 #1H

NAME OF FORMATIONS	TOP
TOP OF CLEVELAND	8968
MARMAION MFS	9152
MARMAION	9376

FOR COMMISSION USE ONLY

ITD on file  YES  NO

APPROVED  DISAPPROVED

2) Reject Codes

\_\_\_\_\_

\_\_\_\_\_

\_\_\_\_\_

\_\_\_\_\_

Was open hole logs run?  yes  no

Date last log was run \_\_\_\_\_

Was CO2 encountered?  yes  no at what depths? \_\_\_\_\_

Was H2S encountered?  yes  no at what depths? \_\_\_\_\_

Were unusual drilling circumstances encountered?  Yes  No

If yes, briefly explain: \_\_\_\_\_

Other remarks: \_\_\_\_\_

\_\_\_\_\_

\_\_\_\_\_

\_\_\_\_\_

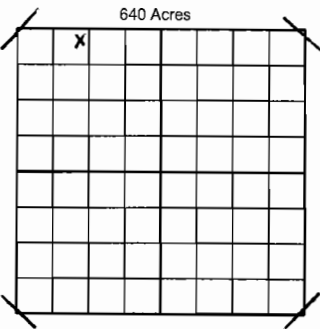

If more than two drainholes are proposed, attach a separate sheet indicating the necessary information.

Direction must be stated in degrees azimuth. Please note, the horizontal drainhole and its end point must be located within the boundaries of the lease or spacing unit.

Directional surveys are required for all drainholes and directional wells.

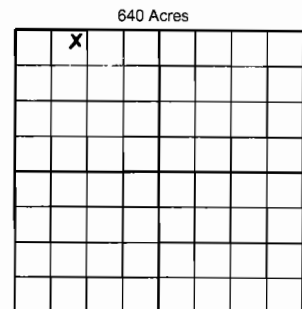

**BOTTOM HOLE LOCATION FOR DIRECTIONAL HOLE**

SEC	TWP	RGE	COUNTY
Spot Location 1/4 1/4 1/4 1/4		Feet From 1/4 Section Lines FSL FWL	
Measured Total Depth	True Vertical Depth	BHL From Lease, Unit or Property Line:	

**BOTTOM HOLE LOCATION FOR HORIZONTAL HOLE: (LATERALS)**

LATERAL #1

SEC	TWP	RGE	COUNTY
03	18N	24W	ELLIS
Spot Location NE 1/4 NE 1/4 NW 1/4 NW 1/4		Feet From 1/4 Section Lines 2368 FSL 1157 FWL	
Depth of Deviation 8767	Radius of Turn 672	Direction 357	Total Length 4152
Measured Total Depth 13858	True Vertical Depth 9203	End Pt Location From Lease, Unit or Property Line: 322	

LATERAL #2

SEC	TWP	RGE	COUNTY
Spot Location 1/4 1/4 1/4 1/4		Feet From 1/4 Section Lines FSL FWL	
Depth of Deviation	Radius of Turn	Direction	Total Length
Measured Total Depth	True Vertical Depth	End Pt Location From Lease, Unit or Property Line:	

LATERAL #3

SEC	TWP	RGE	COUNTY
Spot Location 1/4 1/4 1/4 1/4		Feet From 1/4 Section Lines FSL FWL	
Depth of Deviation	Radius of Turn	Direction	Total Length
Measured Total Depth	True Vertical Depth	End Pt Location From Lease, Unit or Property Line:	