

Oklahoma Corporation Commission  
Oil & Gas Conservation Division  
Post Office Box 52000  
Oklahoma City, Oklahoma 73152-2000  
Rule 165: 10-3-25

Form 1002A

API No.: 35103244900000

**Completion Report**

Spud Date: March 15, 2013

OTC Prod. Unit No.:

Drilling Finished Date: March 21, 2013

1st Prod Date: November 12, 2013

Completion Date: November 06, 2013

**Drill Type: STRAIGHT HOLE**

Well Name: GRACE 10

Purchaser/Measurer:

Location: NOBLE 25 24N 2W  
C SE NE SE  
1650 FSL 2310 FWL of 1/4 SEC  
Derrick Elevation: 987 Ground Elevation: 976

First Sales Date:

Operator: DONRAY PETROLEUM LLC 21690

2525 NW EXPRESSWAY STE 640  
OKLAHOMA CITY, OK 73112-7230

Completion Type	
X	Single Zone
	Multiple Zone
	Commingled

Location Exception
Order No
There are no Location Exception records to display.

Increased Density
Order No
There are no Increased Density records to display.

Casing and Cement							
Type	Size	Weight	Grade	Feet	PSI	SAX	Top of CMT
SURFACE	8 5/8	23		244		180	SURFACE
PRODUCTION	5 1/2	17		4481		485	1800

Liner								
Type	Size	Weight	Grade	Length	PSI	SAX	Top Depth	Bottom Depth
There are no Liner records to display.								

**Total Depth: 4497**

Packer	
Depth	Brand & Type
There are no Packer records to display.	

Plug	
Depth	Plug Type
4481	FLOAT SHOE CIBP

Initial Test Data										
Test Date	Formation	Oil BBL/Day	Oil-Gravity (API)	Gas MCF/Day	Gas-Oil Ratio Cu FT/BBL	Water BBL/Day	Pumpin or Flowing	Initial Shut-In Pressure	Choke Size	Flow Tubing Pressure
Nov 12, 2013	COTTAGE GROVE	8	40	19	2375	600	PUMPING	380		

Completion and Test Data by Producing Formation		
Formation Name: COTTAGE GROVE	Code: 405CGGV	Class: OIL
<b>Spacing Orders</b>		<b>Perforated Intervals</b>
<b>Order No</b>	<b>Unit Size</b>	<b>From</b> <b>To</b>
There are no Spacing Order records to display.		3378      3432
<b>Acid Volumes</b>		<b>Fracture Treatments</b>
1,000 GALLONS 10%		1,000 BGW, 141,000 POUNDS SAND, N2 FOAM

Formation	Top
PAWHUSKA	2000
HOOVER	2030
TONKAWA	2450
COTTAGE GROVE	3370
SKINNER	4080
RED FORK	4170
MISSISSIPPIAN	4290
VIOLA	4470

Were open hole logs run? Yes  
Date last log run: March 21, 2013

Were unusual drilling circumstances encountered? No  
Explanation:

Other Remarks
There are no Other Remarks.

FOR COMMISSION USE ONLY	
Status: Accepted	1122350

# AS SUBMITTED

# RECEIVED

DEC 05 2013

Form 1002A  
Rev. 2009

## OKLAHOMA CORPORATION COMMISSION

API NO 103 24490  
OTC PROD UNIT NO 21690

PLEASE TYPE OR USE BLACK  
NOTE:

Attach copy of original 1002A  
if recompletion or reentry.

Oil & Gas Conservation Division  
Post Office Box 52000  
Oklahoma City, Oklahoma 73152-2000  
Rule 165:10-3-25

ORIGINAL  
 AMENDED (Reason)

### COMPLETION REPORT

#### TYPE OF DRILLING OPERATION

STRAIGHT HOLE  DIRECTIONAL HOLE  HORIZONTAL HOLE  
 SERVICE WELL

If directional or horizontal, see reverse for bottom hole location.

COUNTY <u>NOBLE</u>	SEC <u>25</u>	TWP <u>24N</u>	RGE <u>2W</u>	SPUD DATE <u>3-15-13</u>
LEASE NAME <u>G RACE</u>	WELL NO. <u>#10</u>			DRLG FINISHED DATE <u>3-21-13</u>
C <u>1/4 SE 1/4 NE 1/4 SE 1/4</u>				DATE OF WELL COMPLETION <u>11-6-13</u>
ELEVATION N Derrick <u>907'</u> Ground <u>920'</u>				1st PROD DATE <u>11-12-13</u>
FSL OF 1/4 SEC <u>1650'</u> FWL OF 1/4 SEC <u>220'</u>				RECOMP DATE
OPERATOR NAME <u>Downray Petroleum LLC</u>				OTC/OCC OPERATOR NO. <u>21690</u>
ADDRESS <u>2525 N.W. Expressway #640</u>				
CITY <u>OKC</u>			STATE <u>OKA</u>	ZIP <u>73112</u>

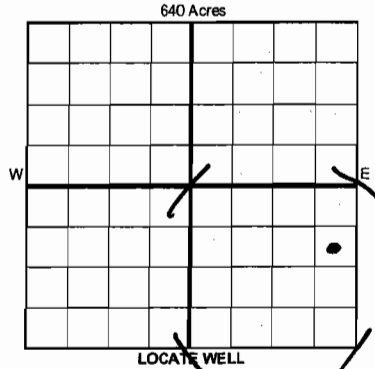

#### COMPLETION TYPE

SINGLE ZONE  
 MULTIPLE ZONE  
 COMMINGLED  
 LOCATION EXCEPTION ORDER  
 INCREASED DENSITY ORDER NO.

#### CASING & CEMENT (Form 1002C must be attached)

TYPE	SIZE	WEIGHT	GRADE	FEET	PSI	SAX	TOP OF CMT	
CONDUCTOR								
SURFACE	<u>7 5/8</u>	<u>23#</u>		<u>244'</u>		<u>180</u>	<u>SURF</u>	
INTERMEDIATE								
PRODUCTION	<u>5 1/2</u>	<u>17#</u>		<u>4481'</u>		<u>485'</u>	<u>1800'</u> <u>COL</u>	
LINER								
PACKER @ <u>4481'</u> TYPE <u>ALCOAT 5H00</u> PLUG @ <u>4481'</u> TYPE <u>ALCOAT 5H00</u>							TOTAL DEPTH	<u>4497'</u>

PACKER @ \_\_\_\_\_ BRAND & TYPE \_\_\_\_\_ PLUG @ \_\_\_\_\_ TYPE \_\_\_\_\_ PLUG @ \_\_\_\_\_ TYPE \_\_\_\_\_

#### COMPLETION & TEST DATA BY PRODUCING FORMATION 405C66V

FORMATION	<u>Cottrell Group</u>						
SPACING & SPACING ORDER NUMBER	<u>UNSPACED</u>						
CLASS: Oil, Gas, Dry, Inj, Disp, Comm Disp, Svc	<u>Oil</u>						
PERFORATED INTERVALS	<u>3378' TO 3432'</u>						
ACID/VOLUME	<u>1000 GAL 10% 1000 B G W</u>						
FRACTURE TREATMENT (Fluids/Prop Amounts)	<u>1/4 K# SAND 1/2 FOAM</u>						

Min Gas Allowable (165:10-17-7)

Gas Purchaser/Measurer

OR Oil Allowable (165:10-13-3)

First Sales Date

#### INITIAL TEST DATA

INITIAL TEST DATE	<u>11-12-13</u>			
OIL-BBL/DAY	<u>8 BOPD</u>			
OIL-GRAVITY (API)	<u>40°</u>			
GAS-MCF/DAY	<u>19 MCF/D</u>			
GAS-OIL RATIO CU FT/BBL				
WATER-BBL/DAY	<u>600 BPD</u>			
PUMPING OR FLOWING	<u>PUMPING</u>			
INITIAL SHUT-IN PRESSURE	<u>380 #</u>			
CHOKE SIZE				
FLOW TUBING PRESSURE				

A record of the formations drilled through, and pertinent remarks are presented on the reverse. I declare that I have knowledge of the contents of this report and am authorized by my organization to make this report, which was prepared by me or under my supervision and direction, with the data and facts stated herein to be true, correct, and complete to the best of my knowledge and belief.

RAY CORRETT JR SIGNATURE NAME (PRINT OR TYPE) 12-3-13 DATE 418-9348 PHONE NUMBER  
2525 N.W. Expressway #640 ADDRESS OKC CITY 73112 STATE ZIP Know at DownrayPetroleum.com EMAIL ADDRESS

PLEASE TYPE OR USE BLACK INK ONLY  
FORMATION RECORD

Give formation names and tops, if available, or descriptions and thickness of formations drilled through. Show intervals cored or drillstem tested.

LEASE NAME GRACE WELL No. #10

NAMES OF FORMATIONS	TOP
BAWUSKA	2000'
HOOPER	2030'
TOUKAWA	2450'
COTTAGE GROVE	3320'
SKYNER	4080'
RED FORK	4170'
MISSISSIPPIAN	4290'
VIOLA	4470'

FOR COMMISSION USE ONLY

ITD on file  YES  NO

APPROVED \_\_\_\_\_ DISAPPROVED \_\_\_\_\_

2) Reject Codes \_\_\_\_\_

Were open hole logs run?  yes  no

Date Last log was run 3-21-13

Was CO<sub>2</sub> encountered?  yes  no at what depths? \_\_\_\_\_

Was H<sub>2</sub>S encountered?  yes  no at what depths? \_\_\_\_\_

Were unusual drilling circumstances encountered?  yes  no  
If yes, briefly explain below

Other remarks:

---



---



---



---

640 Acres

If more than three drainholes are proposed, attach a separate sheet indicating the necessary information.

Direction must be stated in degrees azimuth. Please note, the horizontal drainhole and its end point must be located within the boundaries of the lease or spacing unit.

Directional surveys are required for all drainholes and directional wells.

640 Acres

BOTTOM HOLE LOCATION FOR DIRECTIONAL HOLE

SEC	TWP	RGE	COUNTY
Spot Location			
1/4	1/4	1/4	1/4
Measured Total Depth		True Vertical Depth	BHL From Lease, Unit, or Property Line:

BOTTOM HOLE LOCATION FOR HORIZONTAL HOLE: (LATERALS)

LATERAL #1

SEC	TWP	RGE	COUNTY
Spot Location			
1/4	1/4	1/4	1/4
Depth of Deviation	Radius of Turn	Direction	Total Length
Measured Total Depth		True Vertical Depth	BHL From Lease, Unit, or Property Line:

LATERAL #2

SEC	TWP	RGE	COUNTY
Spot Location			
1/4	1/4	1/4	1/4
Depth of Deviation	Radius of Turn	Direction	Total Length
Measured Total Depth		True Vertical Depth	BHL From Lease, Unit, or Property Line:

LATERAL #3

SEC	TWP	RGE	COUNTY
Spot Location			
1/4	1/4	1/4	1/4
Depth of Deviation	Radius of Turn	Direction	Total Length
Measured Total Depth		True Vertical Depth	BHL From Lease, Unit, or Property Line: