

Oklahoma Corporation Commission
 Oil & Gas Conservation Division
 Post Office Box 52000
 Oklahoma City, Oklahoma 73152-2000
 Rule 165: 10-3-25

Form 1002A

API No.: 35019259360000

Completion Report

Spud Date: September 01, 2013

OTC Prod. Unit No.:

Drilling Finished Date: September 11, 2013

1st Prod Date: November 16, 2013

Completion Date: November 15, 2013

Drill Type: STRAIGHT HOLE

Well Name: SEHDU GODDARD 4-10

Purchaser/Measurer:

Location: CARTER 10 5S 2W
 E2 NE NE SE
 2310 FSL 265 FEL of 1/4 SEC
 Derrick Elevation: 0 Ground Elevation: 858

First Sales Date:

Operator: MID-CON ENERGY OPERATING LLC 23271

2431 E 61ST ST STE 850
 TULSA, OK 74136-1236

Completion Type	
X	Single Zone
	Multiple Zone
	Commingled

Location Exception
Order No
There are no Location Exception records to display.

Increased Density
Order No
There are no Increased Density records to display.

Casing and Cement							
Type	Size	Weight	Grade	Feet	PSI	SAX	Top of CMT
SURFACE	8 5/8	24	J-55	1560		700	SURFACE
PRODUCTION	5 1/2	17	J-55	6123		225	3980

Liner								
Type	Size	Weight	Grade	Length	PSI	SAX	Top Depth	Bottom Depth
There are no Liner records to display.								

Total Depth: 6150

Packer	
Depth	Brand & Type
There are no Packer records to display.	

Plug	
Depth	Plug Type
There are no Plug records to display.	

Initial Test Data										
Test Date	Formation	Oil BBL/Day	Oil-Gravity (API)	Gas MCF/Day	Gas-Oil Ratio Cu FT/BBL	Water BBL/Day	Pumpin or Flowing	Initial Shut-In Pressure	Choke Size	Flow Tubing Pressure
Nov 15, 2013	DEESE	100				68	PUMPING			

Completion and Test Data by Producing Formation		
Formation Name: DEESE	Code: 404DEESS	Class: OIL
Spacing Orders		Perforated Intervals
Order No	Unit Size	From To
408098	UNIT	5938 5948
Acid Volumes		Fracture Treatments
10 BARRELS 7 1/2% NEFE		696 BARRELS GEL WATER, 20,500 POUNDS 16/30 OTTAWA SAND

Formation	Top
DAUBE LIME	2550
ANADARCHE LIME	2965
CRINERVILLE LIME	3295
CHUBBEE SAND	4285
NATSY LIME	4625
LONE GROVE SAND SERIE	5085
MARTIN SAND ZONE	5625
L / MARTIN SHALE MARKER	5755
HEWITT SAND	5940
STACY SAND	5985
LEEMAN SAND	6045
PRE-PENN (WOODFORD)	6118

Were open hole logs run? Yes
Date last log run: September 10, 2013
Were unusual drilling circumstances encountered? No
Explanation:

Other Remarks
There are no Other Remarks.

FOR COMMISSION USE ONLY	
Status: Accepted	1122247

API NO. 019-25936
 OTC PROD.
 UNIT NO.

PLEASE TYPE OR USE BLACK INK
 NOTE:
 Attach copy of original 1002A if



RECEIVED
 Form 1002A
 NOV 22 2013
 Rev. 2009

OKLAHOMA CORPORATION
 COMMISSION

ORIGINAL
 AMENDED (Reason)

COMPLETION REPORT

TYPE OF DRILLING OPERATION
 STRAIGHT HOLE DIRECTIONAL HOLE HORIZONTAL HOLE
 SERVICE WELL

If directional or horizontal, see reverse for bottom hole location.

COUNTY	Carter	SEC 10	TWP 5S	RGE 2W	SPUD DATE	09/01/2013	
LEASE NAME	SEHDU Goddard			WELL NO.	4-10	DRLG FINISHED DATE	09/11/2013
E2 1/4 NE 1/4 NE 1/4 SE 1/4	FSL 2310	FWC OF 1/4 SEC	265 FEL	DATE OF WELL COMPLETION	11/15/2013		
ELEVATION N Derrick	Ground 858	Latitude (if known)		1st PROD DATE	11/16/2013		
OPERATOR NAME	Mid-Con Energy Operating, LLC.			OTC/OCC OPERATOR N	23271		
ADDRESS	2431 E 61st St., Ste. 850						
CITY	Tulsa	STATE	OK	ZIP	74136		

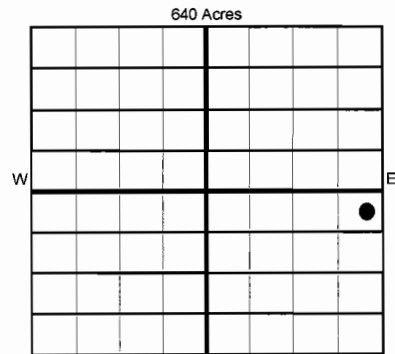

COMPLETION TYPE

SINGLE ZONE

MULTIPLE ZONE
 Application Date

COMMINGLED
 Application Date

LOCATION EXCEPTION ORDER INCREASED DENSITY ORDER NO.

CASING & CEMENT (Form 1002C must be attached)								
TYPE	SIZE	WEIGHT	GRADE	FEET	PSI	SAX	TOP OF CMT	
CONDUCTOR								
SURFACE	8 5/8	24#	J55	1560'		700	surface	
INTERMEDIATE								
PRODUCTION	5 1/2	17#	J55	6123'		225	3980	
LINER								
								TOTAL DEPTH 6150'

PACKER @ _____ BRAND & TYPE _____ PLUG @ _____ TYPE _____ PLUG @ _____ TYPE _____
 PACKER @ _____ BRAND & TYPE _____ PLUG @ _____ TYPE _____ PLUG @ _____ TYPE _____

COMPLETION & TEST DATA BY PRODUCING FORMATION	
FORMATION	Deese (Hewitt Sand) <i>404 DEESS</i>
SPACING & SPACING ORDER NUMBER	408098 (unit)
CLASS: Oil, Gas, Dry, Inj, Disp, Comm Disp, Svc	Oil
PERFORATED INTERVALS	5938'-5948' 4 SPF
ACID/VOLUME	10 bbls 7 1/2% NE/FE
FRACTURE TREATMENT (Fluids/Prop Amounts)	696 bbls gel water 20,500# 16/30 Ottawa Sand

Min Gas Allowable (165:10-17-7) OR Gas Purchaser/Measurer First Sales Date _____
 Oil Allowable (165:10-13-3)

INITIAL TEST DATA	
INITIAL TEST DATE	11/15/2013
OIL-BBL/DAY	100
OIL-GRAVITY (API)	
GAS-MCF/DAY	
GAS-OIL RATIO CU FT/BBL	
WATER-BBL/DAY	68
PUMPING OR FLOWING	pumping
INITIAL SHUT-IN PRESSURE	
CHOKE SIZE	
FLOW TUBING PRESSURE	

A record of the formations drilled through, and pertinent remarks are presented on the reverse. I declare that I have knowledge of the contents of this report and am authorized by my organization to make this report, which was prepared by me or under my supervision and direction, with the data and facts stated herein to be true, correct, and complete to the best of my knowledge and belief.

Lindsey Vedros SIGNATURE
 2431 E 61st St. Suite 850 ADDRESS
 Tulsa CITY
 Ok 74136 STA ZIP
 11/19/13 DATE
 918-748-3369 PHONE NUMBER
 lvedros@midcon-energy.com EMAIL ADDRESS

PLEASE TYPE OR USE BLACK INK ONLY
FORMATION RECORD

Give formation names and tops, if available, or descriptions and thickness of formations drilled through. Show intervals cored or drillstem tested.

LEASE NAME SEHDU Goddard WELL NO. 4-10

NAMES OF FORMATIONS	TOP
Duabe Lime	2,550
Anadarche Lime	2,965
Crinerville Lime	3,295
Chubbee Sand	4,285
Natsy Lime	4,625
Lone Grove Sand Series	5,085
Martin Sand Zone	5,625
L/Martin Shale Marker	5,755
Hewitt Sand	5,940
Stacy Sand	5,985
Leeman Sand	6,045
Pre-Penn (Woodford)	6,118

FOR COMMISSION USE ONLY

ITD on file YES NO

APPROVED _____ DISAPPROVED _____

2) Reject Codes _____

Were open hole logs run? yes no

Date Last log was run 9/10/2013

Was CO₂ encountered? yes no at what depths? _____

Was H₂S encountered? yes no at what depths? _____

Were unusual drilling circumstances encountered? yes no
 If yes, briefly explain below _____

Other remarks: _____

640 Acres

If more than three drainholes are proposed, attach a separate sheet indicating the necessary information.

Direction must be stated in degrees azimuth. Please note, the horizontal drainhole and its end point must be located within the boundaries of the lease or spacing unit.

Directional surveys are required for all drainholes and directional wells.

640 Acres

BOTTOM HOLE LOCATION FOR DIRECTIONAL HOLE

SEC	TWP	RGE	COUNTY							
Spot Location				1/4	1/4	1/4	1/4	Feet From 1/4 Sec Lines	FSL	FWL
Measured Total Depth				True Vertical Depth		BHL From Lease, Unit, or Property Line:				

BOTTOM HOLE LOCATION FOR HORIZONTAL HOLE: (LATERALS)

LATERAL #1

SEC	TWP	RGE	COUNTY							
Spot Location				1/4	1/4	1/4	1/4	Feet From 1/4 Sec Lines	FSL	FWL
Depth of Deviation				Radius of Turn		Direction		Total Length		
Measured Total Depth				True Vertical Depth		BHL From Lease, Unit, or Property Line:				

LATERAL #2

SEC	TWP	RGE	COUNTY							
Spot Location				1/4	1/4	1/4	1/4	Feet From 1/4 Sec Lines	FSL	FWL
Depth of Deviation				Radius of Turn		Direction		Total Length		
Measured Total Depth				True Vertical Depth		BHL From Lease, Unit, or Property Line:				

LATERAL #3

SEC	TWP	RGE	COUNTY							
Spot Location				1/4	1/4	1/4	1/4	Feet From 1/4 Sec Lines	FSL	FWL
Depth of Deviation				Radius of Turn		Direction		Total Length		
Measured Total Depth				True Vertical Depth		BHL From Lease, Unit, or Property Line:				