

Oklahoma Corporation Commission  
Oil & Gas Conservation Division  
Post Office Box 52000  
Oklahoma City, Oklahoma 73152-2000  
Rule 165: 10-3-25

Form 1002A

API No.: 35103245410000

**Completion Report**

Spud Date: July 19, 2013

OTC Prod. Unit No.: 103-211506

Drilling Finished Date: September 02, 2013

1st Prod Date: October 12, 2013

Completion Date: October 10, 2013

**Drill Type: HORIZONTAL HOLE**

Min Gas Allowable: Yes

Well Name: COMMISSIONERS 20-2-30 1 HM

Purchaser/Measurer: PVR

Location: NOBLE 30 20N 2W  
NE NE NW NW  
2474 FSL 1206 FWL of 1/4 SEC  
Derrick Elevation: 1187 Ground Elevation: 1164

First Sales Date: 10/12/2013

Operator: SUNDANCE ENERGY OKLAHOMA LLC dba SEO LLC 22918

633 17TH ST STE 1950  
DENVER , CO 80202-3620

Completion Type	
X	Single Zone
	Multiple Zone
	Commingled

Location Exception
Order No
605642

Increased Density
Order No
There are no Increased Density records to display.

Casing and Cement							
Type	Size	Weight	Grade	Feet	PSI	SAX	Top of CMT
SURFACE	9 5/8	36	J-55	356		276	SURFACE
PRODUCTION	7	26	P-110	5636		207	4567

Liner								
Type	Size	Weight	Grade	Length	PSI	SAX	Top Depth	Bottom Depth
LINER	4 1/2	11.6	N-80	5115	0	0	4937	10052

**Total Depth: 10068**

Packer	
Depth	Brand & Type
There are no Packer records to display.	

Plug	
Depth	Plug Type
There are no Plug records to display.	

Initial Test Data										
Test Date	Formation	Oil BBL/Day	Oil-Gravity (API)	Gas MCF/Day	Gas-Oil Ratio Cu FT/BBL	Water BBL/Day	Pumpin or Flowing	Initial Shut-In Pressure	Choke Size	Flow Tubing Pressure
Nov 07, 2013	MISSISSIPPIAN	157	41	373	2376	519	PUMPING		OPEN	140

Completion and Test Data by Producing Formation			
Formation Name: MISSISSIPPIAN	Code: 359MSSP	Class: OIL	
<b>Spacing Orders</b>		<b>Perforated Intervals</b>	
<b>Order No</b>	<b>Unit Size</b>	<b>From</b> <b>To</b>	
605056	640	There are no Perf. Intervals records to display.	
<b>Acid Volumes</b>		<b>Fracture Treatments</b>	
2,871 BARRELS 15% HCL		17 STAGES - 55,060 BARRELS H2O, 852,300 POUNDS 30/50, 811,700 POUNDS 20/40	

Formation	Top
HOGSHOOTER	4335
OSWEGO	5007
VERDIGRIS	5138
INOLA	5256
MISSISSIPPI	5321

Were open hole logs run? No

Date last log run:

Were unusual drilling circumstances encountered? No

Explanation:

Other Remarks
OCC - THIS WELL IS AN OPEN HOLE COMPLETION FROM BOTTOM OF THE 7" CASING AT 5,638' TO TERMINUS AT 10,068'. THE 4 1/2" LINER IS NOT CEMENTED. IRREGULAR SECTION. FLE ORDER HAS NOT BEEN ISSUED. WE HAVE ACCEPTED OPERATORS DATA AS SUBMITTED.

Lateral Holes
Sec: 30 TWP: 20N RGE: 2W County: LOGAN
SE SW SW SW
165 FSL 653 FWL of 1/4 SEC
Depth of Deviation: 4866 Radius of Turn: 1227 Direction: 0 Total Length: 4271
Measured Total Depth: 10067 True Vertical Depth: 5350 End Pt. Location From Release, Unit or Property Line: 165

FOR COMMISSION USE ONLY
Status: Accepted
1122148

API NO. 35-103-24541  
 OTC PROD. UNIT NO. 103-211506

PLEASE TYPE OR USE BLACK INK  
 NOTE:

Attach copy of original 1002C if recompletion or reentry.



RECEIVED

NOV 21 2013

Form 1002A Rev. 2009

OKLAHOMA CORPORATION COMMISSION

ORIGINAL  
 AMENDED (Reason)

COMPLETION REPORT

TYPE OF DRILLING OPERATION

STRAIGHT HOLE  DIRECTIONAL HOLE  HORIZONTAL HOLE  
 SERVICE WELL

If directional or horizontal, see reverse for bottom hole location.

COUNTY Noble	SEC 30	TWP 20N	RGE 2W	SPUD DATE 7/19/13
LEASE NAME Commissioners 20-2-30				DATE OF WELL COMPLETION 10/10/13
NE 1/4 NE 1/4 NW 1/4 NW 1/4		FSL OF 1/4 SEC 2474'	FWL OF 1/4 SEC 1206'	1st PROD DATE 10/12/13
ELEVATIO N Derrick 1187'	Ground 1164'	Latitude (if known) 36.18798° N	Longitude -97.45665° W (if known)	RECOMP DATE
OPERATOR NAME Sundance Energy Oklahoma LLC			OTC/OCC OPERATOR NO. 22918	
ADDRESS 13524 Railway Dr. Ste. G				
CITY Oklahoma City		STATE OK	ZIP 73114-2258	

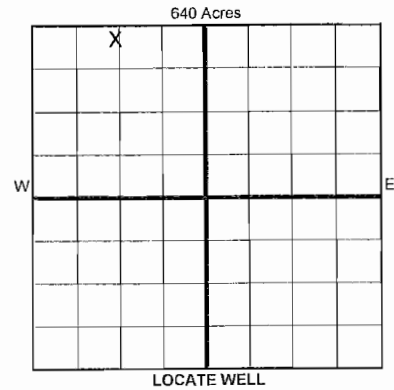

COMPLETION TYPE

SINGLE ZONE Mississippi

MULTIPLE ZONE Application Date

COMMINGLED Application Date

LOCATION EXCEPTION ORDER INCREASED DENSITY ORDER NO. 605642 1001

CASING & CEMENT (Form 1002C must be attached)

TYPE	SIZE	WEIGHT	GRADE	FEET	PSI	SAX	TOP OF CMT
CONDUCTOR	20"						
SURFACE	9-5/8"	36#	J-55	356'		276	0'
INTERMEDIATE	7"	26#	P-110	5638'		207	4567'
PRODUCTION							
LINER	4-1/2"	11.6#	N-80	4937'-10052'			
TOTAL DEPTH							10,068'

PACKER @ \_\_\_\_\_ BRAND & TYPE \_\_\_\_\_ PLUG @ \_\_\_\_\_ TYPE \_\_\_\_\_ PLUG @ \_\_\_\_\_ TYPE \_\_\_\_\_  
 PACKER @ \_\_\_\_\_ BRAND & TYPE \_\_\_\_\_ PLUG @ \_\_\_\_\_ TYPE \_\_\_\_\_ PLUG @ \_\_\_\_\_ TYPE \_\_\_\_\_

COMPLETION & TEST DATA BY PRODUCING FORMATION 359MSSP

FORMATION	Mississippi an						
SPACING & SPACING ORDER NUMBER	640Ac. 605056						
CLASS: Oil, Gas, Dry, Inj, Disp, Comm Disp, Svc	Oil						
PERFORATED INTERVALS	17 Stages						
	-5,638' - 10,068'						
	open hole						
ACID/VOLUME	Total	2871 bbls 15%HCL					
	Total	55,060 bbls H2O					
FRACTURE TREATMENT (Fluids/Prop Amounts)	Total	852,300 lbs 30/50					
	Total	811,700 lbs 20/40					

Reported to Focus Focus

Min Gas Allowable (165-10-17-7) OR  Oil Allowable (165-10-13-3)  
 Gas Purchaser/Measurer PVR  
 First Sales Date 10/12/13

INITIAL TEST DATE	11/7/2013			
OIL-BBL/DAY	157			
OIL-GRAVITY ( API)	41			
GAS-MCF/DAY	373			
GAS-OIL RATIO CU FT/BBL	2376			
WATER-BBL/DAY	519			
PUMPING OR FLOWING	PUMPING			
INITIAL SHUT-IN PRESSURE				
CHOKE SIZE	OPEN			
FLOW TUBING PRESSURE	140 psi FTP			

A record of the formations drilled through, and pertinent remarks are presented on the reverse. I declare that I have knowledge of the contents of this report and am authorized by my organization to make this report, which was prepared by me or under my supervision and direction, with the data and facts stated herein to be true, correct, and complete to the best of my knowledge and belief.

*Donald Hodgson III*  
 Donald Hodgson III 11/19/13 (303)543-5700  
 NAME (PRINT OR TYPE) DATE PHONE NUMBER  
 633 17th St, Ste. #1950 Denver, CO 80202 thodgson@sundanceenergy.net  
 ADDRESS CITY STATE ZIP EMAIL ADDRESS

PLEASE TYPE OR USE BLACK INK ONLY  
FORMATION RECORD

Give formation names and tops, if available, or descriptions and thickness of formations drilled through. Show intervals cored or drillstem tested.

LEASE NAME Commissioners 20-2-30

WELL NO. 1 HM

NAMES OF FORMATIONS	TOP
Hogshooter	4335'
Oswego	5007'
Verdigris	5138'
Inola	5256'
Mississippi	5321'
All top depths in ft. TVD	

FOR COMMISSION USE ONLY

ITD on file  YES  NO

APPROVED \_\_\_\_\_ DISAPPROVED \_\_\_\_\_

2) Reject Codes

---

---

---

---

---

---

Were open hole logs run? \_\_\_\_\_ yes  no

Date Last log was run \_\_\_\_\_

Was CO<sub>2</sub> encountered? \_\_\_\_\_ yes  no at what depths? \_\_\_\_\_

Was H<sub>2</sub>S encountered? \_\_\_\_\_ yes  no at what depths? \_\_\_\_\_

Were unusual drilling circumstances encountered? \_\_\_\_\_ yes  no  
If yes, briefly explain below \_\_\_\_\_

Other remarks: *OCC - This well is an open hole completion from bottom of the 7" casing at 5638' to terminus at 10,068'. The 4 1/2" liner is not cemented.*

640 Acres

X									

If more than three drainholes are proposed, attach a separate sheet indicating the necessary information.

Direction must be stated in degrees azimuth. Please note, the horizontal drainhole and its end point must be located within the boundaries of the lease or spacing unit.

Directional surveys are required for all drainholes and directional wells.

640 Acres

BOTTOM HOLE LOCATION FOR DIRECTIONAL HOLE

SEC	TWP	RGE	COUNTY
Spot Location			
1/4	1/4	1/4	1/4
Measured Total Depth		True Vertical Depth	BHL From Lease, Unit, or Property Line:

BOTTOM HOLE LOCATION FOR HORIZONTAL HOLE: (LATERALS)

LATERAL #1

SEC	TWP	RGE	COUNTY
30	20N	2W	Logan
Spot Location			
SE 1/4	SW 1/4	SW 1/4	SW 1/4
Depth of Deviation 4866'		Radius of Turn 1227'	Direction S
Measured Total Depth 10,067.6'		True Vertical Depth 5,350.5'	BHL From Lease, Unit, or Property Line: FSL 165', FWL 653'

LATERAL #2

SEC	TWP	RGE	COUNTY
Spot Location			
1/4	1/4	1/4	1/4
Depth of Deviation		Radius of Turn	Direction
Measured Total Depth		True Vertical Depth	BHL From Lease, Unit, or Property Line:

LATERAL #3

SEC	TWP	RGE	COUNTY
Spot Location			
1/4	1/4	1/4	1/4
Depth of Deviation		Radius of Turn	Direction
Measured Total Depth		True Vertical Depth	BHL From Lease, Unit, or Property Line: