

Oklahoma Corporation Commission
Oil & Gas Conservation Division
Post Office Box 52000
Oklahoma City, Oklahoma 73152-2000
Rule 165: 10-3-25

Form 1002A

API No.: 35083241370000

Completion Report

Spud Date: July 12, 2013

OTC Prod. Unit No.:

Drilling Finished Date: August 08, 2013

1st Prod Date: October 18, 2013

Completion Date: October 01, 2013

Drill Type: HORIZONTAL HOLE

Min Gas Allowable: Yes

Well Name: BUFFORD 1-20H

Purchaser/Measurer: SUPERIOR

Location: LOGAN 20 17N 4W
SE SW SE SE
203 FSL 809 FEL of 1/4 SEC
Derrick Elevation: 1076 Ground Elevation: 1061

First Sales Date: 10/18/2013

Operator: PAYNE EXPLORATION COMPANY 918

7005 N ROBINSON AVE
OKLAHOMA CITY, OK 73116-9044

Completion Type		Location Exception		Increased Density	
X	Single Zone	Order No		Order No	
	Multiple Zone	615081		There are no Increased Density records to display.	
	Commingled	618183			

Casing and Cement							
Type	Size	Weight	Grade	Feet	PSI	SAX	Top of CMT
CONDUCTOR	16			85		8	SURFACE
SURFACE	9 5/8	36	J-55	657	600	280	SURFACE
INTERMEDIATE	7	26	J-55	7187	1150	175	5990
PRODUCTION	4.5	11.6	P-110	11334	1500	400	6300

Liner								
Type	Size	Weight	Grade	Length	PSI	SAX	Top Depth	Bottom Depth
There are no Liner records to display.								

Total Depth: 11334

Packer	
Depth	Brand & Type
7137	BAKER MODEL R

Plug	
Depth	Plug Type
There are no Plug records to display.	

Initial Test Data										
Test Date	Formation	Oil BBL/Day	Oil-Gravity (API)	Gas MCF/Day	Gas-Oil Ratio Cu FT/BBL	Water BBL/Day	Pumpin or Flowing	Initial Shut-In Pressure	Choke Size	Flow Tubing Pressure
Oct 31, 2013	HUNTON	28.6	37.5			786	GAS LIFT		2	180

Completion and Test Data by Producing Formation									
Formation Name: HUNTON				Code: 269HNTN			Class: OIL		
Spacing Orders				Perforated Intervals					
Order No		Unit Size		From			To		
613643		320		7188			11290		
Acid Volumes				Fracture Treatments					
4,164 BARRELS 15%				175,244 BFW, 3,336,020 POUNDS					

Formation	Top
LAYTON	5107
HOGSHOOTER	5368
CHECKERBOARD	5491
BIG LIME	5797
OSWEGO	5913
VERDIGRIS	6028
PINK	6128
MISSISSIPPI	6215
WOODFORD SHALE	6511
HUNTON LIME	6643

Were open hole logs run? Yes

Date last log run: August 06, 2013

Were unusual drilling circumstances encountered? No

Explanation:

Other Remarks
FMI LOG NOT REQUIRED TO BE SUBMITTED TO OCC. IRREGULAR SECTION.

Lateral Holes
Sec: 20 TWP: 17N RGE: 4W County: LOGAN NW NE NW NE 216 FNL 979 FWL of 1/4 SEC Depth of Deviation: 6125 Radius of Turn: 1168 Direction: 348 Total Length: 4912 Measured Total Depth: 11334 True Vertical Depth: 6791 End Pt. Location From Release, Unit or Property Line: 216

FOR COMMISSION USE ONLY
Status: Accepted

API NO. 083-24137
OTC PROD.
UNIT NO.

PLEASE TYPE OR USE BLACK INK ON
NOTE:

Attach copy of original 1002A
if recompletion or reentry.

AS SUBMITTED

RECEIVED

NOV 06 2013

Form 1002A
Rev. 2009

☒ ORIGINAL
☐ AMENDED (Reason)

Rule 165:10-3-25

COMPLETION REPORT

TYPE OF DRILLING OPERATION

☐ STRAIGHT HOLE ☐ DIRECTIONAL HOLE ☒ HORIZONTAL HOLE
☐ SERVICE WELL

If directional or horizontal, see reverse for bottom hole location.

COUNTY	Logan	SEC	20	TWP	17N	RGE	04W
LEASE NAME	Bufford	WELL NO.	1-20H				
SE 1/4 SW 1/4 SE 1/4 SE 1/4	FSL OF 1/4 SEC	203	FEL OF 1/4 SEC	809	DATE OF WELL COMPLETION	10/17/13	
ELEVATION	1076	Ground	1061	Latitude (if known)	Longitude (if known)	1st PROD DATE	10/18/13
OPERATOR NAME	Payne Exploration Company	OTC/OCC OPERATOR NO.	918				
ADDRESS	7005 N. Robinson						
CITY	Oklahoma City	STATE	OK	ZIP	73116		

OKLAHOMA CORPORATION COMMISSION

640 Acres

W E

LOCATE WELL

COMPLETION TYPE

<input checked="" type="checkbox"/> SINGLE ZONE
<input type="checkbox"/> MULTIPLE ZONE
<input type="checkbox"/> COMMINGLED
LOCATION EXCEPTION ORDER NO
INCREASED DENSITY ORDER NO

Interim 615081

CASING & CEMENT (Form 1002C must be attached)

TYPE	SIZE	WEIGHT	GRADE	FEET	PSI	SAX	TOP OF CMT
CONDUCTOR	16"			85'		8.5 yds	Surface
SURFACE	9 5/8"	36#	J-55	657'	600	280	Surface
INTERMEDIATE	7"	26#	J-55	7187'	1150	175	5990 +/-
PRODUCTION	4.5"	11.6#	P-110	11,329'	1500	400	6300 +/-
LINER							

PACKER @ 7137' BRAND & TYPE Baker Mod R PLUG @ TYPE PLUG @ TYPE
PACKER @ BRAND & TYPE PLUG @ TYPE PLUG @ TYPE

TOTAL DEPTH 11,334

COMPLETION & TEST DATA BY PRODUCING FORMATION

FORMATION	Hunton	269 HNTIV
SPACING & SPACING ORDER NUMBER	320 AC 613643	Reported to Frac Focus
CLASS: Oil, Gas, Dry, Inj, Disp, Comm Disp, Svc	Oil	
PERFORATED INTERVALS	7188' - 11,290'	
ACID/VOLUME	15% 4164 Bbls	
FRACTURE TREATMENT (Fluids/Prop Amounts)	175,244 BFW 3,556,020#	

Min Gas Allowable (165:10-17-7)

Gas Purchaser/Measurer

Superior

☒

OR

First Sales Date

10/18/2013

INITIAL TEST DATA

Oil Allowable (165:10-13-3)

INITIAL TEST DATE	10/31/2013
OIL-BBL/DAY	28.6
OIL-GRAVITY (API)	37.5
GAS-MCF/DAY	0 MCF
GAS-OIL RATIO CU FT/BBL	-
WATER-BBL/DAY	786
PUMPING OR FLOWING	Gas Lift
INITIAL SHUT-IN PRESSURE	0
CHOKE SIZE	2"
FLOW TUBING PRESSURE	180#

A record of the formations drilled through, and pertinent remarks are presented on the reverse. I declare that I have knowledge of the contents of this report and am authorized by my organization to make this report, which was prepared by me or under my supervision and direction, with the data and facts stated herein to be true, correct, and complete to the best of my knowledge and belief.

SIGNATURE	Terry A. Daniel	DATE	11/5/2013	PHONE NUMBER	405-843-9419
ADDRESS	7005 N. Robinson	CITY	OKC, OK	STATE	73116
EMAIL ADDRESS	tdaniel@payneenergy.com				

PLEASE TYPE OR USE BLACK INK ONLY

FORMATION RECORD

Give formation names and tops, if available, or descriptions and thickness of formations drilled through. Show intervals cored or drillstem tested.

NAMES OF FORMATIONS	TOP
Layton	5107'
Hogshooter	5368'
Checkerboard	5491'
Big Lime	5797'
Oswego	5913'
Verdigris	6028'
Pink	6128'
Mississippi	6215'
Woodford Shale	6511'
Hunton Lime	6643'

LEASE NAME Bufford WELL NO. 1-20H

FOR COMMISSION USE ONLY	
ITD on file <input type="checkbox"/> YES <input type="checkbox"/> NO	
APPROVED _____	DISAPPROVED _____
2) Reject Codes	

Were open hole logs run? ☒ yes ☐ no

Date Last log was run 8/6/13 FMI Only

Was CO₂ encountered? ☐ yes ☒ no at what depths? _____

Was H₂S encountered? ☐ yes ☒ no at what depths? _____

Were unusual drilling circumstances encountered? ☐ yes ☒ no

If yes, briefly explain below: _____

Other remarks: FMI log not required to be submitted to OCC.

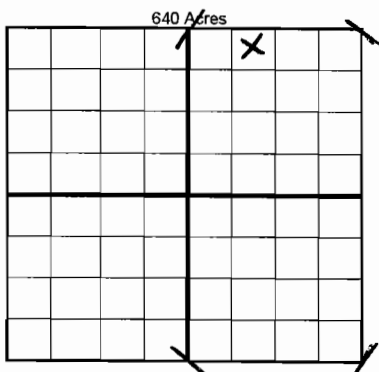

If more than three drainholes are proposed, attach a separate sheet indicating the necessary information.

Direction must be stated in degrees azimuth. Please note, the horizontal drainhole and its end point must be located within the boundaries of the lease or spacing unit.

Directional surveys are required for all drainholes and directional wells.

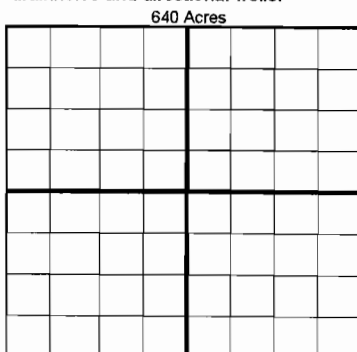

BOTTOM HOLE LOCATION FOR DIRECTIONAL HOLE

SEC	TWP	RGE	COUNTY
Spot Location			
1/4	1/4	1/4	1/4
Measured Total Depth	True Vertical Depth	BHL From Lease, Unit, or Property Line:	

BOTTOM HOLE LOCATION FOR HORIZONTAL HOLE: (LATERALS)

LATERAL #1

SEC	TWP	RGE	COUNTY
20	17N	04W	Logan
Spot Location			
N/2	1/4	NE 1/4	NE 1/4
Depth of Deviation	6125'	Radius of Turn	1168'
Measured Total Depth	11,334'	True Vertical Depth	6795'
		Direction	348
		Total Length	4912'
		BHL From Lease, Unit, or Property Line: 252'	

LATERAL #2

SEC	TWP	RGE	COUNTY
Spot Location			
1/4	1/4	1/4	1/4
Depth of Deviation	Radius of Turn		
Measured Total Depth	True Vertical Depth		
		Direction	Total Length
		BHL From Lease, Unit, or Property Line:	

LATERAL #3

SEC	TWP	RGE	COUNTY
Spot Location			
1/4	1/4	1/4	1/4
Depth of Deviation	Radius of Turn		
Measured Total Depth	True Vertical Depth		
		Direction	Total Length
		BHL From Lease, Unit, or Property Line:	