

Oklahoma Corporation Commission  
Oil & Gas Conservation Division  
Post Office Box 52000  
Oklahoma City, Oklahoma 73152-2000  
Rule 165: 10-3-25

Form 1002A

API No.: 35103244850000

**Completion Report**

Spud Date: March 01, 2013

OTC Prod. Unit No.:

Drilling Finished Date: March 21, 2013

1st Prod Date: May 25, 2013

Completion Date: April 24, 2013

**Drill Type: HORIZONTAL HOLE**

Well Name: CARNEGIE 1-36H

Purchaser/Measurer:

Location: NOBLE 36 20N 1W  
SE SE SE SW  
150 FSL 2487 FWL of 1/4 SEC  
Derrick Elevation: 996 Ground Elevation: 981

First Sales Date:

Operator: RED FORK (USA) INVESTMENTS INC 22094

1437 S BOULDER AVE STE 700  
TULSA, OK 74119-3617

Completion Type	
X	Single Zone
	Multiple Zone
	Commingled

Location Exception	
Order No	
613905	

Increased Density	
Order No	
There are no Increased Density records to display.	

Casing and Cement							
Type	Size	Weight	Grade	Feet	PSI	SAX	Top of CMT
CONDUCTOR	16			60		8	SURFACE
SURFACE	9 5/8	36		507		250	SURFACE
PRODUCTION	7	26	P-110	5453		265	3629

Liner								
Type	Size	Weight	Grade	Length	PSI	SAX	Top Depth	Bottom Depth
LINER	4 1/2	11.6	P-110	4387	0	840	5220	9607

**Total Depth: 9635**

Packer	
Depth	Brand & Type
There are no Packer records to display.	

Plug	
Depth	Plug Type
There are no Plug records to display.	

Initial Test Data										
Test Date	Formation	Oil BBL/Day	Oil-Gravity (API)	Gas MCF/Day	Gas-Oil Ratio Cu FT/BBL	Water BBL/Day	Pumpin or Flowing	Initial Shut-In Pressure	Choke Size	Flow Tubing Pressure
Jul 22, 2013	MISSISSIPPIAN	78		278	3564	329	PUMPING			

Completion and Test Data by Producing Formation										
Formation Name: MISSISSIPPIAN			Code: 359MSSP			Class: OIL				
<b>Spacing Orders</b>				<b>Perforated Intervals</b>						
<b>Order No</b>	<b>Unit Size</b>			<b>From</b>			<b>To</b>			
607317	640			5564			9544			
<b>Acid Volumes</b>				<b>Fracture Treatments</b>						
24 BARRELS 15% HCL				1,500 BARRELS 15% HCL, 972,260 POUNDS 40/70						

Formation	Top
CHECKERBOARD	4106
BIG LIME	4290
OSWEGO	4378
VERDIGRIS	4528
PINK LIME	4651
MISSISSIPPI	4875

Were open hole logs run? Yes  
Date last log run: March 22, 2013

Were unusual drilling circumstances encountered? No  
Explanation:

Other Remarks
IRREGULAR SECTION.

Lateral Holes
Sec: 36 TWP: 20N RGE: 1W County: NOBLE
NE NE NE NW
2465 FSL 2379 FWL of 1/4 SEC
Depth of Deviation: 4310 Radius of Turn: 804 Direction: 356 Total Length: 4955
Measured Total Depth: 9635 True Vertical Depth: 4902 End Pt. Location From Release, Unit or Property Line: 175

FOR COMMISSION USE ONLY
Status: Accepted
1121371

RECEIVED

AS SUBMITTED

OCT 11 2013

Form 1002A Rev. 2009

API NO. 103-24485
OTC PROD.
UNIT NO.

PLEASE TYPE OR USE BLACK INK ON NOTE:

Attach copy of original 1002A if recompletion or reentry.

Oklahoma City, Oklahoma, P.O. Box 2000
Rule 165:10-3-25

OKLAHOMA CORPORATION COMMISSION

ORIGINAL
AMENDED (Reason)

COMPLETION REPORT

TYPE OF DRILLING OPERATION
STRAIGHT HOLE
DIRECTIONAL HOLE
HORIZONTAL HOLE
SERVICE WELL

SPUD DATE 3/1/13
DRLG FINISHED DATE 3/21/13
DATE OF WELL COMPLETION 4/24/13
1st PROD DATE 5/25/13
RECOMP DATE
ELEVATION N Derrick 996' Ground 981'
Latitude (if known)
Longitude (if known)
OPERATOR NAME Red Fork (USA) Investments, Inc.
OTC/OCC OPERATOR NO. 22094
ADDRESS 1437 S Boulder Ave., Suite 700
CITY Tulsa STATE OK ZIP 74119

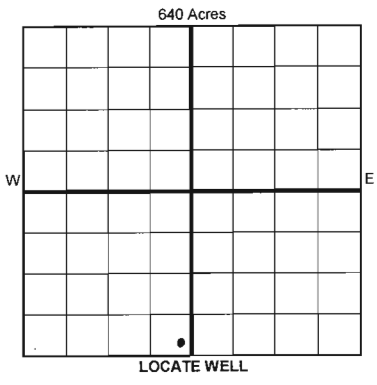

COUNTY Noble SEC 36 TWP 20N RGE 1W
LEASE NAME Carnegie
WELL NO. 1-36H
SE 1/4 SE 1/4 SE 1/4 SW 1/4
FSL OF 1/4 SEC 150 FWL OF 1/4 SEC 2487
ELEVATION N Derrick 996' Ground 981'
Latitude (if known)
Longitude (if known)
OPERATOR NAME Red Fork (USA) Investments, Inc.
OTC/OCC OPERATOR NO. 22094
ADDRESS 1437 S Boulder Ave., Suite 700
CITY Tulsa STATE OK ZIP 74119

COMPLETION TYPE
SINGLE ZONE
MULTIPLE ZONE
COMMINGLED
LOCATION EXCEPTION ORDER 613905
INCREASED DENSITY ORDER NO.

Table with columns: TYPE, SIZE, WEIGHT, GRADE, FEET, PSI, SAX, TOP OF CMT. Rows include CONDUCTOR, SURFACE, INTERMEDIATE, PRODUCTION, LINER, and TOTAL DEPTH 9635'.

PACKER @ BRAND & TYPE PLUG @ TYPE PLUG @ TYPE
PACKER @ BRAND & TYPE PLUG @ TYPE PLUG @ TYPE

Table for COMPLETION & TEST DATA BY PRODUCING FORMATION. Includes handwritten entries for Formation (Mississippi an), Spacing & Spacing (607317 640 ac), Class (Oil), Perforated Intervals (5564 - 9544'), Acid Volume (24 bbl 15% HCl), and Fracture Treatment (1500 bbl 15% HCl, 972,260 lb 40/70).

Min Gas Allowable (165:10-17-7) Gas Purchaser/Measurer
OR
Oil Allowable (165:10-13-3) First Sales Date

Table for INITIAL TEST DATA. Includes fields for Initial Test Date (7/22/13), Oil-Bbl/Day (78), Gas-Mcf/Day (278), Gas-Oil Ratio (3564), Water-Bbl/Day (329), Pumping or Flowing (Pumping), Initial Shut-in Pressure, Choke Size, and Flow Tubing Pressure.

A record of the formations drilled through, and pertinent remarks are presented on the reverse. I declare that I have knowledge of the contents of this report and am authorized by my organization to make this report, which was prepared by me or under my supervision and direction, with the data and facts stated herein to be true, correct, and complete to the best of my knowledge and belief.

SIGNATURE: Sara Evans, NAME (PRINT OR TYPE): Sara Evans, DATE: 10/9/13, PHONE NUMBER: 918-879-1942
ADDRESS: 1437 S Boulder Ave., Suite 700, CITY: Tulsa, STATE: OK, ZIP: 74119, EMAIL ADDRESS: sevans@redforkenergy.com

PLEASE TYPE OR USE BLACK INK ONLY  
FORMATION RECORD

Give formation names and tops, if available, or descriptions and thickness of formations drilled through. Show intervals cored or drillstem tested.

LEASE NAME Carnegie WELL NO. 1-36H

NAMES OF FORMATIONS	TOP
Checkerboard	4106' TVD
Big Lime	4290'
Oswego	4378'
Verdigris	4528'
Pink Lime	4651'
Mississippi	4875'

FOR COMMISSION USE ONLY

ITD on file  YES  NO

APPROVED \_\_\_\_\_ DISAPPROVED \_\_\_\_\_

2) Reject Codes \_\_\_\_\_  
\_\_\_\_\_  
\_\_\_\_\_  
\_\_\_\_\_

Were open hole logs run?  yes  no

Date Last log was run 3/22/13

Was CO<sub>2</sub> encountered?  yes  no at what depths? \_\_\_\_\_

Was H<sub>2</sub>S encountered?  yes  no at what depths? \_\_\_\_\_

Were unusual drilling circumstances encountered?  yes  no  
If yes, briefly explain below \_\_\_\_\_

Other remarks: \_\_\_\_\_  
\_\_\_\_\_  
\_\_\_\_\_  
\_\_\_\_\_

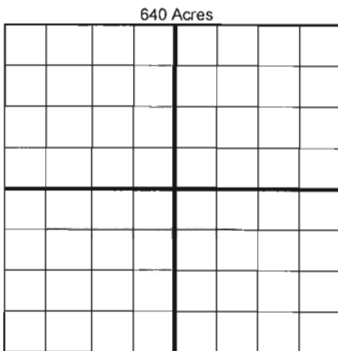

BOTTOM HOLE LOCATION FOR DIRECTIONAL HOLE

SEC	TWP	RGE	COUNTY				
Spot Location	1/4	1/4	1/4	1/4	Feet From 1/4 Sec Lines	FSL	FWL
Measured Total Depth	True Vertical Depth		BHL From Lease, Unit, or Property Line:				

BOTTOM HOLE LOCATION FOR HORIZONTAL HOLE: (LATERALS)

LATERAL #1

SEC	TWP	RGE	COUNTY				
36	20N	1W	Noble				
Spot Location	NE 1/4	NE 1/4	NE 1/4	NW 1/4	Feet From 1/4 Sec Lines	FSL 2470	FWL 2379
Depth of Deviation	4310'	Radius of Turn	804'	Direction	356	Total Length	4955'
Measured Total Depth	True Vertical Depth		BHL From Lease, Unit, or Property Line:				
	9635'		4956'		175'		

LATERAL #2

SEC	TWP	RGE	COUNTY				
Spot Location	1/4	1/4	1/4	1/4	Feet From 1/4 Sec Lines	FSL	FWL
Depth of Deviation	Radius of Turn		Direction		Total Length		
Measured Total Depth	True Vertical Depth		BHL From Lease, Unit, or Property Line:				

LATERAL #3

SEC	TWP	RGE	COUNTY				
Spot Location	1/4	1/4	1/4	1/4	Feet From 1/4 Sec Lines	FSL	FWL
Depth of Deviation	Radius of Turn		Direction		Total Length		
Measured Total Depth	True Vertical Depth		BHL From Lease, Unit, or Property Line:				

If more than three drainholes are proposed, attach a separate sheet indicating the necessary information.

Direction must be stated in degrees azimuth. Please note, the horizontal drainhole and its end point must be located within the boundaries of the lease or spacing unit.

Directional surveys are required for all drainholes and directional wells.

