

Oklahoma Corporation Commission
Oil & Gas Conservation Division
Post Office Box 52000
Oklahoma City, Oklahoma 73152-2000
Rule 165: 10-3-25

Form 1002A

API No.: 35103245130000

Completion Report

Spud Date: May 21, 2013

OTC Prod. Unit No.:

Drilling Finished Date: June 06, 2013

1st Prod Date: July 11, 2013

Completion Date: June 23, 2013

Drill Type: HORIZONTAL HOLE

Well Name: JEKYL & HYDE 1-14H

Purchaser/Measurer:

Location: NOBLE 14 20N 1E
NW SW SE SE
509 FSL 1478 FWL of 1/4 SEC
Derrick Elevation: 0 Ground Elevation: 1014

First Sales Date:

Operator: RED FORK (USA) INVESTMENTS INC 22094

1437 S BOULDER AVE STE 700
TULSA, OK 74119-3617

Completion Type	
X	Single Zone
	Multiple Zone
	Commingled

Location Exception
Order No
614818

Increased Density
Order No
There are no Increased Density records to display.

Casing and Cement							
Type	Size	Weight	Grade	Feet	PSI	SAX	Top of CMT
CONDUCTOR	16			55		8	SURFACE
SURFACE	9 5/8	36	J-55	516		260	SURFACE
PRODUCTION	7	26	P-110	5484		240	3428

Liner								
Type	Size	Weight	Grade	Length	PSI	SAX	Top Depth	Bottom Depth
LINER	4 1/2	11.6	P-110	3956	0	345	5262	9218

Total Depth: 9228

Packer	
Depth	Brand & Type
There are no Packer records to display.	

Plug	
Depth	Plug Type
There are no Plug records to display.	

Initial Test Data										
Test Date	Formation	Oil BBL/Day	Oil-Gravity (API)	Gas MCF/Day	Gas-Oil Ratio Cu FT/BBL	Water BBL/Day	Pumpin or Flowing	Initial Shut-In Pressure	Choke Size	Flow Tubing Pressure
Aug 11, 2013	WOODFORD	211		963	4564	1678	PUMPING			

Completion and Test Data by Producing Formation			
Formation Name: WOODFORD	Code: 319WDFD	Class: OIL	
Spacing Orders		Perforated Intervals	
Order No	Unit Size	From	To
598044	640	5563	9123
Acid Volumes		Fracture Treatments	
1,000 GALLONS 15% AND 1,700 GALLONS 7 1/2% HCL		1,050 BARRELS 15% HCL, 1,945,960 POUNDS 40/70	

Formation	Top
CHECKERBOARD	3910
BIG LIME	4101
OSWEGO	4202
VERDIGRIS	4350
PINK LIME	4473
BARTLESVILLE	4547
MISSISSIPPI	4677
WOODFORD	4890

Were open hole logs run? No

Date last log run:

Were unusual drilling circumstances encountered? No

Explanation:

Other Remarks
IRREGULAR SECTION.

Lateral Holes

Sec: 14 TWP: 20N RGE: 1E County: NOBLE

NW NW NE NE

161 FNL 1237 FEL of 1/4 SEC

Depth of Deviation: 4215 Radius of Turn: 1107 Direction: 347 Total Length: 4650

Measured Total Depth: 9228 True Vertical Depth: 4910 End Pt. Location From Release, Unit or Property Line: 161

FOR COMMISSION USE ONLY

1121360

Status: Accepted

AS SUBMITTED

RECEIVED

Form 1002A
Rev. 2009

OCT 11 2013

OKLAHOMA CORPORATION
COMMISSION

API NO. 103-24513
OTC PROD.
UNIT NO.

PLEASE TYPE OR USE BLACK
NOTE:

Attach copy of original
if recompletion or reer

Rule 165-10-3-25

ORIGINAL
 AMENDED (Reason)

COMPLETION REPORT

TYPE OF DRILLING OPERATION

STRAIGHT HOLE DIRECTIONAL HOLE HORIZONTAL HOLE
 SERVICE WELL

If directional or horizontal, see reverse for bottom hole location.

SPUD DATE 5/21/13
DRLG FINISHED DATE 6/6/13
DATE OF WELL COMPLETION 6/23/13
1st PROD DATE 7/11/13
RECOMP DATE
Longitude (if known)
OTC/OCC OPERATOR NO. 22094

COUNTY Noble SEC 14 TWP 20N RGE 1E
LEASE NAME Jekyll & Hyde
WELL NO. 1-14H
NW 1/4 SW 1/4 SE 1/4 SE 1/4 FSL OF 1/4 SEC 509 FWL OF 1/4 SEC 1478
ELEVATION N Derrick Ground 1014' Latitude (if known)
OPERATOR NAME Red Fork (USA) Investments, Inc.
ADDRESS 1437 S Boulder Ave., Suite 700
CITY Tulsa STATE OK ZIP 74119

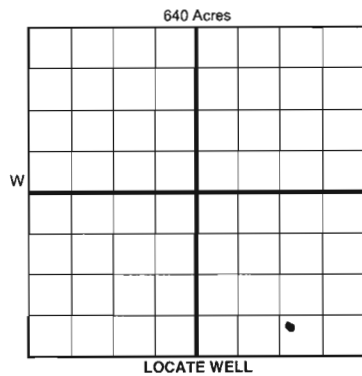

COMPLETION TYPE

SINGLE ZONE
 MULTIPLE ZONE
Application Date
 COMMINGLED
Application Date
LOCATION EXCEPTION ORDER 614818
INCREASED DENSITY ORDER NO.

CASING & CEMENT (Form 1002C must be attached)

TYPE	SIZE	WEIGHT	GRADE	FEET	PSI	SAX	TOP OF CMT
CONDUCTOR	16"			55'			
SURFACE	9 5/8"	36#	J-55	512'		260	Surface
INTERMEDIATE	7"	26#	P-110	5484'		240	
PRODUCTION							
LINER	4 1/2"	11.6#	P-110	9218'		345	
						TOTAL DEPTH	9228'

PACKER @ _____ BRAND & TYPE _____ PLUG @ _____ TYPE _____ PLUG @ _____ TYPE _____
PACKER @ _____ BRAND & TYPE _____ PLUG @ _____ TYPE _____ PLUG @ _____ TYPE _____

COMPLETION & TEST DATA BY PRODUCING FORMATION

FORMATION	SPACING & SPACING ORDER NUMBER	CLASS: Oil, Gas, Dry, Inj, Disp, Comm Disp, Svc	PERFORATED INTERVALS	ACID/VOLUME	FRACTURE TREATMENT (Fluids/Prop Amounts)
Woodford	598044 640 ac	Oil	5563 - 9125'	1000 gal 15% & 1700 gal 7 1/2% HCl	1050 bbl 15% HCl 1,945,960 lb 40/70

319 WDFD

Monitor Report to FracFocus

Min Gas Allowable (165-10-17-7)

Gas Purchaser/Measurer

OR

First Sales Date

Oil Allowable (165-10-13-3)

INITIAL TEST DATA

INITIAL TEST DATE	8/11/13
OIL-BBL/DAY	211
OIL-GRAVITY (API)	
GAS-MCF/DAY	963
GAS-OIL RATIO CU FT/BBL	4563
WATER-BBL/DAY	1678
PUMPING OR FLOWING	Pumping
INITIAL SHUT-IN PRESSURE	
CHOKE SIZE	
FLOW TUBING PRESSURE	

A record of the formations drilled through, and pertinent remarks are presented on the reverse. I declare that I have knowledge of the contents of this report and am authorized by my organization to make this report, which was prepared by me or under my supervision and direction, with the data and facts stated herein to be true, correct, and complete to the best of my knowledge and belief.

Sara Evans
SIGNATURE Sara Evans NAME (PRINT OR TYPE) 10/9/13 DATE 918-879-1942 PHONE NUMBER
1437 S Boulder Ave., Suite 700 ADDRESS Tulsa CITY OK STATE 74119 ZIP sevans@redforkenergy.com EMAIL ADDRESS

PLEASE TYPE OR USE BLACK INK ONLY
FORMATION RECORD

Give formation names and tops, if available, or descriptions and thickness of formations drilled through. Show intervals cored or drillstem tested.

LEASE NAME Jekyll & Hyde

WELL NO. 1-14H

NAMES OF FORMATIONS	TOP
Checkerboard	3910' TVD
Big Lime	4101'
Oswego	4202'
Verdigris	4350'
Pink Lime	4473'
Bartlesville	4547'
Mississippi	4677'
Woodford	4890'

FOR COMMISSION USE ONLY

ITD on file YES NO

APPROVED _____ DISAPPROVED _____

2) Reject Codes _____

Were open hole logs run? _____ yes no

Date Last log was run _____

Was CO₂ encountered? _____ yes no at what depths? _____

Was H₂S encountered? _____ yes no at what depths? _____

Were unusual drilling circumstances encountered? _____ yes no
If yes, briefly explain below _____

Other remarks: _____

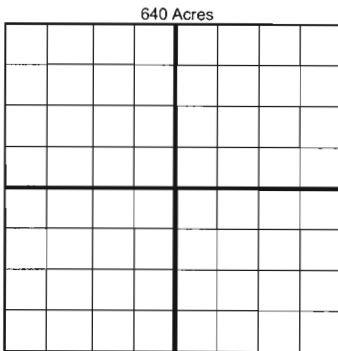

If more than three drainholes are proposed, attach a separate sheet indicating the necessary information.

Direction must be stated in degrees azimuth. Please note, the horizontal drainhole and its end point must be located within the boundaries of the lease or spacing unit.

Directional surveys are required for all drainholes and directional wells.

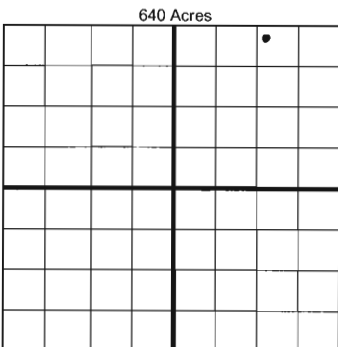

BOTTOM HOLE LOCATION FOR DIRECTIONAL HOLE

SEC	TWP	RGE	COUNTY				
Spot Location	1/4	1/4	1/4	1/4	Feet From 1/4 Sec Lines	FSL	FWL
Measured Total Depth	True Vertical Depth		BHL From Lease, Unit, or Property Line:				

BOTTOM HOLE LOCATION FOR HORIZONTAL HOLE: (LATERALS)

LATERAL #1

SEC	TWP	RGE	COUNTY				
14	20N	1E	Noble				
Spot Location	NW 1/4	NW 1/4	NE 1/4	NE 1/4	Feet From 1/4 Sec Lines	FSL 2494	FWL 1400
Depth of Deviation	4215'	Radius of Turn	1107'	Direction	347	Total Length	4650'
Measured Total Depth	True Vertical Depth		BHL From Lease, Unit, or Property Line:				
	9228'		4925'		161'		

LATERAL #2

SEC	TWP	RGE	COUNTY				
Spot Location	1/4	1/4	1/4	1/4	Feet From 1/4 Sec Lines	FSL	FWL
Depth of Deviation	Radius of Turn		Direction		Total Length		
Measured Total Depth	True Vertical Depth		BHL From Lease, Unit, or Property Line:				

LATERAL #3

SEC	TWP	RGE	COUNTY				
Spot Location	1/4	1/4	1/4	1/4	Feet From 1/4 Sec Lines	FSL	FWL
Depth of Deviation	Radius of Turn		Direction		Total Length		
Measured Total Depth	True Vertical Depth		BHL From Lease, Unit, or Property Line:				