

Oklahoma Corporation Commission
Oil & Gas Conservation Division
Post Office Box 52000
Oklahoma City, Oklahoma 73152-2000
Rule 165: 10-3-25

Form 1002A

API No.: 35045233620000

Completion Report

Spud Date: July 02, 2013

OTC Prod. Unit No.: 045-211273

Drilling Finished Date: July 27, 2013

1st Prod Date: August 30, 2013

Completion Date: September 19, 2013

Drill Type: HORIZONTAL HOLE

Min Gas Allowable: Yes

Well Name: GROSS 16-2H

Purchaser/Measurer: DCP MIDSTREAM LP

Location: ELLIS 16 17N 24W
SE SW SE SE
250 FSL 950 FEL of 1/4 SEC
Derrick Elevation: 0 Ground Elevation: 2263

First Sales Date: 08/30/2013

Operator: EOG RESOURCES INC 16231

3817 NW EXPRESSWAY STE 500
OKLAHOMA CITY, OK 73112-1483

| Completion Type | |
|-----------------|---------------|
| X | Single Zone |
| | Multiple Zone |
| | Commingled |

| Location Exception | |
|--------------------|--|
| Order No | |
| 612682 | |

| Increased Density | |
|-------------------|--|
| Order No | |
| 612470 | |

| Casing and Cement | | | | | | | |
|-------------------|-------|--------|-------|------|-----|-----|------------|
| Type | Size | Weight | Grade | Feet | PSI | SAX | Top of CMT |
| SURFACE | 9 5/8 | 36 | J-55 | 1504 | | 520 | SURFACE |
| PRODUCTION | 7 | 26 | P-110 | 9999 | | 350 | 7369 |

| Liner | | | | | | | | |
|-------|-------|--------|-------|--------|-----|-----|-----------|--------------|
| Type | Size | Weight | Grade | Length | PSI | SAX | Top Depth | Bottom Depth |
| LINER | 4 1/2 | 13.5 | P-110 | 4950 | 0 | 420 | 9134 | 14084 |

Total Depth: 14084

| Packer | |
|--------|--------------|
| Depth | Brand & Type |
| 9134 | PACKER |

| Plug | |
|---------------------------------------|-----------|
| Depth | Plug Type |
| There are no Plug records to display. | |

| Initial Test Data | | | | | | | | | | |
|-------------------|-----------|-------------|-------------------|-------------|-------------------------|---------------|-------------------|--------------------------|------------|----------------------|
| Test Date | Formation | Oil BBL/Day | Oil-Gravity (API) | Gas MCF/Day | Gas-Oil Ratio Cu FT/BBL | Water BBL/Day | Pumpin or Flowing | Initial Shut-In Pressure | Choke Size | Flow Tubing Pressure |
| Sep 22, 2013 | MARMATON | 350 | 43 | 535 | 1529 | 768 | FLOWING | 4650 | OPEN | 210 |

| Completion and Test Data by Producing Formation | | | | | | | | | | |
|---|------------------|--|---------------|---|--|------------|-----------|--|--|--|
| Formation Name: MARMATON | | | Code: 404MRMN | | | Class: OIL | | | | |
| Spacing Orders | | | | Perforated Intervals | | | | | | |
| Order No | Unit Size | | | From | | | To | | | |
| 594259 | 640 | | | 10074 | | | 13945 | | | |
| Acid Volumes | | | | Fracture Treatments | | | | | | |
| There are no Acid Volume records to display. | | | | 6.18MM POUNDS PROPPANT + 5.158MM GALLONS HCL / SLICKWATER | | | | | | |

| Formation | Top |
|---------------|------|
| TOP CLEVELAND | 9316 |
| MARMATON MSF | 9563 |
| MARMATON | 9785 |

Were open hole logs run? No

Date last log run:

Were unusual drilling circumstances encountered? No

Explanation:

| Other Remarks |
|--|
| OCC: FLE ORDER HAS NOT BEEN ISSUED. WE HAVE ACCEPTED OPERATORS DATA AS SUBMITTED. IRREGULAR SECTION. |

| Lateral Holes |
|---|
| Sec: 16 TWP: 17N RGE: 24W County: ELLIS |
| SW NW NE NE |
| 2252 FSL 1429 FWL of 1/4 SEC |
| Depth of Deviation: 9171 Radius of Turn: 620 Direction: 358 Total Length: 4032 |
| Measured Total Depth: 14084 True Vertical Depth: 9582 End Pt. Location From Release, Unit or Property Line: 388 |

| FOR COMMISSION USE ONLY |
|-------------------------|
| Status: Accepted |
| 1121219 |

API NO. **045-23362**
 OTC PROD. UNIT NO. **045-211273**

PLEASE TYPE OR USE BLACK NOTE:

Attach copy of original if recompletion or re

AS SUBMITTED

RECEIVED SEP 27 2013
 OKLAHOMA CORPORATION COMMISSION
 640 Acres

SEP 27 2013

OKLAHOMA CORPORATION COMMISSION
 640 Acres

ORIGINAL
 AMENDED
 Reason Amended

TYPE OF DRILLING OPERATION
 STRAIGHT HOLE DIRECTIONAL HOLE HORIZONTAL HOLE SERVICE WELL

If directional or horizontal, see reverse for bottom hole location.

| | | | | |
|--|------------------------|--|--------------------------------|-------------------------------------|
| COUNTY: ELLIS | SEC 16 | TWP 17N | RGE 24W | SPUD DATE 7/2/2013 |
| LEASE NAME: GROSS | WELL NO: 16 #2H | | | DRLG FINISHED DATE 7/27/2013 |
| SHL: SE 1/4 SW 1/4 SE 1/4 SE 1/4 | FSL 250 | DATE OF WELL COMPLETION 9/19/2013 | | 1ST PROD DATE 8/30/2013 |
| ELEVATION: Ground 2263 | Latitude if known | | Longitude (if known) | |
| OPERATOR NAME EOG RESOURCES, INC. | | | OTC/OCC OPER NO 16231-0 | |
| ADDRESS 3817 NW EXPRESSWAY, SUITE 500 | | | | |
| CITY OKLAHOMA CITY | | STATE OK | ZIP 73112 | |

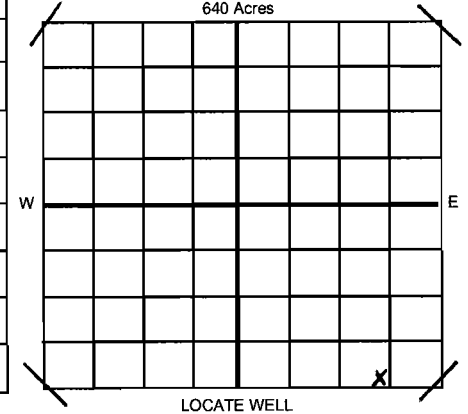

COMPLETION TYPE

SINGLE ZONE
 MULTIPLE ZONE
 COMMINGLED

LOCATION EXCEPTION ORDER NO. **612682 1.0**
 INCREASED DENSITY ORDER NO. **612470**

CASING & CEMENT (Form 1002C must be attached)

| TYPE | SIZE | WEIGHT | GRADE | FEET | PSI | SAX | TOP |
|--------------|-------|--------|-------|------|--------|-----|---------|
| Conductor | | | | | | | |
| Surface | 9 5/8 | 36# | J-55 | 1504 | | 520 | SURFACE |
| Intermediate | | | | | | | |
| Production | 7 | 26# | P-110 | 9999 | | 350 | 7369 |
| Liner | 4 1/2 | 13.5# | P-110 | 9134 | 14084' | 420 | 9134 |

PACKER @ **9134** BRAND & TYPE _____ PLUG@ _____ TYPE _____ PLUG@ _____ TYPE _____ TOTAL DEPTH **14084**

PACKER @ _____ BRAND & TYPE _____ PLUG@ _____ TYPE _____ PLUG@ _____ TYPE _____

COMPLETION & TEST DATA BY PRODUCING FORMATION

| FORMATION | SPACING & SPACING ORDER NUMBER | CLASS: Oil, Gas, Dry, Inj, disp, Comm Disp, svc | PERFORATED INTERVALS | ACID/VOLUME | FRACTURE TREATMENT (Fluids/Prop Amounts) |
|-----------------|--------------------------------|---|----------------------|-------------|--|
| MARMATON | 640/594259 | OIL | 10074-13945' | NO | 6.18MM # PROP + 5.158MM GALS HCL/SLKWTR |

404MARMATON Reported to Frac Focus

INITIAL TEST DATA

Minimum gas allowable (165:10-17-7) OR Oil Allowable (165:10-13-3) Gas Purchaser/Measurer **DCP MIDSTREAM LP** 1st Sales Date **8/30/2013**

| | |
|--------------------------|------------------|
| INITIAL TEST DATE | 9/22/2013 |
| OIL-BBL/DAY | 350 |
| OIL-GRAVITY (API) | 43 |
| GAS-MCF/DAY | 535 |
| GAS-OIL RATIO CU FT/BBL | 1529 |
| WATER-BBL/DAY | 768 |
| PUMPING OR FLOWING | FLOWING |
| INITIAL SHUT-IN PRESSURE | 4650 |
| CHOKE SIZE | OPEN |
| FLOW TUBING PRESSURE | 210 |

A record of the formations drilled through, and pertinent remarks are presented on the reverse. I declare that I have knowledge of the contents of this report and am authorized by my organization to make this report, which was prepared by me or under my supervision and direction, with the data and facts stated herein to be true, correct, and complete to the best of my knowledge and belief.

Dawn Rockel
 SIGNATURE **DAWN ROCKEL** NAME (PRINT OR TYPE) **9/24/2013** DATE **405/246-3226** PHONE NUMBER

3817 NW EXPRESSWAY, SUITE 500 ADDRESS **OKLAHOMA CITY** CITY **OK 73112** STATE ZIP

PLEASE TYPE OR USE BLACK INK ONLY
FORMATION RECORD

LEASE NAME GROSS WELL NO. 16 #2H

Give formation names and tops, if available, or descriptions and thickness of formations drilled through. Show intervals cored or drillstem tested.

| NAME OF FORMATIONS | TOP |
|--------------------|------|
| TOP OF CLEVELAND | 9316 |
| MARMATON MFS | 9563 |
| MARMATON | 9785 |

FOR COMMISSION USE ONLY

ITD on file YES NO

APPROVED DISAPPROVED

2) Reject Codes

Was open hole logs run? yes no

Date last log was run _____

Was CO2 encountered? yes no at what depths? _____

Was H2S encountered? yes no at what depths? _____

Were unusual drilling circumstances encountered? Yes No

If yes, briefly explain: _____

Other remarks: _____

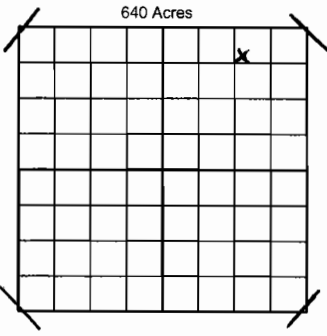

If more than two drainholes are proposed, attach a separate sheet indicating the necessary information.

Direction must be stated in degrees azimuth. Please note, the horizontal drainhole and its end point must be located within the boundaries of the lease or spacing unit.

Directional surveys are required for all drainholes and directional wells.

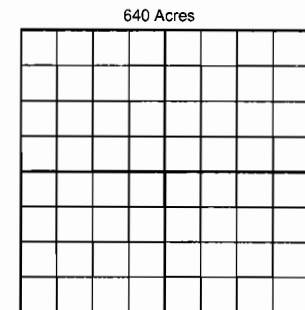

BOTTOM HOLE LOCATION FOR DIRECTIONAL HOLE

| | | | |
|----------------------------------|---------------------|--|--------|
| SEC | TWP | RGE | COUNTY |
| Spot Location 1/4 1/4 1/4 1/4 | | Feet From 1/4 Section Lines FSL FWL | |
| Measured Total Depth | True Vertical Depth | BHL From Lease, Unit or Property Line: | |

BOTTOM HOLE LOCATION FOR HORIZONTAL HOLE: (LATERALS)

LATERAL #1

| | | | |
|--|-----------------------------|---|----------------------|
| SEC | TWP | RGE | COUNTY |
| 16 | 17N | 24W | ELLIS |
| Spot Location SW 1/4 NW 1/4 NE 1/4 NE 1/4 | | Feet From 1/4 Section Lines 2252 FSL 1429 FWL | |
| Depth of Deviation 9171 | Radius of Turn 620 | Direction 358 | Total Length 4032 |
| Measured Total Depth 14084 | True Vertical Depth 9582 | End Pt Location From Lease, Unit or Property Line: 388 | |

LATERAL #2

| | | | |
|----------------------------------|---------------------|--|--------------|
| SEC | TWP | RGE | COUNTY |
| Spot Location 1/4 1/4 1/4 1/4 | | Feet From 1/4 Section Lines FSL FWL | |
| Depth of Deviation | Radius of Turn | Direction | Total Length |
| Measured Total Depth | True Vertical Depth | End Pt Location From Lease, Unit or Property Line: | |

LATERAL #3

| | | | |
|----------------------------------|---------------------|--|--------------|
| SEC | TWP | RGE | COUNTY |
| Spot Location 1/4 1/4 1/4 1/4 | | Feet From 1/4 Section Lines FSL FWL | |
| Depth of Deviation | Radius of Turn | Direction | Total Length |
| Measured Total Depth | True Vertical Depth | End Pt Location From Lease, Unit or Property Line: | |