

Oklahoma Corporation Commission
Oil & Gas Conservation Division
Post Office Box 52000
Oklahoma City, Oklahoma 73152-2000
Rule 165: 10-3-25

Form 1002A

API No.: 35045233550000

Completion Report

Spud Date: May 29, 2013

OTC Prod. Unit No.: 045-211248

Drilling Finished Date: June 26, 2013

1st Prod Date: August 26, 2013

Completion Date: September 17, 2013

Drill Type: HORIZONTAL HOLE

Well Name: GROSS 16-1H

Purchaser/Measurer: DCP MIDSTREAM LP

Location: ELLIS 16 17N 24W
SE SW SE SW
250 FSL 1800 FWL of 1/4 SEC
Derrick Elevation: 0 Ground Elevation: 2280

First Sales Date: 08/26/2013

Operator: EOG RESOURCES INC 16231

3817 NW EXPRESSWAY STE 500
OKLAHOMA CITY, OK 73112-1483

Completion Type	
X	Single Zone
	Multiple Zone
	Commingled

Location Exception	
Order No	
612471	

Increased Density	
Order No	
There are no Increased Density records to display.	

Casing and Cement							
Type	Size	Weight	Grade	Feet	PSI	SAX	Top of CMT
SURFACE	9 5/8	36	J-55	1480		520	SURFACE
PRODUCTION	7	26	P-110 / HC	9988		350	7339

Liner								
Type	Size	Weight	Grade	Length	PSI	SAX	Top Depth	Bottom Depth
LINER	4 1/2	13.5	P-110	5133	0	450	9102	14235

Total Depth: 14237

Packer	
Depth	Brand & Type
9102	PACKER

Plug	
Depth	Plug Type
There are no Plug records to display.	

Initial Test Data										
Test Date	Formation	Oil BBL/Day	Oil-Gravity (API)	Gas MCF/Day	Gas-Oil Ratio Cu FT/BBL	Water BBL/Day	Pumpin or Flowing	Initial Shut-In Pressure	Choke Size	Flow Tubing Pressure
Sep 20, 2013	MARMATON	245	43	464	1894	215	FLOWING	3420	OPEN	200

Completion and Test Data by Producing Formation										
Formation Name: MARMATON			Code: 404MRMN			Class: OIL				
Spacing Orders				Perforated Intervals						
Order No	Unit Size			From			To			
594259	640			10094			14114			
Acid Volumes				Fracture Treatments						
There are no Acid Volume records to display.				4.89MM POUNDS PROPPANT + 4.352MM GALLONS HCL / SLICKWATER						

Formation	Top
TOP CLEVELAND	9344
MARMATON MFS	9594
MARMATON	9796

Were open hole logs run? No

Date last log run:

Were unusual drilling circumstances encountered? No

Explanation:

Other Remarks
OCC: FLE ORDER HAS NOT BEEN ISSUED. WE HAVE ACCEPTED OPERATORS DATA AS SUBMITTED. IRREGULAR SECTION.

Lateral Holes
Sec: 16 TWP: 17N RGE: 24W County: ELLIS
NW NE NW NW
2341 FSL 899 FWL of 1/4 SEC
Depth of Deviation: 9202 Radius of Turn: 634 Direction: 350 Total Length: 4185
Measured Total Depth: 14237 True Vertical Depth: 9651 End Pt. Location From Release, Unit or Property Line: 299

FOR COMMISSION USE ONLY
Status: Accepted
1121127

API NO. 045-23355
 OTC PROD. UNIT NO. 045-211248

PLEASE TYPE OR USE BLACK NOTE:

Attach copy of original if recompletion or re

AS SUBMITTED

RECEIVED
 SEP 25 2013
 OKLAHOMA CORPORATION COMMISSION
 Form 1002A Rev. 2009

ORIGINAL
 AMENDED
 Reason Amended

TYPE OF DRILLING OPERATION

STRAIGHT HOLE DIRECTIONAL HOLE HORIZONTAL HOLE
 SERVICE WELL

If directional or horizontal, see reverse for bottom hole location.

COUNTY: ELLIS	SEC 16	TWP 17N	RGE 24W	SPUD DATE 5/29/2013
LEASE NAME: GROSS	WELL NO: 16 #1H	DATE OF WELL COMPLETION 9/17/2013	DRLG FINISHED DATE 6/26/2013	1ST PROD DATE 8/26/2013
SHL: SE 1/4 SW 1/4 SE 1/4 SW 1/4	FSL 250	FWL OF 1/4 SEC 1800	RECOMP DATE	
ELEVATION: Ground 2280	Latitude if known	Longitude (if known)		
OPERATOR NAME EOG RESOURCES, INC.	OTC/OCC OPER NO 16231-0			
ADDRESS 3817 NW EXPRESSWAY, SUITE 500				
CITY OKLAHOMA CITY	STATE OK	ZIP 73112		

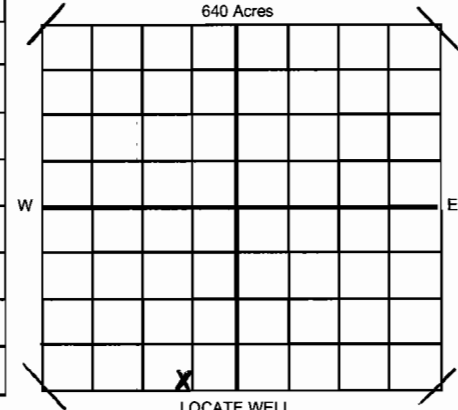

COMPLETION TYPE

SINGLE ZONE

MULTIPLE ZONE Application Date

COMMINGLED Application Date

LOCATION EXCEPTION ORDER NO. **612471 1.0**

INCREASED DENSITY ORDER NO.

CASING & CEMENT (Form 1002C must be attached)

TYPE	SIZE	WEIGHT	GRADE	FEET	PSI	SAX	TOP
Conductor							
Surface	9 5/8	36#	J-55	1480		520	SURFACE
Intermediate							
Production	7"	26#	P110/HC	9988		350	7339
Liner	4 1/2	13.5#	P-110	9102--	14235	450	9102
PACKER @ 9102 BRAND & TYPE _____ PLUG@ _____ TYPE _____ PLUG@ _____ TYPE _____ TOTAL DEPTH							14237
PACKER @ _____ BRAND & TYPE _____ PLUG@ _____ TYPE _____ PLUG@ _____ TYPE _____							

COMPLETION & TEST DATA BY PRODUCING FORMATION **404 MRMIN**

FORMATION	SPACING & SPACING ORDER NUMBER	CLASS: Oil, Gas, Dry, Inj. disp. Comm Disp. svc	PERFORATED INTERVALS	ACID/VOLUME	FRACTURE TREATMENT (Fluids/Prop Amounts)
MARMATON	640/594259	OIL	10094-14114'	NO	4.89MM # PROP + 4.352MM GALS HCL/SLKWIR
<i>Reported to Frac Focus</i>					

INITIAL TEST DATA

Minimum gas allowable (165:10-17-7) OR Oil Allowable (165:10-13-3)

Gas Purchaser/Measurer **DCP MIDSTREAM LP** 1st Sales Date **8/26/2013**

INITIAL TEST DATE	9/20/2013
OIL-BBL/DAY	245
OIL-GRAVITY (API)	43
GAS-MCF/DAY	464
GAS-OIL RATIO CU FT/BBL	1894
WATER-BBL/DAY	215
PUMPING OR FLOWING	FLOWING
INITIAL SHUT-IN PRESSURE	3420
CHOKE SIZE	OPEN
FLOW TUBING PRESSURE	200

A record of the formations drilled through, and pertinent remarks are presented on the reverse. I declare that I have knowledge of the contents of this report and am authorized by my organization to make this report, which was prepared by me or under my supervision and direction, with the data and facts stated herein to be true, correct, and complete to the best of my knowledge and belief.

Dawn Rockel
 SIGNATURE **DAWN ROCKEL** NAME (PRINT OR TYPE) **9/25/2013** DATE **405/246-3226** PHONE NUMBER

3817 NW EXPRESSWAY, SUITE 500 ADDRESS **OKLAHOMA CITY** CITY **OK 73112** STATE ZIP

PLEASE TYPE OR USE BLACK INK ONLY
FORMATION RECORD

LEASE NAME GROSS WELL NO. 16 #1H

Give formation names and tops, if available, or descriptions and thickness of formations drilled through. Show intervals cored or drillstem tested.

NAME OF FORMATIONS	TOP
TOP OF CLEVELAND	9344
MARMATON MFS	9594
MARMATON	9796

FOR COMMISSION USE ONLY

ITD on file YES NO

APPROVED _____ DISAPPROVED _____

2) Reject Codes

Was open hole logs run? yes no

Date last log was run _____

Was CO2 encountered? yes no at what depths? _____

Was H2S encountered? yes no at what depths? _____

Were unusual drilling circumstances encountered? Yes No

If yes, briefly explain: _____

Other remarks: _____

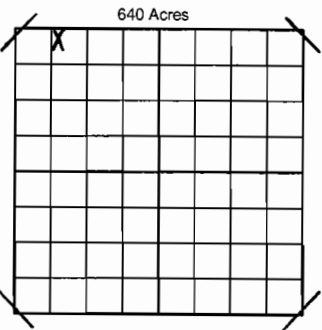

BOTTOM HOLE LOCATION FOR DIRECTIONAL HOLE

SEC	TWP	RGE	COUNTY
Spot Location 1/4 1/4 1/4 1/4	Feet From 1/4 Section Lines FSL FWL		
Measured Total Depth	True Vertical Depth	BHL From Lease, Unit or Property Line:	

BOTTOM HOLE LOCATION FOR HORIZONTAL HOLE: (LATERALS)

LATERAL #1

SEC	TWP	RGE	COUNTY
16	17N	24W	ELLIS
Spot Location NW 1/4 NE 1/4 NW 1/4 NW 1/4	Feet From 1/4 Section Lines 2341 FSL 899 FWL		
Depth of Deviation 9202	Radius of Turn 634	Direction 350	Total Length 4185
Measured Total Depth 14237	True Vertical Depth 9651	End Pt Location From Lease, Unit or Property Line: 299	

If more than two drainholes are proposed, attach a separate sheet indicating the necessary information.

Direction must be stated in degrees azimuth. Please note, the horizontal drainhole and its end point must be located within the boundaries of the lease or spacing unit.

Directional surveys are required for all drainholes and directional wells.

LATERAL #2

SEC	TWP	RGE	COUNTY
Spot Location 1/4 1/4 1/4 1/4	Feet From 1/4 Section Lines FSL FWL		
Depth of Deviation	Radius of Turn	Direction	Total Length
Measured Total Depth	True Vertical Depth	End Pt Location From Lease, Unit or Property Line:	

LATERAL #3

SEC	TWP	RGE	COUNTY
Spot Location 1/4 1/4 1/4 1/4	Feet From 1/4 Section Lines FSL FWL		
Depth of Deviation	Radius of Turn	Direction	Total Length
Measured Total Depth	True Vertical Depth	End Pt Location From Lease, Unit or Property Line:	

