

Oklahoma Corporation Commission
Oil & Gas Conservation Division
Post Office Box 52000
Oklahoma City, Oklahoma 73152-2000
Rule 165: 10-3-25

Form 1002A

API No.: 35151237810001

Completion Report

Spud Date: December 14, 2012

OTC Prod. Unit No.: 151-209840

Drilling Finished Date: January 01, 2013

1st Prod Date: February 12, 2013

Completion Date: February 10, 2013

Drill Type: HORIZONTAL HOLE

Min Gas Allowable: Yes

Well Name: MOREHART 2H-8

Purchaser/Measurer: SEMGAS

Location: WOODS 8 26N 13W
NW NE NE NW
250 FNL 2080 FWL of 1/4 SEC
Derrick Elevation: 0 Ground Elevation: 1445

First Sales Date: 02/12/2013

Operator: MIDSTATES PETROLEUM COMPANY LLC 23079

4400 POST OAK PKWY STE 1900
HOUSTON, TX 77027-3444

Completion Type	
X	Single Zone
	Multiple Zone
	Commingled

Location Exception	
Order No	
	603652
	610746

Increased Density	
Order No	
	602943

Casing and Cement							
Type	Size	Weight	Grade	Feet	PSI	SAX	Top of CMT
SURFACE	13.375	54.5	J-55	626		480	626
INTERMEDIATE	9 5/8	36	J-55	1005		365	1052
PRODUCTION	7	26	N-80	6247		225	4568

Liner								
Type	Size	Weight	Grade	Length	PSI	SAX	Top Depth	Bottom Depth
LINER	4 1/2	11.6	N-80	4869	0	435	5935	10804

Total Depth: 10804

Packer	
Depth	Brand & Type
There are no Packer records to display.	

Plug	
Depth	Plug Type
There are no Plug records to display.	

Initial Test Data										
Test Date	Formation	Oil BBL/Day	Oil-Gravity (API)	Gas MCF/Day	Gas-Oil Ratio Cu FT/BBL	Water BBL/Day	Pumpin or Flowing	Initial Shut-In Pressure	Choke Size	Flow Tubing Pressure
Mar 11, 2013	MISSISSIPPIAN	72		1063	14764	1976	FLOWING		50	

Completion and Test Data by Producing Formation			
Formation Name: MISSISSIPPIAN	Code: 359MSSP	Class: OIL	
Spacing Orders		Perforated Intervals	
Order No	Unit Size	From	To
581897	640	6234	10764
Acid Volumes		Fracture Treatments	
6,810 BARRELS 15% HCL		35,146 BARRELS SLICK WATER, 514,250 POUNDS 30/50 OTTAWA SAND	

Formation	Top
HEEBNER SHALE	4369
HASKELL LIME	4687
TONKAWA	4771
AVANT LIME	5043
COTTAGE GROVE	0
OSWEGO	5357
CHEROKEE	5494
RED FORK	0
MISSISSIPPI CHAT	5680
MISSISSIPPI	5718

Were open hole logs run? No

Date last log run:

Were unusual drilling circumstances encountered? No

Explanation:

Other Remarks
IRREGULAR SECTION.

Lateral Holes

Sec: 8 TWP: 26N RGE: 13W County: WOODS

NW SE SE SW

334 FSL 2025 FWL of 1/4 SEC

Depth of Deviation: 4907 Radius of Turn: 1232 Direction: 181 Total Length: 4620

Measured Total Depth: 10804 True Vertical Depth: 5768 End Pt. Location From Release, Unit or Property Line: 334

FOR COMMISSION USE ONLY

1119573

Status: Accepted

Per Rebecca Bourland

API NO. 151 23781
OTC PROD. UNIT NO. 151-209840

PLEASE TYPE OR USE NOTE

Attach copy of original if recompletion of

AS SUBMITTED

RECEIVED

JUN 03 2013

Form 1002A Rev. 2009

OKLAHOMA CORPORATION COMMISSION

ORIGINAL
 AMENDED (Reason)

TYPE OF DRILLING OPERATION
 STRAIGHT HOLE DIRECTIONAL HOLE HORIZONTAL HOLE
 SERVICE WELL

If directional or horizontal, see reverse for bottom hole location.

COUNTY **Woods** SEC **08** TWP **26N** RGE **13W**

LEASE NAME **Morehart** WELL NO. **2H-8** SPUD DATE **12/14/12**
 DATE OF WELL COMPLETION **2/10/13**

1st PROD DATE **2/12/13**

RECOMP DATE

ELEVATION N Derrick **Ground 1445** Latitude (if known) **36°45'11.5"N** Longitude (if known) **98°37'23.5"W**

OPERATOR NAME **Midstates Petroleum Company LLC** OTC/OCC OPERATOR NO. **23079**

ADDRESS **321 South Boston, Suite 101**

CITY **Tulsa** STATE **OK** ZIP **74103**

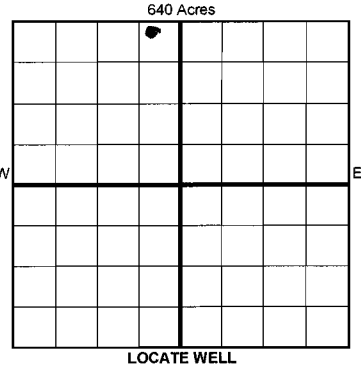

COMPLETION TYPE

SINGLE ZONE
 MULTIPLE ZONE
 COMMINGLED

LOCATION EXCEPTION ORDER **603652**
 INCREASED DENSITY ORDER NO. **602943**

CASING & CEMENT (Form 1002C must be attached)

TYPE	SIZE	WEIGHT	GRADE	FEET	PSI	SAX	TOP OF CMT	
CONDUCTOR	13.375	54.5#	J-55	626		480	626	
SURFACE	9-5/8	36#	J-55	1005		365	1052	
INTERMEDIATE	7	26#	N-80	6247		225	4568	
PRODUCTION								
LINER	4-1/2	11.6#	N-80	5935 - 10854		435	4000	
							TOTAL DEPTH	10,854

PACKER @ _____ BRAND & TYPE _____ PLUG @ _____ TYPE _____ PLUG @ _____ TYPE _____
 PACKER @ _____ BRAND & TYPE _____ PLUG @ _____ TYPE _____ PLUG @ _____ TYPE _____

COMPLETION & TEST DATA BY PRODUCING FORMATION **359MSSIP**

FORMATION	SPACING & SPACING ORDER NUMBER	CLASS: Oil, Gas, Dry, Inj, Disp, Comm Disp, Svc	PERFORATED INTERVALS	ACID/VOLUME	FRACTURE TREATMENT (Fluids/Prop Amounts)
Mississippian	640/581897	Oil	10,764-5725'	15% HCl/6810 bbls	slk wtr/35,146 bbls 30/50 Ottawa sd/514,250 lbs

Min Gas Allowable (165:10-17-7) OR Oil Allowable (165:10-13-3)

Gas Purchaser/Measurer **SemGas** First Sales Date **2/12/13**

INITIAL TEST DATA

INITIAL TEST DATE	3/11/13
OIL-BBL/DAY	72
OIL-GRAVITY (API)	
GAS-MCF/DAY	1063
GAS-OIL RATIO CU FT/BBL	1476 14763
WATER-BBL/DAY	1976
PUMPING OR FLOWING	flowing
INITIAL SHUT-IN PRESSURE	
CHOKE SIZE	50
FLOW TUBING PRESSURE	0

A record of the formations drilled through, and pertinent remarks are presented on the reverse. I declare that I have knowledge of the contents of this report and am authorized by my organization to make this report, which was prepared by me or under my supervision and direction, with the data and facts stated herein to be true, correct, and complete to the best of my knowledge and belief.

Rebecca Bourland for → Ladd Sullins
 SIGNATURE NAME (PRINT OR TYPE) DATE 05/13/13 PHONE NUMBER 918-947-8553

321 South Boston, Suite 101 Tulsa, OK 74103
 ADDRESS CITY STATE ZIP EMAIL ADDRESS l.sullins@midstatespetroleum.com

Per Rebecca Bourland

Monitor Report to FracFocus

PLEASE TYPE OR USE BLACK INK ONLY
FORMATION RECORD

Give formation names and tops, if available, or descriptions and thickness of formations drilled through. Show intervals cored or drillstem tested.

LEASE NAME Morehart

WELL NO. 2H-8

NAMES OF FORMATIONS	TOP
Heeb Shale	4369
Hask LM	4687
Tonkawa	4771
Avant Lm	5043
Cottage Grove	
Oswego	5357
Cherokee	5494
Red Fork	
Miss Chat	5680
Mississippi	5718

FOR COMMISSION USE ONLY

ITD on file YES NO

APPROVED _____ DISAPPROVED _____

2) Reject Codes _____

Were open hole logs run? yes no

Date Last log was run n/a

Was CO₂ encountered? yes no at what depths? _____

Was H₂S encountered? yes no at what depths? _____

Were unusual drilling circumstances encountered? yes no
If yes, briefly explain below

Other remarks: _____

640 Acres

If more than three drainholes are proposed, attach a separate sheet indicating the necessary information.

Direction must be stated in degrees azimuth. Please note, the horizontal drainhole and its end point must be located within the boundaries of the lease or spacing unit.

Directional surveys are required for all drainholes and directional wells.

640 Acres

BOTTOM HOLE LOCATION FOR DIRECTIONAL HOLE

SEC	TWP	RGE	COUNTY	Spot Location		Feet From 1/4 Sec Lines	FSL	FWL
				1/4	1/4	1/4	1/4	
Measured Total Depth		True Vertical Depth		BHL From Lease, Unit, or Property Line:				

BOTTOM HOLE LOCATION FOR HORIZONTAL HOLE: (LATERALS)

LATERAL #1

SEC	TWP	RGE	COUNTY	Spot Location		Feet From 1/4 Sec Lines	FSL	FWL
08	26N	13W	Woods	C	S/2	SE	SW	
				1/4	1/4	1/4	1/4	
Depth of Deviation		Radius of Turn		Direction		Total Length		
4907		1232		181°		4620'		
Measured Total Depth		True Vertical Depth		BHL From Lease, Unit, or Property Line:				
10,854		5768		330				

LATERAL #2

SEC	TWP	RGE	COUNTY	Spot Location		Feet From 1/4 Sec Lines	FSL	FWL
				1/4	1/4	1/4	1/4	
Depth of Deviation		Radius of Turn		Direction		Total Length		
Measured Total Depth		True Vertical Depth		BHL From Lease, Unit, or Property Line:				

LATERAL #3

SEC	TWP	RGE	COUNTY	Spot Location		Feet From 1/4 Sec Lines	FSL	FWL
				1/4	1/4	1/4	1/4	
Depth of Deviation		Radius of Turn		Direction		Total Length		
Measured Total Depth		True Vertical Depth		BHL From Lease, Unit, or Property Line:				