

Oklahoma Corporation Commission  
Oil & Gas Conservation Division  
Post Office Box 52000  
Oklahoma City, Oklahoma 73152-2000  
Rule 165: 10-3-25

Form 1002A

API No.: 35121246560001

**Completion Report**

Spud Date: April 27, 2012

OTC Prod. Unit No.: 121-209771

Drilling Finished Date: September 16, 2012

1st Prod Date: March 14, 2013

Completion Date: March 11, 2013

**Drill Type: HORIZONTAL HOLE**

Min Gas Allowable: Yes

Well Name: PATTERSON 3-20H17

Purchaser/Measurer:

Location: PITTSBURG 20 5N 12E  
NE NW NE NW  
265 FNL 1888 FWL of 1/4 SEC  
Derrick Elevation: 0 Ground Elevation: 786

First Sales Date:

Operator: XTO ENERGY INC 21003

210 PARK AVE STE 2350  
OKLAHOMA CITY, OK 73102-5683

Completion Type	
	Single Zone
	Multiple Zone
X	Commingled

Location Exception	
Order No	
	593486
	611265

Increased Density	
Order No	
	593322

Casing and Cement							
Type	Size	Weight	Grade	Feet	PSI	SAX	Top of CMT
CONDUCTOR	20	85	J-55	67		45	SURFACE
SURFACE	13 3/8	54.50	J-55	555		465	SURFACE
INTERMEDIATE	9 5/8	40	K-55	3804		400	2370
PRODUCTION	5 1/2	17 & 20	P-110	13263		1970	3870

Liner								
Type	Size	Weight	Grade	Length	PSI	SAX	Top Depth	Bottom Depth
There are no Liner records to display.								

**Total Depth: 13265**

Packer	
Depth	Brand & Type
There are no Packer records to display.	

Plug	
Depth	Plug Type
There are no Plug records to display.	

Initial Test Data										
Test Date	Formation	Oil BBL/Day	Oil-Gravity (API)	Gas MCF/Day	Gas-Oil Ratio Cu FT/BBL	Water BBL/Day	Pumpin or Flowing	Initial Shut-In Pressure	Choke Size	Flow Tubing Pressure
Mar 03, 2013	WOODFORD-MAYES			1856		407	FLOWING	1350	36/64	660

**Completion and Test Data by Producing Formation**

Formation Name: WOODFORD                      Code: 319WDFD                      Class: GAS

Spacing Orders	
Order No	Unit Size
529920	640

Perforated Intervals	
From	To
8220	13132

Acid Volumes
12,200 GALLONS

Fracture Treatments
12 STAGES - 153,247 BTW, 417,684 POUNDS 100 MESH, 2,855,632 POUNDS 20/70

Formation Name: MAYES                      Code: 353MYES                      Class: GAS

Spacing Orders	
Order No	Unit Size
529920	640

Perforated Intervals	
From	To
9010	9550

Acid Volumes
1,800 GALLONS

Fracture Treatments
2 STAGES - 23,243 BTW, 61,796 POUNDS 100 MESH, 420,708 POUNDS 40/70

Formation Name: WOODFORD-MAYES                      Code:                      Class: GAS

Formation	Top
CANEY	7326
MAYES	7759
WOODFORD	8066

Were open hole logs run? No  
Date last log run:  
Were unusual drilling circumstances encountered? No  
Explanation:

**Other Remarks**  
IRREGULAR SECTION

**Lateral Holes**

Sec: 17 TWP: 5N RGE: 12E County: PITTSBURG

NE NE NW NW

37 FNL 1147 FWL of 1/4 SEC

Depth of Deviation: 7130 Radius of Turn: 787 Direction: 352 Total Length: 5557

Measured Total Depth: 13265 True Vertical Depth: 7627 End Pt. Location From Release, Unit or Property Line: 37

**FOR COMMISSION USE ONLY**

1119158

Status: Accepted

API NO. 121-24656  
 OTC PROD. UNIT NO. 121-209771

PLEASE TYPE OR USE BLACK INK ONLY  
 NOTE: Attach copy of original 1002A if recompletion or reentry.

OKLAHOMA CORPORATION COMMISSION  
 Oil & Gas Conservation Division  
 Post Office Box 52000  
 Oklahoma City, Oklahoma 73152-2000  
 Rule 165:10-3-25

RECEIVED  
 Form 1002A  
 Rev. 2007

MAY 14 2013

OKLAHOMA CORPORATION COMMISSION

ORIGINAL  
 AMENDED  
 Reason Amended \_\_\_\_\_  
 TYPE OF DRILLING OPERATION  
 STRAIGHT HOLE  DIRECTIONAL HOLE  HORIZONTAL HOLE  
 SERVICE WELL  
 If directional or horizontal, see reverse for bottom hole location.

COMPLETION REPORT

COUNTY	SEC	TWP	RGE	WELL COMPLETION
Pittsburg	20	5N	12E	3/11/2013
LEASE NAME	WELL NO.		1ST PROD DATE	
PATTERSON	3-20H17		3/14/2013	
SHL	FNL	FWL OF 1/4 SE		RECOMP DATE
NE 1/4 NW 1/4 NE 1/4 NW 1/4	265'	1888'		
ELEVATION	Latitude if Known		Longitude if Known	
Derrick Ft GL: 786' Ground	34°53'50.8"N		96°03'53.6"W	
OPERATOR NAME			OTC/OCC OPERATOR NO.	
XTO ENERGY INC.			21003	
ADDRESS				
210 PARK AVENUE, SUITE 2350				
CITY			STATE	ZIP
OKLAHOMA CITY			OKLAHOMA	73102

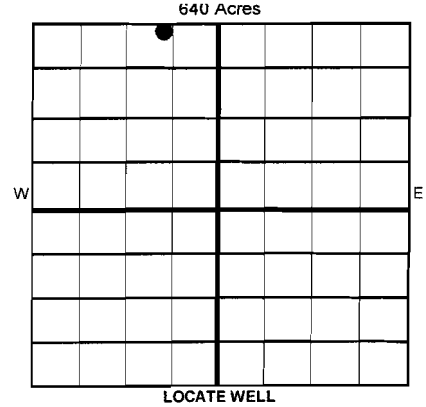

COMPLETION TYPE

<input type="checkbox"/>	SINGLE ZONE
<input type="checkbox"/>	MULTIPLE ZONE
<input type="checkbox"/>	Application Date _____
<input checked="" type="checkbox"/>	COMMINGLED
<input type="checkbox"/>	Application Date 4/30/2013
LOCATION EXCEPTION ORDER NO.	
593486	
INCREASED DENSITY ORDER NO.	
593322	

CASING & CEMENT (Form 1002C must be attached)

TYPE	SIZE	WEIGHT	GRADE	FEET	PSI	SAX	TOP OF CMI
Conductor							
	20	85	J-55	67		45	Surface
Surface	13 3/8"	54.50	J-55	555		465	Surface
Intermediate	9 5/8"	40	K-55	3804		400	2370'
Production	5 1/2"	17#,20#	P-110	13,263		1970	3870'
Liner							
							<b>13,265'</b>

PACKER @ \_\_\_\_\_ BRAND & TYPE \_\_\_\_\_ PLUG @ \_\_\_\_\_ TYPE \_\_\_\_\_ PLUG @ \_\_\_\_\_ TYPE \_\_\_\_\_ TOTAL DEPTH  
 PACKER @ \_\_\_\_\_ BRAND & TYPE \_\_\_\_\_ PLUG @ \_\_\_\_\_ TYPE \_\_\_\_\_ PLUG @ \_\_\_\_\_ TYPE \_\_\_\_\_

COMPLETION & TEST DATA BY PRODUCING FORMATION

FORMATION	WOODFORD	MAYES
SPACING & SPACING ORDER NUMBER	640:529920	640:529920
CLASS: Oil, Gas, Dry, Inj, Disp, Comm Disp, Svc	Gas	Gas
PERFORATED INTERVALS	12 Stages 8220-8872, 9610-13,132'	2 Stages 9010-9550
ACID/VOLUME Fracture Treatment (Fluids/Prop Amounts)	12200 gals 153,247 BTW 417,684# 100 Mesh 2,855,632# 40/70	1800 gals 23,243 BTW 61,796# 100 Mesh 420,708# 40/70

*317 WOODFORD / 353 MAYES* *Report to Frac Focus*

**AS SUBMITTED**

INITIAL TEST DATA  Request minimum gas allowable (165:10-17-7) Gas Purchaser/Measurer \_\_\_\_\_ 1st Sales Date \_\_\_\_\_

INITIAL TEST DATE	3/3/2013
OIL-BBL/DAY	N/A
OIL-GRAVITY ( API)	N/A
GAS-MCF/DAY	1856
GAS-OIL RATIO CU FT/BBL	N/A
WATER-BBL/DAY	407
PUMPING OR FLOWING	Flowing
INITIAL SHUT-IN PRESSURE	1350
CHOKE SIZE	36/64"
FLOW TUBING PRESSURE	660

SCANNED

A record of the formations drilled through, and pertinent remarks are presented on the reverse. I declare that I have knowledge of the contents of this report and am authorized by my organization to make this report, which was prepared by me or under my supervision and direction, with the data and facts stated herein to be true, correct, and complete to the best of my knowledge and belief.

*Debbie Waggoner* Debbie Waggoner, Regulatory Analyst 5/13/2013 405-232-4011  
 SIGNATURE NAME (PRINT OR TYPE) DATE PHONE NUMBER  
 210 Park Avenue, Suite 2350 Oklahoma City Oklahoma 73102 debbie\_waggoner@xtoenergy.com  
 ADDRESS CITY STATE ZIP EMAIL ADDRESS

PLEASE TYPE OR USE BLACK INK ONLY  
FORMATION RECORD

Give formation names and tops, if available, or descriptions and thickness of formations drilled through. Show intervals cored or drillstem tested.

LEASE NAME PATTERSON

WELL NO. 3-20H17

NAMES OF FORMATIONS	TOP
CANEY	7326
MAYES	7759
WOODFORD	8066

FOR COMMISSION USE ONLY	
ITD on file	<input type="checkbox"/> YES <input type="checkbox"/> NO
APPROVED	DISAPPROVED
2) Reject Codes	
_____	
_____	
_____	
_____	

Were open hole logs run?	yes	<input checked="" type="checkbox"/>	no	<input type="checkbox"/>
Date Last log was run	_____			
Was CO <sub>2</sub> encountered?	yes	<input checked="" type="checkbox"/>	no	at what depths?
Was H <sub>2</sub> S encountered?	yes	<input checked="" type="checkbox"/>	no	at what depths?
Were unusual drilling circumstances encountered?	yes	<input checked="" type="checkbox"/>	no	<input type="checkbox"/>
If yes, briefly explain. _____				

Other remarks: **IRREGULAR SECTION**

\_\_\_\_\_

\_\_\_\_\_

\_\_\_\_\_

\_\_\_\_\_

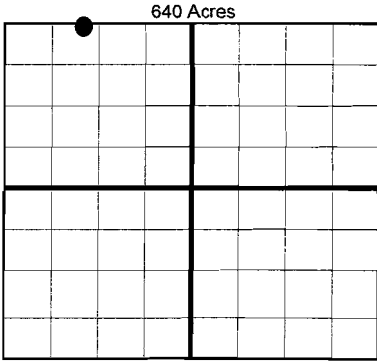

**BOTTOM HOLE LOCATION FOR DIRECTIONAL HOLE**

SEC	TWP	RGE	COUNTY
Spot Location	1/4 1/4		Feet From 1/4 Sec Lines
Measured Total Depth	True Vertical Depth	BHL From Lease, Unit, or Property Line:	
		FSL	FWL

**BOTTOM HOLE LOCATION FOR HORIZONTAL HOLE: (LATERALS)**

**LATERAL #1**

SEC	TWP	RGE	COUNTY
17	5N	12E	PITTSBURG
Spot Location	NE 1/4 NE 1/4 NW 1/4 NW 1/4		Feet From 1/4 Sec Lines
Depth of Deviation	7130'	Radius of Turn	787.5'
Measured Total Depth	True Vertical Depth	End Pt Location From Lease, Unit or Property Line:	
	13,265'	37' FNL & 1147' FWL	

If more than three drainholes are proposed, attach a separate sheet indicating the necessary information.

Direction must be stated in degrees azimuth. Please note, the horizontal drainhole and its end point must be located within the boundaries of the lease or spacing unit.

**Directional surveys are required for all drainholes and directional wells.**

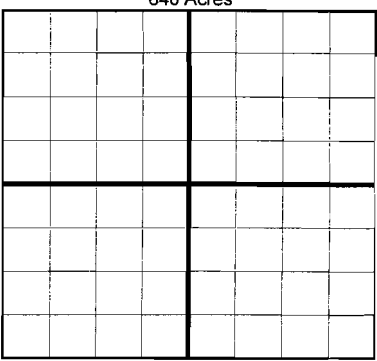

**LATERAL #2**

SEC	TWP	RGE	COUNTY
Spot Location	1/4 1/4		Feet From 1/4 Sec Lines
Depth of Deviation	Radius of Turn	Direction	Total Length
Measured Total Depth	True Vertical Depth	End Pt Location From Lease, Unit or Property Line:	

**LATERAL #3**

SEC	TWP	RGE	COUNTY
Spot Location	1/4 1/4		Feet From 1/4 Sec Lines
Depth of Deviation	Radius of Turn	Direction	Total Length
Measured Total Depth	True Vertical Depth	End Pt Location From Lease, Unit or Property Line:	

API NO. 121-24656  
 OTC PROD. UNIT NO. 121-209771

PLEASE TYPE OR USE BLACK INK ONLY  
 NOTE: Attach copy of original 1002A if recompletion or reentry.

6/1/13  
 OKLAHOMA CORPORATION COMMISSION  
 Oil & Gas Conservation Division

RECEIVED  
 Form 1002A Rev. 2007

MAY 14 2013 1016EZ

Post Office Box 52000  
 Oklahoma City, Oklahoma 73152-2000  
 Rule 165:10-3-25

OKLAHOMA CORPORATION COMMISSION

A: 209771 I

ORIGINAL  
 AMENDED  
 Reason Amended

COMPLETION REPORT

TYPE OF DRILLING OPERATION  
 STRAIGHT HOLE  DIRECTIONAL HOLE  HORIZONTAL HOLE  
 SERVICE WELL

if directional or horizontal, see reverse for bottom hole location

COUNTY Pittsburg SEC 20 TWP 5N R3E  
 LEASE NAME PATTERSON WELL NO. 3-20H17  
 SHL NE 1/4 NW 1/4 NE 1/4 NW 1/4 FNL 265' FWL OF 1/4 SE 1888'  
 ELEVATION Derrick Fl GL: 786' Ground Latitude if Known 34°53'50.8"N Longitude if Known 96°03'53.6"W  
 OPERATOR NAME XTO ENERGY INC. OTC/OCC OPERATOR NO. 21UU3  
 ADDRESS 210 PARK AVENUE, SUITE 2350  
 CITY OKLAHOMA CITY STATE OKLAHOMA ZIP 73102

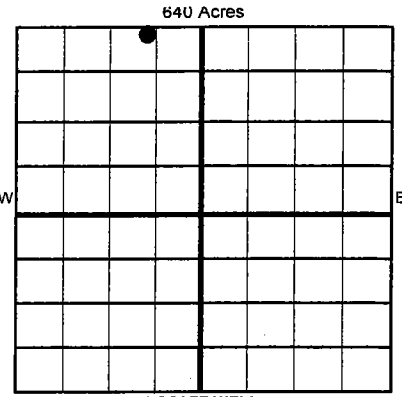

COMPLETION TYPE

SINGLE ZONE  
 MULTIPLE ZONE  
 Application Date  
 COMMINGLED  
 Application Date 4/30/2013  
 LOCATION EXCEPTION ORDER NO. 593486  
 INCREASED DENSITY ORDER NO. 593322

CASING & CEMENT (Form 1002C must be attached)

TYPE	SIZE	WEIGHT	GRADE	FEET	PSI	SAX	TOP OF CMI	
Conductor	20	85	J-55	67		45	Surface	
Surface	13 3/8"	54.50	J-55	555		465	Surface	
Intermediate	9 5/8"	40	K-55	3804		400	2370'	
Production	5 1/2"	17#.20#	P-110	13,263		1970	3870'	
Liner								
							<b>TOTAL DEPTH</b>	<b>13,265'</b>

PACKER @ \_\_\_\_\_ BRAND & TYPE \_\_\_\_\_ PLUG @ \_\_\_\_\_ TYPE \_\_\_\_\_ PLUG @ \_\_\_\_\_ TYPE \_\_\_\_\_  
 PACKER @ \_\_\_\_\_ BRAND & TYPE \_\_\_\_\_ PLUG @ \_\_\_\_\_ TYPE \_\_\_\_\_ PLUG @ \_\_\_\_\_ TYPE \_\_\_\_\_

COMPLETION & TEST DATA BY PRODUCING FORMATION

FORMATION	WOODFORD	MAYES	
SPACING & SPACING ORDER NUMBER	640:529920	640:529920	
CLASS: Oil, Gas, Dry, Inj, Disp, Comm Disp, Svc	Gas	Gas	
PERFORATED INTERVALS	12 Stages 8220-8872, 9610-13,132'	2 Stages 9010-9550	
ACID/VOLUME Fracture Treatment (Fluids/Prop Amounts)	12200 gals 153,247 BTW 417,684# 100 Mesh 2,855,632# 40/70	1800 gals 23,243 BTW 61,796# 100 Mesh 420,708# 40/70	

**AS SUBMITTED**

Report to Frac Focus

Request minimum gas allowable (165:10-17-7) Gas Purchaser/Measurer \_\_\_\_\_ 1st Sales Date 3/14/13

INITIAL TEST DATA

INITIAL TEST DATE	3/3/2013
OIL-BBL/DAY	N/A
OIL-GRAVITY ( API)	N/A
GAS-MCF/DAY	1856
GAS-OIL RATIO CU FT/BBL	N/A
WATER-BBL/DAY	407
PUMPING OR FLOWING	Flowing
INITIAL SHUT-IN PRESSURE	1350
CHOKE SIZE	36/64"
FLOW TUBING PRESSURE	660

SCANNED

A record of the formations drilled through, and pertinent remarks are presented on the reverse. I declare that I have knowledge of the contents of this report and am authorized by my organization to make this report, which was prepared by me or under my supervision and direction, with the data and facts stated herein to be true, correct, and complete to the best of my knowledge and belief.

Signature: Debbie Waggoner Debbie Waggoner, Regulatory Analyst DATE: 5/13/2013 PHONE NUMBER: 405-232-4011  
 ADDRESS: 210 Park Avenue, Suite 2350 Oklahoma City, Oklahoma 73102 EMAIL ADDRESS: debbie\_waggoner@xtoenergy.com

EZ

*[Handwritten signature]*