

Oklahoma Corporation Commission  
Oil & Gas Conservation Division  
Post Office Box 52000  
Oklahoma City, Oklahoma 73152-2000  
Rule 165: 10-3-25

Form 1002A

API No.: 35015232190000

**Completion Report**

Spud Date: December 26, 2012

OTC Prod. Unit No.: 015209991

Drilling Finished Date: February 14, 2013

1st Prod Date: March 07, 2013

Completion Date: March 19, 2013

**Drill Type: HORIZONTAL HOLE**

Min Gas Allowable: Yes

Well Name: JERRY 28-2H

Purchaser/Measurer: DCP MIDSTREAM LP

Location: CADDO 28 10N 11W  
SW SE SW SW  
250 FSL 760 FWL of 1/4 SEC  
Derrick Elevation: 0 Ground Elevation: 1475

First Sales Date: 03/20/2013

Operator: EOG RESOURCES INC 16231

3817 NW EXPRESSWAY STE 500  
OKLAHOMA CITY, OK 73112-1483

Completion Type	
X	Single Zone
	Multiple Zone
	Commingled

Location Exception	
Order No	
604944	

Increased Density	
Order No	
There are no Increased Density records to display.	

Casing and Cement							
Type	Size	Weight	Grade	Feet	PSI	SAX	Top of CMT
SURFACE	9 5/8	36	J-55	1496		675	SURFACE
PRODUCTION	7	26	P-110	10500		350	7869

Liner								
Type	Size	Weight	Grade	Length	PSI	SAX	Top Depth	Bottom Depth
LINER	4 1/2	13.5	P-110	4764	0	0	9602	14366

**Total Depth: 14366**

Packer	
Depth	Brand & Type
9602	PACKER

Plug	
Depth	Plug Type
There are no Plug records to display.	

Initial Test Data										
Test Date	Formation	Oil BBL/Day	Oil-Gravity (API)	Gas MCF/Day	Gas-Oil Ratio Cu FT/BBL	Water BBL/Day	Pumpin or Flowing	Initial Shut-In Pressure	Choke Size	Flow Tubing Pressure
Mar 24, 2013	HOXBAR	170	44	162	953	522	FLOWING	2863	OPEN	121

Completion and Test Data by Producing Formation										
Formation Name: HOXBAR			Code: 405HXBR			Class: OIL				
<b>Spacing Orders</b>				<b>Perforated Intervals</b>						
<b>Order No</b>	<b>Unit Size</b>			<b>From</b>			<b>To</b>			
604860	480			There are no Perf. Intervals records to display.						
<b>Acid Volumes</b>				<b>Fracture Treatments</b>						
There are no Acid Volume records to display.				2.44MM GALLONS GEL / SLICKWATER + 3.17MM POUNDS PROPPANT						

Formation	Top
TONKAWA	8883
COTTAGE GROVE	9843
HOXBAR	10340

Were open hole logs run? No

Date last log run:

Were unusual drilling circumstances encountered? No

Explanation:

Other Remarks
OCC - THIS WELL IS AN OPEN HOLE COMPLETION FROM THE BOTTOM OF THE 7" CASING SET AT 10,500' TO TERMINUS AT 14,366'. THE 4 1/2" LINER IS OPEN FROM 10,615' TO 14,229' BUT THE LINER IS NOT CEMENTED. FLE ORDER HAS NOT BEEN ISSUED. WE HAVE ACCEPTED OPERATORS DATA AS SUBMITTED. IRREGULAR SECTION.

Lateral Holes
Sec: 28 TWP: 10N RGE: 11W County: CADD0
SW NE NW NW
2012 FSL 795 FWL of 1/4 SEC
Depth of Deviation: 9690 Radius of Turn: 632 Direction: 1 Total Length: 3773
Measured Total Depth: 14366 True Vertical Depth: 10178 End Pt. Location From Release, Unit or Property Line: 628

FOR COMMISSION USE ONLY
Status: Accepted
1119027

API NO. 015-23219  
 OTC PROD. UNIT NO. 015-209991

PLEASE TYPE OR USE BLACK INK ONLY  
 NOTE:

Attach copy of original 1002A if recompletion or reentry.

OKLAHOMA CORPORATION COMMISSION  
 Oil & Gas Conservation Commission  
 Post Office Box 52000  
 Oklahoma City, Oklahoma 73152-2000  
 Rule 165:10-3-25

RECEIVED  
 Form 1002A  
 Rev. 2009

APR 23 2013

OKLAHOMA CORPORATION COMMISSION

ORIGINAL  
 AMENDED  
 Reason Amended  
 TYPE OF DRILLING OPERATION  
 STRAIGHT HOLE  DIRECTIONAL HOLE  HORIZONTAL HOLE  
 SERVICE WELL  
 If directional or horizontal, see reverse for bottom hole location.

COMPLETION REPORT

COUNTY: CADDO	SEC 28	TWP 10N	RGE 11W	SPUD DATE 12/26/2012
LEASE NAME: JERRY	WELL NO: 28 #2H			DRLG FINISHED DATE 2/14/2013
SHL: SW 1/4 SE 1/4 SW 1/4 SW 1/4	FSL 250	FWL OF 1/4 SEC 760	DATE OF WELL COMPLETION 3/19/2013	1ST PROD DATE 3/7/2013
ELEVATION: Derrick FI Ground 1475	Latitude if known		Longitude (if known)	
OPERATOR NAME EOG RESOURCES, INC.			OTC/OCC OPER NO 16231-0	
ADDRESS 3817 NW EXPRESSWAY, SUITE 500				
CITY OKLAHOMA CITY		STATE OK	ZIP 73112	

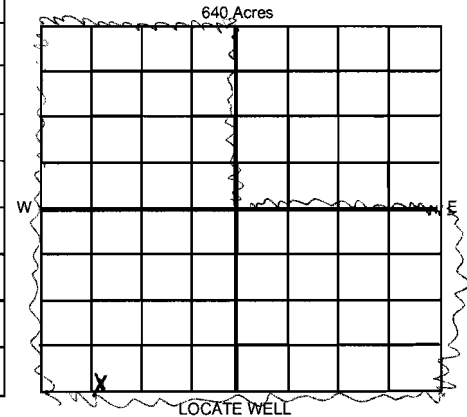

COMPLETION TYPE

SINGLE ZONE

MULTIPLE ZONE  
Application Date

COMMINGLED  
Application Date

LOCATION EXCEPTION ORDER NO. 604944

INCREASED DENSITY ORDER NO.

CASING & CEMENT (Form 1002C must be attached)

TYPE	SIZE	WEIGHT	GRADE	FEET	PSI	SAX	TOP
Conductor							
Surface	9 5/8	36#	J-55	1496		675	SURFACE
Intermediate							
Production	7"	26#	P-110	10500		350	7869
Liner	4 1/2	13.5#	P-110	9602-	14366'	0	- - -

PACKER @ 9602 BRAND & TYPE \_\_\_\_\_ PLUG@ \_\_\_\_\_ TYPE \_\_\_\_\_ PLUG@ \_\_\_\_\_ TYPE \_\_\_\_\_ TOTAL DEPTH 14366

PACKER @ \_\_\_\_\_ BRAND & TYPE \_\_\_\_\_ PLUG@ \_\_\_\_\_ TYPE \_\_\_\_\_ PLUG@ \_\_\_\_\_ TYPE \_\_\_\_\_

COMPLETION & TEST DATA BY PRODUCING FORMATION

FORMATION	HOXBAR				
SPACING & SPACING ORDER NUMBER	480/604860				
CLASS: Oil, Gas, Dry, Inj. disp. Comm Disp. svc	OIL				
PERFORATED INTERVALS	<del>10615-14229</del> open hole				
ACID/VOLUME	NO				
FRACTURE TREATMENT (Fluids/Prop Amounts)	2.4MM GALS GEL/SLICKWTR + 3.17MM # PROP.				

**AS SUBMITTED**

INITIAL TEST DATA  Minimum gas allowable (165:10-17-7) OR Oil Allowable (165:10-13-3) Gas Purchaser/Measurer DCP MIDSTREAM LP 1st Sales Date 3/20/2013

INITIAL TEST DATE	3/24/2013			
OIL-BBL/DAY	170			
OIL-GRAVITY ( API)	44			
GAS-MCF/DAY	162			
GAS-OIL RATIO CU FT/BBL	953			
WATER-BBL/DAY	522			
PUMPING OR FLOWING	FLOWING			
INITIAL SHUT-IN PRESSURE	2863			
CHOKE SIZE	OPEN			
FLOW TUBING PRESSURE	121			

SCANNED

A record of the formations drilled through, and pertinent remarks are presented on the reverse. I declare that I have knowledge of the contents of this report and am authorized by my organization to make this report, which was prepared by me or under my supervision and direction, with the data and facts stated herein to be true, correct, and complete to the best of my knowledge and belief.

SIGNATURE Dawn Rockel NAME (PRINT OR TYPE) DAWN ROCKEL DATE 4/22/2013 PHONE NUMBER 405/246-3226

ADDRESS 3817 NW EXPRESSWAY, SUITE 500 CITY OKLAHOMA CITY STATE OK ZIP 73112 EMAIL ADDRESS

PLEASE TYPE OR USE BLACK INK ONLY  
FORMATION RECORD

LEASE NAME JERRY WELL NO. 28 #2H

Give formation names and tops, if available, or descriptions and thickness of formations drilled through. Show intervals cored or drillstem tested.

NAME OF FORMATIONS	TOP
TONKAWA	8883'
COTTAGE GROVE	9843'
HOXBAR	10340'

FOR COMMISSION USE ONLY

ITD on file  YES  NO

APPROVED \_\_\_\_\_ DISAPPROVED \_\_\_\_\_

2) Reject Codes

\_\_\_\_\_

\_\_\_\_\_

\_\_\_\_\_

\_\_\_\_\_

Was open hole logs run?  yes  no

Date last log was run \_\_\_\_\_

Was CO2 encountered?  yes  no at what depths? \_\_\_\_\_

Was H2S encountered?  yes  no at what depths? \_\_\_\_\_

Were unusual drilling circumstances encountered?  Yes  No

If yes, briefly explain: \_\_\_\_\_

Other remarks: *OCC - This well is an open hole completion from the bottom of the 7" casing set at 10500' to terminus at 14366'. The 4 1/2" line is open from 10615' to 14229' but the line is not cemented*

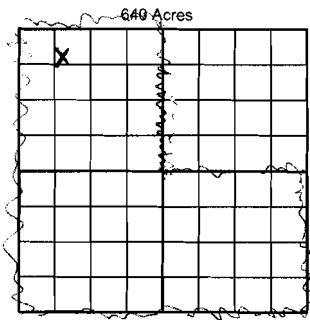

If more than two drainholes are proposed, attach a separate sheet indicating the necessary information.

Direction must be stated in degrees azimuth. Please note, the horizontal drainhole and its end point must be located within the boundaries of the lease or spacing unit.

Directional surveys are required for all drainholes and directional wells.

**BOTTOM HOLE LOCATION FOR DIRECTIONAL HOLE**

SEC	TWP	RGE	COUNTY
Spot Location	Feet From 1/4 Section Lines		
1/4 1/4 1/4 1/4	FSL	FWL	
Measured Total Depth	True Vertical Depth	BHL From Lease, Unit or Property Line:	

**BOTTOM HOLE LOCATION FOR HORIZONTAL HOLE: (LATERALS)**

**LATERAL #1**

SEC	TWP	RGE	COUNTY
28	10N	11W	CADDO
Spot Location	Feet From 1/4 Section Lines		
SW 1/4 NE 1/4 NW 1/4 NW 1/4	2012	FSL	795 FWL
Depth of Deviation	Radius of Turn	Direction	Total Length
9690	632	1.96	3773
Measured Total Depth	True Vertical Depth	End Pt Location From Lease, Unit or Property Line:	
14366	10178	628	

**LATERAL #2**

SEC	TWP	RGE	COUNTY
Spot Location	Feet From 1/4 Section Lines		
1/4 1/4 1/4 1/4	FSL	FWL	
Depth of Deviation	Radius of Turn	Direction	Total Length
Measured Total Depth	True Vertical Depth	End Pt Location From Lease, Unit or Property Line:	

**LATERAL #3**

SEC	TWP	RGE	COUNTY
Spot Location	Feet From 1/4 Section Lines		
1/4 1/4 1/4 1/4	FSL	FWL	
Depth of Deviation	Radius of Turn	Direction	Total Length
Measured Total Depth	True Vertical Depth	End Pt Location From Lease, Unit or Property Line:	

