

Oklahoma Corporation Commission  
Oil & Gas Conservation Division  
Post Office Box 52000  
Oklahoma City, Oklahoma 73152-2000  
Rule 165: 10-3-25

Form 1002A

API No.: 35121246530003

**Completion Report**

Spud Date: April 25, 2012

OTC Prod. Unit No.: 121-209769

Drilling Finished Date: August 09, 2012

1st Prod Date: March 14, 2012

Completion Date: February 27, 2013

**Drill Type: HORIZONTAL HOLE**

Well Name: PATTERSON 1-20H17

Purchaser/Measurer:

Location: PITTSBURG 20 5N 12E  
NE NW NE NW  
265 FNL 1928 FWL of 1/4 SEC  
Derrick Elevation: 0 Ground Elevation: 787

First Sales Date:

Operator: XTO ENERGY INC 21003

210 PARK AVE STE 2350  
OKLAHOMA CITY, OK 73102-5683

Completion Type	
<input type="checkbox"/>	Single Zone
<input type="checkbox"/>	Multiple Zone
<input checked="" type="checkbox"/>	Commingled

Location Exception
Order No
593485

Increased Density
Order No
593322

Casing and Cement							
Type	Size	Weight	Grade	Feet	PSI	SAX	Top of CMT
CONDUCTOR	20	67	J-55	67		45	SURFACE
SURFACE	13 3/8	54.50	J-55	490		450	SURFACE
INTERMEDIATE	9 5/8	40	K-55	3811		400	2370
PRODUCTION	5 1/2	20	P-110	13300		1970	7330

Liner								
Type	Size	Weight	Grade	Length	PSI	SAX	Top Depth	Bottom Depth
There are no Liner records to display.								

**Total Depth: 13300**

Packer	
Depth	Brand & Type
There are no Packer records to display.	

Plug	
Depth	Plug Type
There are no Plug records to display.	

Initial Test Data										
Test Date	Formation	Oil BBL/Day	Oil-Gravity (API)	Gas MCF/Day	Gas-Oil Ratio Cu FT/BBL	Water BBL/Day	Pumpin or Flowing	Initial Shut-In Pressure	Choke Size	Flow Tubing Pressure
Mar 31, 2013	WOODFORD-HUNTON			2428		363	FLOWING	1400	36/64	760

**Completion and Test Data by Producing Formation**

Formation Name: WOODFORD                      Code: 319WDFD                      Class: GAS

Spacing Orders	
Order No	Unit Size
529920	640

Perforated Intervals	
From	To
8237	13188

Acid Volumes
111,400 GALLONS

Fracture Treatments
155,572 BTW, 423,772 POUNDS 100 MESH, 2,906,566 POUNDS 40/70

Formation Name: HUNTON                      Code: 269HNTN                      Class: GAS

Spacing Orders	
Order No	Unit Size
610825	640

Perforated Intervals	
From	To
8967	9578

Acid Volumes
1,600 GALLONS

Fracture Treatments
19,888 BTW, 54,888 POUNDS 100 MESH, 375,754 POUNDS 40/70

Formation Name: WOODFORD-HUNTON                      Code:                      Class: GAS

Formation	Top
WOODFORD	7760
HUNTON	7800

Were open hole logs run? No  
Date last log run:  
Were unusual drilling circumstances encountered? No  
Explanation:

**Other Remarks**  
OCC: FLE ORDER HAS NOT BEEN ISSUED. WE HAVE ACCEPTED OPERATORS DATA AS SUBMITTED. IRREGULAR SECTION.

**Lateral Holes**

Sec: 17 TWP: 5N RGE: 12E County: PONTOTOC

NW NW NW NE

57 FNL 5 FWL of 1/4 SEC

Depth of Deviation: 7154 Radius of Turn: 1009 Direction: 7 Total Length: 5531

Measured Total Depth: 13300 True Vertical Depth: 7668 End Pt. Location From Release, Unit or Property Line: 57

**FOR COMMISSION USE ONLY**

1119011

Status: Accepted

APITNO. 121-24653  
 OTC PROD. UNIT NO. 121-209769

PLEASE TYPE OR  
 NOTE:  
 Attach copy of origi

**AS SUBMITTED**

REGISTRATION COMMISSION  
 Conservation Division  
 Office Box 52000  
 Oklahoma 73152-2000  
 165-10-3-25

**RECEIVED** Form 1002A Rev. 2007

APR 29 2013

OKLAHOMA CORPORATION  
 COMMISSION

ORIGINAL  
 AMENDED  
 Reason Amended

TYPE OF DRILLING OPERATION

STRAIGHT HOLE  DIRECTIONAL HOLE  HORIZONTAL HOLE  
 SERVICE WELL

If directional or horizontal, see reverse for bottom hole location.

COUNTY	SEC	TWP	RGE	SPUD DATE
Pittsburg	20	5N	12E	4/23/2012
LEASE NAME	WELL NO.		DRLG FINISHED	
PATTERSON	1-20H17		8/9/2012	
SHL	FNL	FWL OF 1/4 SEC	WELL COMPLETION	
NE 1/4 NW 1/4 NE 1/4 NW 1/4	265	1928	2/27/2013	
ELEVATION	Latitude if Known		1ST PROD DATE	
Derrick Ft GL: 787' Ground	34°53'50.8"N		3/14/2012	
OPERATOR NAME			RECOMP DATE	
XTO ENERGY INC.				
ADDRESS			OTC/OCC OPERATOR NO.	
210 PARK AVENUE, SUITE 2350			21003	
CITY	STATE	ZIP		
OKLAHOMA CITY	OKLAHOMA	73102		

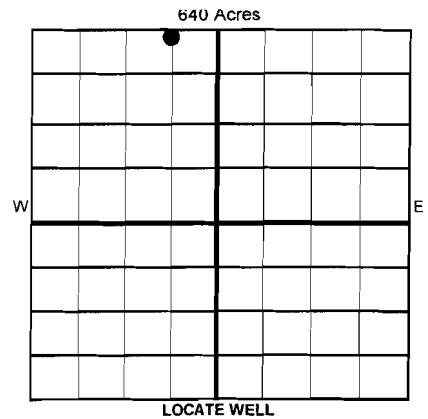

COMPLETION TYPE

<input type="checkbox"/> SINGLE ZONE
<input type="checkbox"/> MULTIPLE ZONE
Application Date
<input checked="" type="checkbox"/> COMMINGLED
Application Date 4/10/2013
LOCATION EXCEPTION ORDER NO.
593485 1.01
INCREASED DENSITY ORDER NO.
593322

CASING & CEMENT (Form 1002C must be attached)

TYPE	SIZE	WEIGHT	GRADE	FEET	PSI	SAX	TOP OF CEMENT	
Conductor	20"	67	J-55	67		45	Surface	
Surface	13 3/8"	54.50	J-55	520		450	Surface	
Intermediate	9 5/8"	40	K-55	3811		400	2370	
Production	5 1/2"	20	P-110	13,300		1970	7330	
Liner								
							<b>TOTAL DEPTH</b>	<b>13,300'</b>

PACKER @ \_\_\_\_\_ BRAND & TYPE \_\_\_\_\_ PLUG @ \_\_\_\_\_ TYPE \_\_\_\_\_ PLUG @ \_\_\_\_\_ TYPE \_\_\_\_\_  
 PACKER @ \_\_\_\_\_ BRAND & TYPE \_\_\_\_\_ PLUG @ \_\_\_\_\_ TYPE \_\_\_\_\_ PLUG @ \_\_\_\_\_ TYPE \_\_\_\_\_

COMPLETION & TEST DATA BY PRODUCING FORMATION

FORMATION	WOODFORD	HUNTON				
SPACING & SPACING						
ORDER NUMBER	640:529920	640: 529920				
CLASS: Oil, Gas, Dry, Inj, Disp, Comm Disp, Svc	Gas	Gas				
PERFORATED INTERVALS	12 Stages 8237-9217,9681-13188	2 STAGES 8967-9089,9324-9578				
ACID/VOLUME Fracture Treatment (Fluids/Prop Amounts)	111,400 gals 155,572 BTW 423,772# 100 Mesh 2906566# 40/70	1600 gals 19,888 BTW 54,888# 100 Mesh 378,754# 40/70				

Request minimum gas allowable (165-10-17.2) Gas Purchaser/Measurer \_\_\_\_\_ 1st Sales Date \_\_\_\_\_

INITIAL TEST DATA			
INITIAL TEST DATE	3/31/2013		
OIL-BBL/DAY	N/A		
OIL-GRAVITY ( API)	N/A		
GAS-MCF/DAY	2428		
GAS-OIL RATIO CU FT/BBL	N/A		
WATER-BBL/DAY	363		
PUMPING OR FLOWING	Flowing		
INITIAL SHUT-IN PRESSURE	1400		
CHOKE SIZE	36/64"		
FLOW TUBING PRESSURE	760		

A record of the formations drilled through, and pertinent remarks are presented on the reverse. I declare that I have knowledge of the contents of this report and am authorized by my organization to make this report, which was prepared by me or under my supervision and direction, with the data and facts stated herein to be true, correct, and complete to the best of my knowledge and belief.

Signature: Debbie Waggoner NAME (PRINT OR TYPE) Debbie Waggoner, Regulatory Analyst DATE 4/26/2013 PHONE NUMBER 405-232-4011  
 ADDRESS 210 Park Avenue, Suite 2350 CITY Oklahoma City STATE Oklahoma ZIP 73102 EMAIL ADDRESS debbie.waggoner@xtoenergy.com



API NO. 121-24653  
 OTC PROD. UNIT NO. 121-209769

**AS SUBMITTED**

5/1/13  
 CORPORATION COMMISSION  
 Conservation Division  
 Office Box 52000  
 Oklahoma 73152-2000  
 165-10-3-25

**RECEIVED**  
 APR 29 2013 1016EZ  
 OKLAHOMA CORPORATION COMMISSION

PLEASE TYPE OR NOTE:  
 Attach copy of original  
 ORIGINAL AMENDED  
 Reason Amended

TYPE OF DRILLING OPERATION  
 STRAIGHT HOLE \_\_\_\_\_ DIRECTIONAL HOLE \_\_\_\_\_ HORIZONTAL HOLE   
 SERVICE WELL \_\_\_\_\_  
 If directional or horizontal, see reverse for location

COUNTY: Pittsburg  
 SEC: 20 TWP: 5N RGE: 12E  
 LEASE NAME: PATTERSON  
 WELL NO.: 1-20H17  
 SHL: NE 1/4 NW 1/4 NE 1/4 NW 1/4  
 FNL: 265 FWL OF 1/4 SEC: 1928  
 ELEVATION: 265  
 Derrick Ft: 787' Ground  
 Latitude if Known: 34°53'50.8"N  
 Longitude if Known: 96°03'53.1"W  
 OPERATOR NAME: XTO ENERGY INC.  
 ADDRESS: 210 PARK AVENUE, SUITE 2350  
 CITY: OKLAHOMA CITY STATE: OKLAHOMA ZIP: 73102

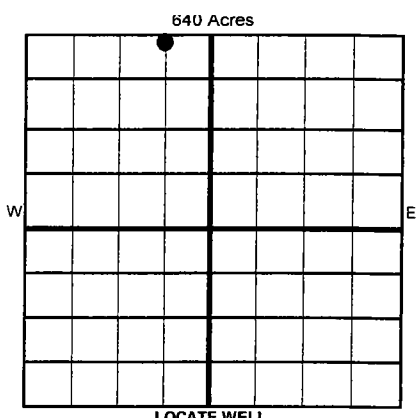

COMPLETION TYPE

SINGLE ZONE  
 MULTIPLE ZONE  
 Application Date \_\_\_\_\_  
 COMMINGLED  
 Application Date 4/10/2013  
 LOCATION EXCEPTION ORDER NO. 593485  
 INCREASED DENSITY ORDER NO. 593322

CASING & CEMENT (Form 1002C must be attached)

TYPE	SIZE	WEIGHT	GRADE	FEET	PSI	SAX	TOP OF CMI
Conductor	20"	67	J-55	67		45	Surface
Surface	13 3/8"	54.50	J-55	520		450	Surface
Intermediate	9 5/8"	40	K-55	3811		400	2370
Production	5 1/2"	20	P-110	13,300		1970	7330
Liner							

PACKER @ \_\_\_\_\_ BRAND & TYPE \_\_\_\_\_ PLUG @ \_\_\_\_\_ TYPE \_\_\_\_\_ PLUG @ \_\_\_\_\_ TYPE \_\_\_\_\_ TOTAL DEPTH 13,300'  
 PACKER @ \_\_\_\_\_ BRAND & TYPE \_\_\_\_\_ PLUG @ \_\_\_\_\_ TYPE \_\_\_\_\_ PLUG @ \_\_\_\_\_ TYPE \_\_\_\_\_

COMPLETION & TEST DATA BY PRODUCING FORMATION

FORMATION	WOODFORD	HUNTON	
SPACING & SPACING ORDER NUMBER	640:529920	640: 529920	
CLASS: Oil, Gas, Dry, Inj, Disp, Comm Disp, Svc	Gas	Gas	
PERFORATED INTERVALS	12 Stages 8237-9217,9681-13188	2 STAGES 8967-9089,9324-9578	
ACID/VOLUME Fracture Treatment (Fluids/Prop Amounts)	111,400 gals 155,572 BTW 423,772# 100 Mesh 2906566# 40/70	1600 gals 19,888 BTW 54,888# 100 Mesh 378,754# 40/70	

*Reported to Frac Fracs*

INITIAL TEST DATA

Request minimum gas allowable (165-10-17.2)  
 Gas Purchaser/Measurer \_\_\_\_\_ 1st Sales Date 3/11/12

INITIAL TEST DATE	3/31/2013
OIL-BBL/DAY	N/A
OIL-GRAVITY ( API)	N/A
GAS-MCF/DAY	2428
GAS-OIL RATIO CU FT/BBL	N/A
WATER-BBL/DAY	363
PUMPING OR FLOWING	Flowing
INITIAL SHUT-IN PRESSURE	1400
CHOKE SIZE	36/64
FLOW TUBING PRESSURE	760

A record of the formations drilled through, and pertinent remarks are presented on the reverse. I declare that I have knowledge of the contents of this report and am authorized by my organization to make this report, which was prepared by me or under my supervision and direction, with the data and facts stated herein to be true, correct, and complete to the best of my knowledge and belief.

Signature: *Debbie Waggoner*  
 Name (PRINT OR TYPE): Debbie Waggoner, Regulatory Analyst  
 Date: 4/26/2013  
 Phone Number: 405-232-4011  
 Address: 210 Park Avenue, Suite 2350, Oklahoma City, Oklahoma 73102  
 Email Address: debbie.waggoner@xtoenergy.com

*EZ*

*JK*