

Oklahoma Corporation Commission  
Oil & Gas Conservation Division  
Post Office Box 52000  
Oklahoma City, Oklahoma 73152-2000  
Rule 165: 10-3-25

Form 1002A

API No.: 35151237900000

**Completion Report**

Spud Date: October 31, 2012

OTC Prod. Unit No.: 151-210116

Drilling Finished Date: November 21, 2012

1st Prod Date: March 20, 2013

Completion Date: February 24, 2013

**Drill Type: HORIZONTAL HOLE**

Min Gas Allowable: Yes

Well Name: MACK 10-27-17 1H

Purchaser/Measurer: CHESAPEAKE OPERATING INC

Location: WOODS 10 27N 17W  
S2 SE SW SW  
200 FSL 990 FWL of 1/4 SEC  
Derrick Elevation: 1776 Ground Elevation: 1761

First Sales Date: 03/22/2013

Operator: CHESAPEAKE OPERATING INC 17441  
PO BOX 18496  
6100 N WESTERN AVE  
OKLAHOMA CITY, OK 73154-0496

Completion Type	
X	Single Zone
	Multiple Zone
	Commingled

Location Exception	
Order No	
603311	

Increased Density	
Order No	
There are no Increased Density records to display.	

Casing and Cement							
Type	Size	Weight	Grade	Feet	PSI	SAX	Top of CMT
SURFACE	13 3/8	48	H-40	839		895	SURFACE
INTERMEDIATE	9 5/8	36	J-55	1510		475	SURFACE
PRODUCTION	7	26	P-110	5988		211	3750

Liner								
Type	Size	Weight	Grade	Length	PSI	SAX	Top Depth	Bottom Depth
LINER	4 1/2	13.5	P-110	5234	0	550	5300	10534

**Total Depth: 10534**

Packer	
Depth	Brand & Type
5268	AS-3

Plug	
Depth	Plug Type
10450	PBTD

Initial Test Data										
Test Date	Formation	Oil BBL/Day	Oil-Gravity (API)	Gas MCF/Day	Gas-Oil Ratio Cu FT/BBL	Water BBL/Day	Pumpin or Flowing	Initial Shut-In Pressure	Choke Size	Flow Tubing Pressure
Mar 29, 2013	MISSISSIPPIAN	261		748	2866	2606	ARTIFICIA			135

Completion and Test Data by Producing Formation										
Formation Name: MISSISSIPPIAN			Code: 359MSSP			Class: OIL				
<b>Spacing Orders</b>				<b>Perforated Intervals</b>						
<b>Order No</b>		<b>Unit Size</b>		<b>From</b>			<b>To</b>			
602850		640		5760			10405			
<b>Acid Volumes</b>				<b>Fracture Treatments</b>						
23,500 GALLONS 15% HCL ACID				40,094 BARRELS FRAC FLUID, 708,730 POUNDS PROPPANT						

Formation	Top
MISSISSIPPIAN	5723

Were open hole logs run? No

Date last log run:

Were unusual drilling circumstances encountered? No

Explanation:

Other Remarks
OCC: FLE ORDER HAS NOT BEEN ISSUED. WE HAVE ACCEPTED OPERATORS DATA AS SUBMITTED. IRREGULAR SECTION.

Lateral Holes
Sec: 10 TWP: 27N RGE: 17W County: WOODS
NW NE NW NW
65 FNL 671 FWL of 1/4 SEC
Depth of Deviation: 5360 Radius of Turn: 292 Direction: 358 Total Length: 4811
Measured Total Depth: 10534 True Vertical Depth: 5652 End Pt. Location From Release, Unit or Property Line: 65

FOR COMMISSION USE ONLY
Status: Accepted
1118835

API NO. 151-23790  
 OTC PROD.  
 UNIT NO. 151-210116

PLEASE TYPE OR USE BLOCK LETTERS  
 NOTE: Attach copy of original 1002A



OKLAHOMA CORPORATION COMMISSION  
 Division  
 73152-2000

RECEIVED

APR 09 2013

OKLAHOMA CORPORATION COMMISSION

ORIGINAL  
 AMENDED  
 Reason Amended  
 TYPE OF DRILLING OPERATION  
 STRAIGHT HOLE  DIRECTIONAL HOLE  HORIZONTAL HOLE  
 SERVICE WELL  
 If directional or horizontal, see reverse for bottom hole location.

COMPLETION REPORT  
 SPUD DATE 10/31/2012  
 DRLG FINISHED DATE 11/21/2012  
 DATE OF WELL COMPLETION 2/24/2013  
 1ST PROD DATE 3/20/2013  
 RECOMP DATE

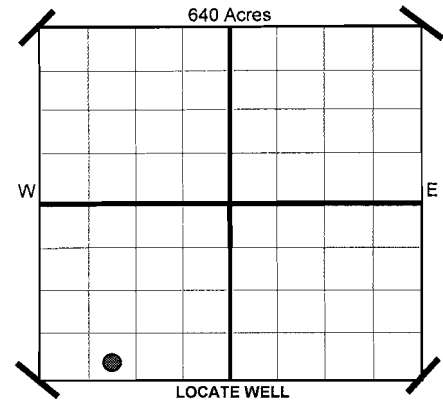

COUNTY WOODS SEC 10 TWP 27N RGE 17W  
 LEASE NAME MACK 10-27-17 WELL NO 1H  
 SHL S2 1/4 SE 1/4 SW 1/4 SW 1/4 FSL 200 FWL OF 1/4 SEC 990  
 ELEVATION Derrick Fl 1,776 Ground 1,761 Latitude (if Known)  
 OPERATOR NAME CHESAPEAKE OPERATING, INC. OTC/OCC OPERATOR NO. 17441  
 ADDRESS P.O. BOX 18496  
 CITY OKLAHOMA CITY STATE OK ZIP 73154

COMPLETION TYPE  
 SINGLE ZONE  
 MULTIPLE ZONE Application Date  
 COMMINGLED Application Date  
 LOCATION EXCEPTION ORDER NO. 603311 (Interim)  
 INCREASED DENSITY ORDER NO. N/A

CASING & CEMENT (Form 1002C must be attached)

TYPE	SIZE	WEIGHT	GRADE	FEET	PSI	SAX	TOP	
CONDUCTOR								
SURFACE	13 3/8"	48#	H-40	839		895	Surface	
INTERMEDIATE I	9 5/8"	36#	J-55	1,510		475	Surface	
INTERMEDIATE II	7"	26#	P-110	5,988		211	3,750	
LINER	4 1/2"	13.5#	P-110	5,300-10,534		550	5,300	
							TOTAL DEPTH	10,534

PACKER @ 5,268 BRAND & TYPE AS-3 PLUG @ 10,450 TYPE PBTD PLUG @ TYPE  
 PACKER @ BRAND & TYPE PLUG @ TYPE

COMPLETION & TEST DATA BY PRODUCING FORMATION

FORMATION	MISSISSIPPIAN						
SPACING & SPACING ORDER NUMBER	640 602850						
CLASS: Oil, Gas, Dry, Inj. Disp, Comm Disp, Svc	OIL						
PERFORATED INTERVALS	5,760-10,405						
ACID/VOLUME	15% HCL Acid 23,500 gal						
FRACTURE TREATMENT (Fluids/Prop Amounts)	Frac Fluid 40,094 bbls Proppant 708,730 lbs						

359MSSP

Reported to Frac Experts

Minimum Gas Allowable (165:10-17-7) Gas Purchaser/Measurer Chesapeake Operating, Inc.  
 OR 1st Sales Date 3/22/2013

INITIAL TEST DATA

INITIAL TEST DATE	3/29/2013			
OIL-BBL/DAY	261			
OIL-GRAVITY ( API)				
GAS-MCF/DAY	748			
GAS-OIL RATIO CU FT/BBL	2,866			
WATER-BBL/DAY	2,606			
PUMPING OR FLOWING	Artificial Lift			
INITIAL SHUT-IN PRESSURE				
CHOKE SIZE				
FLOW TUBING PRESSURE	135			

SCANNED

A record of the formations drilled through, and pertinent remarks are presented on the reverse. I declare that I have knowledge of the contents of this report and am authorized by my organization to make this report, which was prepared by me or under my supervision and direction, with the data and facts stated herein to be true, correct, and complete to the best of my knowledge and belief.

*David Craycraft* SIGNATURE David Craycraft - DISTRICT MANAGER 4/1/2013 DATE 405-848-8000 PHONE NUMBER  
 P.O. BOX 18496 ADDRESS OKLAHOMA CITY CITY OK STATE 73154 ZIP dawn.richardson@chk.com EMAIL ADDRESS

PLEASE TYPE OR USE BLACK INK ONLY  
FORMATION RECORD

Give formation names and tops, if available, or descriptions and thickness of formations drilled through. Show intervals cored or drillstem tested.

LEASE NAME MACK 10-27-17

WELL NO. 1H

NAMES OF FORMATIONS	TOP
MISSISSIPPIAN	5,723

FOR COMMISSION USE ONLY

ITD on file  YES  NO

APPROVED \_\_\_\_\_ DISAPPROVED \_\_\_\_\_

2) Reject Codes \_\_\_\_\_

\_\_\_\_\_

\_\_\_\_\_

\_\_\_\_\_

Were open hole logs run? yes  no

Date Last log was run N/A

Was CO<sub>2</sub> encountered? yes  no  at what depths?

Was H<sub>2</sub>S encountered? yes  no  at what depths?

Were unusual drilling circumstances encountered? yes  no

If yes, briefly explain.

Other remarks:

\_\_\_\_\_

\_\_\_\_\_

\_\_\_\_\_

\_\_\_\_\_

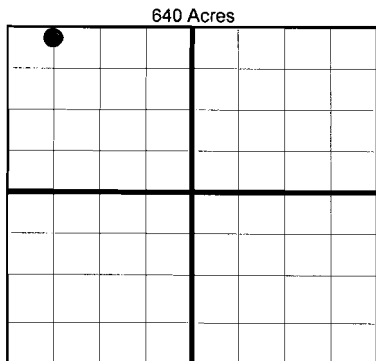

**BOTTOM HOLE LOCATION FOR DIRECTIONAL HOLE**

SEC	TWP	RGE	COUNTY							
Spot Location				1/4	1/4	1/4	1/4	Feet From 1/4 Sec Lines	FSL	FWL
Measured Total Depth				True Vertical Depth		BHL From Lease, Unit, or Property Line:				

**BOTTOM HOLE LOCATION FOR HORIZONTAL HOLE: (LATERALS)**

**LATERAL #1**

SEC	TWP	RGE	COUNTY									
10	27N	17W	WOODS									
Spot Location				NW 1/4	NE 1/4	NW 1/4	NW 1/4	Feet From 1/4 Sec Lines	FNL	65	FWL	671
Depth of Deviation				5,360		292		358		4,811		
Measured Total Depth				10,534		5,652		BHL From Lease, Unit, or Property Line: 65				

If more than three drainholes are proposed, attach a separate sheet indicating the necessary information.

Direction must be stated in degrees azimuth. Please note, the horizontal drainhole and its end point must be located within the boundaries of the lease or spacing unit.

**Directional surveys are required for all drainholes and directional wells.**

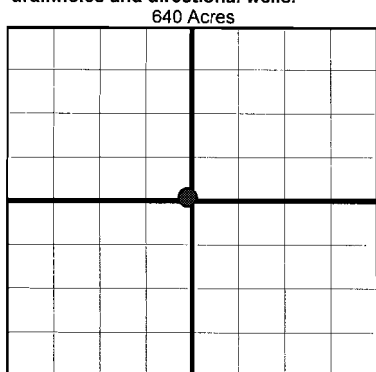

**LATERAL #2**

SEC	TWP	RGE	COUNTY								
Spot Location				1/4	1/4	1/4	1/4	Feet From 1/4 Sec Lines	FSL	FWL	
Depth of Deviation				Radius of Turn		Direction		Total Length			
Measured Total Depth				True Vertical Depth		BHL From Lease, Unit, or Property Line:					

**LATERAL #3**

SEC	TWP	RGE	COUNTY								
Spot Location				1/4	1/4	1/4	1/4	Feet From 1/4 Sec Lines	FSL	FWL	
Depth of Deviation				Radius of Turn		Direction		Total Length			
Measured Total Depth				True Vertical Depth		BHL From Lease, Unit, or Property Line:					