

Oklahoma Corporation Commission  
 Oil & Gas Conservation Division  
 Post Office Box 52000  
 Oklahoma City, Oklahoma 73152-2000  
 Rule 165: 10-3-25

Form 1002A

API No.: 35121246550002

**Completion Report**

Spud Date: April 26, 2012

OTC Prod. Unit No.: 121-209770

Drilling Finished Date: August 29, 2012

1st Prod Date: March 14, 2013

Completion Date: March 06, 2013

**Drill Type: HORIZONTAL HOLE**

Well Name: PATTERSON 2-20H17

Purchaser/Measurer:

Location: PITTSBURG 20 5N 12E  
 NE NW NE NW  
 265 FNL 1908 FWL of 1/4 SEC  
 Derrick Elevation: 0 Ground Elevation: 787

First Sales Date:

Operator: XTO ENERGY INC 21003

210 PARK AVE STE. 2350  
 OKLAHOMA CITY, OK 73102

Completion Type	
X	Single Zone
	Multiple Zone
	Commingled

Location Exception	
Order No	
593903	

Increased Density	
Order No	
593322	

Casing and Cement							
Type	Size	Weight	Grade	Feet	PSI	SAX	Top of CMT
CONDUCTOR	20	85	J-55	67		45	SURFACE
SURFACE	13 3/8	54.50	J-55	529		465	SURFACE
INTERMEDIATE	9 5/8	40	K-55	3800		400	2370
PRODUCTION	5 1/2	20	P-110	13345		1970	4900

Liner								
Type	Size	Weight	Grade	Length	PSI	SAX	Top Depth	Bottom Depth
There are no Liner records to display.								

**Total Depth: 13350**

Packer	
Depth	Brand & Type
There are no Packer records to display.	

Plug	
Depth	Plug Type
There are no Plug records to display.	

Initial Test Data										
Test Date	Formation	Oil BBL/Day	Oil-Gravity (API)	Gas MCF/Day	Gas-Oil Ratio Cu FT/BBL	Water BBL/Day	Pumpin or Flowing	Initial Shut-In Pressure	Choke Size	Flow Tubing Pressure
Mar 31, 2013	WOODFORD			2806		430	FLOWING	1040	36/64	650

Completion and Test Data by Producing Formation										
Formation Name: WOODFORD			Code: 319WDFD			Class: GAS				
<b>Spacing Orders</b>				<b>Perforated Intervals</b>						
<b>Order No</b>	<b>Unit Size</b>			<b>From</b>			<b>To</b>			
529920	640			8286			13232			
<b>Acid Volumes</b>				<b>Fracture Treatments</b>						
14,000 GALLONS ACID				14 STAGES - 175,772 BTW, 472,160 POUNDS 100 MESH, 3,279,850 POUNDS 40/70						

Formation	Top
CANEY	7347
MAYES	7752
WOODFORD	8056

Were open hole logs run? No

Date last log run:

Were unusual drilling circumstances encountered? No

Explanation:

Other Remarks
IRREGULAR SECTION. OCC: FLE ORDER HAS NOT BEEN ISSUED. WE HAVE ACCEPTED OPERATORS DATA AS SUBMITTED.

Lateral Holes
Sec: 17 TWP: 5N RGE: 12E County: PITTSBURG
NE NW NE NW
50 FNL 1894 FWL of 1/4 SEC
Depth of Deviation: 7110 Radius of Turn: 706 Direction: 359 Total Length: 5493
Measured Total Depth: 13350 True Vertical Depth: 7683 End Pt. Location From Release, Unit or Property Line: 50

FOR COMMISSION USE ONLY
Status: Accepted
1118732

API NO. 121-24655  
 OTC PROD. UNIT NO. 121-209770  
 PLEASE TYPE OR USE BLACK INK  
 NOTE: Attach copy of original 1002A if



MISSION

RECEIVED

APR 02 2013

OKLAHOMA CORPORATION  
COMMISSION

ORIGINAL  
 AMENDED  
 Reason Amended  
 TYPE OF DRILLING OPERATION  
 STRAIGHT HOLE  DIRECTIONAL HOLE  HORIZONTAL HOLE  
 SERVICE WELL  
 If directional or horizontal, see reverse for bottom hole location.

SPUD DATE 4/26/2012  
 DRLG FINISHED 8/29/2012

COUNTY Pittsburg SEC 20 TWP 5N RGE 12E  
 LEASE NAME PATTERSON WELL NO. 2-20H17  
 SHL NE 1/4 NW 1/4 NE 1/4 NW 1/4 FNL 265 FEL OF 1/4 SEC 1908  
 ELEVATION Derrick Ft GL: 787' Ground Latitude if Known 34°53'50.8"N Longitude if Known 96°03'53.3"W  
 OPERATOR NAME XTO ENERGY INC. OTC/OCC OPERATOR NO. 21U03  
 ADDRESS 210 PARK AVENUE, SUITE 2350  
 CITY OKLAHOMA CITY STATE OKLAHOMA ZIP 73102

LOCATE WELL

COMPLETION TYPE  
 SINGLE ZONE  
 MULTIPLE ZONE  
 Application Date  
 COMMINGLED  
 Application Date  
 LOCATION EXCEPTION ORDER NO.  
 593903  
 INCREASED DENSITY ORDER NO.  
 593322

CASING & CEMENT (Form 1002C must be attached)

TYPE	SIZE	WEIGHT	GRADE	FEET	PSI	SAX	TOP OF CMI
Conductor	20"	85	J-55	67		45	Surface
Surface	13 3/8"	54.50	J-55	555		465	Surface
Intermediate	9 5/8"	40	K-55	3800		400	2370'
Production	5 1/2"	20	P-110	13,345		1970	4900'
Liner							
							<b>13,350'</b>

PACKER @ \_\_\_\_\_ BRAND & TYPE \_\_\_\_\_ PLUG @ \_\_\_\_\_ TYPE \_\_\_\_\_ PLUG @ \_\_\_\_\_ TYPE \_\_\_\_\_ TOTAL DEPTH 13,350'  
 PACKER @ \_\_\_\_\_ BRAND & TYPE \_\_\_\_\_ PLUG @ \_\_\_\_\_ TYPE \_\_\_\_\_ PLUG @ \_\_\_\_\_ TYPE \_\_\_\_\_

COMPLETION & TEST DATA BY PRODUCING FORMATION

FORMATION	WOODFORD					
SPACING & SPACING ORDER NUMBER	640: 529920					
CLASS: Oil, Gas, Dry, Inj, Disp, Comm Disp, Svc	Gas					
PERFORATED INTERVALS	14 Stages 8286-13,232'					
ACID/VOLUME Fracture Treatment (Fluids/Prop Amounts)	14,000 gals acid 175,772 BTW 472,160# 100 Mesh 3,279,850# 40/70					

*314WDFD* *Reported to Frac Focus*

SCANNED

Request minimum gas allowable (165-10-17-7) Gas Purchaser/Measurer \_\_\_\_\_ 1st Sales Date \_\_\_\_\_

INITIAL TEST DATA

INITIAL TEST DATE	3/31/2013				
OIL-BBL/DAY	N/A				
OIL-GRAVITY ( API)	N/A				
GAS-MCF/DAY	2806				
GAS-OIL RATIO CU FT/BBL	N/A				
WATER-BBL/DAY	430				
PUMPING OR FLOWING	Flowing				
INITIAL SHUT-IN PRESSURE	1040				
CHOKE SIZE	36/64"				
FLOW TUBING PRESSURE	650				

A record of the formations drilled through, and pertinent remarks are presented on the reverse. I declare that I have knowledge of the contents of this report and am authorized by my organization to make this report, which was prepared by me or under my supervision and direction, with the data and facts stated herein to be true, correct, and complete to the best of my knowledge and belief.

*Debbie Waggoner* Debbie Waggoner, Regulatory Analyst  
 SIGNATURE NAME (PRINT OR TYPE) DATE 4/1/2012 PHONE NUMBER 405-232-4011  
 ADDRESS 210 Park Avenue, Suite 2350 Oklahoma City Oklahoma 73102  
 CITY STATE ZIP EMAIL ADDRESS debbie.waggoner@xtoenergy.com

**PLEASE TYPE OR USE BLACK INK ONLY  
FORMATION RECORD**

Give formation names and tops, if available, or descriptions and thickness of formations drilled through. Show intervals cored or drillstem tested.

LEASE NAME

PATTERSON

WELL NO. 2-20H17

NAMES OF FORMATIONS	TOP
CANEY	7347
MAYES	7752
WOODFORD	8056

FOR COMMISSION USE ONLY	
ILD on file	<input type="checkbox"/> YES <input type="checkbox"/> NO
APPROVED	DISAPPROVED
2) Reject Codes	

Were open hole logs run?	yes <input checked="" type="checkbox"/>	no
Date Last log was run		
Was CO <sub>2</sub> encountered?	yes <input checked="" type="checkbox"/>	no at what depths?
Was H <sub>2</sub> S encountered?	yes <input checked="" type="checkbox"/>	no at what depths?
Were unusual drilling circumstances encountered?	yes <input type="checkbox"/>	no <input checked="" type="checkbox"/>
If yes, briefly explain.		

Other remarks: **IRREGULAR SECTION**

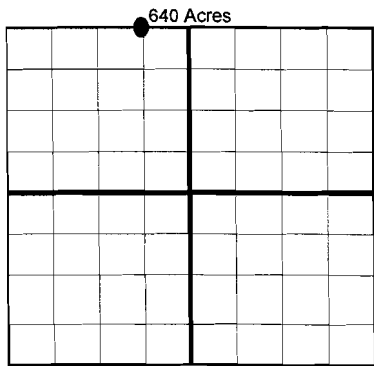

**BOTTOM HOLE LOCATION FOR DIRECTIONAL HOLE**

SEC	TWP	RGE	COUNTY
Spot Location	1/4	1/4	1/4
Measured Total Depth	True Vertical Depth		Feet From 1/4 Sec Lines FSL FWL
BHL From Lease, Unit, or Property Line:			

**BOTTOM HOLE LOCATION FOR HORIZONTAL HOLE: (LATERALS)**

SEC	TWP	RGE	COUNTY
17	5N	12E	PITTSBURG
Spot Location	NE 1/4	NW 1/4	NE 1/4 NW 1/4
Depth of Deviation	7110'	Radius of Turn	706.6'
Measured Total Depth	True Vertical Depth		End Pt Location From Lease, Unit or Property Line:
13,350'	7682'		50' FNL & 5493.8' FWL

**LATERAL #2**

SEC	TWP	RGE	COUNTY
Spot Location	1/4	1/4	1/4
Depth of Deviation	Radius of Turn		Direction Total Length
Measured Total Depth	True Vertical Depth		End Pt Location From Lease, Unit or Property Line:

**LATERAL #3**

SEC	TWP	RGE	COUNTY
Spot Location	1/4	1/4	1/4
Depth of Deviation	Radius of Turn		Direction Total Length
Measured Total Depth	True Vertical Depth		End Pt Location From Lease, Unit or Property Line:

If more than three drainholes are proposed, attach a separate sheet indicating the necessary information.

Direction must be stated in degrees azimuth. Please note, the horizontal drainhole and its end point must be located within the boundaries of the lease or spacing unit.

**Directional surveys are required for all drainholes and directional wells.**

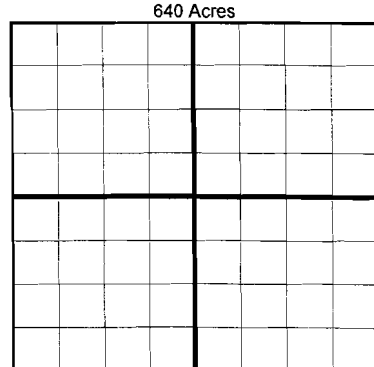

API NO. 121-24655  
 OTC PROD. UNIT NO. 121-209770

PLEASE TYPE OR USE BLACK  
 NOTE: 3/14/13  
 Attach copy of original 1002A if

**AS SUBMITTED**

MISSION  
 2000

**RECEIVED**

Form 1002A  
 Rev. 2007

APR 02 2013

1016EZ

OKLAHOMA CORPORATION  
 COMMISSION

ORIGINAL  
 AMENDED  
 Reason Amended  
 A: 209770 I

TYPE OF DRILLING OPERATION  
 STRAIGHT HOLE \_\_\_\_\_ DIRECTIONAL HOLE \_\_\_\_\_ HORIZONTAL HOLE

SPUD DATE 4/26/2012  
 DRLG FINISHED 8/29/2012

WELL COMPLETION 3/6/2013  
 1ST PROD DATE 3/14/2013

RECOMP DATE \_\_\_\_\_

COUNTY Pittsburg SEC 20 TWP 5N RGE 12E  
 LEASE NAME PATTERSON WELL NO. 2-20H17  
 SHL NE 1/4 NW 1/4 NE 1/4 NW 1/4 FNL 265 FEL OF 1/4 SEC 1908  
 ELEVATION Derick Ft GL: 787' Ground Latitude if Known 34°53'50.8"N Longitude if Known 96°03'53.3"W  
 OPERATOR NAME XTO ENERGY INC. OTC/OCC OPERATOR NO. 21003  
 ADDRESS 210 PARK AVENUE, SUITE 2350  
 CITY OKLAHOMA CITY STATE OKLAHOMA ZIP 73102

LOCATE WELL

COMPLETION TYPE

SINGLE ZONE  
 MULTIPLE ZONE  
 Application Date \_\_\_\_\_  
 COMMINGLED  
 Application Date \_\_\_\_\_

LOCATION EXCEPTION ORDER NO. 593903 I.O.  
 INCREASED DENSITY ORDER NO. 593322

CASING & CEMENT (Form 1002C must be attached)

TYPE	SIZE	WEIGHT	GRADE	FEET	PSI	SAX	TOP OF CMI
Conductor	20"	85	J-55	67		45	Surface
Surface	13 3/8"	54.50	J-55	555		465	Surface
Intermediate	9 5/8"	40	K-55	3800		400	2370'
Production	5 1/2"	20	P-110	13,345		1970	4900'
Liner							
TOTAL DEPTH							13,350'

PACKER @ \_\_\_\_\_ BRAND & TYPE \_\_\_\_\_  
 PLUG @ \_\_\_\_\_ TYPE \_\_\_\_\_

COMPLETION & TEST DATA BY PRODUCING FORMATION

FORMATION	WOODFORD						
SPACING & SPACING ORDER NUMBER	640: 529920						
CLASS: Oil, Gas, Dry, Inj., Disp, Comm Disp, Svc	Gas						
PERFORATED INTERVALS	14 Stages 8286-13,232'						
ACID/VOLUME Fracture Treatment (Fluids/Prop Amounts)	14,000 gals acid 175,772 BTW 472,160# 100 Mesh 3,279,850# 40/70						

319WDFD

Reported to Frac Focus

INITIAL TEST DATA

Request minimum gas allowable (165:10-17-7) Gas Purchaser/Measurer \_\_\_\_\_ 1st Sales Date 3/14/13

INITIAL TEST DATE	3/31/2013				
OIL-BBL/DAY	N/A				
OIL-GRAVITY ( API)	N/A				
GAS-MCF/DAY	2806				
GAS-OIL RATIO CU FT/BBL	N/A				
WATER-BBL/DAY	430				
PUMPING OR FLOWING	Flowing				
INITIAL SHUT-IN PRESSURE	1040				
CHOKE SIZE	36/64"				
FLOW TUBING PRESSURE	650				

A record of the formations drilled through, and pertinent remarks are presented on the reverse. I declare that I have knowledge of the contents of this report and am authorized by my organization to make this report, which was prepared by me or under my supervision and direction, with the data and facts stated herein to be true, correct, and complete to the best of my knowledge and belief.

Debbie Waggoner, Regulatory Analyst  
 SIGNATURE DATE 4/1/2012 PHONE NUMBER 405-232-4011  
 ADDRESS 210 Park Avenue, Suite 2350 CITY Oklahoma STATE Oklahoma ZIP 73102 EMAIL ADDRESS debbie.waggoner@xtoenergy.com

*E 2*

*JR*

SCANNED