

Oklahoma Corporation Commission  
Oil & Gas Conservation Division  
Post Office Box 52000  
Oklahoma City, Oklahoma 73152-2000  
Rule 165: 10-3-25

Form 1002A

API No.: 35069201320000

**Completion Report**

Spud Date: February 06, 2012

OTC Prod. Unit No.: 069-207753

Drilling Finished Date: March 18, 2012

1st Prod Date: May 09, 2012

Completion Date: April 30, 2012

**Drill Type: HORIZONTAL HOLE**

Well Name: CHAPMAN 1-20H21

Purchaser/Measurer:

Location: JOHNSTON 20 4S 4E  
SE SE NE NE  
1080 FNL 300 FEL of 1/4 SEC  
Derrick Elevation: 0 Ground Elevation: 764

First Sales Date:

Operator: XTO ENERGY INC 21003

810 HOUSTON ST  
FORT WORTH, TX 76102-6203

Completion Type	
X	Single Zone
	Multiple Zone
	Commingled

Location Exception	
Order No	
601556	

Increased Density	
Order No	
There are no Increased Density records to display.	

Casing and Cement							
Type	Size	Weight	Grade	Feet	PSI	SAX	Top of CMT
SURFACE	13 3/8	54.5	J-55	460		460	SURFACE
INTERMEDIATE	9 5/8	36	K-55	1500		400	SURFACE
PRODUCTION	5 1/2	20	P-110	16215		485	8020

Liner								
Type	Size	Weight	Grade	Length	PSI	SAX	Top Depth	Bottom Depth
There are no Liner records to display.								

**Total Depth: 16248**

Packer	
Depth	Brand & Type
There are no Packer records to display.	

Plug	
Depth	Plug Type
There are no Plug records to display.	

Initial Test Data										
Test Date	Formation	Oil BBL/Day	Oil-Gravity (API)	Gas MCF/Day	Gas-Oil Ratio Cu FT/BBL	Water BBL/Day	Pumpin or Flowing	Initial Shut-In Pressure	Choke Size	Flow Tubing Pressure
May 24, 2012	WOODFORD	223	53	3456	15498	779	FLOWING	3100	34/64	

Completion and Test Data by Producing Formation										
Formation Name: WOODFORD			Code: 319WDFD			Class: GAS				
<b>Spacing Orders</b>				<b>Perforated Intervals</b>						
<b>Order No</b>		<b>Unit Size</b>		<b>From</b>			<b>To</b>			
123138		640		11728			16145			
<b>Acid Volumes</b>				<b>Fracture Treatments</b>						
33,000 GALLONS FE / HCL				11 STAGES - 249,689 BTW, 590,700 POUNDS MESH, 1,837,460 POUNDS 40/70, 731,089 POUNDS 30/50						

Formation	Top
WOODFORD	11432

Were open hole logs run? No

Date last log run:

Were unusual drilling circumstances encountered? No

Explanation:

Other Remarks
IRREGULAR SECTION

Lateral Holes
Sec: 21 TWP: 4S RGE: 4E County: JOHNSTON
SE NE NE NE
384 FNL 64 FEL of 1/4 SEC
Depth of Deviation: 8015 Radius of Turn: 2435 Direction: 83 Total Length: 5565
Measured Total Depth: 16248 True Vertical Depth: 10593 End Pt. Location From Release, Unit or Property Line: 64

FOR COMMISSION USE ONLY
Status: Accepted
1114725

API NO. 069-20132  
 OTC PROD. UNIT NO. 069-207753

PLEASE TYPE OR USE BLACK INK  
 NOTE: Attach copy of original 1002A if recom

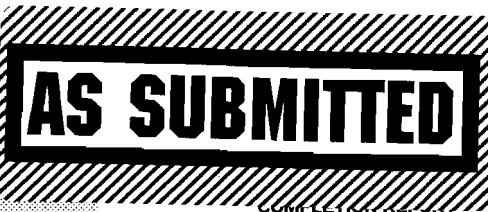

RECEIVED

MAY 29 2012

OKLAHOMA CORPORATION COMMISSION

ORIGINAL  
 AMENDED  
 Reason Amended Reclassify from oil well to gas well

TYPE OF DRILLING OPERATION  
 STRAIGHT HOLE  DIRECTIONAL HOLE  HORIZONTAL HOLE  
 SERVICE WELL  
 If directional or horizontal, see reverse for bottom hole location.

COUNTY	JOHNSTON	SEC	20	TWP	4S	RGE	4E	SPUD DATE	2/6/2012	
LEASE NAME	CHAPMAN			WELL NO.	1-20H21			DRLG FINISHED	3/18/2012	
SHL	SE 1/4	SE 1/4	NE 1/4	NE 1/4	FNL	1080	FEL OF 1/4 SEC	300	WELL COMPLETION	4/30/2012
ELEVATION	Derrick Ft			GL: 764'	Ground	Latitude if Known		34°11'55.2"N	Longitude if Known	96°53'56.1"W
OPERATOR NAME	XTO ENERGY INC.				OTC/OCC OPERATOR NO.		21003			
ADDRESS	210 PARK AVENUE, SUITE 2350									
CITY	OKLAHOMA CITY			STATE	OKLAHOMA		ZIP	73102		

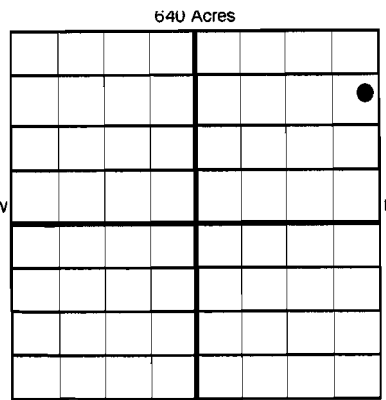

COMPLETION TYPE

SINGLE ZONE

MULTIPLE ZONE  
 Application Date \_\_\_\_\_

COMMINGLED  
 Application Date \_\_\_\_\_

LOCATION EXCEPTION ORDER NO.  
 590559

INCREASED DENSITY ORDER NO.

CASING & CEMENT (Form 1002C must be attached)

TYPE	SIZE	WEIGHT	GRADE	FEET	PSI	SAX	TOP OF CMI	
Conductor								
Surface	13 3/8"	54.50	J-55	460		460	SURFACE	
Intermediate	9 5/8"	36	K-55	1500		400	SURFACE	
Production	5 1/2"	20	P-110	16,248		1545	8020	
Liner								
							TOTAL DEPTH	16,248'

PACKER @ \_\_\_\_\_ BRAND & TYPE \_\_\_\_\_ PLUG @ \_\_\_\_\_ TYPE \_\_\_\_\_ PLUG @ \_\_\_\_\_ TYPE \_\_\_\_\_  
 PACKER @ \_\_\_\_\_ BRAND & TYPE \_\_\_\_\_ PLUG @ \_\_\_\_\_ TYPE \_\_\_\_\_ PLUG @ \_\_\_\_\_ TYPE \_\_\_\_\_

COMPLETION & TEST DATA BY PRODUCING FORMATION

FORMATION	WOODFORD					
SPACING & SPACING ORDER NUMBER	640: 123138					
CLASS Oil, Gas, Dry, Inj, Disp, Comm Disp, Svc	Gas					
PERFORATED INTERVALS	11 STAGES					
	11,728-16,145					
ACID/VOLUME Fracture Treatment (Fluids/Prop Amounts)	33,000 gals FE/HCl					
	249,689 BTW					
	590,700# Mesh					
	1,837,460# 40/70	731,089# 30/50				

SCANNED

INITIAL TEST DATA  Request minimum gas allowable (185-10-17-7) Gas Purchaser/Measurer \_\_\_\_\_ 1st Sales Date \_\_\_\_\_

INITIAL TEST DATE	5/24/2012			
OIL-BBL/DAY	223			
OIL-GRAVITY ( API)	53			
GAS-MCF/DAY	3456			
GAS-OIL RATIO CU FT/BBL	15498			
WATER-BBL/DAY	779			
PUMPING OR FLOWING	Flowing			
INITIAL SHUT-IN PRESSURE	3100			
CHOKE SIZE	34/64"			
FLOW TUBING PRESSURE				

A record of the formations drilled through, and pertinent remarks are presented on the reverse. I declare that I have knowledge of the contents of this report and am authorized by my organization to make this report, which was prepared by me or under my supervision and direction, with the data and facts stated herein to be true, correct, and complete to the best of my knowledge and belief.

*Debbie Waggoner*  
 SIGNATURE  
 210 Park Avenue, Suite 2350  
 ADDRESS

Debbie Waggoner, Regulatory Analyst  
 NAME (PRINT OR TYPE)  
 Oklahoma City  
 CITY

5/18/2012  
 DATE

405-232-4011  
 PHONE NUMBER

debbie\_waggoner@xtoenergy.com  
 EMAIL ADDRESS

Oklahoma  
 STATE

73102  
 ZIP

**PLEASE TYPE OR USE BLACK INK ONLY**  
FORMATION RECORD

Give formation names and tops, if available, or descriptions and thickness of formations drilled through. Show intervals cored or drillstem tested.

LEASE NAME CHAPMAN

WELL NO 1-20H21

NAMES OF FORMATIONS	TOP
WOODFORD	11,432'

FOR COMMISSION USE ONLY

ITD on file  YES  NO

APPROVED \_\_\_\_\_ DISAPPROVED \_\_\_\_\_

2) Reject Codes

\_\_\_\_\_

\_\_\_\_\_

\_\_\_\_\_

\_\_\_\_\_

Were open hole logs run? yes  no

Date Last log was run \_\_\_\_\_

Was CO<sub>2</sub> encountered? yes  no  at what depths? \_\_\_\_\_

Was H<sub>2</sub>S encountered? yes  no  at what depths? \_\_\_\_\_

Were unusual drilling circumstances encountered? yes  no   
If yes, briefly explain. \_\_\_\_\_

Other remarks: **IRREGULAR SECTION**

\_\_\_\_\_

\_\_\_\_\_

\_\_\_\_\_

\_\_\_\_\_

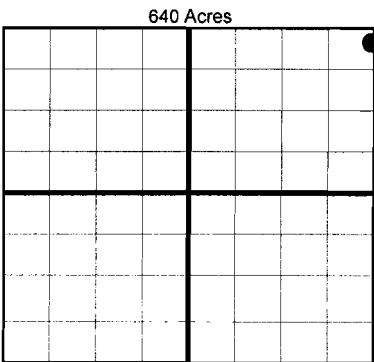

**BOTTOM HOLE LOCATION FOR DIRECTIONAL HOLE**

SEC	TWP	RGE	COUNTY
Spot Location	Feet From 1/4 Sec Lines		
1/4	1/4	1/4	1/4
Measured Total Depth	True Vertical Depth	BHL From Lease, Unit, or Property Line:	

**BOTTOM HOLE LOCATION FOR HORIZONTAL HOLE: (LATERALS)**

**LATERAL #1**

SEC	TWP	RGE	COUNTY
21	4S	4E	JOHNSTON
Spot Location	Feet From 1/4 Sec Lines		
SE 1/4 NE 1/4 NE 1/4 NE 1/4	384 FNL <del>5221 FWL</del> <b>64 FEL</b>		
Depth of Deviation	Radius of Turn	Direction	Total Length
8015	2435.1	82.8°	5565.2
Measured Total Depth	True Vertical Depth	End Pt Location From Lease, Unit or Property Line:	
16,248	10,593	<del>384 FNL &amp; 5221 FWL</del> <b>64 FEL</b>	

If more than three drainholes are proposed, attach a separate sheet indicating the necessary information.

Direction must be stated in degrees azimuth. Please note, the horizontal drainhole and its end point must be located within the boundaries of the lease or spacing unit.

**Directional surveys are required for all drainholes and directional wells.**  
640 Acres

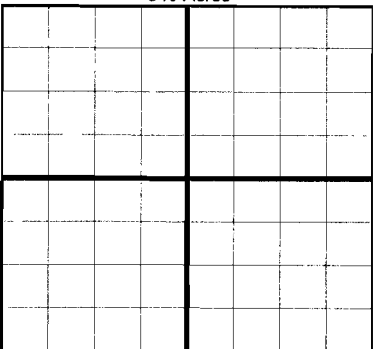

**LATERAL #2**

SEC	TWP	RGE	COUNTY
Spot Location	Feet From 1/4 Sec Lines		
1/4	1/4	1/4	1/4
Depth of Deviation	Radius of Turn	Direction	Total Length
Measured Total Depth	True Vertical Depth	End Pt Location From Lease, Unit or Property Line:	

**LATERAL #3**

SEC	TWP	RGE	COUNTY
Spot Location	Feet From 1/4 Sec Lines		
1/4	1/4	1/4	1/4
Depth of Deviation	Radius of Turn	Direction	Total Length
Measured Total Depth	True Vertical Depth	End Pt Location From Lease, Unit or Property Line:	

API NO. 069-20132  
 OTC PROD. UNIT NO. 069-207753

PLEASE TYPE OR USE BLACK INK ONLY  
 NOTE: Attach copy of original 1002A if recompletion or reentry.

OKLAHOMA CORPORATION COMMISSION  
 Oil & Gas Conservation Division  
 Post Office Box 52000  
 Oklahoma City, Oklahoma 73152-2000  
 Rule 165:10-3-25

RECEIVED Form 1002A (REV) 2007

MAY 21 2012

OKLAHOMA CORPORATION COMMISSION

64U Acres

ORIGINAL  
 AMENDED  
 Reason Amended \_\_\_\_\_  
 TYPE OF DRILLING OPERATION  
 STRAIGHT HOLE  DIRECTIONAL HOLE  HORIZONTAL HOLE  
 SERVICE WELL

COMPLETION REPORT

If directional or horizontal, see reverse for bottom hole location.

COUNTY	JOHNSTON	SEC	20	TWP	4S	RGE	4E	SPUD DATE	2/6/2012	
LEASE NAME	CHAPMAN			WELL NO.	1-20H21			DRLG FINISHED	3/18/2012	
SHL	SE 1/4	SE 1/4	NE 1/4	NE 1/4	FNL	1080	FEL OF 1/4 SEC	300	WELL COMPLETION	4/30/2012
ELEVATION	Derrick Fl			GL: 764'	Ground	Latitude if Known	34°11'55.2"N		Longitude if Known	96°53'56.1"W
OPERATOR NAME	XTO ENERGY INC.			OTC/OCC OPERATOR NO.			21003			
ADDRESS	210 PARK AVENUE, SUITE 2350									
CITY	OKLAHOMA CITY			STATE	OKLAHOMA		ZIP	73102		

COMPLETION TYPE

<input checked="" type="checkbox"/> SINGLE ZONE
<input type="checkbox"/> MULTIPLE ZONE
Application Date _____
<input type="checkbox"/> COMMINGLED
Application Date _____
LOCATION EXCEPTION ORDER NO.
590559
INCREASED DENSITY ORDER NO.

CASING & CEMENT (Form 1002C must be attached)

TYPE	SIZE	WEIGHT	GRADE	FEET	PSI	SAX	TOP OF CMI	
Conductor								
Surface	13 3/8"	54.50	J-55	460		460	SURFACE	
Intermediate	9 5/8"	36	K-55	1500		400	SURFACE	
Production	5 1/2"	20	P-110	16,248		1545	8020	
Liner								
							TOTAL DEPTH	16,248'

PACKER @ \_\_\_\_\_ BRAND & TYPE \_\_\_\_\_ PLUG @ \_\_\_\_\_ TYPE \_\_\_\_\_ PLUG @ \_\_\_\_\_ TYPE \_\_\_\_\_  
 Packer @ \_\_\_\_\_ BRAND & TYPE \_\_\_\_\_ PLUG @ \_\_\_\_\_ TYPE \_\_\_\_\_ PLUG @ \_\_\_\_\_ TYPE \_\_\_\_\_

COMPLETION & TEST DATA BY PRODUCING FORMATION

FORMATION	WOODFORD					
SPACING & SPACING ORDER NUMBER	640: 123138					
CLASS Oil, Gas, Dry, Inj, Disp, Comm Disp, Svc	Oil					
PERFORATED INTERVALS	11 STAGES					
	11,728-16,145					
ACID/VOLUME Fracture Treatment (Fluids/Prop Amounts)	33,000 gals FE/HCl					
	249,689 BTW					
	590,700# Mesh					
	1,837,460# 40/70	731,089# 30/50				

Request minimum gas allowable (165:10-17-7)  Gas Purchaser/Measurer \_\_\_\_\_ 1st Sales Date \_\_\_\_\_

INITIAL TEST DATE	5/14/2012			
OIL-BBL/DAY	384			
OIL-GRAVITY ( API)	37.4			
GAS-MCF/DAY	3167			
GAS-OIL RATIO CU FT/BBL	8247			
WATER-BBL/DAY	1621			
PUMPING OR FLOWING	Flowing			
INITIAL SHUT-IN PRESSURE	3100			
CHOKE SIZE	34/64"			
FLOW TUBING PRESSURE				

A record of the formations drilled through, and pertinent remarks are presented on the reverse. I declare that I have knowledge of the contents of this report and am authorized by my organization to make this report, which was prepared by me or under my supervision and direction, with the data and facts stated herein to be true, correct, and complete to the best of my knowledge and belief.

*Debbie Waggoner*  
 SIGNATURE  
 210 Park Avenue, Suite 2350  
 ADDRESS  
 Oklahoma City  
 CITY  
 Oklahoma  
 STATE  
 73102  
 ZIP  
 Debbie Waggoner, Regulatory Analyst  
 NAME (PRINT OR TYPE)  
 5/18/2012  
 DATE  
 405-232-4011  
 PHONE NUMBER  
 debbie\_waggoner@xtoenergy.com  
 EMAIL ADDRESS

**PLEASE TYPE OR USE BLACK INK ONLY**  
**FORMATION RECORD**

Give formation names and tops, if available, or descriptions and thickness of formations drilled through. Show intervals cored or drillstem tested.

LEASE NAME CHAPMAN

WELL NO. 1-20H21

NAMES OF FORMATIONS	TOP
WOODFORD	11,432'

FOR COMMISSION USE ONLY	
ITD on file <input type="checkbox"/> YES <input type="checkbox"/> NO	
APPROVED _____ DISAPPROVED _____	2) Reject Codes
_____	
_____	
_____	

Were open hole logs run? _____ yes <input checked="" type="checkbox"/> no
Date Last log was run _____
Was CO <sub>2</sub> encountered? _____ yes <input checked="" type="checkbox"/> no at what depths? _____
Was H <sub>2</sub> S encountered? _____ yes <input checked="" type="checkbox"/> no at what depths? _____
Were unusual drilling circumstances encountered? _____ yes <input checked="" type="checkbox"/> no If yes, briefly explain. _____

Other remarks: **IRREGULAR SECTION**

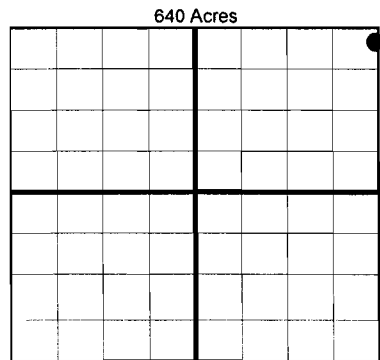

If more than three drainholes are proposed, attach a separate sheet indicating the necessary information.

Direction must be stated in degrees azimuth. Please note, the horizontal drainhole and its end point must be located within the boundaries of the lease or spacing unit.

**Directional surveys are required for all drainholes and directional wells.**

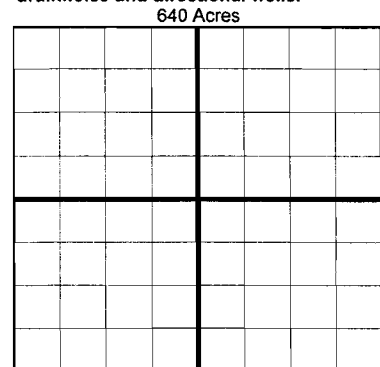

**BOTTOM HOLE LOCATION FOR DIRECTIONAL HOLE**

SEC	TWP	RGE	COUNTY	Feet From 1/4 Sec Lines		
Spot Location 1/4	1/4	1/4	1/4	FSL	FWL	
Measured Total Depth	True Vertical Depth		BHL From Lease, Unit, or Property Line:			

**BOTTOM HOLE LOCATION FOR HORIZONTAL HOLE: (LATERALS)**

LATERAL #1									
SEC	TWP	RGE	COUNTY	Feet From 1/4 Sec Lines					
21	4S	4E	JOHNSTON	SEC 1/4	NE 1/4	NE 1/4	NE 1/4	384 FNL	5221 FWL
Depth of Deviation		Radius of Turn		Direction		Total Length			
8015		2435.1		82.8°		5565.2			
Measured Total Depth	True Vertical Depth		End Pt Location From Lease, Unit or Property Line:						
16,248	10,593		384 FNL & 5221 FWL						

**LATERAL #2**

SEC	TWP	RGE	COUNTY	Feet From 1/4 Sec Lines		
1/4	1/4	1/4	1/4	FSL	FWL	
Depth of Deviation		Radius of Turn		Direction		Total Length
Measured Total Depth	True Vertical Depth		End Pt Location From Lease, Unit or Property Line:			

**LATERAL #3**

SEC	TWP	RGE	COUNTY	Feet From 1/4 Sec Lines		
1/4	1/4	1/4	1/4	FSL	FWL	
Depth of Deviation		Radius of Turn		Direction		Total Length
Measured Total Depth	True Vertical Depth		End Pt Location From Lease, Unit or Property Line:			