

Oklahoma Corporation Commission
 Oil & Gas Conservation Division
 Post Office Box 52000
 Oklahoma City, Oklahoma 73152-2000
 Rule 165: 10-3-25

Form 1002A

API No.: 35119239320000

Completion Report

Spud Date: May 07, 2012

OTC Prod. Unit No.:

Drilling Finished Date: May 21, 2012

1st Prod Date: July 27, 2012

Completion Date: August 31, 2012

Drill Type: HORIZONTAL HOLE

Min Gas Allowable: Yes

Well Name: COLE 1-13H

Purchaser/Measurer: SUPERIOR

Location: PAYNE 13 18N 2E
 NE NW NE NE
 2355 FSL 1825 FWL of 1/4 SEC
 Derrick Elevation: 0 Ground Elevation: 965

First Sales Date: 09/01/2012

Operator: TRUEVINE OPERATING LLC 22516
 P.O. Box 1422
 703 N BROADWAY STE 1
 ADA, OK 74821-1422

Completion Type	
X	Single Zone
	Multiple Zone
	Commingled

Location Exception
Order No
There are no Location Exception records to display.

Increased Density
Order No
There are no Increased Density records to display.

Casing and Cement							
Type	Size	Weight	Grade	Feet	PSI	SAX	Top of CMT
CONDUCTOR	16			40		3	SURFACE
SURFACE	9 5/8	36	L/S	495	1200	250	SURFACE
PRODUCTION	7	26	J-58	4762	350	75	500

Liner								
Type	Size	Weight	Grade	Length	PSI	SAX	Top Depth	Bottom Depth
There are no Liner records to display.								

Total Depth: 6802

Packer	
Depth	Brand & Type
There are no Packer records to display.	

Plug	
Depth	Plug Type
There are no Plug records to display.	

Initial Test Data										
Test Date	Formation	Oil BBL/Day	Oil-Gravity (API)	Gas MCF/Day	Gas-Oil Ratio Cu FT/BBL	Water BBL/Day	Pumpin or Flowing	Initial Shut-In Pressure	Choke Size	Flow Tubing Pressure
Jul 27, 2012	MISSISSIPPIAN	5	41			600	PUMPING			

Completion and Test Data by Producing Formation										
Formation Name: MISSISSIPPIAN			Code: 359MSSP			Class: OIL				
Spacing Orders				Perforated Intervals						
Order No	Unit Size			From			To			
593299	640			There are no Perf. Intervals records to display.						
Acid Volumes				Fracture Treatments						
20,500 GALLONS 15% HCL				5,000 BARRELS SLICK WATER						

Formation	Top
SKINNER	4144
RED FORK	4193
BARTLESVILLE	4285
MISSISSIPPI	4375

Were open hole logs run? No

Date last log run:

Were unusual drilling circumstances encountered? Yes

Explanation: DRILLED INTO A FAULT OR FRACTURE, LOST CIRCULATION TOTALLY AND STOPPED LATERAL AT THAT POINT.

Other Remarks
There are no Other Remarks.

Lateral Holes
Sec: 13 TWP: 18N RGE: 2E County: PAYNE
NE NW NE NE
2324 FSL 1839 FWL of 1/4 SEC
Depth of Deviation: 3813 Radius of Turn: 572 Direction: 179 Total Length: 2223
Measured Total Depth: 6802 True Vertical Depth: 4442 End Pt. Location From Release, Unit or Property Line: 801

FOR COMMISSION USE ONLY
Status: Accepted
1116421

AS SUBMITTED

RECEIVED

Form 1002A
Rev. 2009

API NO. 119 23932
OTC PROD. UNIT NO. 22516

PLEASE TYPE OR USE BLACK NOTE:

Attach copy of original 10 if recompletion or reent

Rule 165.10-3-25

SEP 28 2012

OKLAHOMA CORPORATION COMMISSION

ORIGINAL
 AMENDED (Reason)

COMPLETION REPORT

TYPE OF DRILLING OPERATION

STRAIGHT HOLE DIRECTIONAL HOLE HORIZONTAL HOLE
 SERVICE WELL

If directional or horizontal, see reverse for bottom hole location.

COUNTY PAYNE SEC 13 TWP 18N RGE 02E
LEASE NAME COLE
WELL NO. 1-13H
DATE OF WELL COMPLETION 08/31/2012
1st PROD DATE 07/27/2012
RECOMP DATE
ELEVATION Ground 965
Latitude (if known)
Longitude (if known)
OPERATOR NAME TRUEVINE OPERATING, LLC OTC/OCC OPERATOR NO. 22516
ADDRESS P.O. BOX 1422
CITY ADA STATE OK ZIP 74821

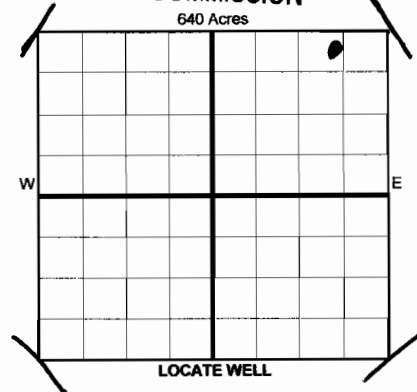

COMPLETION TYPE

SINGLE ZONE
 MULTIPLE ZONE
Application Date
 COMMINGLED
Application Date
LOCATION
EXCEPTION ORDER
INCREASED DENSITY
ORDER NO.

CASING & CEMENT (Form 1002C must be attached)

TYPE	SIZE	WEIGHT	GRADE	FEET	PSI	SAX	TOP OF CMT
CONDUCTOR	16			40		3yds	surface
SURFACE	9 5/8	36	L/S	495	1200	250	SURFACE
INTERMEDIATE	7	26	J58	4,762	350	75	500
PRODUCTION							
LINER							
TOTAL DEPTH							6,802

PACKER @ BRAND & TYPE PLUG @ TYPE PLUG @ TYPE
PACKER @ BRAND & TYPE PLUG @ TYPE PLUG @ TYPE

COMPLETION & TEST DATA BY PRODUCING FORMATION

FORMATION	MISSISSIPPIAN
SPACING & SPACING ORDER NUMBER	593299
CLASS: Oil, Gas, Dry, Inj, Disp, Comm Disp, Svc	OIL
PERFORATED INTERVALS	OPEN HOLE
ACID/VOLUME	15% HCL/20,500 gals
FRACTURE TREATMENT (Fluids/Prop Amounts)	5000 bbls sl water

Min Gas Allowable (165:10-17-7) OR Gas Purchaser/Measurer Superior
Oil Allowable (165:10-13-3) OR First Sales Date 9/1/2012

INITIAL TEST DATA

INITIAL TEST DATE	7/27/2012
OIL-BBL/DAY	5
OIL-GRAVITY (API)	41
GAS-MCF/DAY	0
GAS-OIL RATIO CU FT/BBL	0
WATER-BBL/DAY	600
PUMPING OR FLOWING	PUMPING
INITIAL SHUT-IN PRESSURE	0
CHOKE SIZE	NONE
FLOW TUBING PRESSURE	0

A record of the formations drilled through, and pertinent remarks are presented on the reverse. I declare that I have knowledge of the contents of this report and am authorized by my organization to make this report, which was prepared by me or under my supervision and direction, with the data and facts stated herein to be true, correct, and complete to the best of my knowledge and belief.

Mike E. Flowers
SIGNATURE

MIKE E. FLOWERS
NAME (PRINT OR TYPE)

9/25/2012 580-427-7919
DATE PHONE NUMBER

PO BOX 1422
ADDRESS

ADA OK 74821
CITY STATE ZIP

truevine.operating@gmail.com
EMAIL ADDRESS

PLEASE TYPE OR USE BLACK INK ONLY
FORMATION RECORD

Give formation names and tops, if available, or descriptions and thickness of formations drilled through. Show intervals cored or drillstem tested.

NAMES OF FORMATIONS	TOP
SKINNER	4,144
REDFORK	4193
BARTLESVILLE	4,285
MISSISSIPPI	4,375

LEASE NAME COLE WELL NO. 1-13H

FOR COMMISSION USE ONLY

ITD on file YES NO

APPROVED _____ DISAPPROVED _____

2) Reject Codes

Were open hole logs run? yes no

Date Last log was run _____

Was CO₂ encountered? yes no at what depths? _____

Was H₂S encountered? yes no at what depths? _____

Were unusual drilling circumstances encountered? yes no
If yes, briefly explain below

Other remarks: DRILLED INTO A FAULT OR FRACTURE, LOST CIRCULATION TOTALLY AND STOPPED LATERAL AT THAT POINT.

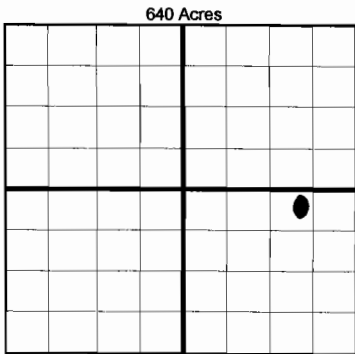

If more than three drainholes are proposed, attach a separate sheet indicating the necessary information.

Direction must be stated in degrees azimuth. Please note, the horizontal drainhole and its end point must be located within the boundaries of the lease or spacing unit.

Directional surveys are required for all drainholes and directional wells.

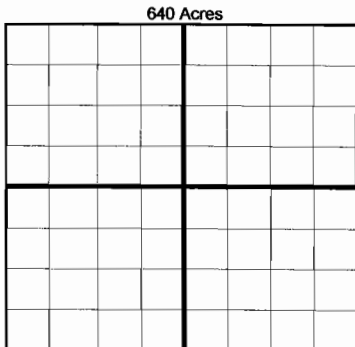

BOTTOM HOLE LOCATION FOR DIRECTIONAL HOLE

SEC	TWP	RGE	COUNTY	Feet From 1/4 Sec Lines	FSL	FWL
Spot Location	1/4	1/4	1/4	1/4		
Measured Total Depth	True Vertical Depth		BHL From Lease, Unit, or Property Line:			

BOTTOM HOLE LOCATION FOR HORIZONTAL HOLE: (LATERALS)

LATERAL #1

SEC	TWP	RGE	COUNTY	Feet From 1/4 Sec Lines	FSL	FWL
13	18N	02E	PAYNE		2324	1839
Spot Location	1/4	NW	1/4	NE	1/4	NE
Depth of Deviation	3,813		Radius of Turn	572		Direction
				179		Total Length
						2,223
Measured Total Depth	6,802		True Vertical Depth	4,442		BHL From Lease, Unit, or Property Line:
						801

LATERAL #2

SEC	TWP	RGE	COUNTY	Feet From 1/4 Sec Lines	FSL	FWL
Spot Location	1/4	1/4	1/4	1/4		
Depth of Deviation	Radius of Turn		Direction		Total Length	
Measured Total Depth	True Vertical Depth		BHL From Lease, Unit, or Property Line:			

LATERAL #3

SEC	TWP	RGE	COUNTY	Feet From 1/4 Sec Lines	FSL	FWL
Spot Location	1/4	1/4	1/4	1/4		
Depth of Deviation	Radius of Turn		Direction		Total Length	
Measured Total Depth	True Vertical Depth		BHL From Lease, Unit, or Property Line:			