

Oklahoma Corporation Commission
 Oil & Gas Conservation Division
 Post Office Box 52000
 Oklahoma City, Oklahoma 73152-2000
 Rule 165: 10-3-25

Form 1002A

API No.: 35117234670000

Completion Report

Spud Date: April 21, 2012

OTC Prod. Unit No.:

Drilling Finished Date: May 03, 2012

1st Prod Date:

Completion Date: June 12, 2012

Drill Type: STRAIGHT HOLE

SERVICE WELL

Well Name: CARNES 1-6 SWD

Purchaser/Measurer:

Location: PAWNEE 6 20N 7E
 NW SW SW SW
 468 FSL 206 FWL of 1/4 SEC
 Derrick Elevation: 959 Ground Elevation: 945

First Sales Date:

Operator: NEW GULF RESOURCES LLC 22815

6310 E 102ND ST
 TULSA, OK 74137-7061

Completion Type	
X	Single Zone
	Multiple Zone
	Commingled

Location Exception
Order No
There are no Location Exception records to display.

Increased Density
Order No
There are no Increased Density records to display.

Casing and Cement							
Type	Size	Weight	Grade	Feet	PSI	SAX	Top of CMT
SURFACE	9 5/8	36	J-55	558	700	240	SURFACE
PRODUCTION	7	23	J-55	3550	1500	250	2975

Liner								
Type	Size	Weight	Grade	Length	PSI	SAX	Top Depth	Bottom Depth
There are no Liner records to display.								

Total Depth: 4655

Packer	
Depth	Brand & Type
There are no Packer records to display.	

Plug	
Depth	Plug Type
There are no Plug records to display.	

Initial Test Data										
Test Date	Formation	Oil BBL/Day	Oil-Gravity (API)	Gas MCF/Day	Gas-Oil Ratio Cu FT/BBL	Water BBL/Day	Pumpin or Flowing	Initial Shut-In Pressure	Choke Size	Flow Tubing Pressure
There are no Initial Data records to display.										

Completion and Test Data by Producing Formation										
Formation Name: ARBUCKLE			Code: 169ABCK				Class: DISP			
Spacing Orders					Perforated Intervals					
Order No		Unit Size			From			To		
There are no Spacing Order records to display.					There are no Perf. Intervals records to display.					
Acid Volumes					Fracture Treatments					
15% HCL					There are no Fracture Treatments records to display.					

Formation	Top
CHECKERBOARD	2114
OSWEGO	2514
VERDIGRIS	2640
RED FORK	2780
MISSISSIPPI	3030
WOODFORD	3154
SIMPSON	3209
ARBUCKLE	3500
GRANITE WASH	4632

Were open hole logs run? Yes
Date last log run: April 28, 2012

Were unusual drilling circumstances encountered? No
Explanation:

Other Remarks
OCC - UIC PERMIT NUMBER 1206970037. THIS WELL IS AN OPEN HOLE COMPLETION FROM BOTTOM OF THE 7" CASING AT 3,545' TO TOTAL DEPTH 4,655'.

FOR COMMISSION USE ONLY	
Status: Accepted	1116285

117-23467

RECEIVED

Form 1002A Rev. 2009

SEP 18 2012

OKLAHOMA CORPORATION COMMISSION

API NO. 117-25467
OTC PROD.
UNIT NO.

PLEASE TYPE OR USE BLOCK LETTERS
NOTE:
Attach copy of original if recompletion or

AS SUBMITTED

ORIGINAL
 AMENDED (Reason)

COMPLETION REPORT

TYPE OF DRILLING OPERATION
 STRAIGHT HOLE DIRECTIONAL HOLE HORIZONTAL HOLE
 SERVICE WELL
If directional or horizontal, see reverse for bottom hole location.

SPUD DATE 4-23-12
DRLG FINISHED DATE 5-3-12
DATE OF WELL COMPLETION 6-12-12
1st PROD DATE
RECOMP DATE
Longitude (if known)
Latitude (if known)

COUNTY Pawnee SEC 06 TWP 20N RGE 07E
LEASE NAME Carnes SWD
WELL NO. 1-6
N 1/4 SW 1/4 SW 1/4 SW 1/4 FSL OF 1/4 SEC 468' FWL OF 1/4 SEC 206'
ELEVATION 959 Ground 945
OPERATOR NAME New Gulf Resources, LLC OTC/OCC OPERATOR NO. 22815
ADDRESS 6310 E. 102nd St.
CITY Tulsa STATE OK ZIP 74137

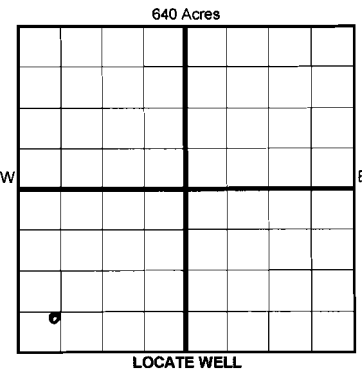

COMPLETION TYPE
 SINGLE ZONE
 MULTIPLE ZONE
Application Date
 COMMINGLED
Application Date
LOCATION
EXCEPTION ORDER
INCREASED DENSITY
ORDER NO.

CASING & CEMENT (Form 1002C must be attached)

TYPE	SIZE	WEIGHT	GRADE	FEET	PSI	SAX	TOP OF CMT
CONDUCTOR							
SURFACE	9&5/8	36#	J55	558'	700	241	Ground
INTERMEDIATE							
PRODUCTION	7	23#	J55	3545'	1500	250	2975
LINER							
TOTAL DEPTH							4655

PACKER @ _____ BRAND & TYPE _____ PLUG @ _____ TYPE _____ PLUG @ _____ TYPE _____
PACKER @ _____ BRAND & TYPE _____ PLUG @ _____ TYPE _____ PLUG @ _____ TYPE _____

COMPLETION & TEST DATA BY PRODUCING FORMATION

FORMATION	Arbuckle						
SPACING & SPACING ORDER NUMBER	N/A						
CLASS: Oil, Gas, Dry, Inj, Disp, Comm Disp, Svc	Disp-1206970037						
PERFORATED INTERVALS	open hole						
ACID/VOLUME	15%HCL						
FRACTURE TREATMENT (Fluids/Prop Amounts)							

Min Gas Allowable (165:10-17-7) OR Gas Purchaser/Measurer First Sales Date
 Oil Allowable (165:10-13-3)

INITIAL TEST DATA

INITIAL TEST DATE	6-12-12				
OIL-BBL/DAY	0				
OIL-GRAVITY (API)	0				
GAS-MCF/DAY	0				
GAS-OIL RATIO CU FT/BBL	0				
WATER-BBL/DAY	0				
PUMPING OR FLOWING	Disposal				
INITIAL SHUT-IN PRESSURE	89#	5min 0#	10min 0#	15min 0#	
CHOKER SIZE					
FLOW TUBING PRESSURE					

SCANNED

A record of the formations drilled through, and pertinent remarks are presented on the reverse. I declare that I have knowledge of the contents of this report and am authorized by my organization to make this report, which was prepared by me or under my supervision and direction, with the data and facts stated herein to be true, correct, and complete to the best of my knowledge and belief.
Signature: Laurie Rush NAME (PRINT OR TYPE): Laurie Rush DATE: 9-17-2012 PHONE NUMBER: 728.3020
ADDRESS: 6310 E 102ND ST. Tulsa CITY: OK STATE: OK ZIP: 74137 EMAIL ADDRESS: Lrush@Newgulfresources.com

PLEASE TYPE OR USE BLACK INK ONLY
FORMATION RECORD

Give formation names and tops, if available, or descriptions and thickness of formations drilled through. Show intervals cored or drillstem tested.

LEASE NAME Carnes SWD

WELL NO. 1-6

NAMES OF FORMATIONS	TOP
Checkerboard	2114
Oswego	2514
Verigris	2640
Redfork	2780
Miss	3030
Woodford	3154
Simpson	3209
Arbuckle	3500
Granite Wash	4632

FOR COMMISSION USE ONLY

ITD on file YES NO

APPROVED _____ DISAPPROVED _____

2) Reject Codes _____

Were open hole logs run? yes no

Date Last log was run 04-29-2012

Was CO₂ encountered? yes no at what depths? _____

Was H₂S encountered? yes no at what depths? _____

Were unusual drilling circumstances encountered? yes no

If yes, briefly explain below _____

Other remarks:

OCC- UIC permit 1206970037
This well is an open hole completion from bottom of the 7" casing at 3545' to total Depth 4655

640 Acres

If more than three drainholes are proposed, attach a separate sheet indicating the necessary information.

Direction must be stated in degrees azimuth. Please note, the horizontal drainhole and its end point must be located within the boundaries of the lease or spacing unit.

Directional surveys are required for all drainholes and directional wells.

640 Acres

BOTTOM HOLE LOCATION FOR DIRECTIONAL HOLE

SEC	TWP	RGE	COUNTY	Spot Location		Feet From 1/4 Sec Lines	FSL	FWL
				1/4	1/4	1/4	1/4	
Measured Total Depth		True Vertical Depth		BHL From Lease, Unit, or Property Line:				

BOTTOM HOLE LOCATION FOR HORIZONTAL HOLE: (LATERALS)

LATERAL #1

SEC	TWP	RGE	COUNTY	Spot Location		Feet From 1/4 Sec Lines	FSL	FWL
				1/4	1/4	1/4	1/4	
Depth of Deviation		Radius of Turn		Direction		Total Length		
Measured Total Depth		True Vertical Depth		BHL From Lease, Unit, or Property Line:				

LATERAL #2

SEC	TWP	RGE	COUNTY	Spot Location		Feet From 1/4 Sec Lines	FSL	FWL
				1/4	1/4	1/4	1/4	
Depth of Deviation		Radius of Turn		Direction		Total Length		
Measured Total Depth		True Vertical Depth		BHL From Lease, Unit, or Property Line:				

LATERAL #3

SEC	TWP	RGE	COUNTY	Spot Location		Feet From 1/4 Sec Lines	FSL	FWL
				1/4	1/4	1/4	1/4	
Depth of Deviation		Radius of Turn		Direction		Total Length		
Measured Total Depth		True Vertical Depth		BHL From Lease, Unit, or Property Line:				

