

Oklahoma Corporation Commission  
 Oil & Gas Conservation Division  
 Post Office Box 52000  
 Oklahoma City, Oklahoma 73152-2000  
 Rule 165: 10-3-25

Form 1002A

API No.: 35045230860000

**Completion Report**

Spud Date: February 15, 2012

OTC Prod. Unit No.: 045-207987

Drilling Finished Date: March 19, 2012

1st Prod Date: June 01, 2012

Completion Date: June 01, 2012

**Drill Type: HORIZONTAL HOLE**

Well Name: DUNN 6-27H

Purchaser/Measurer:

Location: ELLIS 27 17N 24W  
 NE SW SW SW  
 475 FSL 610 FWL of 1/4 SEC  
 Derrick Elevation: 2280 Ground Elevation: 2257

First Sales Date:

Operator: CRAWLEY PETROLEUM CORPORATION 7980

105 N HUDSON AVE STE 800  
 OKLAHOMA CITY, OK 73102-4803

Completion Type	
X	Single Zone
	Multiple Zone
	Commingled

Location Exception	
Order No	
596986	

Increased Density	
Order No	
587013	

Casing and Cement							
Type	Size	Weight	Grade	Feet	PSI	SAX	Top of CMT
SURFACE	13 3/8	48	H-40 STC	670		540	SURFACE
INTERMEDIATE	9 5/8	40	L-80 / J-55	5843		645	SURFACE
PRODUCTION	5 1/2	17	P-110	12385		120	7000

Liner								
Type	Size	Weight	Grade	Length	PSI	SAX	Top Depth	Bottom Depth
There are no Liner records to display.								

**Total Depth: 12385**

Packer	
Depth	Brand & Type
There are no Packer records to display.	

Plug	
Depth	Plug Type
There are no Plug records to display.	

Initial Test Data										
Test Date	Formation	Oil BBL/Day	Oil-Gravity (API)	Gas MCF/Day	Gas-Oil Ratio Cu FT/BBL	Water BBL/Day	Pumpin or Flowing	Initial Shut-In Pressure	Choke Size	Flow Tubing Pressure
Jun 13, 2012	TONKAWA	403		996	2472	300	GAS LIFT			190

Completion and Test Data by Producing Formation										
Formation Name: TONKAWA			Code: 406TNKW			Class: OIL				
<b>Spacing Orders</b>				<b>Perforated Intervals</b>						
<b>Order No</b>	<b>Unit Size</b>			<b>From</b>			<b>To</b>			
62327	640			There are no Perf. Intervals records to display.						
<b>Acid Volumes</b>				<b>Fracture Treatments</b>						
There are no Acid Volume records to display.				59,103 BW, 2,628,300 POUNDS 20/40 WHITE SAND						

Formation	Top
TONKAWA	8493

Were open hole logs run? No

Date last log run:

Were unusual drilling circumstances encountered? No

Explanation:

Other Remarks
OCC - PER THE OPERATOR THIS WELL IS AN OPEN HOLE COMPLETION BELOW WHERE A DV TOOL WAS SET AT 7616' TO TERMINUS AT 12385' THE CEMENT WAS LIFTED FROM THE DV TOOL UP TO APPROX. 7000' BUT FROM THE DV TOOL DOWN IT IS NOT CEMENTED.

Lateral Holes
Sec: 27 TWP: 17N RGE: 24W County: ELLIS NW NW NW 361 FSL 535 FWL of 1/4 SEC Depth of Deviation: 7502 Radius of Turn: 10 Direction: 360 Total Length: 3924 Measured Total Depth: 12385 True Vertical Depth: 8148 End Pt. Location From Release, Unit or Property Line: 2279

FOR COMMISSION USE ONLY
Status: Accepted
1115296

APIT NO. **045-23086**  
 OTC PROD. UNIT NO. **045-207987**

PLEASE TYPE OR U  
 NOTE:  
 Attach copy of original



REGISTRATION COMMISSION  
 Regulation Division  
 Box 52000  
 Oklahoma 73152-2000  
 0-3-25

**RECEIVED** Form 1002A  
 Rev. 2007

JUL 02 2012

OKLAHOMA CORPORATION  
 COMMISSION

ORIGINAL  
 AMENDED  
 Reason Amended

TYPE OF DRILLING OPERATION  
 STRAIGHT HOLE  DIRECTIONAL HOLE  HORIZONTAL HOLE  
 SERVICE WELL

If directional or horizontal, see reverse for bottom hole location.

COUNTY **ELLIS** SEC **27** TWP **17N** RGE **24W**  
 LEASE NAME **DUNN** WELL NO. **6-27H**  
 SHL **NE 1/4 SW 1/4 SW 1/4 SW 1/4** FSL **475** FWL OF 1/4 SEC **610**  
 ELEVATION Derrick Fl **2280** Ground **2257** Latitude if Known **35°54'45.2"N** Longitude if Known **99°45'09.9"W**  
 OPERATOR NAME **CRAWLEY PETROLEUM CORPORATION** OTC/OCC OPERATOR NO. **07980**  
 ADDRESS **105 N. HUDSON, STE. 800**  
 CITY **OKLAHOMA CITY** STATE **OK** ZIP **73102-4803**

640 Acres

LOCATE WELL

COMPLETION TYPE  
 SINGLE ZONE  
 MULTIPLE ZONE  
 Application Date  
 COMMINGLED  
 Application Date  
 LOCATION EXCEPTION ORDER NO. **587303**  
 INCREASED DENSITY ORDER NO. **587013**

CASING & CEMENT (Form 1002C must be attached)

TYPE	SIZE	WEIGHT	GRADE	FEET	PSI	SAX	TOP
Conductor							
Surface	13-3/8"	48#	H-40 STC	670		540	SURFACE
Intermediate	9-5/8"	40#	L-80/J-55	5843		645	SURFACE
Production	5-1/2"	17#	P-110	12,385		120	Approx. 7,000
Liner							

PACKER @ \_\_\_\_\_ BRAND & TYPE \_\_\_\_\_ PLUG @ \_\_\_\_\_ TYPE \_\_\_\_\_ PLUG @ \_\_\_\_\_ TYPE \_\_\_\_\_ TOTAL DEPTH **12,385**  
 PACKER @ \_\_\_\_\_ BRAND & TYPE \_\_\_\_\_ PLUG @ \_\_\_\_\_ TYPE \_\_\_\_\_ PLUG @ \_\_\_\_\_ TYPE \_\_\_\_\_

COMPLETION & TEST DATA BY PRODUCING FORMATION **4067NKW**

FORMATION	SPACING & SPACING ORDER NUMBER	CLASS: Oil, Gas, Dry, Inj, Disp, Comm Disp, Svc	PERFORATED INTERVALS	ACID/VOLUME Fracture Treatment (Fluids/Prop Amounts)
<b>TONKAWA</b>	<b>640 ACRES; 62327</b>	<b>Oil</b>	<b>OPEN HOLE</b> <b>COMPLETION</b>	<b>59,103 BW</b> <b>2,628,300# 20/40 WHITE SAND</b>

INITIAL TEST DATA  Request minimum gas allowable (165:10-17-7) Gas Purchaser/Measurer \_\_\_\_\_ 1st Sales Date \_\_\_\_\_

INITIAL TEST DATE	<b>6/13/2012</b>
OIL-BBL/DAY	<b>403 BO</b>
OIL-GRAVITY ( API)	
GAS-MCF/DAY	<b>996 MCF</b>
GAS-OIL RATIO CU FT/BBL	<b>2472;1</b>
WATER-BBL/DAY	<b>300 BW</b>
PUMPING OR FLOWING	<b>GAS LIFT</b>
INITIAL SHUT-IN PRESSURE	
CHOKE SIZE	
FLOW TUBING PRESSURE	<b>190#</b>

A record of the formations drilled through, and pertinent remarks are presented on the reverse. I declare that I have knowledge of the contents of this report and am authorized by my organization to make this report, which was prepared by me or under my supervision and direction, with the data and facts stated herein to be true, correct, and complete to the best of my knowledge and belief.

*Paula Wehling*  
 SIGNATURE  
 105 N. Hudson, Ste. 800  
 ADDRESS

Paula Wehling / Regulatory Compliance Analyst  
 NAME (PRINT OR TYPE)  
 OKC CITY OK STATE 73102-4803 ZIP  
 paulaw@crawleypetroleum.com  
 EMAIL ADDRESS

*6/28/2012*  
 DATE  
 405-232-9700  
 PHONE NUMBER

PLEASE TYPE OR USE BLACK INK ONLY  
FORMATION RECORD

Give formation names and tops, if available, or descriptions and thickness of formations drilled through. Show intervals cored or drillstem tested.

LEASE NAME DUNN WELL NO. 6-27H

NAMES OF FORMATIONS	TOP
TONKAWA	<del>8040</del> 8973 per Paula

FOR COMMISSION USE ONLY

ITD on file  YES  NO

APPROVED \_\_\_\_\_ DISAPPROVED \_\_\_\_\_

2) Reject Codes \_\_\_\_\_

were open hole logs run? yes  no

Date Last log was run \_\_\_\_\_

was CO<sub>2</sub> encountered? yes  no  at what depths? \_\_\_\_\_

was H<sub>2</sub>S encountered? yes  no  at what depths? \_\_\_\_\_

were unusual drilling circumstances encountered? \_\_\_\_\_ yes  no   
If yes, briefly explain. \_\_\_\_\_

Other remarks: \_\_\_\_\_

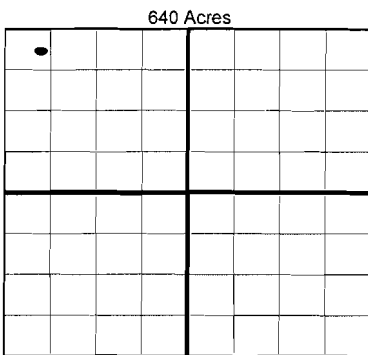

**BOTTOM HOLE LOCATION FOR DIRECTIONAL HOLE**

SEC	TWP	RGE	COUNTY				
Spot Location	1/4	1/4	1/4	1/4	Feet From 1/4 Sec Lines	FSL	FWL
Measured Total Depth	True Vertical Depth		BHL From Lease, Unit, or Property Line:				

**BOTTOM HOLE LOCATION FOR HORIZONTAL HOLE: (LATERALS)**

**LATERAL #1**

SEC	TWP	RGE	COUNTY						
27	17N	24W	ELLIS						
Spot Location	1/4	NW 1/4	NW 1/4	NW 1/4	Feet From 1/4 Sec Lines	361	FSL	535.4	FWL
Depth of Deviation	7502	Radius of Turn	10°	Direction	360	Total Length	3924		
Measured Total Depth	12,385	True Vertical Depth	8148.42	End Pt Location From Lease, Unit or Property Line:					
				2279' FSL & 2104.6' FEL					

If more than three drainholes are proposed, attach a separate sheet indicating the necessary information.

Direction must be stated in degrees azimuth. Please note, the horizontal drainhole and its end point must be located within the boundaries of the lease or spacing unit.

**Directional surveys are required for all drainholes and directional wells.**

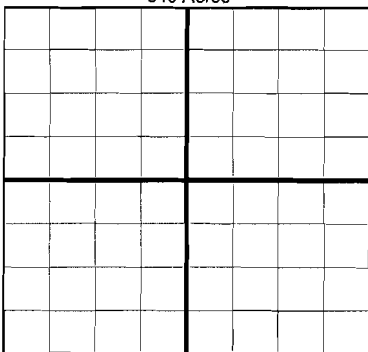

**LATERAL #2**

SEC	TWP	RGE	COUNTY				
Spot Location	1/4	1/4	1/4	1/4	Feet From 1/4 Sec Lines	FSL	FWL
Depth of Deviation	Radius of Turn		Direction	Total Length			
Measured Total Depth	True Vertical Depth	End Pt Location From Lease, Unit or Property Line:					

**LATERAL #3**

SEC	TWP	RGE	COUNTY			
Spot Location	1/4	1/4	1/4	Feet From 1/4 Sec Lines	FSL	FWL
Depth of Deviation	Radius of Turn		Direction	Total Length		
Measured Total Depth	True Vertical Depth	End Pt Location From Lease, Unit or Property Line:				