

Oklahoma Corporation Commission
Oil & Gas Conservation Division
Post Office Box 52000
Oklahoma City, Oklahoma 73152-2000
Rule 165: 10-3-25

Form 1002A

API No.: 35103242810000

Completion Report

Spud Date: May 17, 2011

OTC Prod. Unit No.: 103-206287

Drilling Finished Date: June 17, 2011

1st Prod Date: August 16, 2011

Completion Date: August 15, 2011

Drill Type: HORIZONTAL HOLE

Well Name: ICEMAN 1-20H

Purchaser/Measurer:

Location: NOBLE 17 23N 2E
SE SE SE SE
200 FSL 2360 FWL of 1/4 SEC
Derrick Elevation: 957 Ground Elevation: 941

First Sales Date:

Operator: TERRITORY RESOURCES LLC 22388

1511 S SANGRE RD
STILLWATER, OK 74074-1869

Completion Type	
X	Single Zone
	Multiple Zone
	Commingled

Location Exception	
Order No	
589510	

Increased Density	
Order No	
There are no Increased Density records to display.	

Casing and Cement							
Type	Size	Weight	Grade	Feet	PSI	SAX	Top of CMT
SURFACE	9 5/8	36	J-55	249		150	SURFACE
PRODUCTION	7	26	J-55	5341		500	2500

Liner								
Type	Size	Weight	Grade	Length	PSI	SAX	Top Depth	Bottom Depth
LINER	4 1/2	11.6	P-110	3686	0	300	5316	9002

Total Depth: 9005

Packer	
Depth	Brand & Type
There are no Packer records to display.	

Plug	
Depth	Plug Type
There are no Plug records to display.	

Initial Test Data										
Test Date	Formation	Oil BBL/Day	Oil-Gravity (API)	Gas MCF/Day	Gas-Oil Ratio Cu FT/BBL	Water BBL/Day	Pumpin or Flowing	Initial Shut-In Pressure	Choke Size	Flow Tubing Pressure
Sep 10, 2011	MISSISSIPPIAN	414	42	236	570	1516	PUMPING	2050		

Completion and Test Data by Producing Formation										
Formation Name: MISSISSIPPIAN			Code: 359MSSP			Class: OIL				
Spacing Orders				Perforated Intervals						
Order No	Unit Size			From			To			
585784	640			5360			8996			
Acid Volumes				Fracture Treatments						
245,000 GALLONS 15% HCL				120,250 BARRELS WATER, 299,500 POUNDS SAND						

Formation	Top
OSWEGO	3636
SKINNER	3901
PINK LIME	4002
MISSISSIPPI	4531

Were open hole logs run? Yes
Date last log run: June 16, 2011

Were unusual drilling circumstances encountered? No
Explanation:

Other Remarks
There are no Other Remarks.

Lateral Holes
Sec: 20 TWP: 23N RGE: 2E County: NOBLE NW SE SE SE 397 FSL 2273 FWL of 1/4 SEC Depth of Deviation: 3405 Radius of Turn: 980 Direction: 180 Total Length: 3717 Measured Total Depth: 8997 True Vertical Depth: 4385 End Pt. Location From Release, Unit or Property Line: 367

FOR COMMISSION USE ONLY
Status: Accepted
1113638

AS SUBMITTED

RECEIVED

FEB 10 2012

OMMA CORPORATION
COMMISSION

API NO. 103-24281
OTC PROD. UNIT NO. 103-206287

PLEASE TYPE OR USE BLACK INK ONLY
NOTE:

Attach copy of original 1002A
if recompletion or reentry.

ORIGINAL
 AMENDED (Reason)

Rule 165.10-3-25

COMPLETION REPORT

TYPE OF DRILLING OPERATION
 STRAIGHT HOLE DIRECTIONAL HOLE HORIZONTAL HOLE
 SERVICE WELL

SPUD DATE 5/17/2011
DRLG FINISHED DATE 6/17/2011
DATE OF WELL COMPLETION 8/15/2011
1st PROD DATE 8/16/2011
RECOMP DATE
Longitude (if known) 97*06'17"

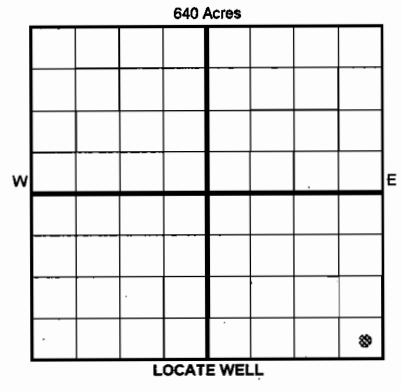

County Noble SEC 17 TWP 23N RGE 2E
LEASE NAME Iceman WELL NO. 1-20H
SE 1/4 SE 1/4 SE 1/4 SE 1/4 FSL OF 1/4 SEC 200 FWL OF 1/4 SEC 2360
ELEVATION 957' Ground 941 Latitude (if known) 36*27'51" Longitude (if known) 97*06'17"
OPERATOR NAME Territory Resources, LLC OTC/OCC OPERATOR NO. 22388
ADDRESS 1511 S. Sangre Road
CITY Stillwater STATE OK ZIP 74074

COMPLETION TYPE
 SINGLE ZONE
 MULTIPLE ZONE
 COMMINGLED
LOCATION EXCEPTION ORDER NO
INCREASED DENSITY ORDER NO

CASING & CEMENT (Form 1002C must be attached)							
TYPE	SIZE	WEIGHT	GRADE	FEET	PSI	SAX	TOP OF CMT
CONDUCTOR							
SURFACE	9 5/8"	36#	J-55	230 (GL)		150	Surface
INTERMEDIATE							
PRODUCTION	7"	26#	J-55	5339' (KB)		500	2500
LINER	4 1/2"	11.6#	P110	5316'-9002' (KB)		310	5326'
						TOTAL DEPTH	9,005

PACKER @ _____ BRAND & TYPE _____ PLUG @ _____ TYPE _____ PLUG @ _____ TYPE _____
PACKER @ _____ BRAND & TYPE _____ PLUG @ _____ TYPE _____ PLUG @ _____ TYPE _____

COMPLETION & TEST DATA BY PRODUCING FORMATION *359MSSP*

FORMATION	Mississippi <i>Dean</i>						
SPACING & SPACING ORDER NUMBER	585784 <i>(640)</i>						
CLASS: Oil, Gas, Dry, Inj, Disp, Comm Disp, Svc	Oil						
PERFORATED INTERVALS	5360'-8997'						
ACID/VOLUME	15% HCl/245,000 gal						
FRACTURE TREATMENT (Fluids/Prop Amounts)	120,250bbls Wtr. 299,500# sand						

Min Gas Allowable (165:10-17-7) OR Gas Purchaser/Measurer First Sales Date
 Oil Allowable (165:10-13-3)

INITIAL TEST DATE	9/10/2011				
OIL-BBL/DAY	414				
OIL-GRAVITY (API)	42				
GAS-MCF/DAY	236				
GAS-OIL RATIO CU FT/BBL	570				
WATER-BBL/DAY	1516				
PUMPING OR FLOWING	Pump				
INITIAL SHUT-IN PRESSURE	2,050				
CHOKE SIZE	N/A				
FLOW TUBING PRESSURE	N/A				

A record of the formations drilled through, and pertinent remarks are presented on the reverse. I declare that I have knowledge of the contents of this report and am authorized by my organization to make this report, which was prepared by me or under my supervision and direction, with the data and facts stated herein to be true, correct, and complete to the best of my knowledge and belief.

Ed Gallegos
SIGNATURE Ed Gallegos NAME (PRINT OR TYPE) 2/9/12 DATE 405/533-1300 PHONE NUMBER
1511 S. Sangre Road ADDRESS Stillwater CITY OK STATE 74074 ZIP janet@territoryllc.com EMAIL ADDRESS

