

Oklahoma Corporation Commission
Oil & Gas Conservation Division
Post Office Box 52000
Oklahoma City, Oklahoma 73152-2000
Rule 165: 10-3-25

Form 1002A

API No.: 35003220480000

Completion Report

Spud Date: April 24, 2011

OTC Prod. Unit No.: 003-206266

Drilling Finished Date: May 17, 2011

1st Prod Date: September 01, 2011

Completion Date: June 11, 2011

Drill Type: HORIZONTAL HOLE

Min Gas Allowable: Yes

Well Name: SCHANBACHER 2-25-12 1H

Purchaser/Measurer: CHESAPEAKE OPERATING INC

Location: ALFALFA 2 25N 12W
SW SE SW SW
200 FNL 760 FWL of 1/4 SEC
Derrick Elevation: 1359 Ground Elevation: 1342

First Sales Date: 09/02/2011

Operator: CHESAPEAKE OPERATING INC 17441
P.O. Box 18496
6100 N WESTERN AVE
OKLAHOMA CITY, OK 73154-0496

Completion Type	
X	Single Zone
	Multiple Zone
	Commingled

Location Exception
Order No
587507

Increased Density
Order No
There are no Increased Density records to display.

Casing and Cement							
Type	Size	Weight	Grade	Feet	PSI	SAX	Top of CMT
SURFACE	9 5/8	36	J-55	1035		425	SURFACE
INTERMEDIATE	7	26	P-110	6405		220	4980

Liner								
Type	Size	Weight	Grade	Length	PSI	SAX	Top Depth	Bottom Depth
LINER	4 1/2	13.5	P-110	4094	0	430	6285	10379

Total Depth: 10381

Packer	
Depth	Brand & Type
6026	PACKER

Plug	
Depth	Plug Type
10280	BP

Initial Test Data										
Test Date	Formation	Oil BBL/Day	Oil-Gravity (API)	Gas MCF/Day	Gas-Oil Ratio Cu FT/BBL	Water BBL/Day	Pumpin or Flowing	Initial Shut-In Pressure	Choke Size	Flow Tubing Pressure
Sep 14, 2011	MISSISSIPPI SOLID	12		390	32500	3787	ARTIFICIA			118

Completion and Test Data by Producing Formation										
Formation Name: MISSISSIPPI SOLID			Code: 351MSSSD			Class: GAS				
Spacing Orders				Perforated Intervals						
Order No		Unit Size		From			To			
154681		640		6075			10242			
Acid Volumes				Fracture Treatments						
1,742 BARRELS 15% HCL ACID				80,009 BARRELS SLICK WATER + FRESH, 2,626,485 POUNDS PROPPANT, 800 BARRELS LINEAR GEL						

Formation	Top
MISSISSIPPI SOLID	6048

Were open hole logs run? Yes
Date last log run: May 15, 2011

Were unusual drilling circumstances encountered? No
Explanation:

Other Remarks
There are no Other Remarks.

Lateral Holes
Sec: 2 TWP: 25N RGE: 12W County: ALFALFA NW NE NW NW 247 FNL 771 FWL of 1/4 SEC Depth of Deviation: 5124 Radius of Turn: 737 Direction: 360 Total Length: 4333 Measured Total Depth: 10381 True Vertical Depth: 5861 End Pt. Location From Release, Unit or Property Line: 247

FOR COMMISSION USE ONLY
Status: Accepted
1112238

API NO. **35-003-22048**
OTC PROD. UNIT NO. **003-206266**

PLEASE TYPE OR USE BLACK INK ONLY
NOTE: Attach copy of original 1002A if recompletion



OCT 07 2011

OKLAHOMA CORPORATION COMMISSION

ORIGINAL
 AMENDED
Reason Amended _____

COMPLETION REPORT

TYPE OF DRILLING OPERATION
 STRAIGHT HOLE DIRECTIONAL HOLE HORIZONTAL HOLE
SERVICE WELL
If directional or horizontal, see reverse for bottom hole location.

SPUD DATE **4/24/2011**
DRLG FINISHED DATE **5/17/2011**
DATE OF WELL COMPLETION **6/11/2011**
1ST PROD DATE **9/1/2011**
RECOMP DATE _____
Longitude (if Known) _____

COUNTY **ALFALFA** SEC **2** TWP **25N** RGE **12W**
LEASE NAME **SCHANBACHER 2-25-12** WELL NO. **1H**
SHL SW 1/4 SE 1/4 SW 1/4 SW 1/4 **200'** FNL FWL **760'**
ELEVATION Derrick Fl **1,359'** Ground **1,342'** Latitude (if Known) _____
OPERATOR NAME **CHESAPEAKE OPERATING, INC.** OTC/OCC OPERATOR NO. **17441**
ADDRESS **P.O. BOX 18496**
CITY **OKLAHOMA CITY** STATE **OK** ZIP **73154**

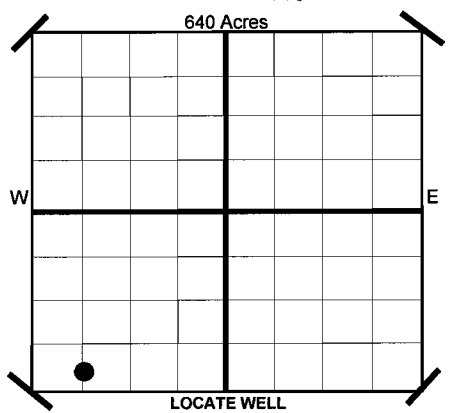

COMPLETION TYPE
 SINGLE ZONE
 MULTIPLE ZONE
Application Date _____
 COMMINGLED
Application Date _____
LOCATION EXCEPTION ORDER NO. **587507**
INCREASED DENSITY ORDER NO. _____

CASING & CEMENT (Form 1002C must be attached)

TYPE	SIZE	WEIGHT	GRADE	FEET	PSI	SAX	TOP	
CONDUCTOR								
SURFACE	9 5/8"	36#	J-55	1,035'		425	SURFACE	
INTERMEDIATE	7"	26#	P-110	6,405'		220	4,980'	
PRODUCTION LINE	4 1/2"	13.5#	P-110	6,285'-10,379'		430	11,256'	
TUBING	3 1/2"	9.30#	J-55	6,018'				
							TOTAL DEPTH	10,381'

PACKER @ **6.026'** BRAND & TYPE _____
PACKER @ _____ BRAND & TYPE _____

PLUG @ **10.280'** TYPE **BP** PLUG @ _____ TYPE _____
PLUG @ _____ TYPE _____ PLUG @ _____ TYPE _____

COMPLETION & TEST DATA BY PRODUCING FORMATION

351MSSSD

FORMATION	MISSISSIPPI SOLID	6610'-6612'	7612'-7614'	8625'-8627'	9634'-9636'
SPACING & SPACING ORDER NUMBER	640 154681	6777'-6779'	7786'-7788'	8790'-8792'	9815'-9817'
CLASS: Oil, Gas, Dry, Inj. Disp, Comm Disp, Svc	GAS	6852'-6854'	7860'-7862'	8870'-8872'	9900'-9902'
PERFORATED INTERVALS	6075'-6077'	7076'-7078'	8115'-8117'	9135'-9137'	10171'-10173'
	6160'-6162'	7156'-7158'	8200'-8202'	9203'-9205'	10240'-10242'
	6245'-6247'	7254'-7256'	8276'-8278'	9305'-9307'	
	6330'-6332'	7350'-7352'	8370'-8372'	9390'-9392'	
	6415'-6417'	7435'-7437'	8450'-8452'	9475'-9477'	
	6500'-6502'	7520'-7522'	8550'-8552'	9545'-9547'	
ACID/VOLUME	15% HCL ACID 1,742 Bbls				
FRACTURE TREATMENT (Fluids/Prop Amounts)	Slick Water+Fresh 80,009 Bbls Proppant 2,626,485 lb	LIN. GEL 800 Bbls			

Minimum Gas Allowable (165:10-17-7)

Gas Purchaser/Measurer

Chesapeake Operating, Inc.

OR

Oil Allowable (165:10-13-3)

1st Sales Date

9/2/2011

INITIAL TEST DATA

INITIAL TEST DATE	9/14/2011			
OIL-BBL/DAY	12			
OIL-GRAVITY (API)				
GAS-MCF/DAY	390			
GAS-OIL RATIO CU FT/BBL	32,500			
WATER-BBL/DAY	3,787			
PUMPING OR FLOWING	ARTIFICIAL LIFT			
INITIAL SHUT-IN PRESSURE				
CHOKE SIZE				
FLOW TUBING PRESSURE	118			

A record of the formations drilled through, and pertinent remarks are presented on the reverse. I declare that I have knowledge of the contents of this report and am authorized by my organization to make this report which was prepared by me or under my supervision and direction, with the data and facts stated herein to be true, correct, and complete to the best of my knowledge and belief.

David Craycraft
SIGNATURE **DAVID CRAYCRAFT - DISTRICT MANAGER** DATE **10/3/2011** PHONE NUMBER **405-848-8000**
P.O. BOX 18496 ADDRESS **OKLAHOMA CITY** STATE **OK** ZIP **73154** EMAIL ADDRESS **jamal.daneshfar@chk.com**

PLEASE TYPE OR USE BLACK INK ONLY
FORMATION RECORD

Give formation names and tops, if available, or descriptions and thickness of formations drilled through. Show intervals cored or drillstem tested.

LEASE NAME SCHANBACHER 2-25-12

WELL NO. 1H

NAMES OF FORMATIONS	TOP
MISSISSIPPI SOLID	6,048'

FOR COMMISSION USE ONLY

ITD on file YES NO

APPROVED _____ DISAPPROVED _____

2) Reject Codes

Were open hole logs run? X yes no

Date Last log was run 5/15/2011

Was CO₂ encountered? yes X no at what depths?

Was H₂S encountered? yes X no at what depths?

Were unusual drilling circumstances encountered? yes X no
If yes, briefly explain.

Other remarks:

640 Acres

If more than three drainholes are proposed, attach a separate sheet indicating the necessary information.

Direction must be stated in degrees azimuth. Please note, the horizontal drainhole and its end point must be located within the boundaries of the lease or spacing unit.

Directional surveys are required for all drainholes and directional wells.
640 Acres

BOTTOM HOLE LOCATION FOR DIRECTIONAL HOLE

SEC	TWP	RGE	COUNTY			
Spot Location				Feet From 1/4 Sec Lines	FSL	FWL
1/4	1/4	1/4	1/4	BHL From Lease, Unit, or Property Line:		
Measured Total Depth		True Vertical Depth				

BOTTOM HOLE LOCATION FOR HORIZONTAL HOLE: (LATERALS)

LATERAL #1

SEC	TWP	RGE	COUNTY			
2	25N	12W	ALFALFA			
Spot Location				Feet From Sec Lines	FNL	FWL
NW 1/4	NE 1/4	NW 1/4	NW 1/4	247'	771'	
Depth of Deviation		Radius of Turn		Direction	Total Length	
5,124'		737'		360 DEG	4,333'	
Measured Total Depth		True Vertical Depth		BHL From Lease, Unit, or Property Line:		
10,381		5,861'		247'		

LATERAL #2

SEC	TWP	RGE	COUNTY			
Spot Location				Feet From 1/4 Sec Lines	FSL	FWL
1/4	1/4	1/4	1/4	BHL From Lease, Unit, or Property Line:		
Depth of Deviation		Radius of Turn		Direction	Total Length	
Measured Total Depth		True Vertical Depth				

LATERAL #3

SEC	TWP	RGE	COUNTY			
Spot Location				Feet From 1/4 Sec Lines	FSL	FWL
1/4	1/4	1/4	1/4	BHL From Lease, Unit, or Property Line:		
Depth of Deviation		Radius of Turn		Direction	Total Length	
Measured Total Depth		True Vertical Depth				