

Oklahoma Corporation Commission
Oil & Gas Conservation Division
Post Office Box 52000
Oklahoma City, Oklahoma 73152-2000
Rule 165: 10-3-25

Form 1002A

API No.: 35009217980001

Completion Report

Spud Date: February 15, 2011

OTC Prod. Unit No.: 009-205557

Drilling Finished Date: April 11, 2011

1st Prod Date: June 09, 2011

Completion Date: June 08, 2011

Drill Type: HORIZONTAL HOLE

Min Gas Allowable: Yes

Well Name: KAY MARTIN 1-22H

Purchaser/Measurer: CHESAPEAKE OPERATING INC

Location: BECKHAM 22 11N 23W
N2 N2 NE NE
240 FNL 660 FEL of 1/4 SEC
Derrick Elevation: 2106 Ground Elevation: 2076

First Sales Date: 06/09/2011

Operator: CHESAPEAKE OPERATING INC 17441
P.O. Box 18496
6100 N WESTERN AVE
OKLAHOMA CITY, OK 73154-0496

Completion Type	
X	Single Zone
	Multiple Zone
	Commingled

Location Exception
Order No
587700

Increased Density
Order No
There are no Increased Density records to display.

Casing and Cement							
Type	Size	Weight	Grade	Feet	PSI	SAX	Top of CMT
SURFACE	9 5/8	40	J-55	1528		620	SURFACE
INTERMEDIATE	7	29	P-110	10901		475	4051

Liner								
Type	Size	Weight	Grade	Length	PSI	SAX	Top Depth	Bottom Depth
LINER	4 1/2	13.5	HCP-110	5648	0	670	10670	16318

Total Depth: 16318

Packer	
Depth	Brand & Type
There are no Packer records to display.	

Plug	
Depth	Plug Type
There are no Plug records to display.	

Initial Test Data										
Test Date	Formation	Oil BBL/Day	Oil-Gravity (API)	Gas MCF/Day	Gas-Oil Ratio Cu FT/BBL	Water BBL/Day	Pumpin or Flowing	Initial Shut-In Pressure	Choke Size	Flow Tubing Pressure
Sep 21, 2011	HOGSHOOTER	109	51	1937	17771	8	FLOWING	988	38/64	347

Completion and Test Data by Producing Formation										
Formation Name: HOGSHOOTER			Code: 405HGSR			Class: GAS				
Spacing Orders				Perforated Intervals						
Order No	Unit Size			From			To			
195051	640			11570			16241			
Acid Volumes				Fracture Treatments						
There are no Acid Volume records to display.				65,919 BSW + LINEAR GEL + 3,089,160 POUNDS SAND						

Formation	Top
COUNCIL GROVE	5368
BASE HEEBNER	9309
TONKAWA	10017
MISSOURIAN	10642
COTTAGE GROVE	10779
HOGSHOOTER	11377

Were open hole logs run? Yes
Date last log run: February 25, 2011
Were unusual drilling circumstances encountered? No
Explanation:

Other Remarks
There are no Other Remarks.

Lateral Holes
Sec: 22 TWP: 11N RGE: 23W County: BECKHAM SW SE SE SE 237 FSL 656 FEL of 1/4 SEC Depth of Deviation: 11110 Radius of Turn: 255 Direction: 181 Total Length: 4941 Measured Total Depth: 16318 True Vertical Depth: 11365 End Pt. Location From Release, Unit or Property Line: 237

FOR COMMISSION USE ONLY	
Status: Accepted	1112239

API NO. 009-21798
 OTC PROD. UNIT NO. 009-205557

PLEASE TYPE OR USE BLACK INK ONLY
 NOTE: Attach copy of original 1002A if recompletion or



RECEIVED 684103
 Form 1002A Rev. 2009

OCT 10 2011

OKLAHOMA CORPORATION COMMISSION

ORIGINAL AMENDED Reason Amended
 TYPE OF DRILLING OPERATION
 STRAIGHT HOLE DIRECTIONAL HOLE HORIZONTAL HOLE
 SERVICE WELL

COMPLETION REPORT

If directional or horizontal, see reverse for bottom hole location.

COUNTY	Beckham	SEC	22	TWP	11N	RGE	23W	SPUD DATE	2/15/2011
LEASE NAME	Kay Martin			WELL NO	1-22H		DRLG FINISHED DATE	4/11/2011	
SHL	N2 1/4	N2 1/4	NE 1/4	NE 1/4	FNL	240	FEL OF	1/4 SEC	660
ELEVATION	Derrick Ft 2,106		Ground 2,076		Latitude (if Known)		Longitude (if Known)		
OPERATOR NAME	CHESAPEAKE OPERATING, INC.				OTC/OCC OPERATOR NO.		17441		
ADDRESS	P.O. BOX 18496								
CITY	OKLAHOMA CITY			STATE	OK		ZIP	73154	

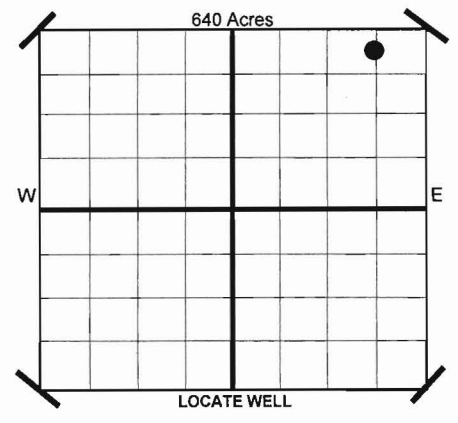

COMPLETION TYPE

SINGLE ZONE
 MULTIPLE ZONE Application Date
 COMMINGLED Application Date

LOCATION EXCEPTION ORDER NO. 587700
 INCREASED DENSITY ORDER NO. N/A

CASING & CEMENT (Form 1002C must be attached)

TYPE	SIZE	WEIGHT	GRADE	FEET	PSI	SAX	TOP
CONDUCTOR							
SURFACE	9-5/8"	40#	J-55	1,528		620	Surface
INTERMEDIATE	7"	29#	P-110	10,901		475	4,051
PRODUCTION							
LINER	4-1/2"	13.5#	HCP-110	10670-16,318		670	10,670 (TOL)

PACKER @ _____ BRAND & TYPE _____ PLUG @ _____ TYPE _____ PLUG @ _____ TYPE _____ TOTAL DEPTH 16,318
 PACKER @ _____ BRAND & TYPE _____ PLUG @ _____ TYPE _____ PLUG @ _____ TYPE _____

COMPLETION & TEST DATA BY PRODUCING FORMATION

405HGS R

FORMATION	Hogshooter	continued perms	continued perms	continued perms	continued perms
SPACING & SPACING	<i>640</i>	12,265 - 12,266	13,457 - 13,458	14,656 - 14,657	15,753 - 15,754
ORDER NUMBER	195051	12,406 - 12,408	13,622 - 13,624	14,796 - 14,797	15,869 - 15,870
CLASS: Oil, Gas, Dry, Inj. Disp, Comm Disp, Svc	Gas	12,534 - 12,536	13,694 - 13,696	14,916 - 14,917	15,986 - 15,987
		12,646 - 12,648	13,822 - 13,824	15,022 - 15,023	16,112 - 16,113
	11,570 - 11,571	12,743 - 12,744	13,948 - 13,949	15,024 - 15,025	16,240 - 16,241
	11,672 - 11,673	12,848 - 12,849	14,045 - 14,046	15,155 - 15,156	
PERFORATED INTERVALS	11,787 - 11,789	12,971 - 12,973	14,170 - 14,172	15,224 - 15,225	
	11,894 - 11,896	13,086 - 13,088	14,282 - 14,284	15,378 - 15,379	
	12,026 - 12,028	13,248 - 13,250	14,412 - 14,414	15,503 - 15,504	
	12,142 - 12,143	13,352 - 13,353	14,563 - 14,564	15,632 - 15,634	
ACID/VOLUME					
FRACTURE TREATMENT (Fluids/Prop Amounts)	65,919 BSW + linear gel + 3,089,160# sand				

Minimum Gas Allowable (165:10-17-7) OR Gas Purchaser/Measurer Chesapeake Operating, Inc.
 1st Sales Date 6/9/2011

INITIAL TEST DATA

Oil Allowable (165:10-13-3)

INITIAL TEST DATE	9/21/2011
OIL-BBL/DAY	109
OIL-GRAVITY (API)	51
GAS-MCF/DAY	1,937
GAS-OIL RATIO CU FT/BBL	17,771
WATER-BBL/DAY	8
PUMPING OR FLOWING	Flowing
INITIAL SHUT-IN PRESSURE	988
CHOKE SIZE	38/64
FLOW TUBING PRESSURE	347 (FCP)

A record of the formations drilled through, and pertinent remarks are presented on the reverse. I declare that I have knowledge of the contents of this report and am authorized by my organization to make this report, which was prepared by me or under my supervision and direction, with the data and facts stated herein to be true, correct, and complete to the best of my knowledge and belief.

Michael Park SIGNATURE MICHAEL PARK - DISTRICT MANAGER 10/7/2011 DATE 405-848-8000 PHONE NUMBER
 P.O. BOX 18496 OKLAHOMA CITY OK 73154 ADDRESS CITY STATE ZIP juanita.cooper@chk.com EMAIL ADDRESS

PLEASE TYPE OR USE BLACK INK ONLY
FORMATION RECORD

Give formation names and tops, if available, or descriptions and thickness of formations drilled through. Show intervals cored or drillstem tested.

LEASE NAME Kay Martin

WELL NO. 1-22H

NAMES OF FORMATIONS	TOP
Council Grove	5,368
Base Heebner	9,309
Tonkawa	10,017
Missourian	10,642
Cottage Grove	10,779
Hogshooter	11,377

FOR COMMISSION USE ONLY	
ITD on file	<input type="checkbox"/> YES <input type="checkbox"/> NO
APPROVED	DISAPPROVED
2) Reject Codes	

Were open hole logs run?	<input checked="" type="checkbox"/> yes	<input type="checkbox"/> no
Date Last log was run	2/25/2011	
Was CO ₂ encountered?	yes	<input checked="" type="checkbox"/> no at what depths?
Was H ₂ S encountered?	yes	<input checked="" type="checkbox"/> no at what depths?
Were unusual drilling circumstances encountered?	<input type="checkbox"/> yes	<input checked="" type="checkbox"/> no
If yes, briefly explain.		

Other remarks:

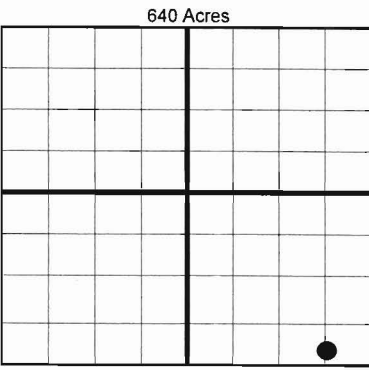

BOTTOM HOLE LOCATION FOR DIRECTIONAL HOLE

SEC	TWP	RGE	COUNTY				
Spot Location	1/4	1/4	1/4	1/4	Feet From 1/4 Sec Lines	FSL	FWL
Measured Total Depth	True Vertical Depth		BHL From Lease, Unit, or Property Line:				

BOTTOM HOLE LOCATION FOR HORIZONTAL HOLE: (LATERALS)

LATERAL #1

SEC	TWP	RGE	COUNTY				
22	11N	23W	Beckham				
Spot Location	SW 1/4	SE 1/4	SE 1/4	SE 1/4	Feet From 1/4 Sec Lines	FSL	FEL
Depth of Deviation	11,110	Radius of Turn	255	Direction	181	Total Length	4,941
Measured Total Depth	True Vertical Depth		BHL From Lease, Unit, or Property Line:				
16,318	11,365		237				

If more than three drainholes are proposed, attach a separate sheet indicating the necessary information.

Direction must be stated in degrees azimuth. Please note, the horizontal drainhole and its end point must be located within the boundaries of the lease or spacing unit.

Directional surveys are required for all drainholes and directional wells.

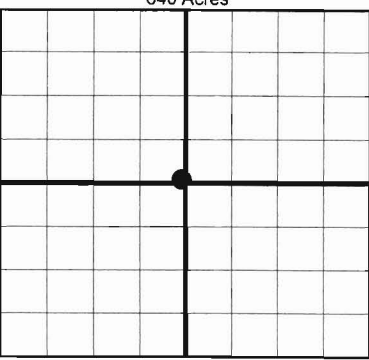

LATERAL #2

SEC	TWP	RGE	COUNTY				
Spot Location	1/4	1/4	1/4	1/4	Feet From 1/4 Sec Lines	FSL	FWL
Depth of Deviation	Radius of Turn		Direction				Total Length
Measured Total Depth	True Vertical Depth		BHL From Lease, Unit, or Property Line:				

LATERAL #3

SEC	TWP	RGE	COUNTY				
Spot Location	1/4	1/4	1/4	1/4	Feet From 1/4 Sec Lines	FSL	FWL
Depth of Deviation	Radius of Turn		Direction				Total Length
Measured Total Depth	True Vertical Depth		BHL From Lease, Unit, or Property Line:				