

Oklahoma Corporation Commission  
 Oil & Gas Conservation Division  
 Post Office Box 52000  
 Oklahoma City, Oklahoma 73152-2000  
 Rule 165: 10-3-25

Form 1002A

API No.: 35009217900001

**Completion Report**

Spud Date: January 30, 2011

OTC Prod. Unit No.: 009-205523

Drilling Finished Date: April 22, 2011

1st Prod Date: May 27, 2011

Completion Date: June 04, 2011

**Drill Type: HORIZONTAL HOLE**

Well Name: HX4 LLC 1-14H

Purchaser/Measurer:

Location: BECKHAM 14 11N 21W  
 NW NE NE NE  
 270 FNL 640 FEL of 1/4 SEC  
 Derrick Elevation: 1997 Ground Elevation: 1999

First Sales Date:

Operator: CHESAPEAKE OPERATING INC 17441  
 P.O. Box 18496  
 6100 N WESTERN AVE  
 OKLAHOMA CITY, OK 73154-0496

Completion Type	
X	Single Zone
	Multiple Zone
	Commingled

Location Exception	
Order No	
586018	

Increased Density	
Order No	
There are no Increased Density records to display.	

Casing and Cement							
Type	Size	Weight	Grade	Feet	PSI	SAX	Top of CMT
SURFACE	9 5/8	40	J-55	1500		620	SURFACE
INTERMEDIATE	7	26	P-110	12260		935	8519
PRODUCTION	4 1/2	13.5	P-110	17651		590	6694

Liner								
Type	Size	Weight	Grade	Length	PSI	SAX	Top Depth	Bottom Depth
There are no Liner records to display.								

**Total Depth: 17651**

Packer	
Depth	Brand & Type
There are no Packer records to display.	

Plug	
Depth	Plug Type
There are no Plug records to display.	

Initial Test Data										
Test Date	Formation	Oil BBL/Day	Oil-Gravity (API)	Gas MCF/Day	Gas-Oil Ratio Cu FT/BBL	Water BBL/Day	Pumpin or Flowing	Initial Shut-In Pressure	Choke Size	Flow Tubing Pressure
Jun 04, 2011	DES MOINES	438	53.2	9771	22308	1560	FLOWING	5027	24	3519

Completion and Test Data by Producing Formation		
Formation Name: DES MOINES	Code: 404DSMN	Class: GAS
<b>Spacing Orders</b>		<b>Perforated Intervals</b>
<b>Order No</b>	<b>Unit Size</b>	<b>From</b> <b>To</b>
578782	640	12927      17536
<b>Acid Volumes</b>		<b>Fracture Treatments</b>
There are no Acid Volume records to display.		FRAC WITH 76,664 BARRELS SLICKWATER AND 3,203,660 POUNDS PROPPANT

Formation	Top
VIRGILIAN	5921
MISSOURIAN	10388
DES MOINES	12666

Were open hole logs run? Yes  
Date last log run: February 23, 2011  
Were unusual drilling circumstances encountered? No  
Explanation:

Other Remarks
IRREGULAR SECTION

Lateral Holes
Sec: 14 TWP: 11N RGE: 21W County: BECKHAM SW SE SE SE 206 FSL 638 FEL of 1/4 SEC Depth of Deviation: 12593 Radius of Turn: 420 Direction: 2 Total Length: 4398 Measured Total Depth: 17651 True Vertical Depth: 13013 End Pt. Location From Release, Unit or Property Line: 206

FOR COMMISSION USE ONLY
Status: Accepted
1111557

API NO. 35-009-21790  
OTC PROD.  
UNIT NO. 009-205523

PLEASE TYPE OR USE BLACK INK ON NOTE:  
Attach copy of original 1002A if recomple



RECEIVED  
63324

AUG 09 2011

OKLAHOMA CORPORATION COMMISSION

ORIGINAL  
 AMENDED  
Reason Amended

COMPLETION REPORT

TYPE OF DRILLING OPERATION  
 STRAIGHT HOLE  DIRECTIONAL HOLE  HORIZONTAL HOLE  
 SERVICE WELL

If directional or horizontal, see reverse for bottom hole location.

COUNTY	BECKHAM	SEC	14	TWP	11N	RGE	21W
LEASE NAME	HX4 LLC			WELL NO	1-14H		
SHL	NW 1/4 NE 1/4 NE 1/4 NE 1/4		FNL	270'		FEL OF	1/4 SEC 640'
ELEVATION	Derrick Fl 1,997' Ground 1,999'		Latitude (if Known)		Longitude (if Known)		
OPERATOR NAME	CHESAPEAKE OPERATING, INC.			OTC/OCC OPERATOR NO.		17441	
ADDRESS	P.O. BOX 18496						
CITY	OKLAHOMA CITY		STATE	OK		ZIP	73154

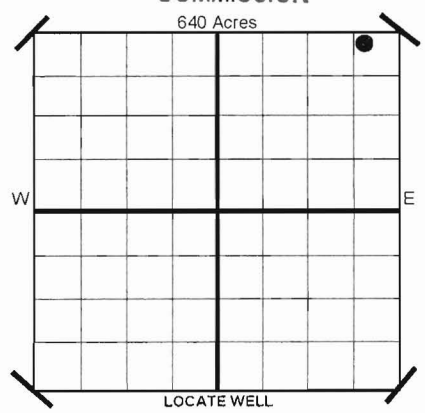

COMPLETION TYPE

<input checked="" type="checkbox"/> SINGLE ZONE
<input type="checkbox"/> MULTIPLE ZONE Application Date
<input type="checkbox"/> COMMINGLED Application Date
LOCATION EXCEPTION ORDER NO. 586018
INCREASED DENSITY ORDER NO. N/A

CASING & CEMENT (Form 1002C must be attached)

TYPE	SIZE	WEIGHT	GRADE	FEET	PSI	SAX	TOP	
CONDUCTOR								
SURFACE	9 5/8"	40#	J-55	1,500'		620	SURFACE	
INTERMEDIATE	7"	26#	P-110	12,260'		935	8519'	
PRODUCTION	4 1/2"	13.5#	P-110	17,651'		590	6,694'	
LINER								
							TOTAL DEPTH	17,651'

PACKER @ \_\_\_\_\_ BRAND & TYPE \_\_\_\_\_ PLUG @ \_\_\_\_\_ TYPE \_\_\_\_\_ PLUG @ \_\_\_\_\_ TYPE \_\_\_\_\_  
 PACKER @ \_\_\_\_\_ BRAND & TYPE \_\_\_\_\_ PLUG @ \_\_\_\_\_ TYPE \_\_\_\_\_ PLUG @ \_\_\_\_\_ TYPE \_\_\_\_\_

COMPLETION & TEST DATA BY PRODUCING FORMATION

FORMATION	DES MOINES					
SPACING & SPACING ORDER NUMBER	640 578782					
CLASS: Oil, Gas, Dry, Inj, Disp, Comm Disp, Svc	GAS					
PERFORATED INTERVALS	12927-12928 13045-13046 13163-13164 13281-13282 13400-13401 13518-13519	13636-13637 13754-13755 13872-13873 13990-13991 14109-14110 14227-14228	14345-14346 14463-14464 14581-14582 14699-14700 14817-14818 14936-14937	15054-15055 15172-15173 15290-15291 15408-15409 15526-15527 15645-15646	15763-15764 15881-15882 15999-16000 16117-16118 16235-16236 16353-16354	16472-16473 16590-16591 16708-16709 16826-16827 16944-16945 17062-17063 17181-17182 17299-17300 17417-17418 17535-17536
ACID/VOLUME						
FRACTURE TREATMENT (Fluids/Prop Amounts)	Frac w/ 76,664 bbls Slickwater & 3,203,660# Proppant					

Minimum Gas Allowable (165-10-17-7) Gas Purchaser/Measurer \_\_\_\_\_  
 OR 1st Sales Date \_\_\_\_\_  
 Oil Allowable (165-10-13-3)

INITIAL TEST DATA

INITIAL TEST DATE	6/4/2011
OIL-BBL/DAY	438
OIL-GRAVITY ( API)	53.2
GAS-MCF/DAY	9,771
GAS-OIL RATIO CU FT/BBL	22,308
WATER-BBL/DAY	1,560
PUMPING OR FLOWING	FLOWING
INITIAL SHUT-IN PRESSURE	5027# CP
CHOKE SIZE	24
FLOW TUBING PRESSURE	3,519# CP

A record of the formations drilled through, and pertinent remarks are presented on the reverse. I declare that I have knowledge of the contents of this report and am authorized by my organization to make this report, which was prepared by me or under my supervision and direction, with the data and facts stated herein to be true, correct, and complete to the best of my knowledge and belief.

SIGNATURE: *[Signature]* MICHAEL PARK - DISTRICT MANAGER DATE: 6/16/2011 PHONE NUMBER: 405-848-8000  
 ADDRESS: P.O. BOX 18496 OKLAHOMA CITY OK 73154 EMAIL ADDRESS: nancy.parker@chk.com

PLEASE TYPE OR USE BLACK INK ONLY  
FORMATION RECORD

Give formation names and tops, if available, or descriptions and thickness of formation: LEASE NAME HX4 LLC  
drilled through. Show intervals cored or drillstem tested.

WELL NO. 1-14H

NAMES OF FORMATIONS	TOP
VIRGILIAN	5,921'
MISSOURIAN	10,388'
DES MOINES	12,666'

FOR COMMISSION USE ONLY	
ITD on file	<input type="checkbox"/> YES <input type="checkbox"/> NO
APPROVED	DISAPPROVED
2) Reject Codes	
_____	
_____	
_____	
_____	

Were open hole logs run?	<input checked="" type="checkbox"/> yes <input type="checkbox"/> no
Date Last log was run	<u>2/23/2011</u>
Was CO <sub>2</sub> encountered?	<input type="checkbox"/> yes <input checked="" type="checkbox"/> no at what depths?
Was H <sub>2</sub> S encountered?	<input type="checkbox"/> yes <input checked="" type="checkbox"/> no at what depths?
Were unusual drilling circumstances encountered?	<input type="checkbox"/> yes <input checked="" type="checkbox"/> no
If yes, briefly explain.	

Other remarks:

\_\_\_\_\_

\_\_\_\_\_

\_\_\_\_\_

\_\_\_\_\_

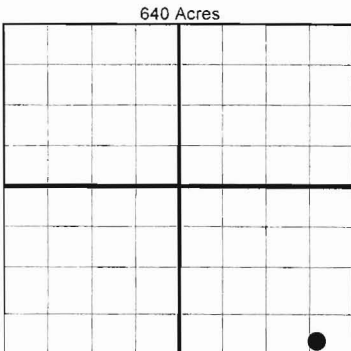

**BOTTOM HOLE LOCATION FOR DIRECTIONAL HOLE**

SEC	TWP	RGE	COUNTY			
Spot Location				Feet From 1/4 Sec Lines	FSL	FWL
1/4	1/4	1/4	1/4	BHL From Lease, Unit, or Property Line:		
Measured Total Depth		True Vertical Depth				

**BOTTOM HOLE LOCATION FOR HORIZONTAL HOLE: (LATERALS)**

**LATERAL #1**

SEC	TWP	RGE	COUNTY			
14	11N	21W	BECKHAM			
Spot Location				Feet From 1/4 Sec Lines	FSL	FEL
SW 1/4	SE 1/4	SE 1/4	SE 1/4	206'	206'	638'
Depth of Deviation		Radius of Turn		Direction		Total Length
12,593		420		2		4,398'
Measured Total Depth		True Vertical Depth		BHL From Lease, Unit, or Property Line:		
17,651'		13,013'		206'		

If more than three drainholes are proposed, attach a separate sheet indicating the necessary information.

Direction must be stated in degrees azimuth. Please note, the horizontal drainhole and its end point must be located within the boundaries of the lease or spacing unit.

**Directional surveys are required for all drainholes and directional wells.**

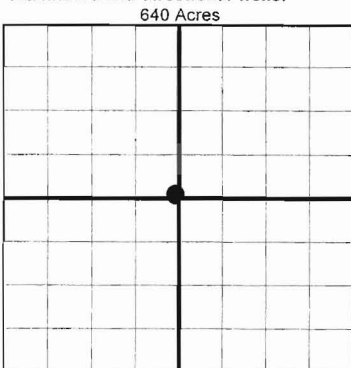

**LATERAL #2**

SEC	TWP	RGE	COUNTY			
Spot Location				Feet From 1/4 Sec Lines	FSL	FWL
1/4	1/4	1/4	1/4	BHL From Lease, Unit, or Property Line:		
Depth of Deviation		Radius of Turn		Direction		Total Length
Measured Total Depth		True Vertical Depth				

**LATERAL #3**

SEC	TWP	RGE	COUNTY			
Spot Location				Feet From 1/4 Sec Lines	FSL	FWL
1/4	1/4	1/4	1/4	BHL From Lease, Unit, or Property Line:		
Depth of Deviation		Radius of Turn		Direction		Total Length
Measured Total Depth		True Vertical Depth				