

Oklahoma Corporation Commission  
 Oil & Gas Conservation Division  
 Post Office Box 52000  
 Oklahoma City, Oklahoma 73152-2000  
 Rule 165: 10-3-25

Form 1002A

API No.: 35045229100000

**Completion Report**

Spud Date: January 03, 2011

OTC Prod. Unit No.: 045-205252-0-0000

Drilling Finished Date: February 07, 2011

1st Prod Date: April 12, 2011

Completion Date: April 12, 2011

**Drill Type: HORIZONTAL HOLE**

Well Name: MILLER 6-28H

Purchaser/Measurer:

Location: ELLIS 28 17N 24W  
 NE SE SW SW  
 525 FSL 1239 FWL of 1/4 SEC  
 Derrick Elevation: 2195 Ground Elevation: 2176

First Sales Date:

Operator: CRAWLEY PETROLEUM CORPORATION 7980

105 N HUDSON AVE STE 800  
 OKLAHOMA CITY, OK 73102-4803

Completion Type	
X	Single Zone
	Multiple Zone
	Commingled

Location Exception	
Order No	
	575180
	584053

Increased Density	
Order No	
	566081
	573984

Casing and Cement							
Type	Size	Weight	Grade	Feet	PSI	SAX	Top of CMT
SURFACE	9 5/8	40	J-55	1483		650	SURFACE
INTERMEDIATE	7	26	P-110 UFJ /	8431		450	3550

Liner								
Type	Size	Weight	Grade	Length	PSI	SAX	Top Depth	Bottom Depth
LINER	4 1/2	11.6	HCP-110 / P-	4426	0	0	7400	11826

**Total Depth: 11828**

Packer	
Depth	Brand & Type
There are no Packer records to display.	

Plug	
Depth	Plug Type
There are no Plug records to display.	

Initial Test Data										
Test Date	Formation	Oil BBL/Day	Oil-Gravity (API)	Gas MCF/Day	Gas-Oil Ratio Cu FT/BBL	Water BBL/Day	Pumpin or Flowing	Initial Shut-In Pressure	Choke Size	Flow Tubing Pressure
Apr 20, 2011	TONKAWA	108		67	620	25	PUMPING	120	32/64	340

Completion and Test Data by Producing Formation										
Formation Name: TONKAWA			Code: 406TNKW			Class: OIL				
<b>Spacing Orders</b>				<b>Perforated Intervals</b>						
<b>Order No</b>	<b>Unit Size</b>			<b>From</b>			<b>To</b>			
62327	640			8623			11683			
<b>Acid Volumes</b>				<b>Fracture Treatments</b>						
There are no Acid Volume records to display.				58,631 BW AND 1,907,212 POUNDS 30/50 SAND AND 20/40 SAND						

Formation	Top
DOUGLAS	7330
TONKAWA SAND	8010

Were open hole logs run? No

Date last log run:

Were unusual drilling circumstances encountered? No

Explanation:

Other Remarks
There are no Other Remarks.

Lateral Holes
Sec: 28 TWP: 17N RGE: 24W County: ELLIS
NW SE NW NW
893 FNL 692 FWL of 1/4 SEC
Depth of Deviation: 7582 Radius of Turn: 503 Direction: 352 Total Length: 3900
Measured Total Depth: 11828 True Vertical Depth: 8096 End Pt. Location From Release, Unit or Property Line: 692

FOR COMMISSION USE ONLY
Status: Accepted
1110233

APT NO. **045-22910**  
 OTC PROD. UNIT NO. **045-205252-U-0000**

PLEASE TYPE OR U:  
 NOTE:  
 Attach copy of original



RECEIVED Form 1002A Rev. 2007

APR 26 2011

OKLAHOMA CORPORATION COMMISSION

ORIGINAL  
 AMENDED  
 Reason Amended \_\_\_\_\_

COMPLETION REPORT

TYPE OF DRILLING OPERATION  
 STRAIGHT HOLE  DIRECTIONAL HOLE  HORIZONTAL HOLE  
 SERVICE WELL

If directional or horizontal, see reverse for bottom hole location.

COUNTY	ELLIS	SEC	28	TWP	17N	RGE	24W	SPUD DATE	1/3/2011
LEASE NAME	MILLER			WELL NO.	#6-28H			DRLG FINISHED	2/7/2011
SHL	NE 1/4 SE 1/4 SW 1/4 SW 1/4			FSL	FWL OF 1/4 SEC			WELL COMPLETION	4/12/2011
ELEVATION	Derrick Fl 2195			Ground	2176			1ST PROD DATE	4/12/2011
OPERATOR NAME	CRAWLEY PETROLEUM CORPORATION				Latitude if Known	35°54'46.0"N		RECOMP DATE	
ADDRESS	105 N. HUDSON, STE. 800				Longitude if Known	99°46'06.8"W		OTC/OCC OPERATOR NO.	07980
CITY	OKLAHOMA CITY		STATE	OK		ZIP	73102-4803		

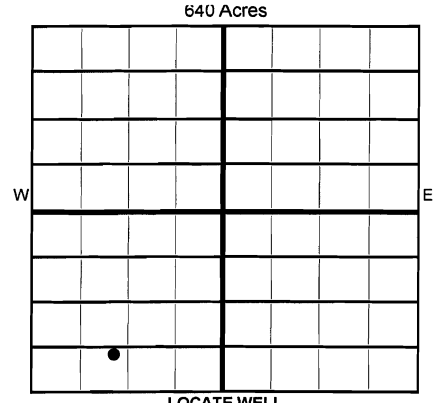

COMPLETION TYPE

<input checked="" type="checkbox"/> SINGLE ZONE
<input type="checkbox"/> MULTIPLE ZONE
Application Date _____
<input type="checkbox"/> COMMINGLED
Application Date _____
LOCATION EXCEPTION ORDER NO. <b>575180</b>
INCREASED DENSITY ORDER NO. <b>573984 &amp; 566081</b>

CASING & CEMENT (Form 1002C must be attached)

TYPE	SIZE	WEIGHT	GRADE	FEET	PSI	SAX	IOP
Conductor							
Surface	9-5/8"	40#	J-55	1483'		650	SURFACE
Intermediate	7"	26#	P-110 UFJ / P-110 LTC	8431'		450	3550
Production	4-1/2"	11.6#	HCP-110 / P110 LTC	11,826'			TDL 7400' (OPEN HOLE COMPLETION)
Liner							

PACKER @ \_\_\_\_\_ BRAND & TYPE \_\_\_\_\_ PLUG @ \_\_\_\_\_ TYPE \_\_\_\_\_ PLUG @ \_\_\_\_\_ TYPE \_\_\_\_\_ TOTAL DEPTH **11,828 TMD**

COMPLETION & TEST DATA BY PRODUCING FORMATION *406 TN&KW*

FORMATION	SPACING & SPACING ORDER NUMBER	CLASS: Oil, Gas, Dry, Inj, Disp, Comm Disp, Svc	PERFORATED INTERVALS	ACID/VOLUME Fracture Treatment (Fluids/Prop Amounts)
TONKAWA SAND	640 ACRES; 62327	OIL	8623 - 11683 (OPEN HOLE COMPLETION)	58,631 BW & 1,907,212# OF 30/50 & 20/40 SAND

INITIAL TEST DATA

INITIAL TEST DATE	4/20/2011	Gas Purchaser/Measurer	1st Sales Date
OIL-BBL/DAY	108 BO		
OIL-GRAVITY ( API)			
GAS-MCF/DAY	67 MCF		
GAS-OIL RATIO CU FT/BBL	1612;1		
WATER-BBL/DAY	25 BW		
PUMPING OR FLOWING	PUMPING		
INITIAL SHUT-IN PRESSURE	120#		
CHOKE SIZE	32/64"		
FLOW TUBING PRESSURE	340#		

A record of the formations drilled through, and pertinent remarks are presented on the reverse. I declare that I have knowledge of the contents of this report and am authorized by my organization to make this report, which was prepared by me or under my supervision and direction, with the data and facts stated herein to be true, correct, and complete to the best of my knowledge and belief.

SIGNATURE: *Paula Wehling* NAME (PRINT OR TYPE): Paula Wehling / Regulatory Compliance Analyst DATE: 4/25/2011 PHONE NUMBER: 405-232-9700

105 N. Hudson, Ste. 800 ADDRESS CITY: OKC STATE: OK ZIP: 73102-4803 EMAIL ADDRESS: paulaw@crawleypetroleum.com

PLEASE TYPE OR USE BLACK INK ONLY  
FORMATION RECORD

Give formation names and tops, if available, or descriptions and thickness of formations drilled through. Show intervals cored or drillstem tested.

LEASE NAME MILLER WELL NO. 6-28H

NAMES OF FORMATIONS	TOP
DOUGLAS	7330
TONKAWA SAND	8010

FOR COMMISSION USE ONLY

ITD on file  YES  NO

APPROVED \_\_\_\_\_ DISAPPROVED \_\_\_\_\_

2) Reject Codes \_\_\_\_\_

were open hole logs run? yes  no  (Open Hole Completion)

Date Last log was run \_\_\_\_\_

were CO<sub>2</sub> encountered? yes  no  at what depths? \_\_\_\_\_

were H<sub>2</sub>S encountered? yes  no  at what depths? \_\_\_\_\_

were unusual drilling circumstances encountered? \_\_\_\_\_ yes  no   
If yes, briefly explain. \_\_\_\_\_

Other remarks: \_\_\_\_\_

\_\_\_\_\_

\_\_\_\_\_

\_\_\_\_\_

640 Acres

--

If more than three drainholes are proposed, attach a separate sheet indicating the necessary information.

Direction must be stated in degrees azimuth. Please note, the horizontal drainhole and its end point must be located within the boundaries of the lease or spacing unit.

**Directional surveys are required for all drainholes and directional wells.**

640 Acres

--

**BOTTOM HOLE LOCATION FOR DIRECTIONAL HOLE**

SEC	TWP	RGE	COUNTY			
Spot Location	1/4	1/4	1/4	Feet From 1/4 Sec Lines	FSL	FWL
Measured Total Depth	True Vertical Depth		BHL From Lease, Unit, or Property Line:			

**BOTTOM HOLE LOCATION FOR HORIZONTAL HOLE: (LATERALS)**

**LATERAL #1**

SEC	TWP	RGE	COUNTY							
28	17N	24W	ELLIS							
Spot Location	NW 1/4	SE 1/4	NW 1/4	NW 1/4	Feet From 1/4 Sec Lines	892.67'	FNL	691.67'	FWL	
Depth of Deviation	7582'		Radius of Turn	503.92'		Direction	352		Total Length	3900.92'
Measured Total Depth	11,828		True Vertical Depth		8096.17		End Pt Location From Lease, Unit or Property Line:			
							<b>892.67' FNL &amp; 691.67' FWL</b>			

**LATERAL #2**

SEC	TWP	RGE	COUNTY				
Spot Location	1/4	1/4	1/4	1/4	Feet From 1/4 Sec Lines	FSL	FWL
Depth of Deviation	Radius of Turn		Direction		Total Length		
Measured Total Depth	True Vertical Depth		End Pt Location From Lease, Unit or Property Line:				

**LATERAL #3**

SEC	TWP	RGE	COUNTY				
Spot Location	1/4	1/4	1/4	1/4	Feet From 1/4 Sec Lines	FSL	FWL
Depth of Deviation	Radius of Turn		Direction		Total Length		
Measured Total Depth	True Vertical Depth		End Pt Location From Lease, Unit or Property Line:				