

Oklahoma Corporation Commission
Oil & Gas Conservation Division
Post Office Box 52000
Oklahoma City, Oklahoma 73152-2000
Rule 165: 10-3-25

Form 1002A

API No.: 35009217800000

Completion Report

Spud Date: October 01, 2010

OTC Prod. Unit No.: 009-205000

Drilling Finished Date: December 04, 2010

1st Prod Date: February 07, 2011

Completion Date: February 06, 2011

Drill Type: HORIZONTAL HOLE

Min Gas Allowable: Yes

Well Name: TOLBERT TRUST 1-13H

Purchaser/Measurer: CHESAPEAKE OPERATING INC

Location: BECKHAM 13 11N 21W
N2 N2 NE NE
250 FNL 660 FEL of 1/4 SEC
Derrick Elevation: 2025 Ground Elevation: 2000

First Sales Date: 02/07/2011

Operator: CHESAPEAKE OPERATING INC 17441
P.O. Box 18496
6100 N WESTERN AVE
OKLAHOMA CITY, OK 73154-0496

| Completion Type | |
|-----------------|---------------|
| X | Single Zone |
| | Multiple Zone |
| | Commingled |

| Location Exception | |
|--------------------|--|
| Order No | |
| 583066 | |

| Increased Density | |
|--|--|
| Order No | |
| There are no Increased Density records to display. | |

| Casing and Cement | | | | | | | |
|-------------------|-------|--------|-------|-------|-----|-----|------------|
| Type | Size | Weight | Grade | Feet | PSI | SAX | Top of CMT |
| SURFACE | 9 5/8 | 40 | J-55 | 1525 | | 620 | SURFACE |
| INTERMEDIATE | 7 | 26 | P-110 | 12241 | | 715 | 9280 |
| PRODUCTION | 4 1/2 | 13.5 | P-110 | 17695 | | 600 | 11740 |

| Liner | | | | | | | | |
|--|------|--------|-------|--------|-----|-----|-----------|--------------|
| Type | Size | Weight | Grade | Length | PSI | SAX | Top Depth | Bottom Depth |
| There are no Liner records to display. | | | | | | | | |

Total Depth: 17695

| Packer | |
|---|--------------|
| Depth | Brand & Type |
| There are no Packer records to display. | |

| Plug | |
|---------------------------------------|-----------|
| Depth | Plug Type |
| There are no Plug records to display. | |

| Initial Test Data | | | | | | | | | | |
|-------------------|------------|-------------|-------------------|-------------|-------------------------|---------------|-------------------|--------------------------|------------|----------------------|
| Test Date | Formation | Oil BBL/Day | Oil-Gravity (API) | Gas MCF/Day | Gas-Oil Ratio Cu FT/BBL | Water BBL/Day | Pumpin or Flowing | Initial Shut-In Pressure | Choke Size | Flow Tubing Pressure |
| Mar 07, 2011 | DES MOINES | 174 | 50.3 | 1610 | 9253 | 441 | FLOWING | | 40/64 | 488 |

| Completion and Test Data by Producing Formation | | | | | | | | | | |
|---|------------------|--|---------------|---|--|------------|-----------|--|--|--|
| Formation Name: DES MOINES | | | Code: 404DSMN | | | Class: OIL | | | | |
| Spacing Orders | | | | Perforated Intervals | | | | | | |
| Order No | Unit Size | | | From | | | To | | | |
| 577666 | 640 | | | 13030 | | | 17483 | | | |
| Acid Volumes | | | | Fracture Treatments | | | | | | |
| There are no Acid Volume records to display. | | | | 69,670 BSW + LINEAR GEL + 2,502,733# 30/50 SAND | | | | | | |

| Formation | Top |
|------------|-------|
| DES MOINES | 12710 |

Were open hole logs run? Yes
Date last log run: November 30, 2010

Were unusual drilling circumstances encountered? No
Explanation:

| Other Remarks |
|-----------------------------|
| There are no Other Remarks. |

| Lateral Holes |
|---|
| Sec: 13 TWP: 11N RGE: 21W County: BECKHAM SE SW SE SE 223 FSL 709 FEL of 1/4 SEC Depth of Deviation: 12726 Radius of Turn: 295 Direction: 178 Total Length: 4985 Measured Total Depth: 17695 True Vertical Depth: 13021 End Pt. Location From Release, Unit or Property Line: 223 |

| FOR COMMISSION USE ONLY |
|-------------------------|
| Status: Accepted |
| 1109783 |

API NO. 009-21780
OTC PROD. UNIT NO. 009-205000

PLEASE TYPE OR USE BLACK INK ONLY
NOTE: Attach copy of original 1002A if recompletion or re-



RECEIVED

MAR 17 2011

OKLAHOMA CORPORATION COMMISSION

ORIGINAL AMENDED Reason Amended

COMPLETION REPORT

TYPE OF DRILLING OPERATION
 STRAIGHT HOLE DIRECTIONAL HOLE HORIZONTAL HOLE
 SERVICE WELL
If directional or horizontal, see reverse for bottom hole location.

SPUD DATE 10/1/2010
DRLG FINISHED DATE 12/4/2010
DATE OF WELL COMPLETION 2/6/2011
1ST PROD DATE 2/7/2011
RECOMP DATE
Longitude (if Known)
OTC/OCC OPERATOR NO. 17441

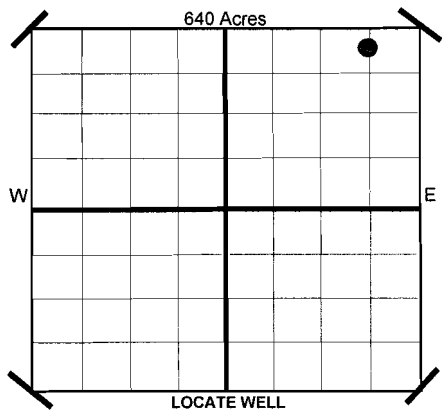

COUNTY Beckham SEC 13 TWP 11N RGE 21W
LEASE NAME Tolbert Trust WELL NO 1-13H
SHL N2 1/4 N2 1/4 NE 1/4 NE 1/4 FNL 250 FEL OF 1/4 SEC 660
ELEVATION Derrick Fl 2,025 Ground 2,000
OPERATOR NAME CHESAPEAKE OPERATING, INC. ADDRESS P.O. BOX 18496
CITY OKLAHOMA CITY STATE OK ZIP 73154

COMPLETION TYPE
 SINGLE ZONE
 MULTIPLE ZONE Application Date
 COMMINGLED Application Date
LOCATION EXCEPTION ORDER NO. 583066
INCREASED DENSITY ORDER NO. N/A

CASING & CEMENT (Form 1002C must be attached)

| TYPE | SIZE | WEIGHT | GRADE | FEET | PSI | SAX | TOP | |
|--------------|--------|--------|-------|--------|-----|-----|-------------|--------|
| CONDUCTOR | | | | | | | | |
| SURFACE | 9-5/8" | 40# | J-55 | 1,525 | | 620 | Surface | |
| INTERMEDIATE | 7" | 26# | P-110 | 12,241 | | 715 | 9,280 | |
| PRODUCTION | 4-1/2" | 13.5# | P-110 | 17,695 | | 600 | 11,740 | |
| LINER | | | | | | | | |
| | | | | | | | TOTAL DEPTH | 17,695 |

PACKER @ BRAND & TYPE
PLUG @ TYPE

PLUG @ TYPE
PLUG @ TYPE

COMPLETION & TEST DATA BY PRODUCING FORMATION

404 DSMN

| FORMATION | Des Moines | continued perms | continued perms | continued perms |
|---|---|-----------------|-----------------|-----------------|
| SPACING & SPACING | 640 | 13,951 - 13,952 | 15,434 - 15,435 | 17,021 - 17,022 |
| ORDER NUMBER | 577666 | 14,105 - 14,106 | 15,540 - 15,541 | 17,200 - 17,201 |
| CLASS: Oil, Gas, Dry, Inj. Disp, Comm Disp, Svc | Oil | 14,300 - 14,301 | 15,708 - 15,709 | 17,328 - 17,329 |
| | | 14,472 - 14,473 | 15,900 - 15,901 | 17,482 - 17,483 |
| | 13,030 - 13,031 | 14,650 - 14,651 | 16,010 - 16,011 | |
| | 13,184 - 13,185 | 14,790 - 14,791 | 16,184 - 16,185 | |
| PERFORATED INTERVALS | 13,337 - 13,338 | 14,940 - 14,941 | 16,334 - 16,335 | |
| | 13,498 - 13,499 | 15,050 - 15,051 | 16,534 - 16,535 | |
| | 13,644 - 13,645 | 15,210 - 15,211 | 16,670 - 16,671 | |
| | 13,794 - 13,795 | 15,305 - 15,306 | 16,868 - 16,869 | |
| ACID/VOLUME | | | | |
| FRACTURE TREATMENT (Fluids/Prop Amounts) | 69,670 BSW + linear gel + 2,502,733# 30/50 sand | | | |

Minimum Gas Allowable (165:10-17-7) OR Gas Purchaser/Measurer Chesapeake Operating, Inc.
1st Sales Date 2/7/2011

INITIAL TEST DATA

| INITIAL TEST DATE | 3/7/2011 |
|--------------------------|-----------|
| OIL-BBL/DAY | 174 |
| OIL-GRAVITY (API) | 50.3 |
| GAS-MCF/DAY | 1,610 |
| GAS-OIL RATIO CU FT/BBL | 9,253 |
| WATER-BBL/DAY | 441 |
| PUMPING OR FLOWING | Flowing |
| INITIAL SHUT-IN PRESSURE | N/A |
| CHOKE SIZE | 40/64 |
| FLOW TUBING PRESSURE | 488 (FCP) |

A record of the formations drilled through, and pertinent remarks are presented on the reverse. I declare that I have knowledge of the contents of this report and am authorized by my organization to make this report, which was prepared by me or under my supervision and direction, with the data and facts stated herein to be true, correct, and complete to the best of my knowledge and belief.

SIGNATURE: *[Signature]* MICHAEL PARK - DISTRICT MANAGER 3/10/2011 405-848-8000
NAME (PRINT OR TYPE) DATE PHONE NUMBER
P.O. BOX 18496 OKLAHOMA CITY OK 73154 juanita.cooper@chk.com
ADDRESS CITY STATE ZIP EMAIL ADDRESS

PLEASE TYPE OR USE BLACK INK ONLY
FORMATION RECORD

Give formation names and tops, if available, or descriptions and thickness of formations drilled through. Show intervals cored or drillstem tested.

LEASE NAME Tolbert Trust

WELL NO. 1-13H

| NAMES OF FORMATIONS | TOP |
|---------------------|--------|
| Des Moines | 12,710 |

| FOR COMMISSION USE ONLY | |
|--|-----------------|
| ITD on file <input type="checkbox"/> YES <input type="checkbox"/> NO | |
| APPROVED _____ DISAPPROVED _____ | 2) Reject Codes |
| _____ | |
| _____ | |
| _____ | |

| | | |
|--|---|--|
| Were open hole logs run? | <input checked="" type="checkbox"/> yes | <input type="checkbox"/> no |
| Date last log was run | 11/30/2010 | |
| Was CO ₂ encountered? | <input type="checkbox"/> yes | <input checked="" type="checkbox"/> no at what depths? |
| Was H ₂ S encountered? | <input type="checkbox"/> yes | <input checked="" type="checkbox"/> no at what depths? |
| Were unusual drilling circumstances encountered? | <input type="checkbox"/> yes | <input checked="" type="checkbox"/> no |
| If yes, briefly explain. | | |

Other remarks:

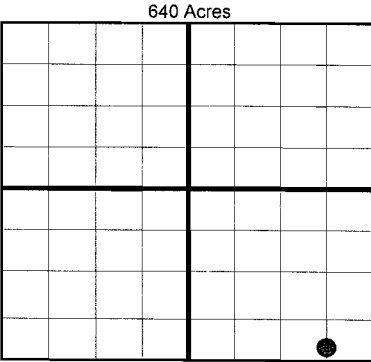

If more than three drainholes are proposed, attach a separate sheet indicating the necessary information.

Direction must be stated in degrees azimuth. Please note, the horizontal drainhole and its end point must be located within the boundaries of the lease or spacing unit.

Directional surveys are required for all drainholes and directional wells.
640 Acres

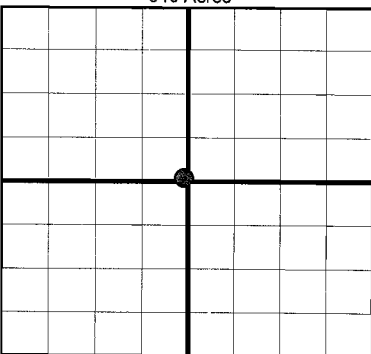

BOTTOM HOLE LOCATION FOR DIRECTIONAL HOLE

| SEC | TWP | RGE | COUNTY | | | | |
|----------------------|---------------------|-----|---|-----|-------------------------|-----|-----|
| Spot Location | 1/4 | 1/4 | 1/4 | 1/4 | Feet From 1/4 Sec Lines | FSL | FWL |
| Measured Total Depth | True Vertical Depth | | BHL From Lease, Unit, or Property Line: | | | | |

BOTTOM HOLE LOCATION FOR HORIZONTAL HOLE: (LATERALS)

LATERAL #1

| SEC | TWP | RGE | COUNTY | | | | |
|----------------------|---------------------|----------------|---|-----------|-------------------------|--------------|-------|
| 13 | 11N | 21W | Beckham | | | | |
| Spot Location | SW 1/4 | SE 1/4 | SE 1/4 | SE 1/4 | Feet From 1/4 Sec Lines | FSL | FEL |
| Depth of Deviation | 12,726 | Radius of Turn | 295 | Direction | 178 | Total Length | 4,985 |
| Measured Total Depth | True Vertical Depth | | BHL From Lease, Unit, or Property Line: | | | | |
| 17,695 | 13,021 | | 212 | | | | |

LATERAL #2

| SEC | TWP | RGE | COUNTY | | | | |
|----------------------|---------------------|-----|---|--------------|-------------------------|-----|-----|
| Spot Location | 1/4 | 1/4 | 1/4 | 1/4 | Feet From 1/4 Sec Lines | FSL | FWL |
| Depth of Deviation | Radius of Turn | | Direction | Total Length | | | |
| Measured Total Depth | True Vertical Depth | | BHL From Lease, Unit, or Property Line: | | | | |

LATERAL #3

| SEC | TWP | RGE | COUNTY | | | | |
|----------------------|---------------------|-----|---|--------------|-------------------------|-----|-----|
| Spot Location | 1/4 | 1/4 | 1/4 | 1/4 | Feet From 1/4 Sec Lines | FSL | FWL |
| Depth of Deviation | Radius of Turn | | Direction | Total Length | | | |
| Measured Total Depth | True Vertical Depth | | BHL From Lease, Unit, or Property Line: | | | | |